

Children's Health Care Conduit Bond Project

HRA Board Report Map • Tuesday, November 26, 2024

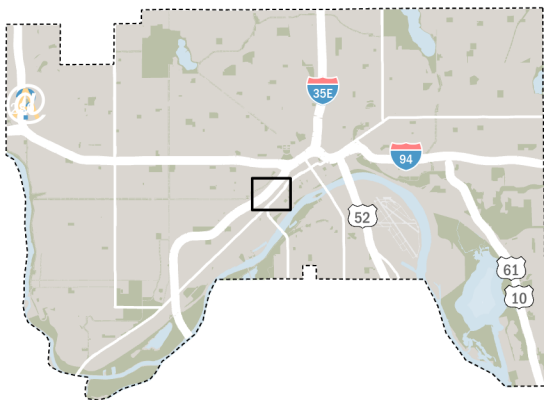
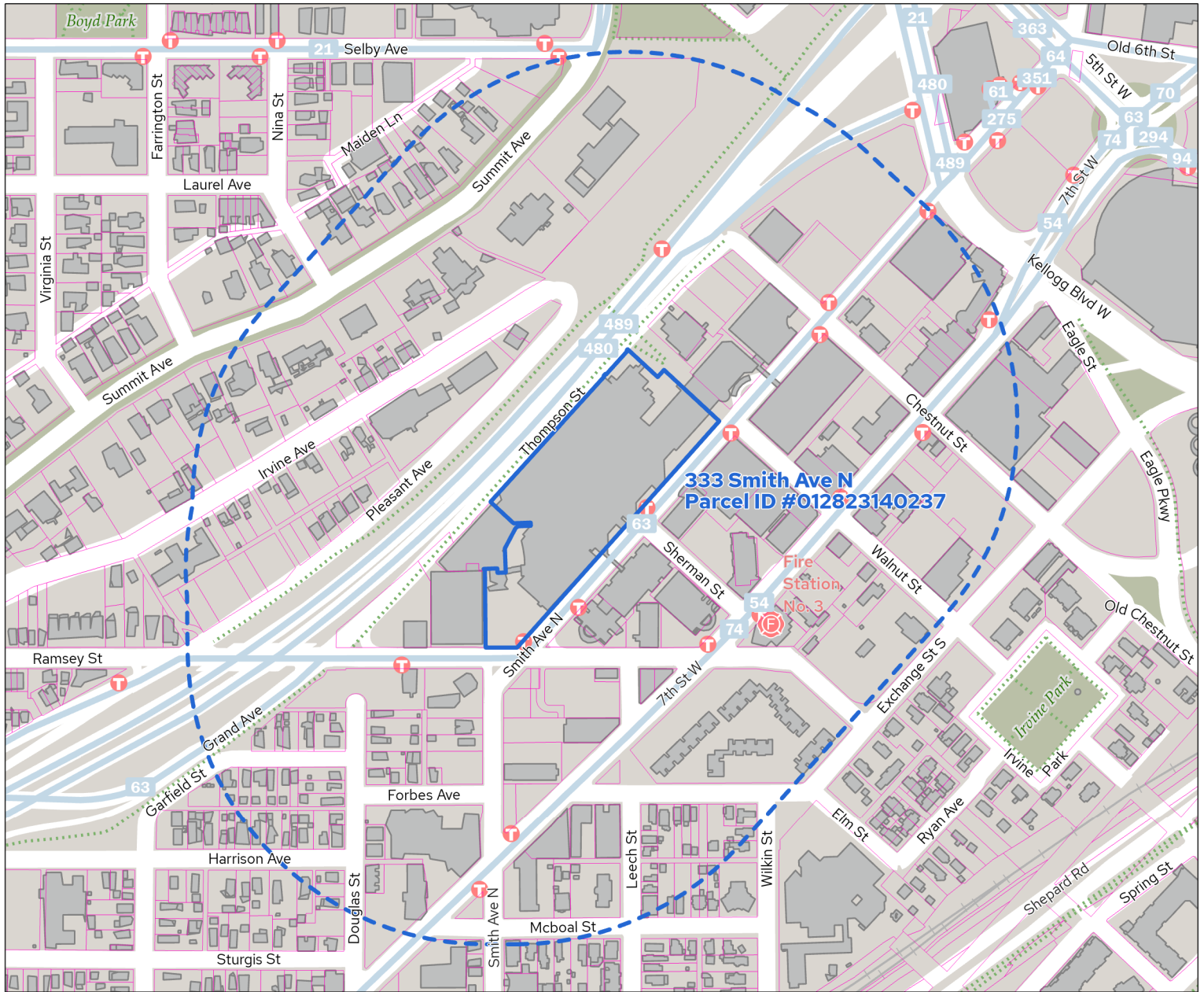

- Tax Parcels
- Subject Property
- Quarter Mile Distance

- Fire Stations
- Library Locations
- Police Stations
- Recreation Facilities
- Schools
- Trails
- Transit Routes
- Transit Stops

DATA CREDITS: St. Paul Enterprise GIS, Parcel Polygons: current Ramsey County data via Minnesota Geospatial Commons; Road and Building Polygons: 2017 impervious surface dataset, Ramsey County; Water bodies via Minnesota DNR. • LIMITATIONS ON USE: This document was prepared by the Saint Paul Planning and Economic Development Department and is intended to be used for reference and illustrative purposes only. This drawing is not a legally recorded plan, survey, official tax map or engineering schematic and is not intended to be used as such. • DATE: 11/26/2024 10:08 AM • DOCUMENT PATH: C:\Users\j37665\City of Saint Paul\PED-Research & Mapping - Documents\Projects\HRA Board Reports\2024\2024-11-26 345 Smith Ave for Jenny Wolfe\4 - GIS\2024-11-26 345 Smith Ave.aprx



0 0.02 0.04 0.09 0.14 0.18
Miles

