

MINNESOTA DEPARTMENT OF TRANSPORTATION RAMSEY COUNTY PUBLIC WORKS DEPARTMENT

PLAN FOR: RIGHT OF WAY ACQUISITION

LOCATED ON: CLEVELAND AVENUE (CSAH 46) FROM COMO AVENUE (CSAH 75) TO LARPEN TEUR AVENUE (CSAH 30) (GEOGRAPHIC DESCRIPTION)
LARPEN TEUR AVE (CSAH 30) FROM CLEVELAND AVE (CSAH 46) TO GORTNER AVENUE (GEOGRAPHIC DESCRIPTION)

CLEVELAND AVENUE (CSAH 46) RECONSTRUCTION CLEVELAND AVENUE STATE AID PROJECT NO. 062-646-033 LARPEN TEUR AVENUE STATE AID PROJECT NO. 062-630-072

CLEVELAND AVE (CSAH 46) / LARPEN TEUR AVE (CSAH 30)
STATE AID PROJ. NO. 062-646-033 / 062-630-072
GROSS LENGTH 5730.66 FEET 1.09 MILES (CLEVELAND AVE/CSAH 46)
GROSS LENGTH 1443.87 FEET 0.27 MILES (LARPEN TEUR AVENUE/CSAH 30)
BRIDGE LENGTH 0.00 FEET 0.000 MILES (CLEVELAND AVE/CSAH 46)
NET LENGTH 7174.53 FEET 1.36 MILES (CLEVELAND AVE/CSAH 46 - LARPEN TEUR AVENUE/CSAH 30)

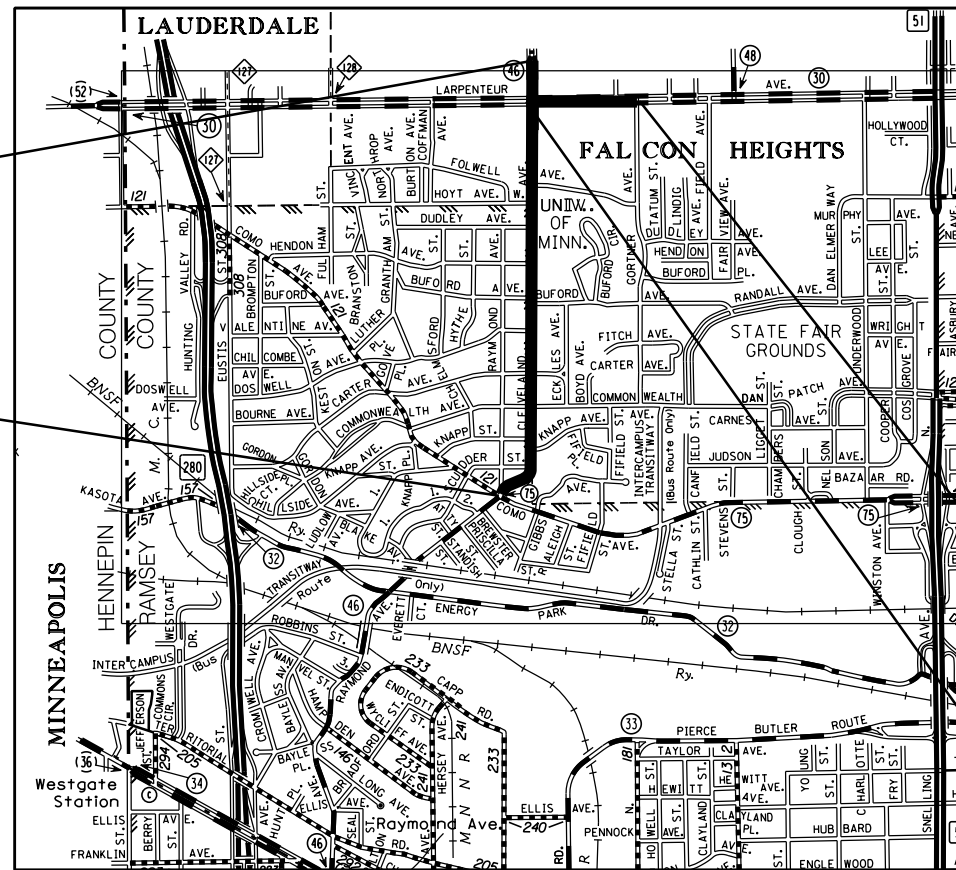

CLEVELAND AVENUE (CSAH 46)
END S.A.P. 062-646-033
STA. 69+54.02

CLEVELAND AVENUE (CSAH 46)
BEGIN S.A.P. 062-646-033
STA. 12+23.36

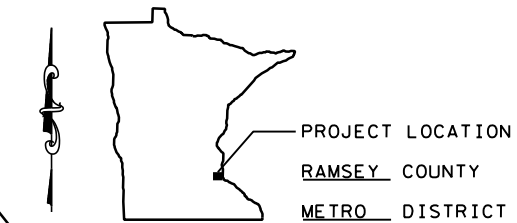

LARPEN TEUR AVENUE (CSAH 30)
END S.A.P. 062-630-072
STA. 26+30.36

LARPEN TEUR AVENUE (CSAH 30)
BEGIN S.A.P. 062-630-072
STA. 11+86.49

PLAN SET SCALES

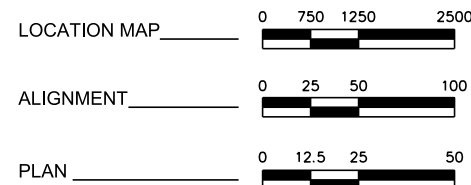

I HEREBY CERTIFY THAT THE FINAL FIELD REVISIONS, IF ANY, OF THIS PLAN WERE MADE BY ME OR UNDER MY DIRECT SUPERVISION AND THAT I AM A DULY LICENSED PROFESSIONAL ENGINEER UNDER THE LAWS OF THE STATE OF MINNESOTA.

ENGINEER _____
DATE _____ REG. NO. _____

PLAN REVISIONS		
DATE	SHEET NO.	APPROVED BY

STATE AID PROJ. NO. 062-646-033 / 062-630-072

GOVERNING SPECIFICATIONS
THE 2018 EDITION OF THE MINNESOTA DEPARTMENT OF TRANSPORTATION "STANDARD SPECIFICATIONS FOR CONSTRUCTION" SHALL GOVERN. ALL TRAFFIC CONTROL SIGNING AND DEVICES SHALL CONFORM TO THE MMUTCO, INCLUDING THE FIELD MANUAL FOR TEMPORARY TRAFFIC CONTROL ZONE LAYOUTS.

SHEET INDEX

SHEET NO.	DESCRIPTION
1	TITLE SHEET
2 - 8	TYPICAL SECTIONS
9 - 12	ALIGNMENT PLAN
13 - 23	RIGHT OF WAY PLAN
24	RIGHT OF WAY CHART

THIS PLAN SET CONTAINS 22 SHEETS



2550 UNIVERSITY AVENUE WEST, SUITE 238N, ST. PAUL, MN 55114
PHONE: 651-645-4197
WWW.KIMLEY-HORN.COM
I HEREBY CERTIFY THAT THIS PLAN WAS PREPARED BY ME OR UNDER MY DIRECT SUPERVISION AND THAT I AM A DULY LICENSED PROFESSIONAL ENGINEER UNDER THE LAWS OF THE STATE OF MINNESOTA.

DATE _____ LIC. NO. _____

ENGINEER _____

APPROVED _____ 2020
CITY OF ST PAUL ENGINEER

APPROVED _____ 2020
RAMSEY COUNTY ENGINEER

APPROVED _____ 2020
DISTRICT STATE AID ENGINEER: REVIEWED FOR COMPLIANCE WITH STATE AID RULES/POLICY

APPROVED FOR STATE AID FUNDING: STATE AID ENGINEER _____ 2020

SHEET NO. 1 OF 24 SHEETS

3:28:49 PM

4/2/2020

CD:160553008.tsh01.dgn

3:28:51 PM

4/2/2020

EXISTING TYPICAL SECTION - CLEVELAND AVE

STA 12+23.36 TO STA 55+00.00

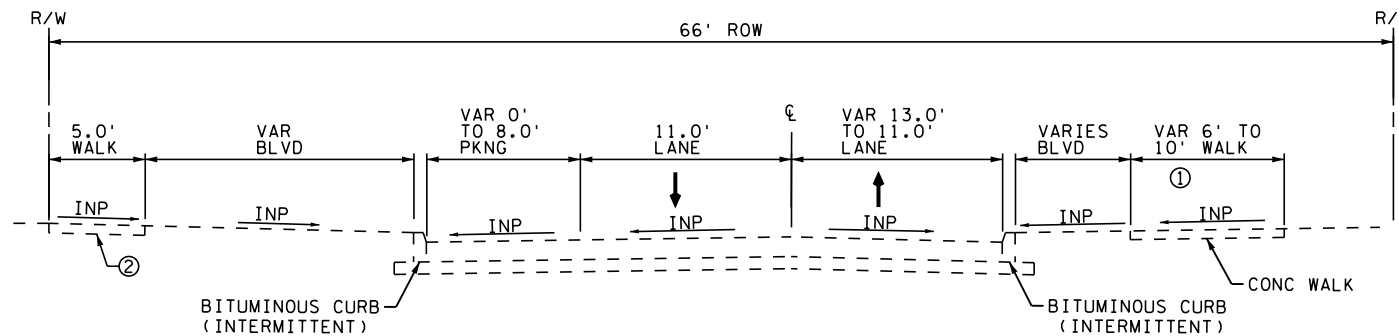

SPECIFIC NOTES:

- ① TYPICAL 6' WIDTH SIDEWALK 8' WIDE STA 12+23 TO STA 25+99
STA 39+51 TO STA 52+71
- SIDEWALK 10' WIDE STA 26+15 TO STA 39+51
- ② CONCRETE WALK STA 12+23 TO STA 53+00
BITUMINOUS WALK STA 53+00 TO STA 55+00

EXISTING TYPICAL SECTION - CLEVELAND AVE

STA 55+00.00 TO STA 60+94.17

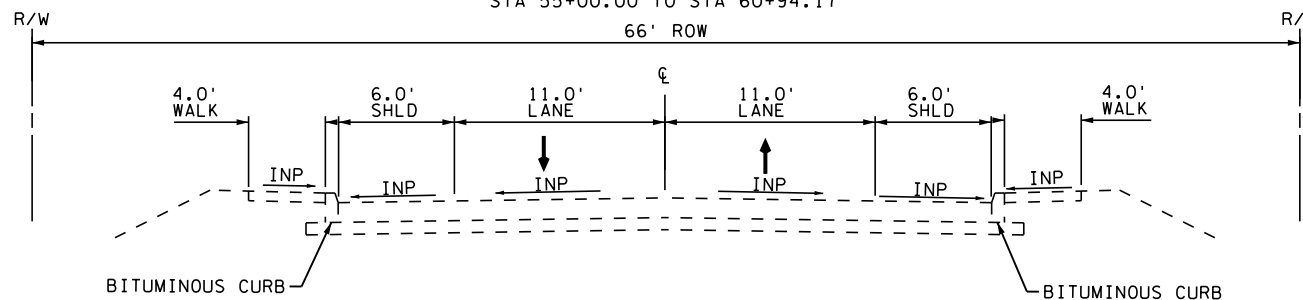

EXISTING TYPICAL SECTION - CLEVELAND AVE

STA 60+94.17 TO STA 65+83.00

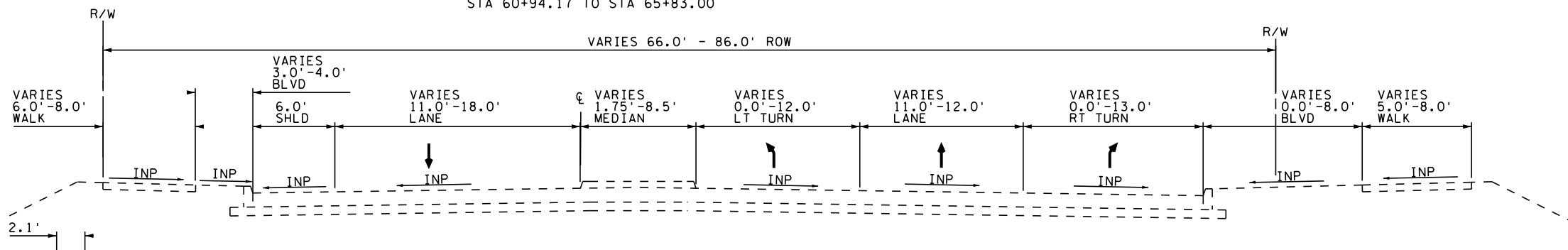

CD:\60553008.tso1.dgn

DESIGN TEAM				
DRAWN BY:				
DESIGNER:				
CHECKED BY:				
	NO.	BY	DATE	REVISIONS

I hereby certify that this plan was prepared by me or under my direct supervision and that I am a duly Licensed Professional Engineer under the laws of the State of Minnesota.

Certified By: [Signature] Lic. No. _____
 Printed Name: COPY Date: 4/2/2020



RAMSEY COUNTY, MINNESOTA
 CLEVELAND AVE (CSAH 46)
 RECONSTRUCTION

TYPICAL SECTIONS
 EXISTING TYPICAL SECTIONS

SAP NO. CLEVELAND AVE 062-646-033	22
LARPEUR AVE 062-630-072	207

3:28:52 PM

4/2/2020

EXISTING TYPICAL SECTION - CLEVELAND AVE
STA 65+83.00 TO STA 69+54.02

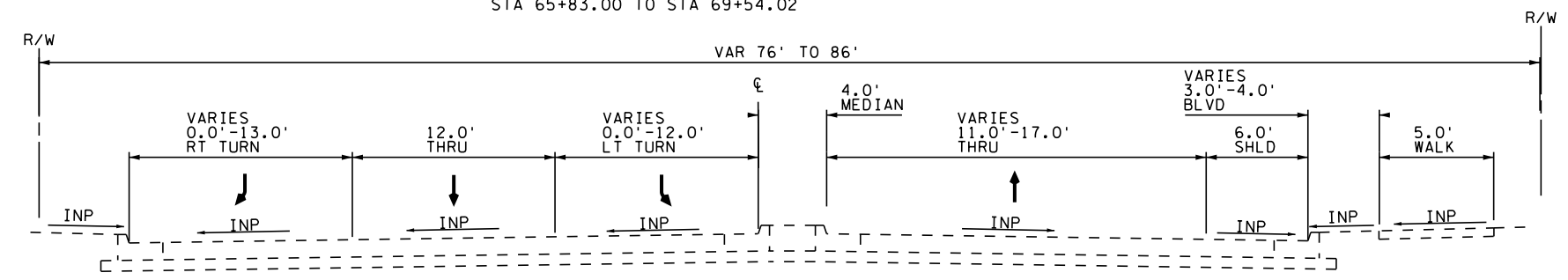

EXISTING TYPICAL SECTION - SCUDDER ST
STA 11+00 TO 12+08

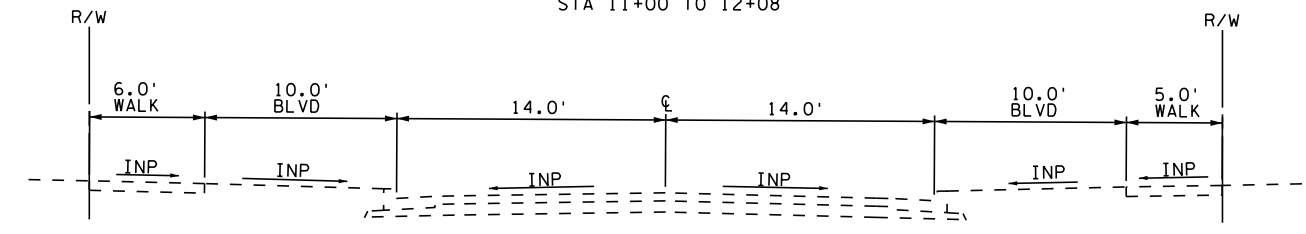

EXISTING TYPICAL SECTION - LARPEN TEUR AVE
STA 12+53 TO 16+56

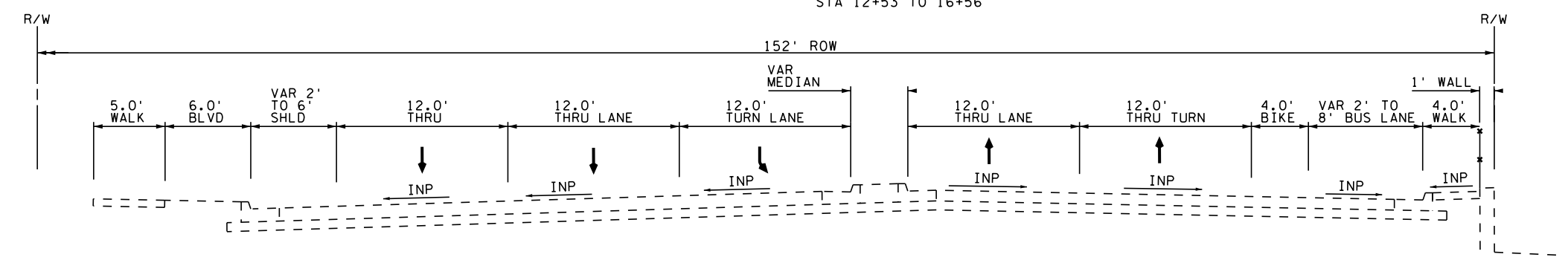

CDI60553008.ts02.dgn

DESIGN TEAM				
DRAWN BY:	TJC			
DESIGNER:	WDJ			
CHECKED BY:	WCK			
NO.	BY	DATE	REVISIONS	

I hereby certify that this plan was prepared by me or under my direct supervision and that I am a duly Licensed Professional Engineer under the laws of the State of Minnesota.

Certified By: WCK Lic. No. _____

Printed Name: WCK Date: 4/2/2020



RAMSEY COUNTY, MINNESOTA
CLEVELAND AVE (CSAH 46)
RECONSTRUCTION

TYPICAL SECTIONS
EXISTING TYPICAL SECTIONS

SAP NO.
CLEVELAND AVE
062-646-033
LARPEN TEUR AVE
062-630-072

23
207

3:28:52 PM

4/2/2020

EXISTING TYPICAL SECTION - LARPEN TEUR AVE
STA 16+56 TO 26+00

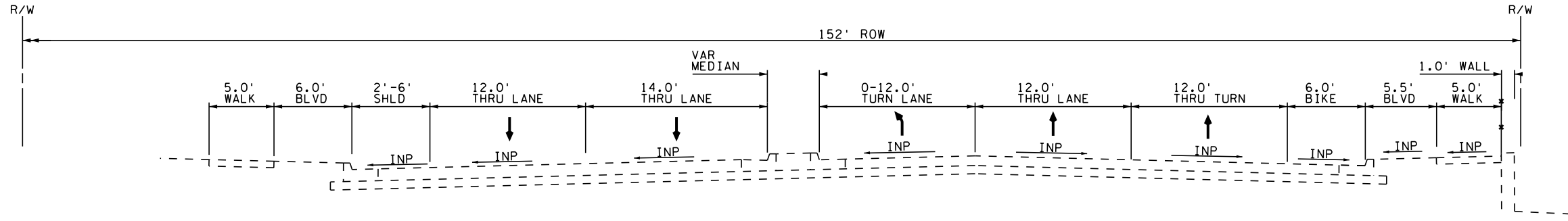

CD:160553008.ts03.dgn

DESIGN TEAM				
DRAWN BY:	TJC			
DESIGNER:	WDJ			
CHECKED BY:	WCK			
NO.	BY	DATE	REVISIONS	

I hereby certify that this plan was prepared by me or under my direct supervision and that I am a duly Licensed Professional Engineer under the laws of the State of Minnesota.

Certified By: WCK Lic. No. _____
Printed Name: _____ Date: 4/2/2020



RAMSEY COUNTY, MINNESOTA
CLEVELAND AVE (CSAH 46)
RECONSTRUCTION

TYPICAL SECTIONS
EXISTING TYPICAL SECTIONS

SAP NO.
CLEVELAND AVE
062-646-033
LARPEN TEUR AVE
062-630-072

24
207

TYPICAL SECTION #1 - CLEVELAND AVE

STA 14+97.69 TO STA 30+61.25

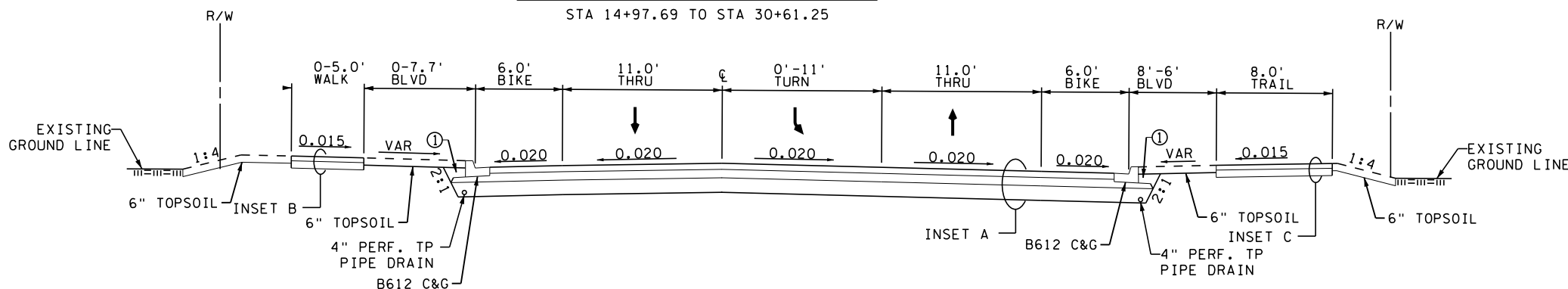

TYPICAL SECTION #2 - CLEVELAND AVE

STA 14+97.69 TO STA 30+61.25

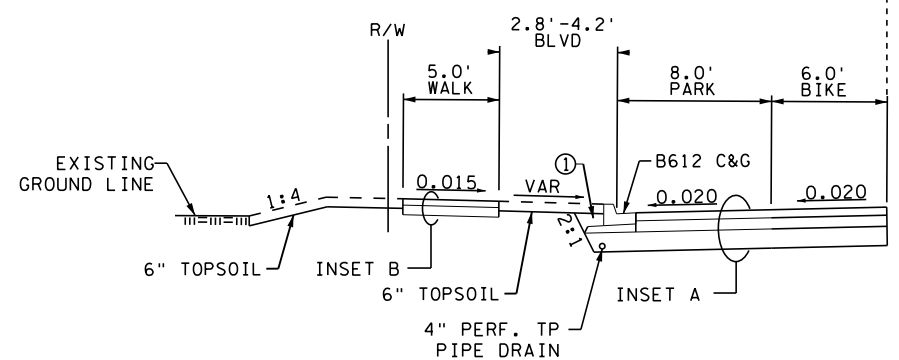
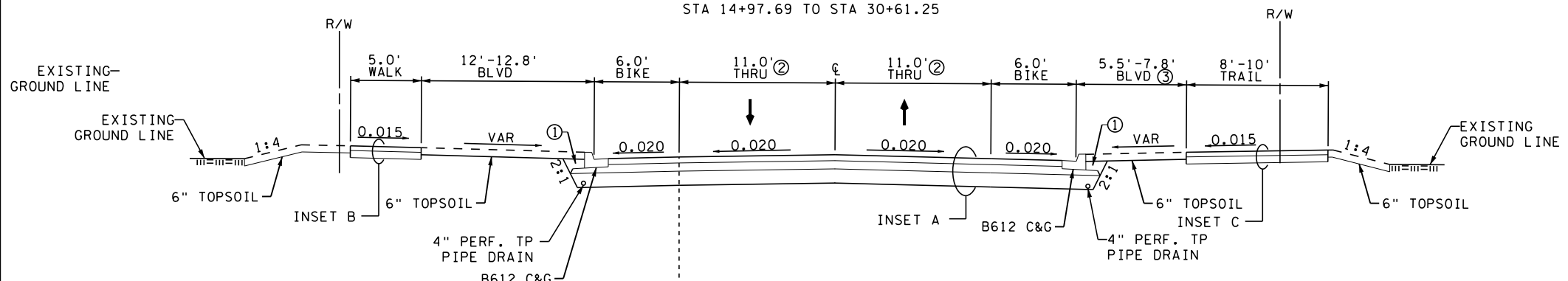

STA 22+32.12 TO STA 24+32.12
STA 28+51.89 TO STA 29+71.25

TYPICAL SECTION #3 - CLEVELAND AVE

STA 30+61 TO STA 40+03

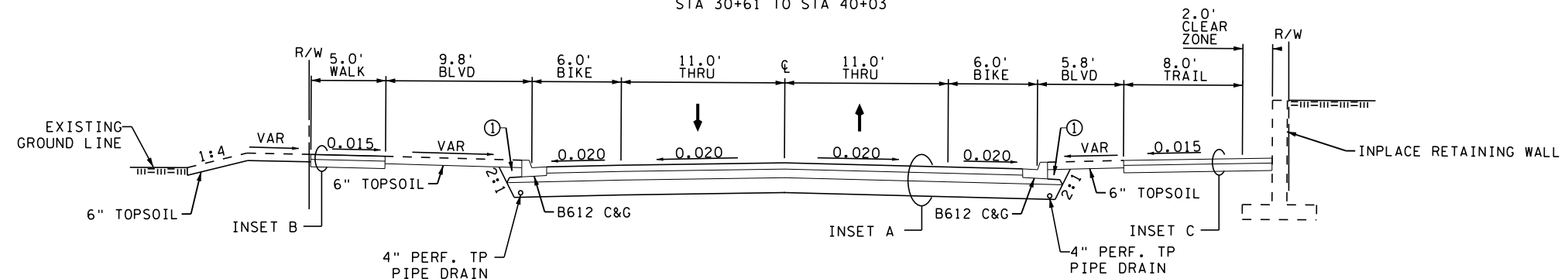

INSET A

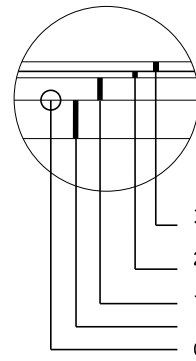

3.0" TYPE SP 9.5 WEARING COURSE MIXTURE (SPWEA340C)
2.0" TYPE SP 12.5 NON WEAR COURSE MIX (SPNWB330B)
7.0" AGGREGATE BASE (CV) CLASS 5
12.0" SELECT GRANULAR EMBANKMENT (CV) GRADING GRADE

INSET B

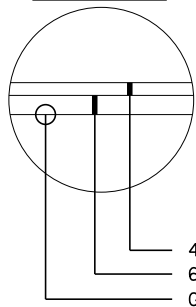

4" CONCRETE WALK
6" CLASS 6 AGGREGATE BASE (2211)
GRADING GRADE

INSET C

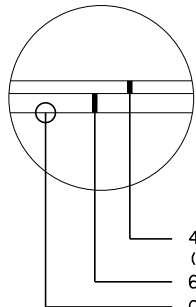

4.0" TYPE SP 9.5 WEARING COURSE MIXTURE (SPWEA340C)
6" CLASS 6 AGGREGATE BASE (2211)
GRADING GRADE

SPECIFIC NOTES:

- ① BACKFILL WITH SELECT GRANULAR MATERIAL.
- ② VARIES 11.0'-14.0'
STA 15+69.29 TO STA 19+17.20
- ③ VARIES 11.0'-14.0'
STA 15+69.29 TO STA 19+17.20

GENERAL NOTES:

- 1. TYPICAL SECTIONS ARE NOT TO SCALE.
- 2. ALL CROSS SLOPES ARE EXPRESSED IN FT/FT.
- 3. UNLESS OTHERWISE SPECIFIED, THE GRADING CROSS SLOPES WILL BE THE SAME AS PROPOSED DRIVING SURFACE.
- 4. ALL DIMENSIONS AT CURB AND GUTTER ARE MEASURED TO FACE OF CURB UNLESS OTHERWISE NOTED.
- 5. AGGREGATE BASE TO EXTEND 1' MIN BEHIND BACK OF CURB.

3:28:53 PM

4/2/2020

CDI60553008.ts04.dgn

DESIGN TEAM				
DRAWN BY:	TJG			
DESIGNER:	WDJ			
CHECKED BY:	WCK			
NO.	BY	DATE	REVISIONS	

I hereby certify that this plan was prepared by me or under my direct supervision and that I am a duly Licensed Professional Engineer under the laws of the State of Minnesota.
Certified By: WCK Lic. No. _____
Printed Name: WCK Date: 4/2/2020



RAMSEY COUNTY, MINNESOTA
CLEVELAND AVE (CSAH 46)
RECONSTRUCTION

TYPICAL SECTIONS
PROPOSED TYPICAL SECTIONS

SAP NO.
CLEVELAND AVE
062-646-033
LARPENITEUR AVE
062-630-072
25
207

3:28:53 PM

4/2/2020

CDI60553008.tso5.dgn

TYPICAL SECTION #4 - CLEVELAND AVE STA 43+57 TO STA 60+64

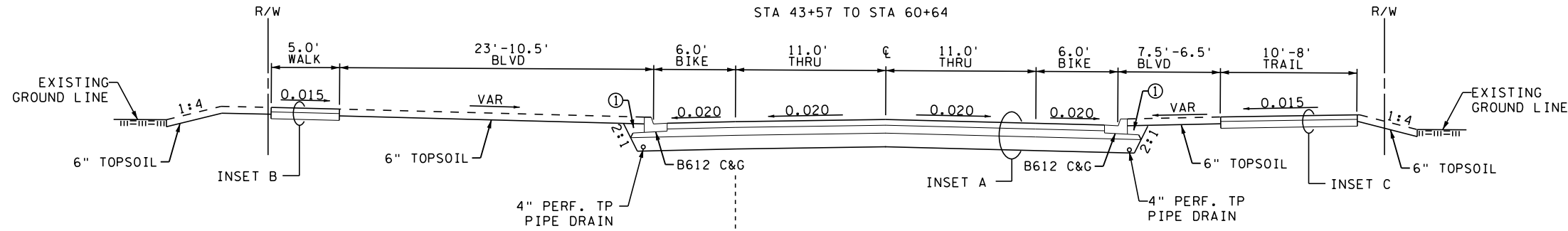

INSET A

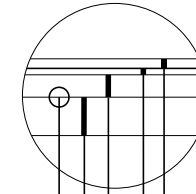

3.0" TYPE SP 9.5 WEARING COURSE MIXTURE (SPWEA340C)
 2.0" TYPE SP 12.5 NON WEAR COURSE MIX (SPNWB330B)
 7.0" AGGREGATE BASE (CV) CLASS 5
 12.0" SELECT GRANULAR EMBANKMENT (CV) GRADING GRADE

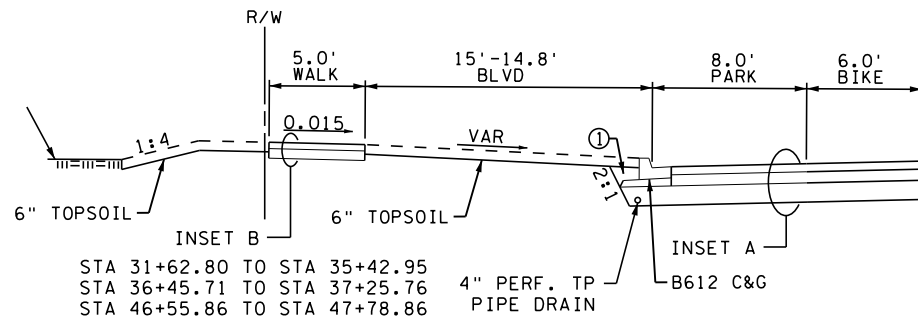

INSET B

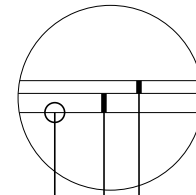

4" CONCRETE WALK
 6" CLASS 6 AGGREGATE BASE (2211)
 GRADING GRADE

STA 31+62.80 TO STA 35+42.95
 STA 36+45.71 TO STA 37+25.76
 STA 46+55.86 TO STA 47+78.86

TYPICAL SECTION #5 - CLEVELAND AVE STA 60+64.40 TO STA 65+46.22

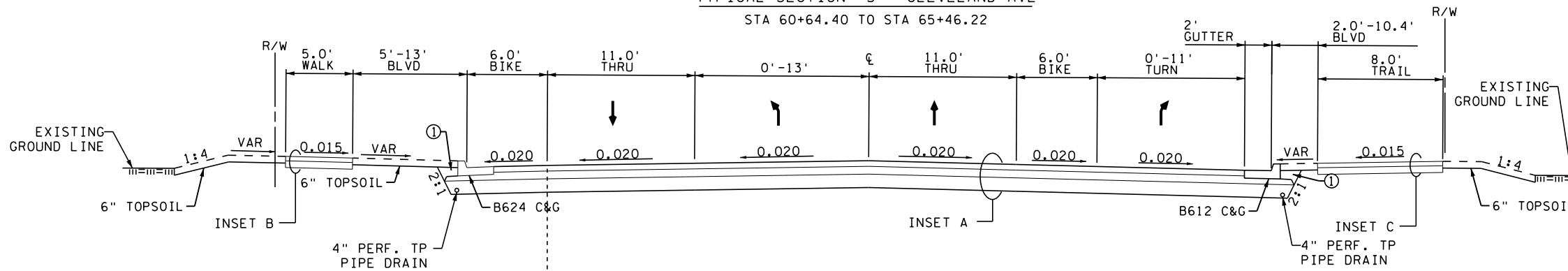

INSET C

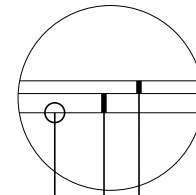

4.0" TYPE SP 9.5 WEARING COURSE MIXTURE (SPWEA340C)
 6" CLASS 6 AGGREGATE BASE (2211)
 GRADING GRADE

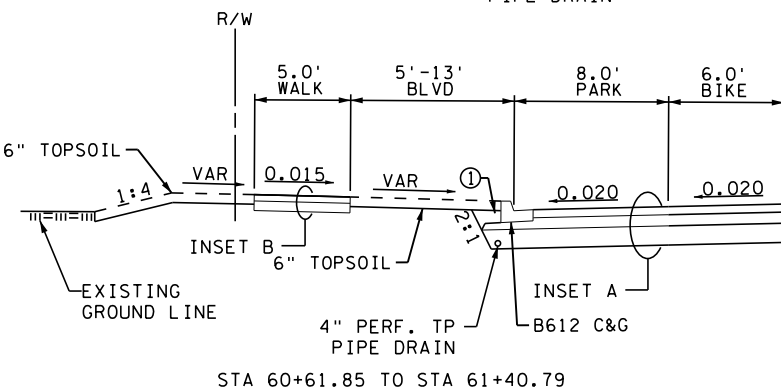

STA 60+61.85 TO STA 61+40.79

GENERAL NOTES:

1. TYPICAL SECTIONS ARE NOT TO SCALE.
2. ALL CROSS SLOPES ARE EXPRESSED IN FT/FT.
3. UNLESS OTHERWISE SPECIFIED, THE GRADING CROSS SLOPES WILL BE THE SAME AS PROPOSED DRIVING SURFACE.
4. ALL DIMENSIONS AT CURB AND GUTTER ARE MEASURED TO FACE OF CURB UNLESS OTHERWISE NOTED.
5. AGGREGATE BASE TO EXTEND 1' MIN BEHIND BACK OF CURB.

SPECIFIC NOTES:

- ① BACKFILL WITH SELECT GRANULAR MATERIAL.

DESIGN TEAM				
DRAWN BY:	TJC			
DESIGNER:	WDJ			
CHECKED BY:	WCK			
NO.	BY	DATE	REVISIONS	

I hereby certify that this plan was prepared by me or under my direct supervision and that I am a duly Licensed Professional Engineer under the laws of the State of Minnesota.
 Certified By: WCK Lic. No. _____
 Printed Name: WCK Date: 4/2/2020



RAMSEY COUNTY, MINNESOTA
 CLEVELAND AVE (CSAH 46)
 RECONSTRUCTION

TYPICAL SECTIONS
 PROPOSED TYPICAL SECTIONS

SAP NO.
 CLEVELAND AVE
 062-646-033
 LARPEUR AVE
 062-630-072

26
 207

3:28:55 PM

4/2/2020

CD:\60553008.ts07.dgn

TYPICAL SECTION #9 - LARPEN TEUR AVE
 STA 14+72 TO 26+00

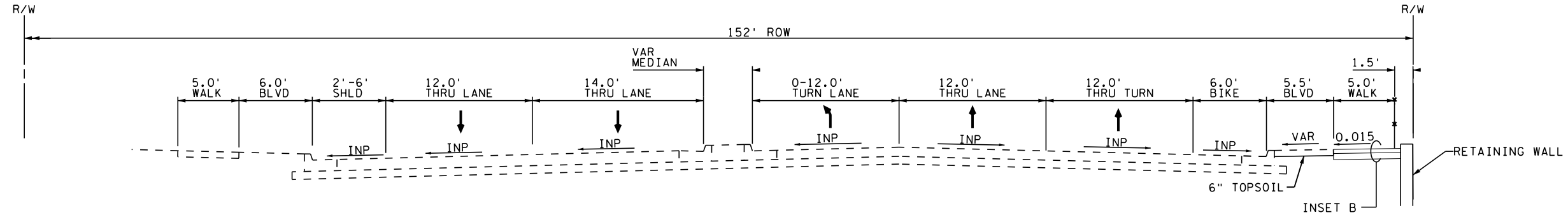

GENERAL NOTES:

1. TYPICAL SECTIONS ARE NOT TO SCALE.
2. ALL CROSS SLOPES ARE EXPRESSED IN FT/FT.
3. UNLESS OTHERWISE SPECIFIED, THE GRADING CROSS SLOPES WILL BE THE SAME AS PROPOSED DRIVING SURFACE.
4. ALL DIMENSIONS AT CURB AND GUTTER ARE MEASURED TO FACE OF CURB UNLESS OTHERWISE NOTED.
5. AGGREGATE BASE TO EXTEND 1' MIN BEHIND BACK OF CURB.

DESIGN TEAM				
DRAWN BY:	TJC			
DESIGNER:	WDJ			
CHECKED BY:	WCK			
	NO.	BY	DATE	REVISIONS

I hereby certify that this plan was prepared by me or under my direct supervision and that I am a duly Licensed Professional Engineer under the laws of the State of Minnesota.
 Certified By: WCK Lic. No. _____
 Printed Name: WCK Date: 4/2/2020



RAMSEY COUNTY, MINNESOTA
 CLEVELAND AVE (CSAH 46)
 RECONSTRUCTION

TYPICAL SECTIONS
 PROPOSED TYPICAL SECTIONS

SAP NO.
 CLEVELAND AVE
 062-646-033
 LARPEN TEUR AVE
 062-630-072

28
 207

3:28:56 PM

4/2/2020

CD:\60553008.dwg

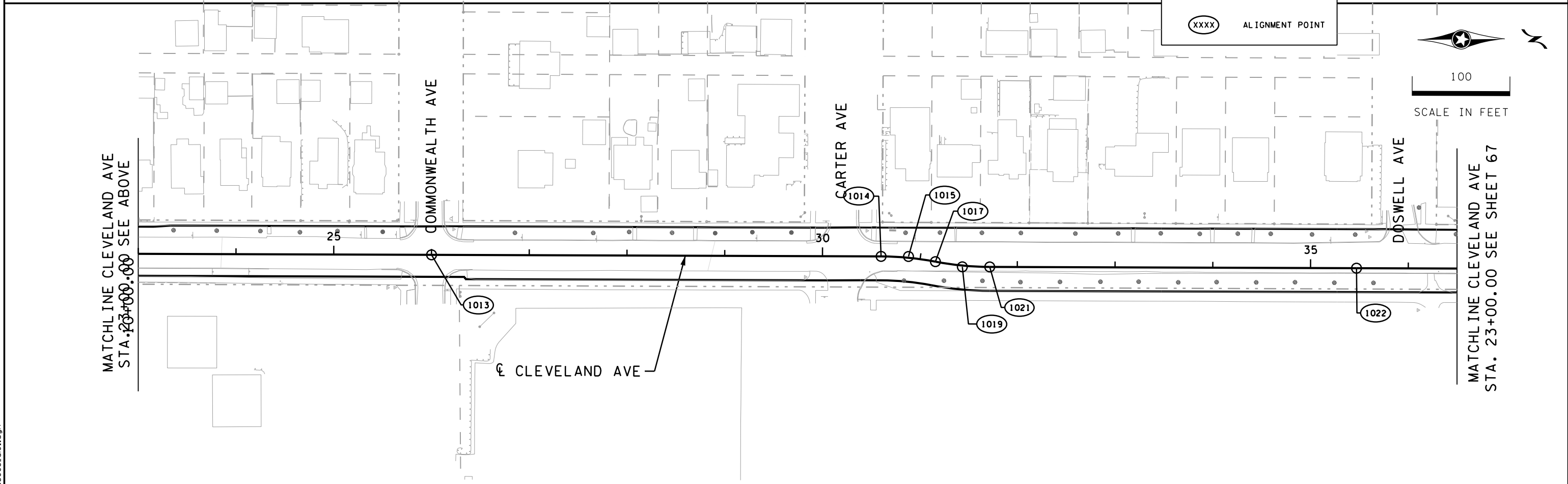
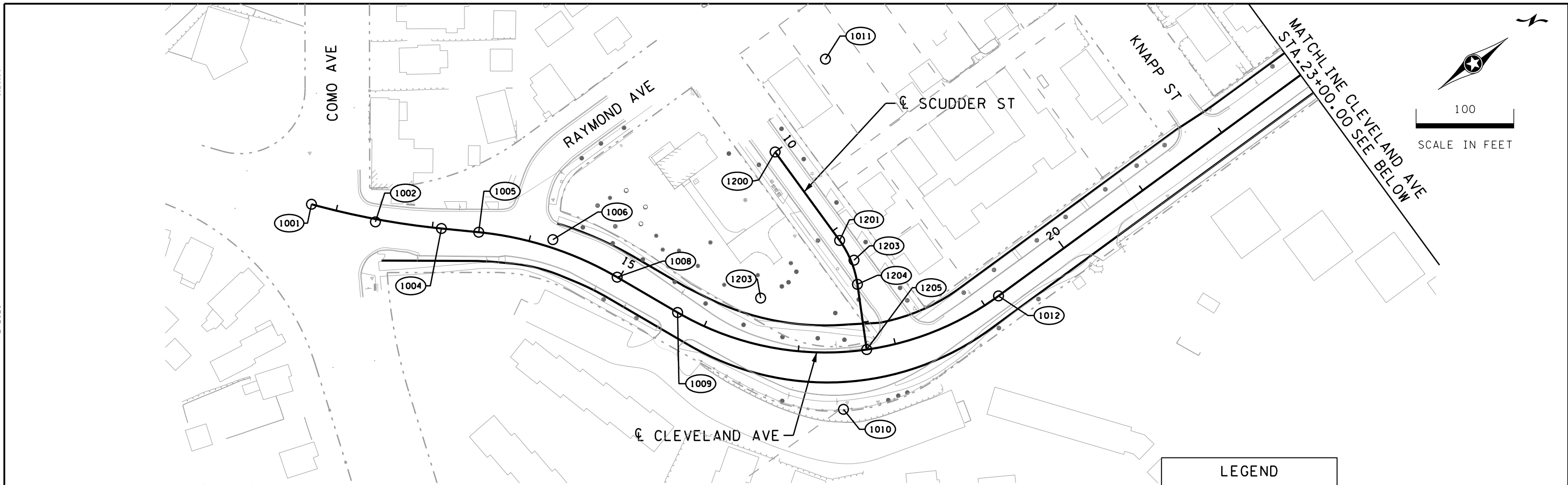

DESIGN TEAM			
DRAWN BY:	TJC		
DESIGNER:	WDJ		
CHECKED BY:	WCK		
NO.	BY	DATE	REVISIONS

I hereby certify that this plan was prepared by me or under my direct supervision and that I am a duly Licensed Professional Engineer under the laws of the State of Minnesota.

Certified By: WCK Lic. No. _____
 Printed Name: WCK Date: 4/2/2020



RAMSEY COUNTY, MINNESOTA
 CLEVELAND AVE (CSAH 46)
 RECONSTRUCTION

ALIGNMENT PLAN
 STA 10+00.00 TO STA 23+00.00

SAP NO.
 CLEVELAND AVE
 062-646-033
 LARPEUR AVE
 062-630-072

66
 207

3:28:57 PM

4/2/2020

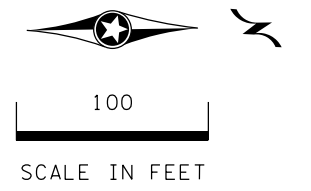

MATCHLINE CLEVELAND AVE
STA. 23+00.00 SEE SHEET 7

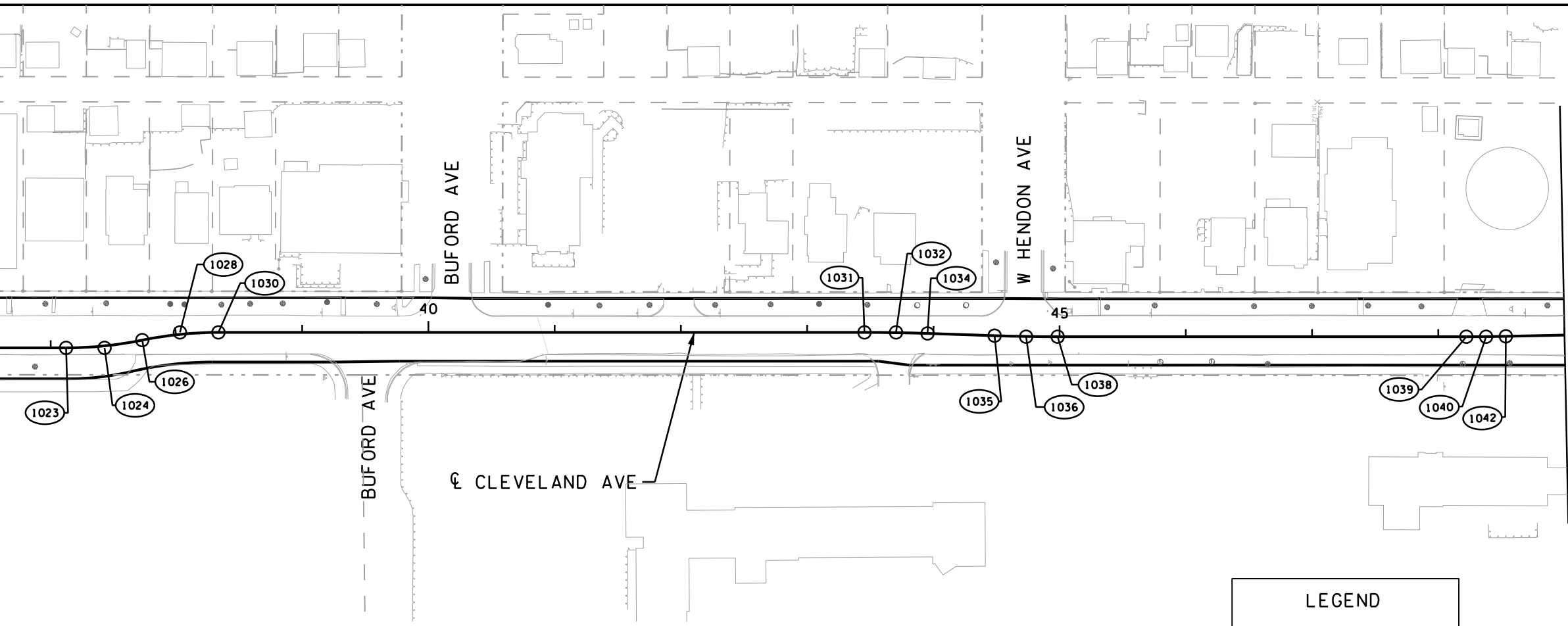

MATCHLINE CLEVELAND AVE
STA. 49+00.00 SEE BELOW

LEGEND

(XXXX) ALIGNMENT POINT

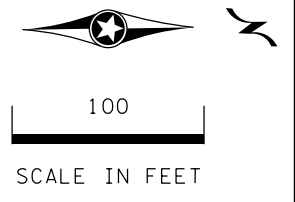

MATCHLINE CLEVELAND AVE
STA. 49+00.00 SEE ABOVE

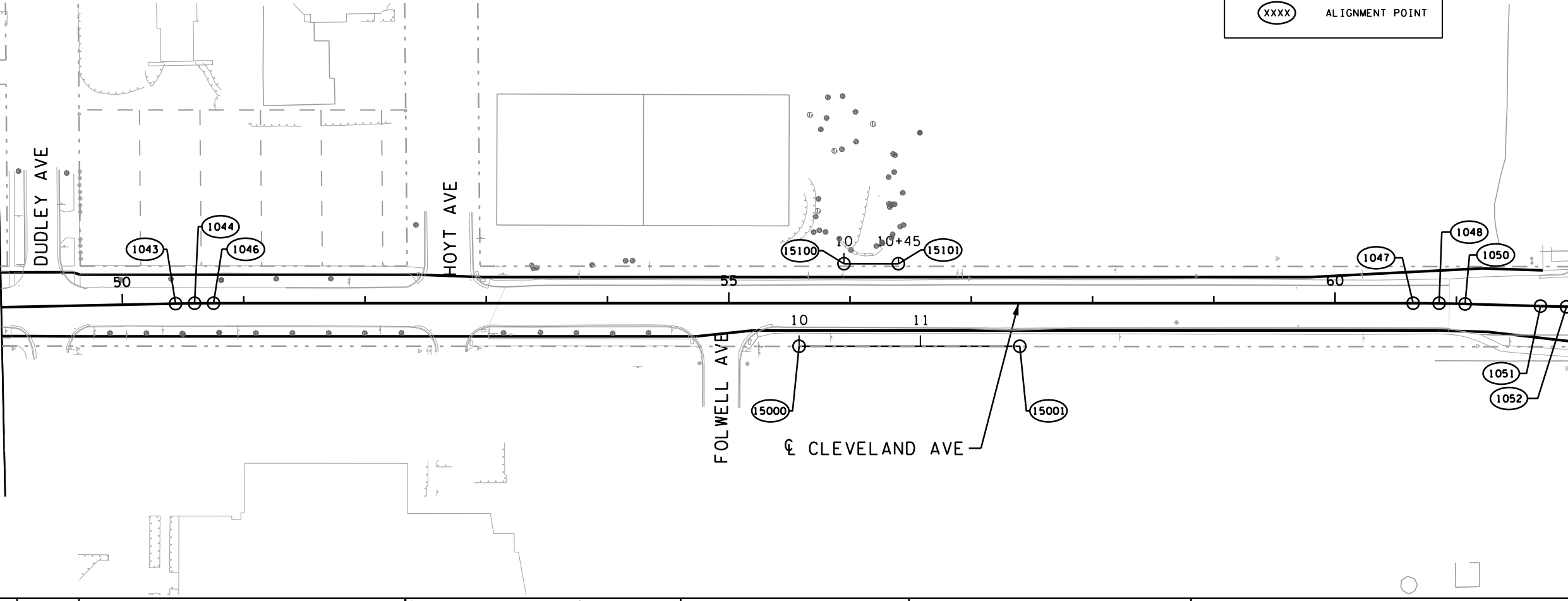

MATCHLINE CLEVELAND AVE
STA. 36+50.00 SEE SHEET 68

CD:\60553008.dwg

DESIGN TEAM			
DRAWN BY:	TJC		
DESIGNER:	WDJ		
CHECKED BY:	WCK		
NO.	BY	DATE	REVISIONS

I hereby certify that this plan was prepared by me or under my direct supervision and that I am a duly Licensed Professional Engineer under the laws of the State of Minnesota.

Certified By: **WCK** Lic. No. _____
Printed Name: **WCK** Date: 4/2/2020

RAMSEY COUNTY
Kimley»Horn

RAMSEY COUNTY, MINNESOTA
**CLEVELAND AVE (CSAH 46)
RECONSTRUCTION**

ALIGNMENT PLAN
STA 23+00.00 TO STA 36+50.00

SAP NO.
CLEVELAND AVE
062-646-033
LARPENTEUR AVE
062-630-072

67
207

3:28:59 PM

4/2/2020

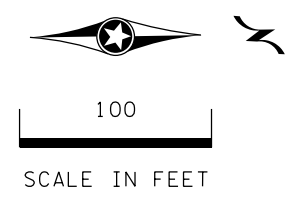

MATCHLINE CLEVELAND AVE
STA. 36+50.00 SEE SHEET 8

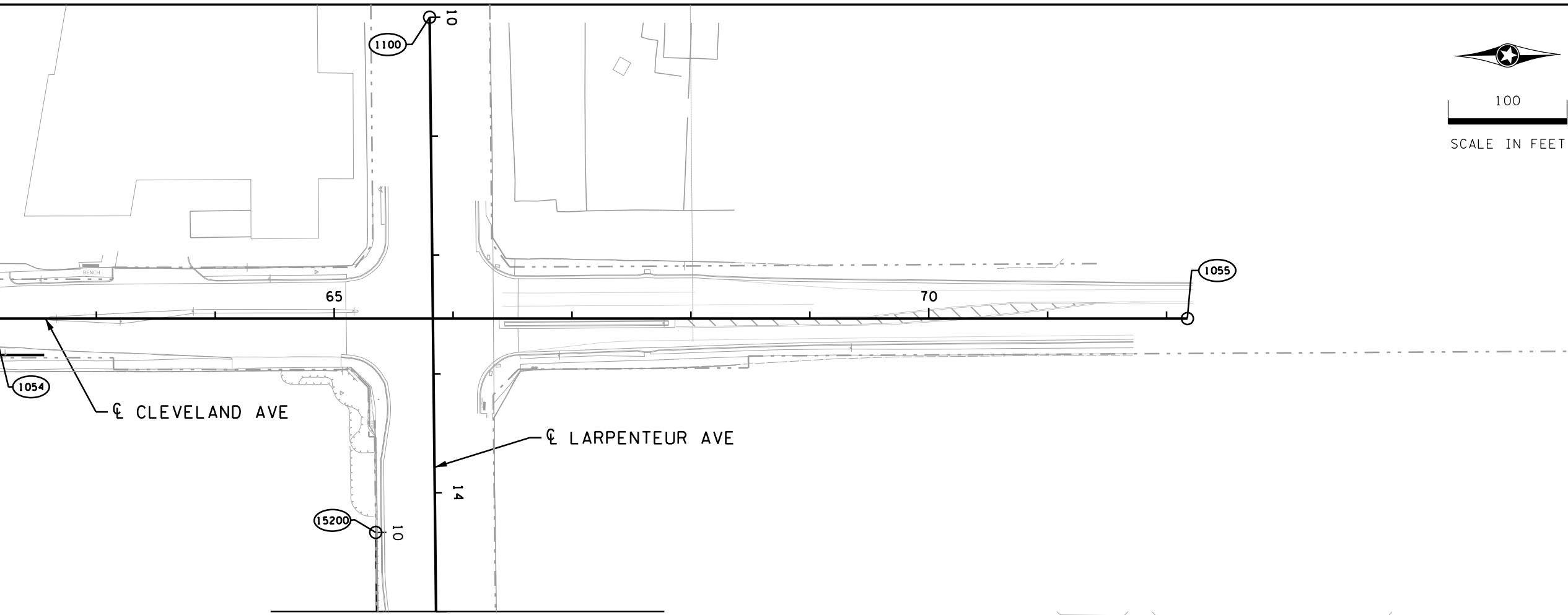

MATCHLINE LARPEL TEUR AVE
STA. 45+00.00 SEE BELOW 69

LEGEND

(XXXX) ALIGNMENT POINT

MATCHLINE LARPEL TEUR AVE
STA. 15+00.00 SEE ABOVE

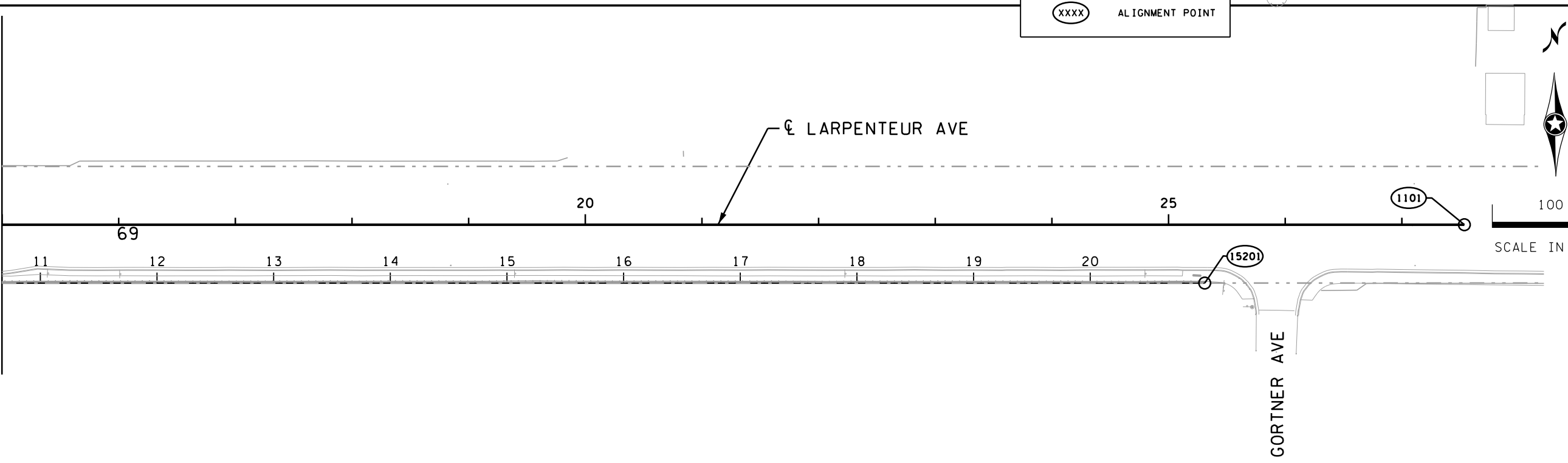

CD:160553008.dwg

DESIGN TEAM				
DRAWN BY:	TJC			
DESIGNER:	WDJ			
CHECKED BY:	WCK			
NO.	BY	DATE	REVISIONS	

I hereby certify that this plan was prepared by me or under my direct supervision and that I am a duly Licensed Professional Engineer under the laws of the State of Minnesota.

Certified By: WCK Lic. No. _____
Printed Name: WCK Date: 4/2/2020



RAMSEY COUNTY, MINNESOTA
CLEVELAND AVE (CSAH 46)
RECONSTRUCTION

ALIGNMENT PLAN
CLEVELAND AVE STA 36+50.00 TO STA 45+00.00
LARPEL TEUR AVE STA 13+12.23 TO STA 28+00.56

SAP NO.
CLEVELAND AVE
062-646-033
LARPEL TEUR AVE
062-630-072

68
207

3:28:59 PM

4/2/2020

CD:\60553008.dwg

ALIGNMENT TABULATION

Table with columns: POINT NUMBER, POINT, STATION, CIRCULAR CURVE DATA (DELTA, DEGREE, RADIUS, TANGENT, LENGTH), SPIRAL CURVE DATA (ANGLE, DEGREE, ST, LT, LS), COORDINATES (X, Y), AZIMUTH. Rows include CLEVELAND AVE and points 1001-1050.

ALIGNMENT TABULATION

Table with columns: POINT NUMBER, POINT, STATION, CIRCULAR CURVE DATA (DELTA, DEGREE, RADIUS, TANGENT, LENGTH), SPIRAL CURVE DATA (ANGLE, DEGREE, ST, LT, LS), COORDINATES (X, Y), AZIMUTH. Rows include LARPEUTEUR AVE, SCUDDER ST, RTWALLO1, RTWALLO2, RTWALLO3 and points 1051-1501.

DESIGN TEAM table with columns: NO., BY, DATE, REVISIONS. Includes entries for TJC, WDJ, WCK.

I hereby certify that this plan was prepared by me or under my direct supervision and that I am a duly Licensed Professional Engineer under the laws of the State of Minnesota. Certified By: [Signature] Lic. No. [Number] Printed Name: [Name] Date: 4/2/2020



RAMSEY COUNTY, MINNESOTA CLEVELAND AVE (CSAH 46) RECONSTRUCTION

ALIGNMENT PLAN 62+00.00

SAP NO. CLEVELAND AVE 062-646-033 LARPEUTEUR AVE 062-630-072 69 207

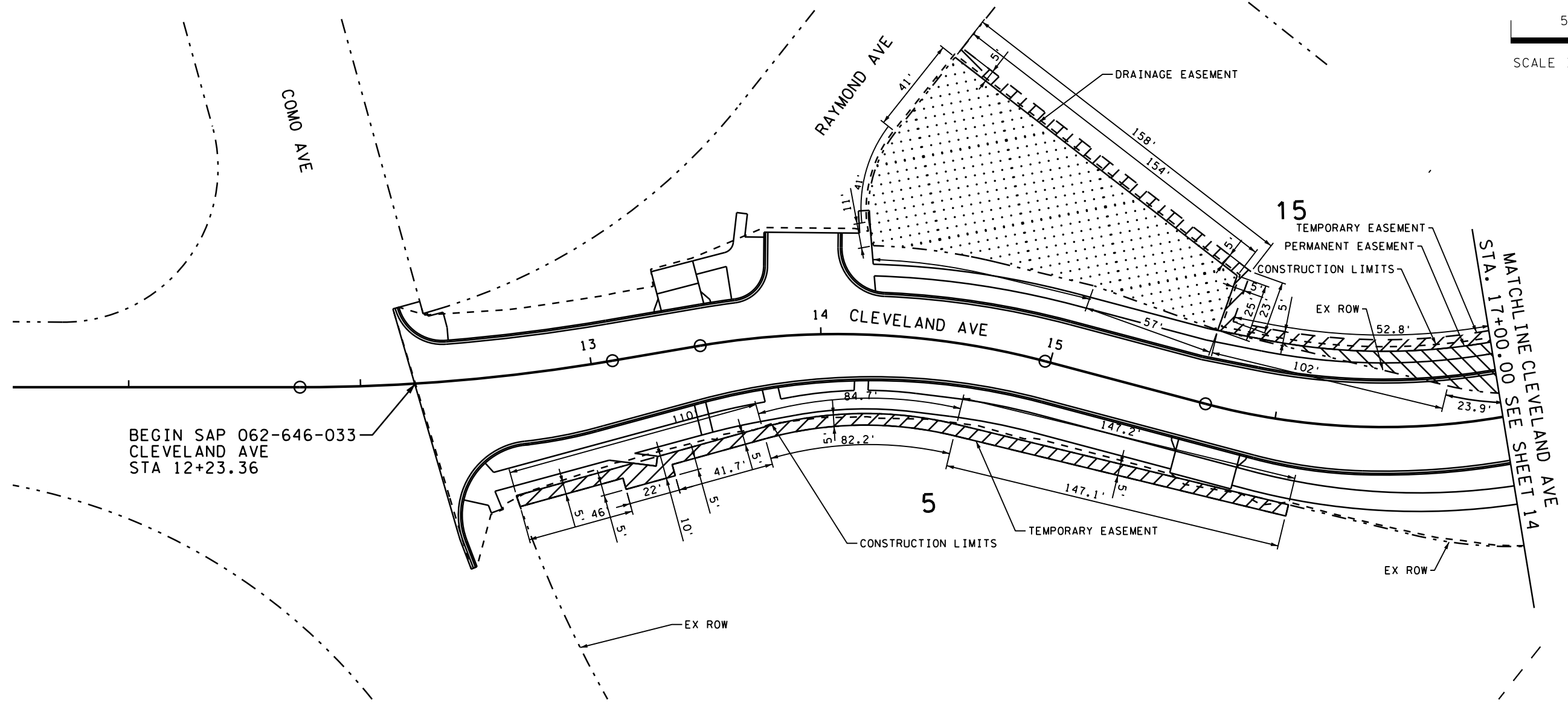
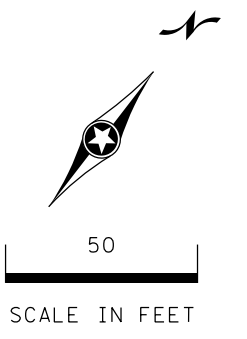

3:29:00 PM

4/2/2020

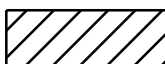

BEGIN SAP 062-646-033
 CLEVELAND AVE
 STA 12+23.36

LEGEND

-  PERMANENT EASEMENT
-  TEMPORARY EASEMENT
-  DRAINAGE EASEMENT

CD160553008.r.cw01.dgn

DESIGN TEAM			
DRAWN BY:	TJG		
DESIGNER:	WDJ		
CHECKED BY:	WCK		
NO.	BY	DATE	REVISIONS

I hereby certify that this plan was prepared by me or under my direct supervision and that I am a duly Licensed Professional Engineer under the laws of the State of Minnesota.

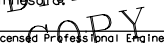
Certified By:  Lic. No. _____
 Printed Name: **COPY** Date: 4/2/2020



RAMSEY COUNTY, MINNESOTA
 CLEVELAND AVE (CSAH 46)
 RECONSTRUCTION

RIGHT OF WAY PLAN
 STA 12+23.36 TO STA 17+00.00

SAP NO.
 CLEVELAND AVE
 062-646-033
 LARPEUR AVE
 062-630-072

13
 24

3:29:01 PM

4/2/2020

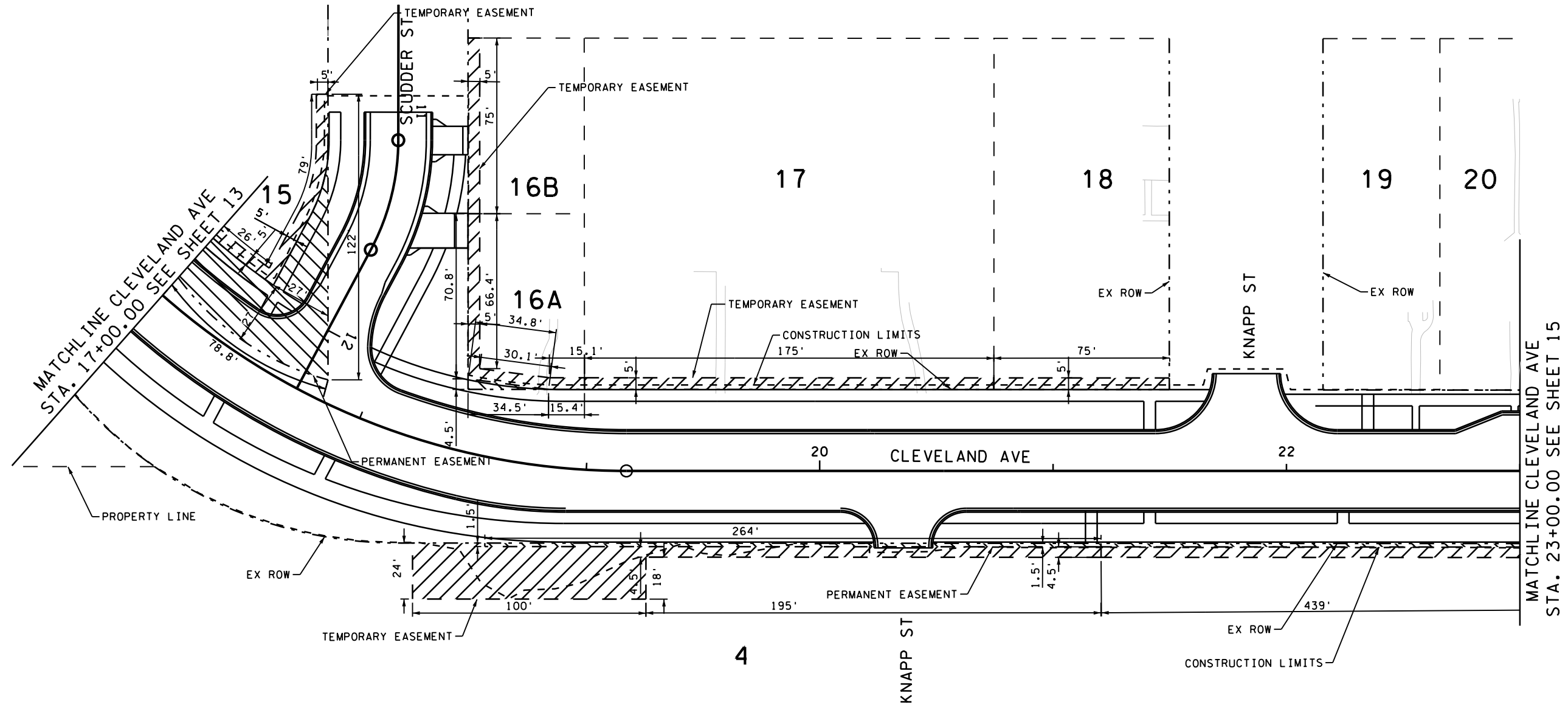

LEGEND

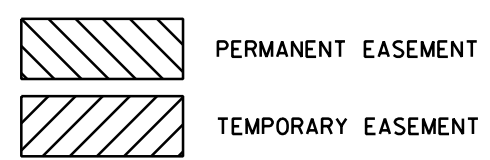

DESIGN TEAM				
DRAWN BY:	TJC			
DESIGNER:	WDJ			
CHECKED BY:	WCK			
	NO.	BY	DATE	REVISIONS

I hereby certify that this plan was prepared by me or under my direct supervision and that I am a duly Licensed Professional Engineer under the laws of the State of Minnesota.

Certified By: *[Signature]* Lic. No. _____
 Printed Name: *[Signature]* Date: 4/2/2020



RAMSEY COUNTY, MINNESOTA
 CLEVELAND AVE (CSAH 46)
 RECONSTRUCTION

RIGHT OF WAY PLAN
 STA 17+00.00 TO STA 23+00.00

SAP NO.
 CLEVELAND AVE
 062-646-033
 LARPEUR AVE
 062-630-072

14
 24

CD160553008_r.cw02.dgn

3:29:02 PM

4/2/2020

CD160553008_r.cw03.dgn

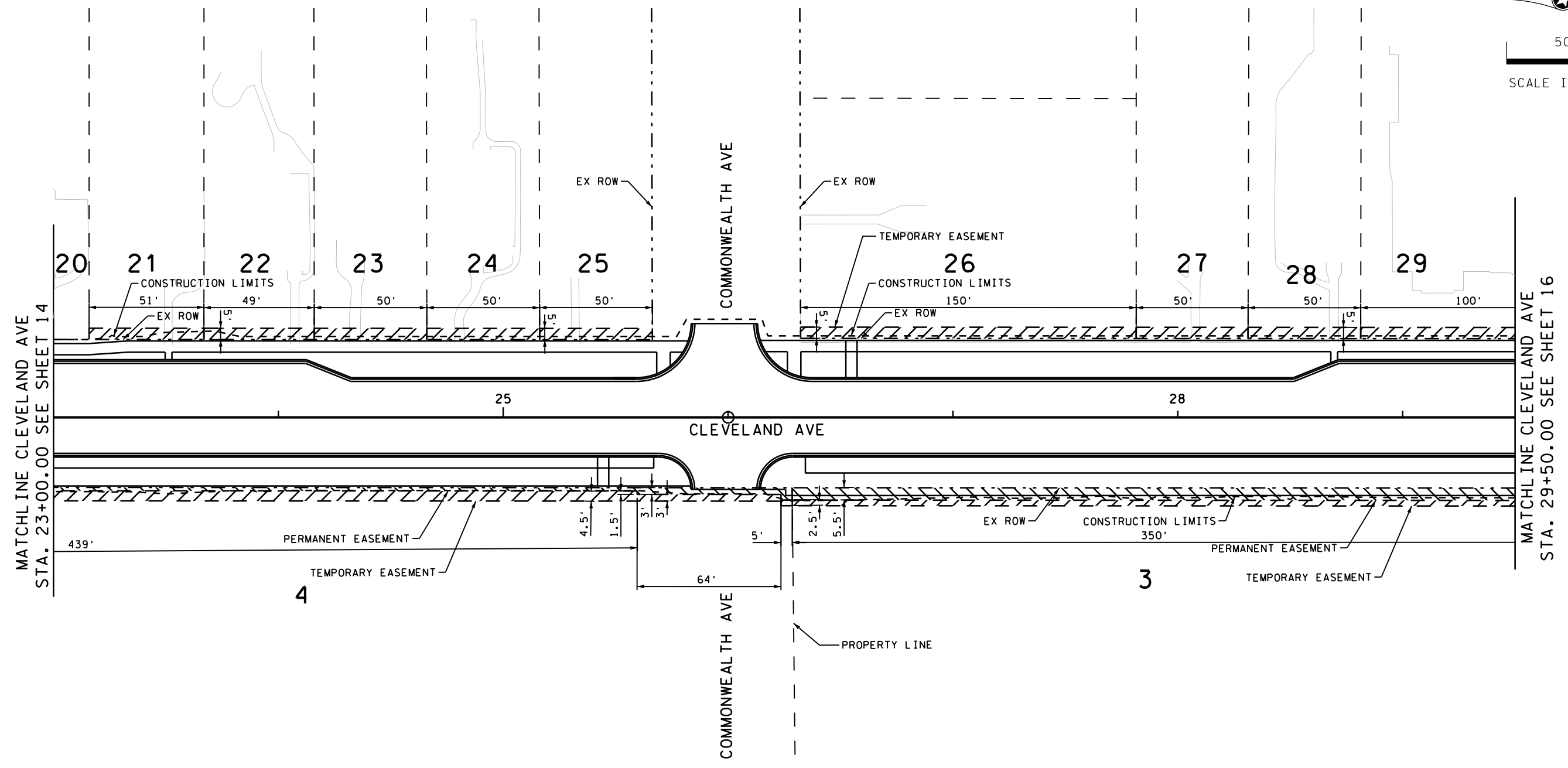
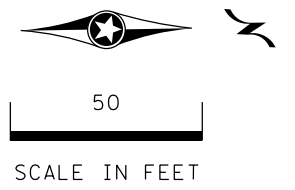

LEGEND

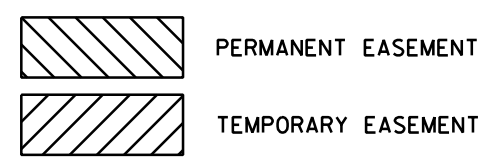

DESIGN TEAM				
DRAWN BY:	TJC			
DESIGNER:	WDJ			
CHECKED BY:	WCK			
	NO.	BY	DATE	REVISIONS

I hereby certify that this plan was prepared by me or under my direct supervision and that I am a duly Licensed Professional Engineer under the laws of the State of Minnesota.

Certified By: WCK Lic. No. _____
Printed Name: WCK Date: 4/2/2020



RAMSEY COUNTY, MINNESOTA
CLEVELAND AVE (CSAH 46)
RECONSTRUCTION

RIGHT OF WAY PLAN
STA 23+00.00 TO STA 29+50.00

SAP NO.
CLEVELAND AVE
062-646-033
LARPENTEUR AVE
062-630-072

15
24

3:29:03 PM

4/2/2020

CD160553008_r.crow05.dgn

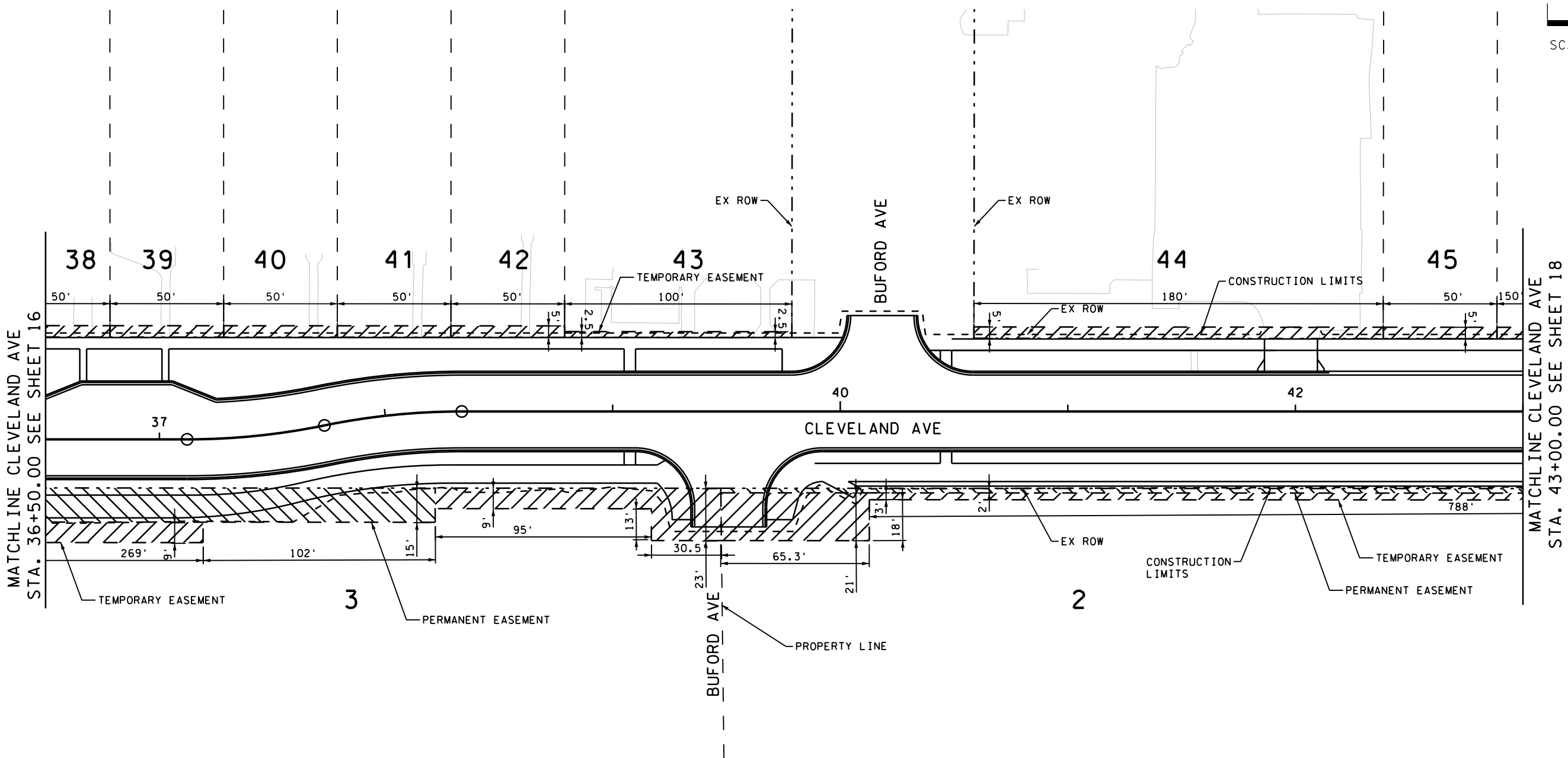
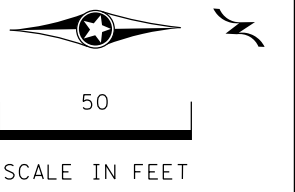

LEGEND

- PERMANENT EASEMENT
- TEMPORARY EASEMENT

DESIGN TEAM			
DRAWN BY:	TJC		
DESIGNER:	WDJ		
CHECKED BY:	WCK		
NO.	BY	DATE	REVISIONS

I hereby certify that this plan was prepared by me or under my direct supervision and that I am a duly Licensed Professional Engineer under the laws of the State of Minnesota.

Certified By: WCK Lic. No. _____
 Printed Name: WCK Date: 4/2/2020



RAMSEY COUNTY, MINNESOTA
 CLEVELAND AVE (CSAH 46)
 RECONSTRUCTION

RIGHT OF WAY PLAN
 STA 36+50.00 TO STA 43+00.00

SAP NO.
 CLEVELAND AVE
 062-646-033
 LARPEUR AVE
 062-630-072

17
 24

3:29:04 PM

4/2/2020

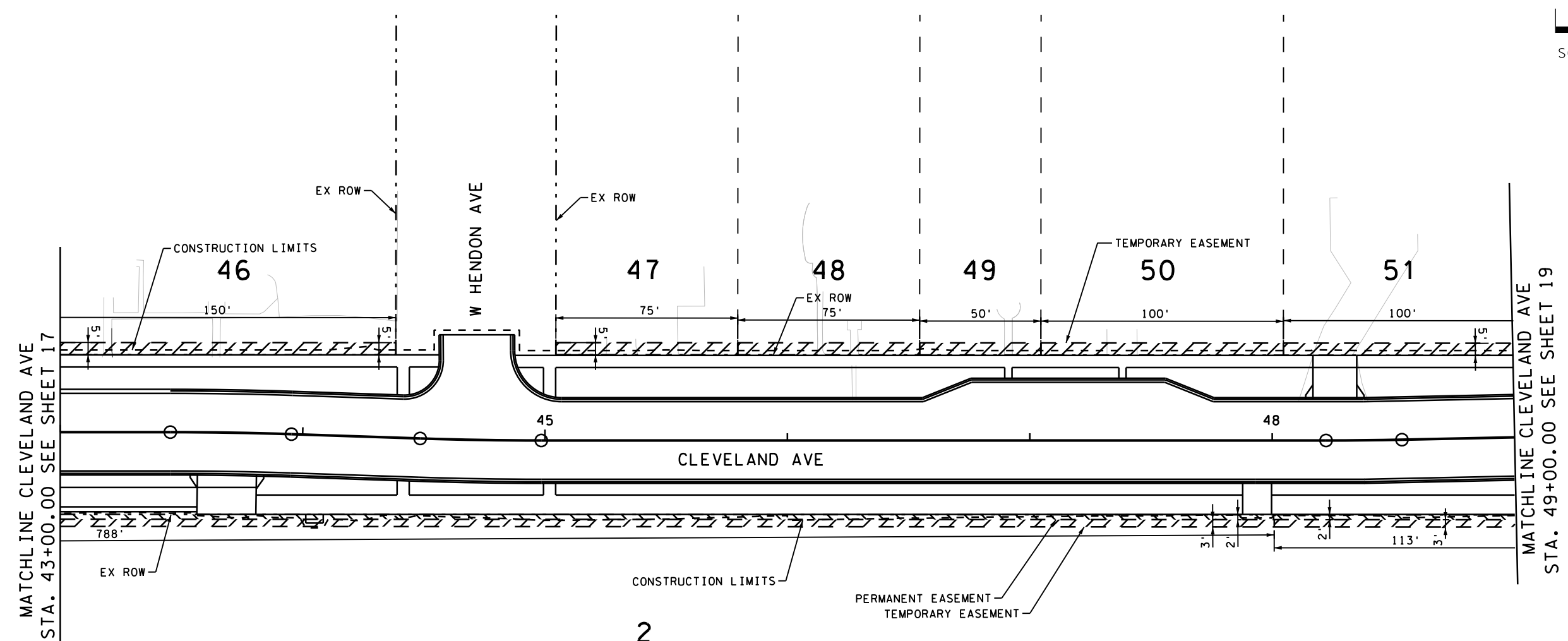
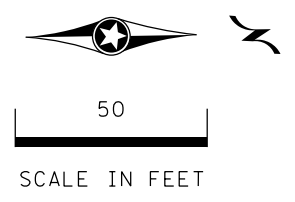

LEGEND

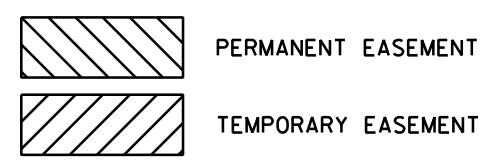

DESIGN TEAM				
DRAWN BY:	TJC			
DESIGNER:	WDJ			
CHECKED BY:	WCK			
	NO.	BY	DATE	REVISIONS

I hereby certify that this plan was prepared by me or under my direct supervision and that I am a duly Licensed Professional Engineer under the laws of the State of Minnesota.

Certified By: WCK Lic. No. _____
 Printed Name: WCK Date: 4/2/2020



RAMSEY COUNTY, MINNESOTA
 CLEVELAND AVE (CSAH 46)
 RECONSTRUCTION

RIGHT OF WAY PLAN
 STA 43+00.00 TO STA 49+00.00

SAP NO.
 CLEVELAND AVE
 062-646-033
 LARPENTEUR AVE
 062-630-072

18
 24

CD160553008_r.crow06.dgn

3:23:05 PM

4/2/2020

CD:\60553008_r.crow07.dgn

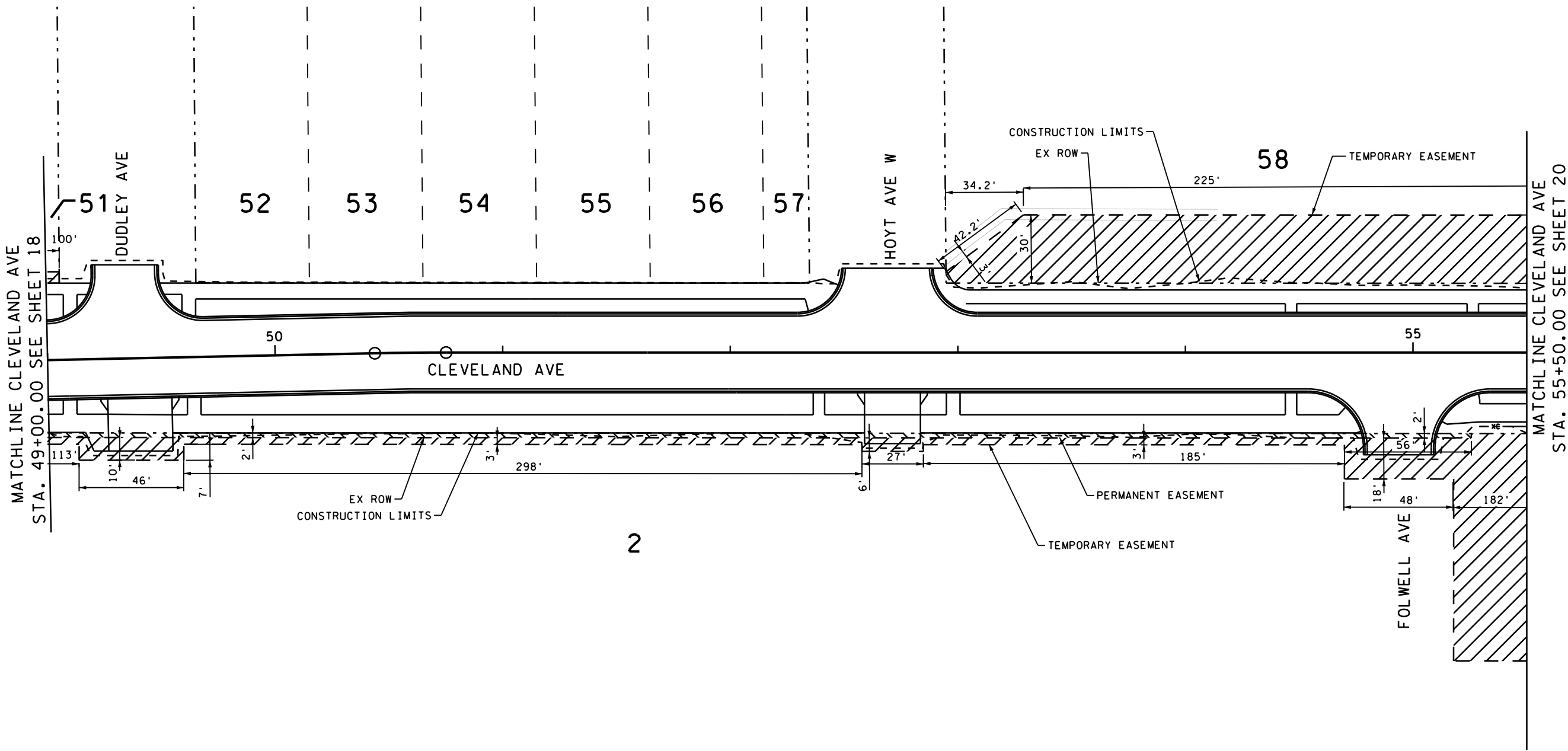
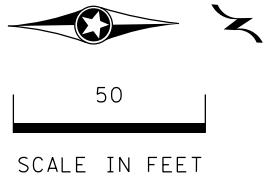

LEGEND

- PERMANENT EASEMENT
- TEMPORARY EASEMENT

DESIGN TEAM			
DRAWN BY:	TJG		
DESIGNER:	WDJ		
CHECKED BY:	WCK		
NO.	BY	DATE	REVISIONS

I hereby certify that this plan was prepared by me or under my direct supervision and that I am a duly Licensed Professional Engineer under the laws of the State of Minnesota.

Certified By: WCK Lic. No. _____
 Printed Name: WCK Date: 4/2/2020



RAMSEY COUNTY, MINNESOTA
 CLEVELAND AVE (CSAH 46)
 RECONSTRUCTION

RIGHT OF WAY PLAN
 STA 49+00.00 TO STA 55+50.00

SAP NO.
 CLEVELAND AVE
 062-646-033
 LARPENTEUR AVE
 062-630-072

19
24

3:29:05 PM

4/2/2020

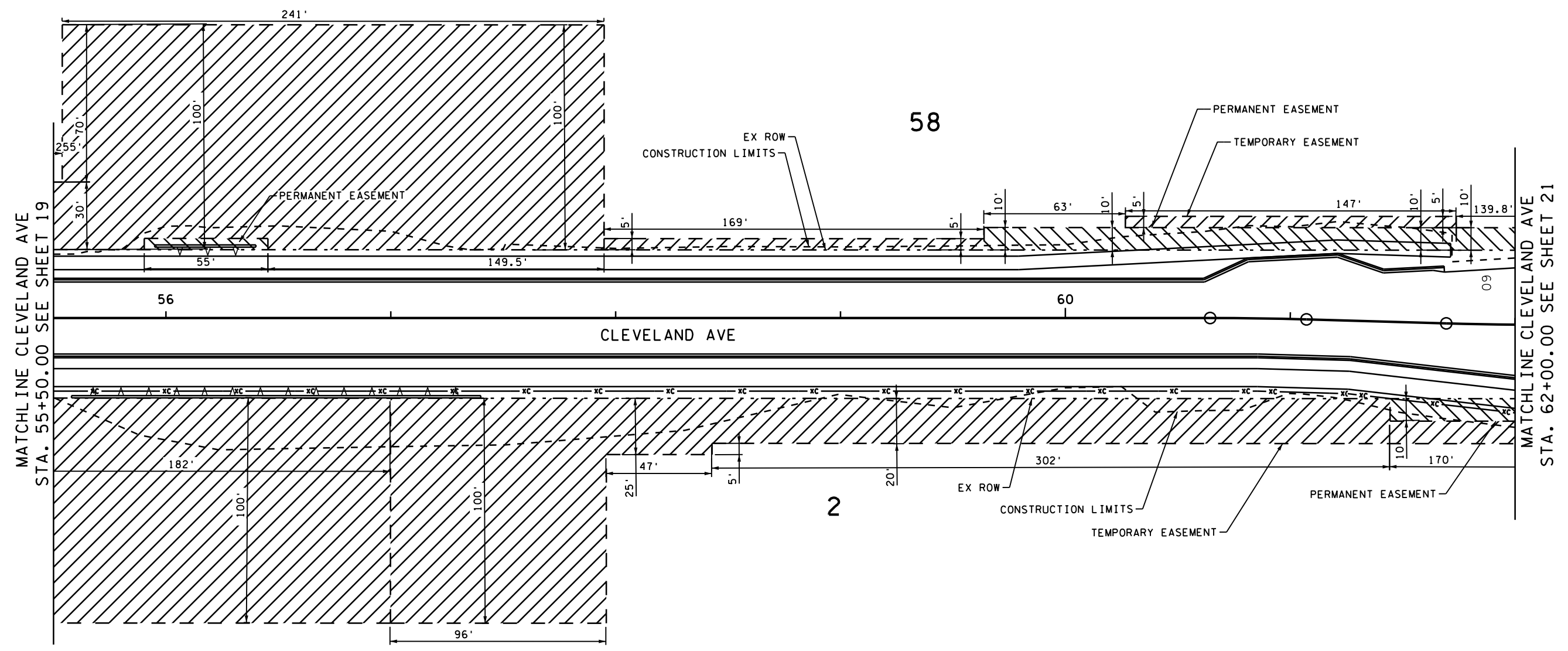
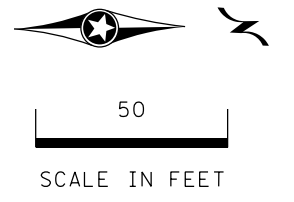

MATCHLINE CLEVELAND AVE
STA. 55+50.00 SEE SHEET 19

MATCHLINE CLEVELAND AVE
STA. 62+00.00 SEE SHEET 21

LEGEND

- PERMANENT EASEMENT
- TEMPORARY EASEMENT

DESIGN TEAM				
DRAWN BY:	TJG			
DESIGNER:	WDJ			
CHECKED BY:	WCK			
	NO.	BY	DATE	REVISIONS

I hereby certify that this plan was prepared by me or under my direct supervision and that I am a duly Licensed Professional Engineer under the laws of the State of Minnesota.
 Certified By: WCK Lic. No. _____
 Printed Name: WCK Date: 4/2/2020



RAMSEY COUNTY, MINNESOTA
 CLEVELAND AVE (CSAH 46)
 RECONSTRUCTION

RIGHT OF WAY PLAN
 STA 55+50.00 TO STA 62+00.00

SAP NO. CLEVELAND AVE 062-646-033 LARPEN TEUR AVE 062-630-072	20 24
---	----------

CD:160553008_r.crow08.dgn

3:29:06 PM

4/2/2020

CD:160553008_r.cw09.dgn

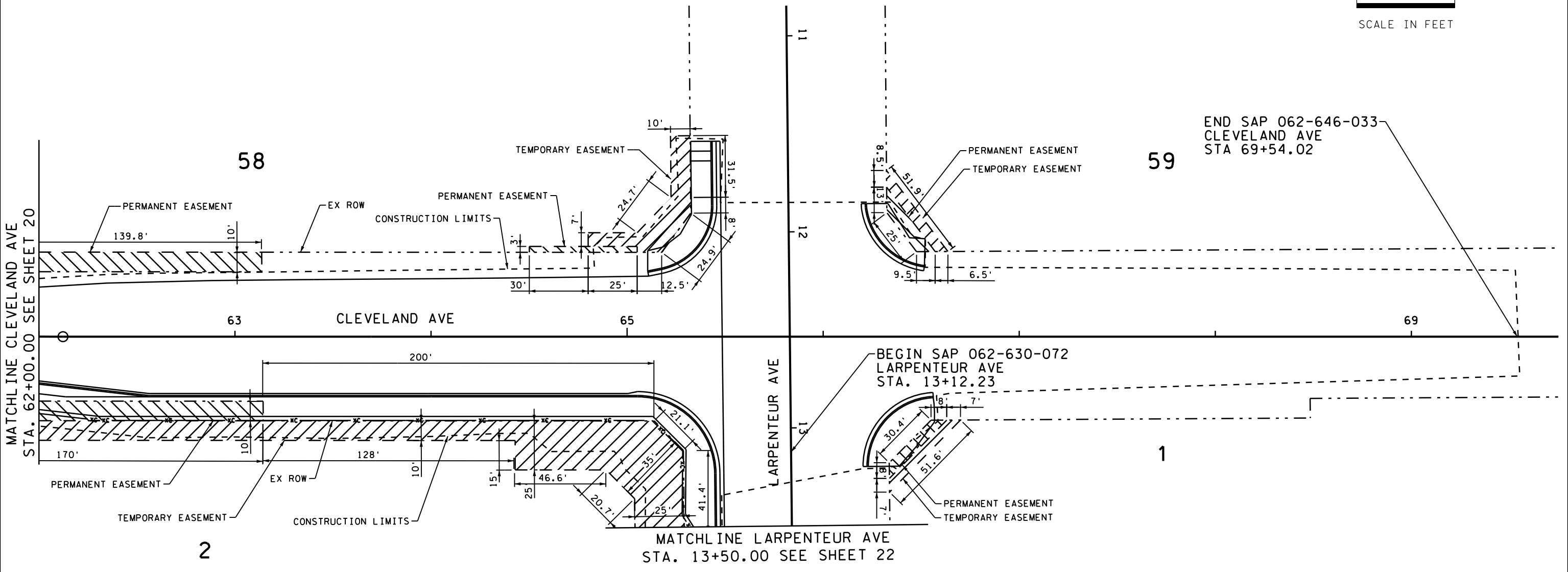
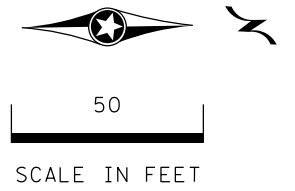

LEGEND

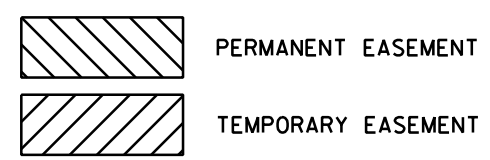

DESIGN TEAM			
DRAWN BY:	TJG		
DESIGNER:	WDJ		
CHECKED BY:	WCK		
NO.	BY	DATE	REVISIONS

I hereby certify that this plan was prepared by me or under my direct supervision and that I am a duly Licensed Professional Engineer under the laws of the State of Minnesota.

Certified By: WCK Lic. No. _____
 Printed Name: WCK Date: 4/2/2020



RAMSEY COUNTY, MINNESOTA
 CLEVELAND AVE (CSAH 46)
 RECONSTRUCTION

RIGHT OF WAY PLAN
 CLEVELAND AVE STA 62+00.00 TO STA 69+54.02
 LARPELTEUR AVE STA 11+86.49 TO STA 13+50.00

SAP NO.
 CLEVELAND AVE
 062-646-033
 LARPELTEUR AVE
 062-630-072

21
 24

3:29:07 PM

4/2/2020

CD160553008_r.cw10.dgn

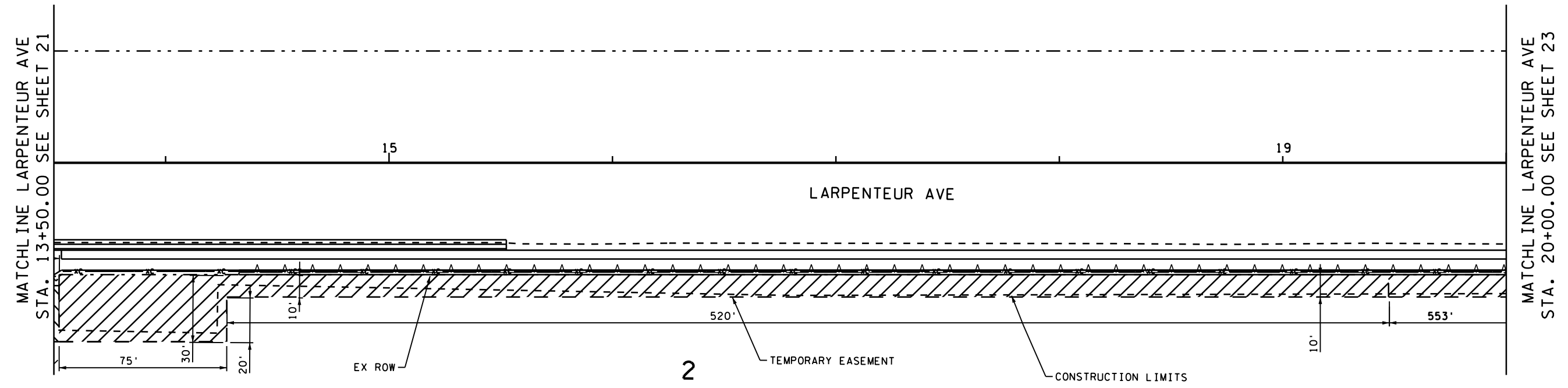
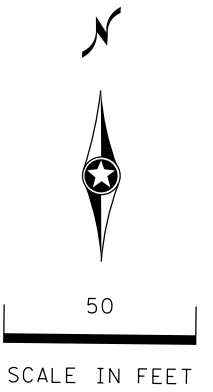

LEGEND

- PERMANENT EASEMENT
- TEMPORARY EASEMENT

DESIGN TEAM				
DRAWN BY:	TJC			
DESIGNER:	WDJ			
CHECKED BY:	WCK			
	NO.	BY	DATE	REVISIONS

I hereby certify that this plan was prepared by me or under my direct supervision and that I am a duly Licensed Professional Engineer under the laws of the State of Minnesota.

Certified By: WCK Lic. No. _____
 Printed Name: WCK Date: 4/2/2020



RAMSEY COUNTY, MINNESOTA
 CLEVELAND AVE (CSAH 46)
 RECONSTRUCTION

RIGHT OF WAY PLAN
 STA 13+50.00 TO STA 20+00.00

SAP NO.
 CLEVELAND AVE
 062-646-033
 LARPEUR AVE
 062-630-072

22
 24

3:29:07 PM

4/2/2020

CD160553008_row11.dgn



50

SCALE IN FEET

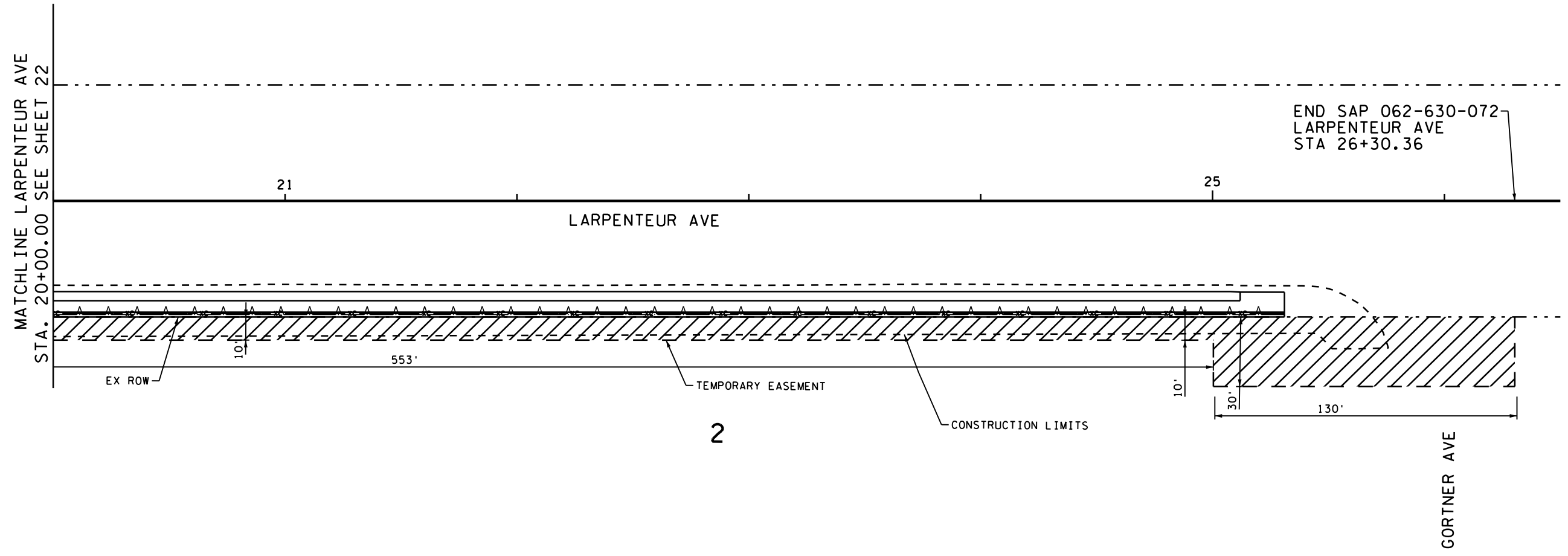

LEGEND

- PERMANENT EASEMENT
- TEMPORARY EASEMENT

DESIGN TEAM				
DRAWN BY:	TJC			
DESIGNER:	WDJ			
CHECKED BY:	WCK			
	NO.	BY	DATE	REVISIONS

I hereby certify that this plan was prepared by me or under my direct supervision and that I am a duly Licensed Professional Engineer under the laws of the State of Minnesota.

Certified By: WCK Lic. No. _____
 Printed Name: WCK Date: 4/2/2020



RAMSEY COUNTY, MINNESOTA
 CLEVELAND AVE (CSAH 46)
 RECONSTRUCTION

RIGHT OF WAY PLAN
 STA 20+00.00 TO STA 26+30.36

SAP NO.
 CLEVELAND AVE
 062-646-033
 LARPEUR AVE
 062-630-072

23
 24

PARCEL NO.	PARCEL ID NO.	PARCEL ADDRESS	OWNER	PARCEL SIZE (SQ FT)	PERMANENT EASEMENT (SQ FT)	TEMPORARY EASEMENT (SQ FT)	DRAINAGE EASEMENT (SQ FT)
1	162923320057	2050 ROSELAWN AVE	UNIVERSITY OF MINNESOTA	1766393	204	231	0
2	212923230002	2033 CLEVELAND AVE N	UNIVERSITY OF MINNESOTA	9740887	4855	64794	0
3	212923320001	0 CLEVELAND AVE N	REGENTS OF THE U OF M	821106	13883	8152	0
4	212923330001	1536 CLEVELAND AVE N	UNIVERSITY OF MINNESOTA	821106	1274	5354	0
5	202923440123	0 RAY PLACE	UNIVERSITY OF MINNESOTA	92304	0	1813	0
15	202923440122	1248 RAYMOND AVE	BOARD OF WATER COMM ST PAUL	37505	3443	2040	8557
16A	202923440063	1253 CLEVELAND AVE N	ERNEST B TROWER	3751	78	581	0
16B	202923440064	2075 SCUDDER ST	ERNEST B TROWER	3751	0	375	0
17	000000000000	1261-1269 CLEVELAND AVE N	CLEVELAND TERRACE APARTMENT OWNERS' ASSOCIATION	26250	0	875	0
18	202923440048	2066 KNAPP ST	JAMES WENGLER	11252	0	375	0
19	202923440042	1285 CLEVELAND AVE N	RICHARD W MOLSTAD	7501	0	0	0
20	202923440041	1289 CLEVELAND AVE N	ANDERS J MANTIUS	7501	0	0	0
21	202923440040	1295 CLEVELAND AVE N	RICHARD W BROWN	7649	0	255	0
22	202923440039	1299 CLEVELAND AVE N	TIA W SHORTRIDGE	7349	0	245	0
23	202923440038	1305 CLEVELAND AVE N	TIMOTHY J FULLER	7492	0	250	0
24	202923440037	1311 CLEVELAND AVE N	PHILIP THOMPSON	7501	0	250	0
25	202923440036	1315 CLEVELAND AVE N	ANDREAS MANTIUS	7501	0	250	0
26	202923410089	2065 COMMONWEALTH AVE	LARA M BOLLWEG	16052	0	750	0
27	202923410088	1337 CLEVELAND AVE N	MACLAURIN INSTITUTE	7501	0	250	0
28	202923410087	1343 CLEVELAND AVE N	JANET E CLOCKER	7501	0	250	0
29	202923410086	2060 CARTER AVE	LAMBDA ALUMNI CORPORATION	15002	0	500	0
30	202923410066	2067 CARTER AVE	ALUM BETA CHAPTER OF CLOVIA	7501	0	250	0
31	202923410065	1361 CLEVELAND AVE N	DENIEL D SCHERER	7501	0	250	0
32	202923410064	1369 CLEVELAND AVE N	LONIO CHAN	7501	0	250	0
33	202923410063	1375 CLEVELAND AVE N	PEGGY A DAHL	9017	0	0	0
34	202923410062	1381 CLEVELAND AVE N	LAMBDA DELTA PHI CORPORATION	13504	0	450	0
35	202923410061	1387 CLEVELAND AVE N	4820 HOLDINGS LLC	7492	0	250	0
36	202923410060	1393 CLEVELAND AVE N	INDEPENDENT MENS COOP	7549	0	250	0
37	202923410059	1403 CLEVELAND AVE N	MINNESOTA STUDENTS COOP INC	10999	0	500	0
38	202923410052	1407 CLEVELAND AVE N	HOSPITALITY CENTER FOR CHINESE	7501	0	250	0
39	202923410053	1415 CLEVELAND AVE N	DAVID M DALY	7492	0	250	0
40	202923410054	1421 CLEVELAND AVE N	REITZEL PROPERTIES LLC	7501	0	250	0
41	202923410055	1425 CLEVELAND AVE N	AVA MARIE MAYERS	7501	0	250	0
42	202923410056	1429 CLEVELAND AVE N	PAR REI LLC	7492	0	250	0
43	202923410057	1435 CLEVELAND AVE N	MAHMOUD SHAHIN	14985	0	250	0
44	202923140117	1445 CLEVELAND AVE N	AWH HOLDINGS LLC	26998	0	900	0
45	202923140116	1465 CLEVELAND AVE N	AWH HOLDINGS LLC	2579	0	250	0
46	202923140151	1469 CLEVELAND AVE N	MINNESOTA STUDENTS COOP INC	7492	0	750	0
47	202923140073	1485 CLEVELAND AVE N	DELTA THETA SIGMA INC	11252	0	375	0
48	202923140072	1495 CLEVELAND AVE N	DELTA THETA SIGMA INC	11252	0	375	0
49	202923140071	1499 CLEVELAND AVE N	JERRE LEE	7501	0	250	0
50	202923140070	1505 CLEVELAND AVE N	MINNESOTA FARMHOUSE ASSN INC	14985	0	500	0
51	202923140069	1515 CLEVELAND AVE N	BOARD OF WATER COMM ST PAUL	15002	0	500	0
52	202923140136	0 CLEVELAND AVE N	UNIVERSITY OF MINNESOTA	6451	0	0	0
53	202923140135	0 CLEVELAND AVE N	UNIVERSITY OF MINNESOTA	6451	0	0	0
54	202923140134	0 CLEVELAND AVE N	UNIVERSITY OF MINNESOTA	6451	0	0	0
55	202923140133	0 CLEVELAND AVE N	UNIVERSITY OF MINNESOTA	6451	0	0	0
56	202923140002	0 CLEVELAND AVE N	UNIVERSITY OF MINNESOTA	6451	0	0	0
57	202923140001	0 CLEVELAND AVE N	UNIVERSITY OF MINNESOTA	2579	0	0	0
58	202923110239	2100 LARPEN TEUR AVE W	UNIVERSITY OF MINNESOTA	1478688	3938	33701	0
59	172923440008	0 UNASSIGNED	COUNTY OF RAMSEY HISTORICAL SC	298386	254	239	0

DESIGN TEAM				
DRAWN BY:	TJC			
DESIGNER:	WDJ			
CHECKED BY:	WCK			
NO.	BY	DATE	REVISIONS	

I hereby certify that this plan was prepared by me or under my direct supervision and that I am a duly Licensed Professional Engineer under the laws of the State of Minnesota.

Certified By: WCK Lic. No. _____
 Printed Name: WCK Date: 4/2/2020



RAMSEY COUNTY, MINNESOTA
 CLEVELAND AVE (CSAH 46)
 RECONSTRUCTION

RIGHT OF WAY PLAN

SAP NO.
 CLEVELAND AVE
 062-646-033
 LARPEN TEUR AVE
 062-630-072

24
 24