

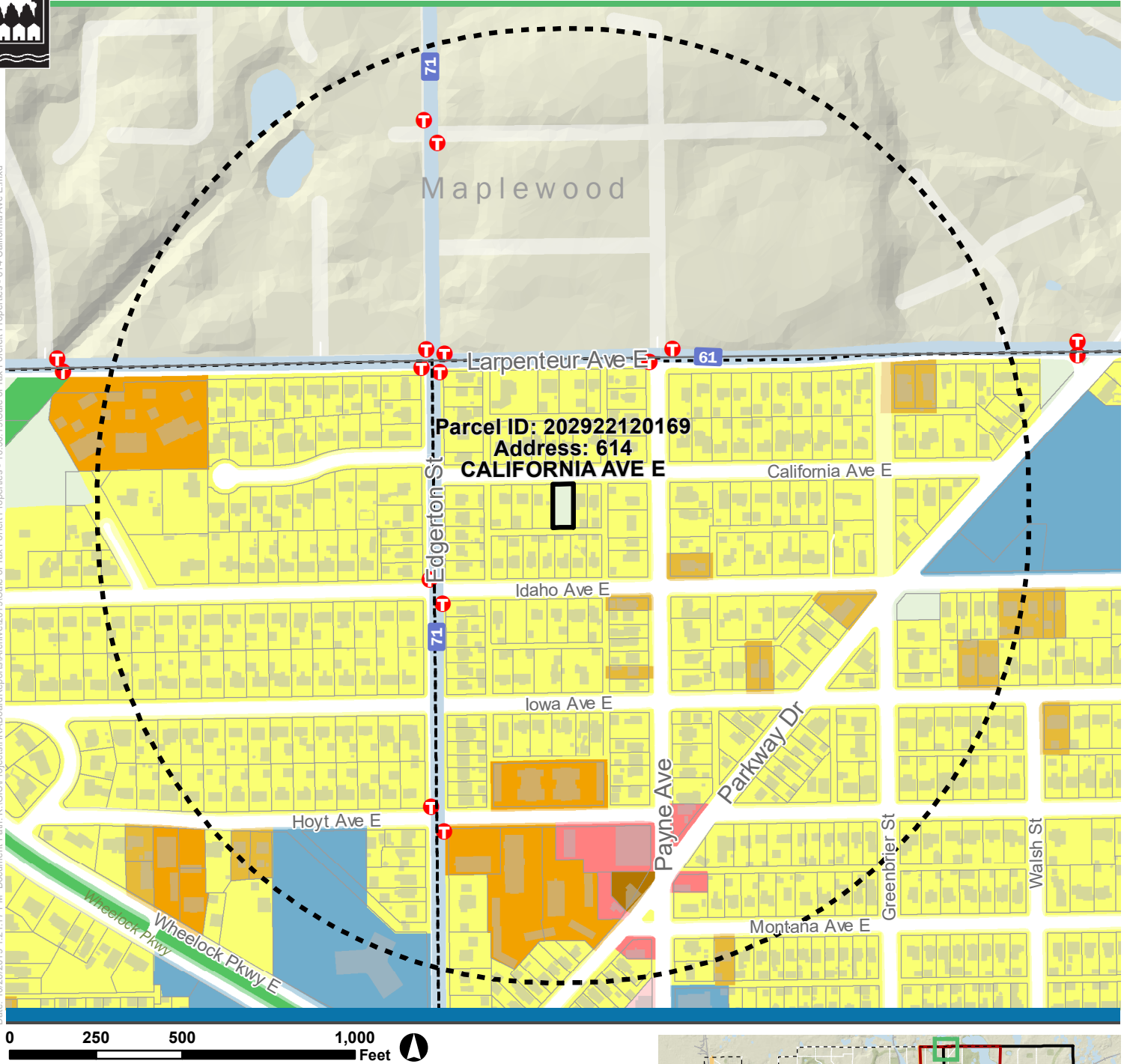

Saint Paul Housing & Redevelopment Authority

# Sale of Tax Forfeit Property - 614 California Ave E

Date: 10/28/2019 12:17 PM Document Path: K:\GIS\Projects\HRA\BoardReports\Archive\2019\Sale of Tax Forfeit Properties - 10-30-19\Sale of Tax Forfeit Properties - 614 California Ave E.mxd



## Current Land Use

- Single Family Detached
- Single Family Attached
- Multifamily
- Office
- Retail and Other Commercial
- Mixed Use Residential
- Institutional
- Park, Recreational or Preserve
- Undeveloped

- Subject Parcel
- Quarter Mile Distance
- Bus Routes
- Bus Stops

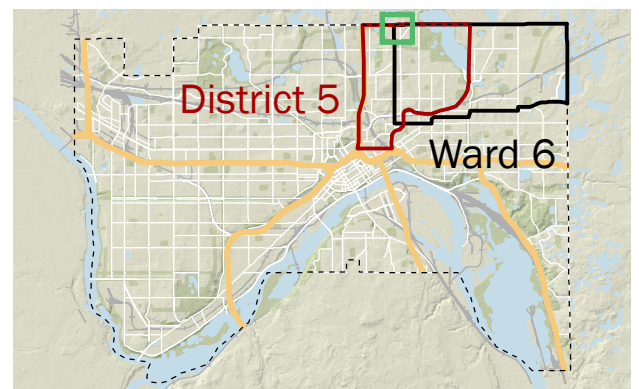

This document was prepared by the Saint Paul Planning and Economic Development Department and is intended to be used for reference and illustrative purposes only. This drawing is not a legally recorded plan, survey, official tax map or engineering schematic and is not intended to be used as such. Data sources: City of Saint Paul (Parks, Street Centerlines, Libraries, Rec Centers); Ramsey County (Street Outlines, Building Footprints, Parcels); Minnesota Geospatial Commons (Hydrography, Highways, Transit Lines and Stops, and Topography)



# Sale of Tax Forfeit Property - 896 Cottage Ave E



## Current Land Use

- Single Family Detached
- Single Family Attached
- Multifamily
- Office
- Retail and Other Commercial
- Mixed Use Residential
- Institutional
- Park, Recreational or Preserve
- Golf Course
- Undeveloped

- Subject Parcel
- Quarter Mile Distance
- Bus Routes
- Bus Stops
- Recreation Centers
- Schools

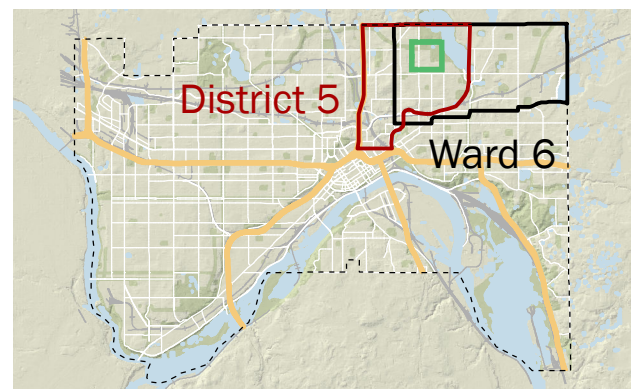

This document was prepared by the Saint Paul Planning and Economic Development Department and is intended to be used for reference and illustrative purposes only. This drawing is not a legally recorded plan, survey, official tax map or engineering schematic and is not intended to be used as such. Data sources: City of Saint Paul (Parks, Street Centerlines, Libraries, Rec Centers); Ramsey County (Street Outlines, Building Footprints, Parcels); Minnesota Geospatial Commons (Hydrography, Highways, Transit Lines and Stops, and Topography)



Saint Paul Housing & Redevelopment Authority

# Sale of Tax Forfeit Property - 282 Wyoming St

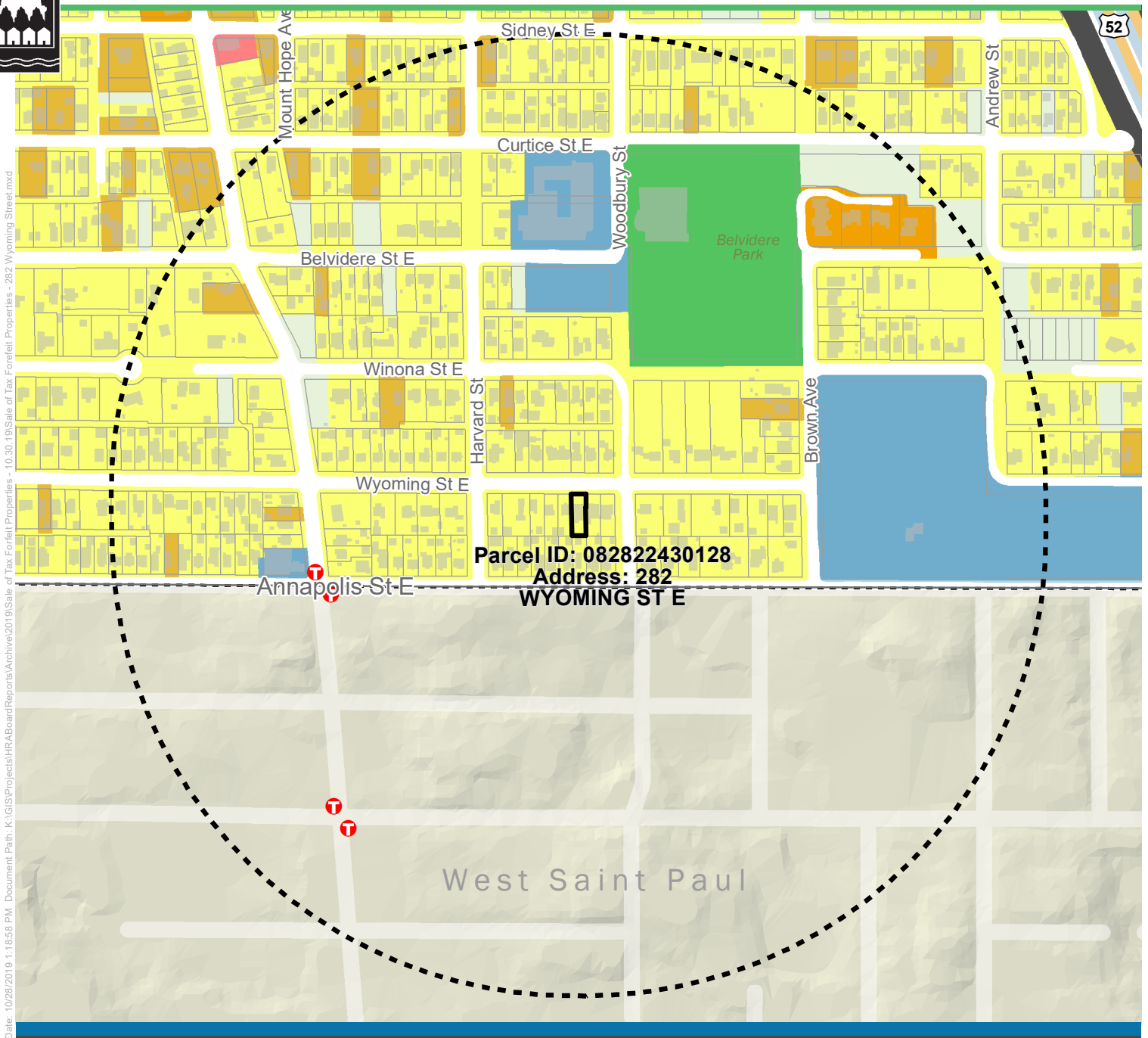

Date: 10/28/2019 1:19:59 PM Document Path: K:\GIS\Projects\HRA\BoardReports\Archive\2019\Sale of Tax Forfeit Properties - 10.30.19\Sale of Tax Forfeit Properties - 282 Wyoming Street.mxd

0 250 500 1,000 Feet



## Current Land Use

- Single Family Detached
- Single Family Attached
- Multifamily
- Retail and Other Commercial
- Institutional
- Park, Recreational or Preserve
- Major Highway
- Agricultural
- Undeveloped

- Subject Parcel
- Quarter Mile Distance
- Bus Routes
- Bus Stops



This document was prepared by the Saint Paul Planning and Economic Development Department and is intended to be used for reference and illustrative purposes only. This drawing is not a legally recorded plan, survey, official tax map or engineering schematic and is not intended to be used as such. Data sources: City of Saint Paul (Parks, Street Centerlines, Libraries, Rec Centers); Ramsey County (Street Outlines, Building Footprints, Parcels); Minnesota Geospatial Commons (Hydrography, Highways, Transit Lines and Stops, and Topography)