



APPLICATION FOR APPEAL

Saint Paul City Council – Legislative Hearings

310 City Hall, 15 W. Kellogg Blvd.
Saint Paul, Minnesota 55102
Telephone: (651) 266-8585

RECEIVED
MAY 12 2016
CITY CLERK

We need the following to process your appeal:

- \$25 filing fee payable to the City of Saint Paul (if cash: receipt number _____)
 - Copy of the City-issued orders/letter being appealed
 - Attachments you may wish to include
 - This appeal form completed
 - Walk-In OR Mail-In
- for abatement orders only: Email OR Fax

HEARING DATE & TIME
(provided by Legislative Hearing Office)
Tuesday, May 17
Time 2:30 p.m.
Location of Hearing:
Room 330 City Hall/Courthouse

Address Being Appealed:

Number & Street: 565 Arlington Ave W. City: St Paul State: MIN Zip: 55117
 Appellant/Applicant: Owen Masonry Email: Kay @ Omasonry.com
 Phone Numbers: Business: 612-817-9439 Residence: same Cell: same
 Signature: [Handwritten Signature] Date: 5/9/16
 Name of Owner (if other than Appellant): Michelle Wessely & Tim Mick
 Mailing Address if Not Appellant's: 565 Arlington Ave W St Paul MN 55117
 Phone Numbers: Business: 651-328-7312 Residence: same Cell: same

What Is Being Appealed and Why? *Attachments Are Acceptable*

- Vacate Order/Condemnation/Revocation of Fire C of O
- Summary/Vehicle Abatement
- Fire C of O Deficiency List
- Code Enforcement Correction Notice
- Vacant Building Registration
- Other

Request for fence variance.
See attached.



CITY OF SAINT PAUL.
Christopher B. Coleman, Mayor

375 Jackson Street, Suite 220
Saint Paul, Minnesota 55101-1806

Telephone: 651-266-8989
Facsimile: 651-266-9124
Web: www.stpaul.gov/idsi

REQUEST FOR FENCE VARIANCE
\$70.00 PER FENCE VARIANCE
(Fees EIL: 01/01/2009)

Folder #

ADDRESS OF VARIANCE: 565 ARLINGTON AVE W
OWNER ADDRESS: 565 ARLINGTON AVE W CONTRACTOR ADDRESS: 2210 E 36th ST
CITY ST PAUL STATE MINN ZIP _____ CITY MINNEAPOLIS STATE MINN ZIP 55407
PHONE W/AREA CODE 651-487-2429 PHONE W/AREA CODE 612-812-9639
FAX W/AREA CODE N/A FAX W/AREA CODE N/A

FENCE DETAILS REQUIRED (A site plan indicating the location of the fence must be provided with this application)

Proposed length of fence (total linear feet) Length of Fence: <u>130</u>	Proposed height of fence Feet: <u>4</u> Inches: <u>0</u>	Will the fence be erected on a corner lot? Yes <input checked="" type="checkbox"/> No <input type="checkbox"/>
Type of Fence: _____ Non-Obscuring Fence _____ Privacy Fence _____ Barbed Wire Fence	Type of Fence: _____ Non-Obscuring Fence <input checked="" type="checkbox"/> Privacy Fence _____ Barbed Wire Fence	
Fence Location: _____	Fence Location: <input checked="" type="checkbox"/> Perimeter of Entire Yard _____ Front Yard Only _____ Rear or Side Yard Only	

Sec. 33.07. Fences--Requirements.
Variances: A variance of the fence height regulations may be granted if, after investigation by the building official, it is found that site, or terrain, or nuisance animal conditions warrant a waiver of the height restrictions.

The property on which the fence is proposed satisfies the variance criteria (underlined in preceding text) for the following reason(s):
Check at least one item below and state the reason(s) you believe the property qualifies for variance consideration
 SITE CONDITIONS TERRAIN CONDITIONS NUISANCE ANIMAL CONDITIONS

REASON FOR VARIANCE REQUEST:
SEE ATTACHED SHEET.

INSPECTOR'S OBSERVATIONS: _____
Office Use Only Below This Line

INSPECTOR'S NAME: _____ Phone: 651- _____

APPROVED Date: _____ Building Official: _____ Phone: 651- _____
DENIED (This decision may be appealed to the legislative hearing officer by calling 651-266-8560.)

RETURN SIGNED RECOMMENDATION TO: _____ AT THE FRONT COUNTER.

PAYMENT CAN BE MADE BY CREDIT CARD

ACCOUNT NUMBER	MasterCard/Visa/Discovery/American Express	EXPIRATION DATE
4 2 5 9 0 8 0 0 0 1 0 1 2 6 4 2		month: 12 year: 17

Signature of Card Holder (required for all charges): [Signature] DATE: 2/2/2016

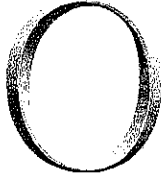

Memo

OWEN MASONRY

January 24, 2016

Owen Masonry requests a fence height variance to allow 4' instead of 2' (per fence requirements sec. 33.07 B) at the corner of Kent Street and Arlington Avenue West.

- 1) **Site Conditions.** The existing property grade level at the corner is 1' 8" above sidewalk level. A 2' fence would only extend 4" above yard grade.
- 2) **Terrain Conditions.** The wall is to the right of a driver turning right onto Arlington Ave W., the view of oncoming traffic is to the left. When turning left, the view to the right is already somewhat obstructed by large vehicles frequently parked on Arlington Ave W.
- 3) **Nuisance Conditions.** One of the reasons for inclosing the yard is to prevent people and pets from walking across the corners of the yard. This has caused considerable distress to the owner who is an avid gardener. The yard is currently designated as a monarch butterfly way station. The enclosure and security of the yard is important to the owner as she has two small children and her eyesight is compromised by a brain tumor.

Owen Masonry, LLC | MN LIC #BC667963
2210 E. 36 1/2 Street, Minneapolis, MN 55407
612.817.9439 | kay@omasonry.com | omasonry.com

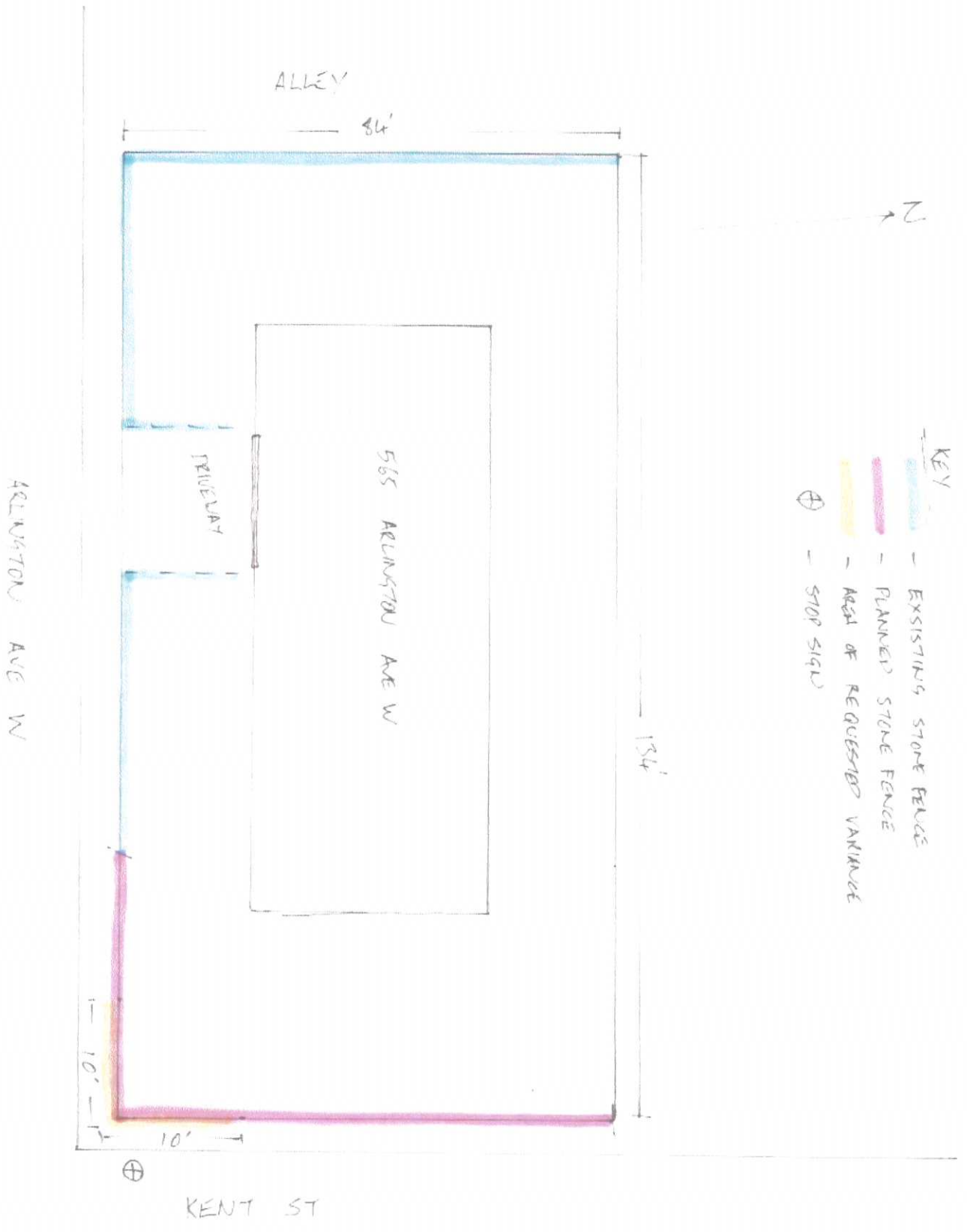

1