



301 YORK AVENUE
ST PAUL, MN 55130
PHONE: 651-558-3300

INVOICE
SP003380

BILL TO CYNDIC I
1955 UNIVERSITY AVE W
SAINT PAUL, MN 55104-3482

JOB SITE STATION 4 BLDG
201 4TH ST E
SAINT PAUL, MN 55101-1603

Customer PO	Astea Reference No.	Our Job Number	Invoice Date	Customer No.	Terms
	SV1502240161@@@1	260053	03-03-15	93232	NET 30

Nature of the Call: PIPED NEW COMPRESSOR RESET DRY VALVE. DRAINED ALL KNOWN LOW POINTS WORK REQUESTED BY ALLEN PETERSON (C) 651.248.9926, (O) 651.487.2133

Sales Person: Katie O'Donnell

Invoiced as per work performed

DESCRIPTION	AMOUNT
FLAT RATE CHARGE	745.00

NEED AN INSPECTION ON YOUR FIRE SPRINKLER SYSTEM, CALL US AT 651-558-3300.

compressor in bldg failed and it went wet -

TO PAY BY CREDIT CARD, PLEASE COMPLETE THE FOLLOWING AND FAX TO 651-558-3310, ATTENTION DIANNE.

CHECK ONE: VISA _____ MASTERCARD _____ AMEX _____

NAME ON CARD: _____ SECURITY CODE _____

ACCOUNT #: _____

SIGNATURE: _____ EXP DATE _____

IF YOU HAVE ANY QUESTIONS REGARDING THE CREDIT CARD PROCESS PLEASE CALL 651-558-3271

FINANCE CHARGES OF 1% PER MONTH, ANNUAL RATE OF 12% IS CHARGED ON ALL LATE PAYMENTS.

PLEASE REMIT TO:

VIKING AUTOMATIC SPRINKLER CO.
PO BOX 6424
ST. PAUL, MN 55106

Pay This Amount  745.00

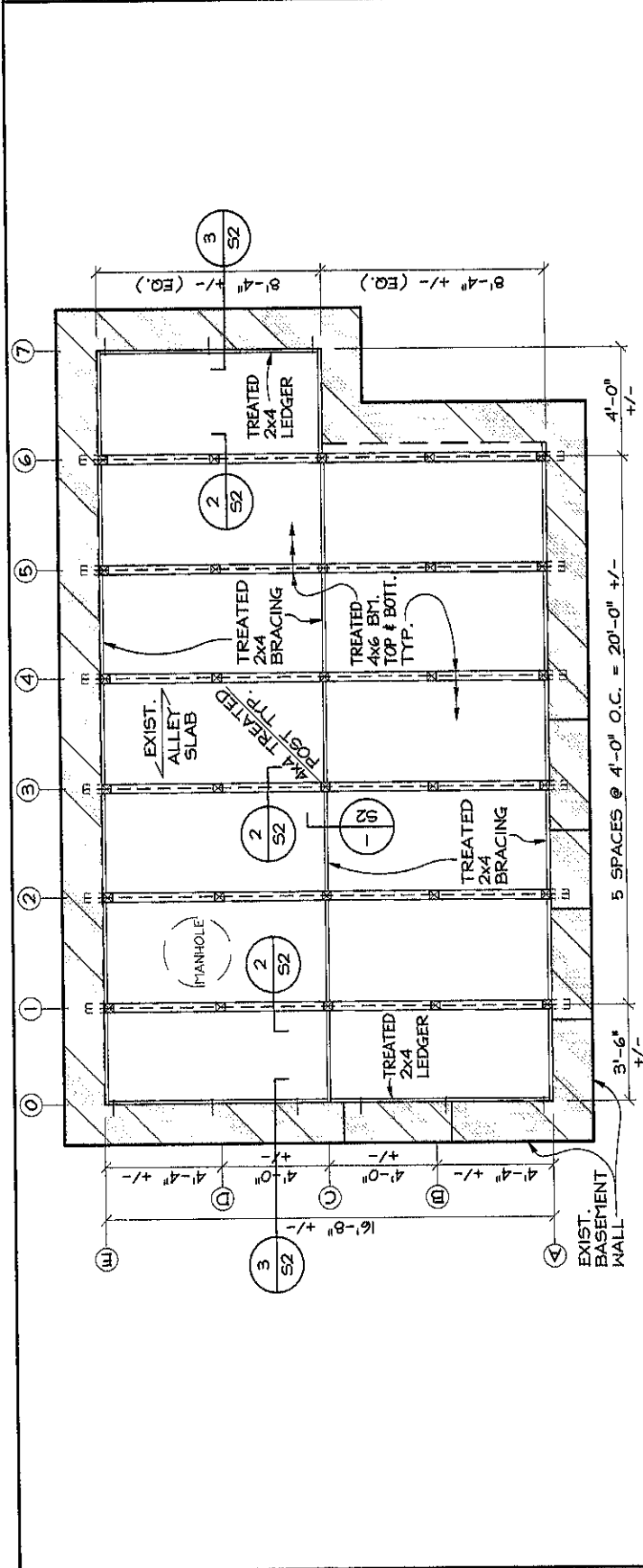

ALLEY SLAB FRAMING PLAN
 1/4" = 1'-0"



NOTES:

1. VERIFY ALL DIMENSIONS & CONDITIONS NOTIFY STRUCTURAL ENGINEER OF ANY DISCREPANCIES.
2. TREATED LUMBER SHALL BE SPF #2 OR BETTER

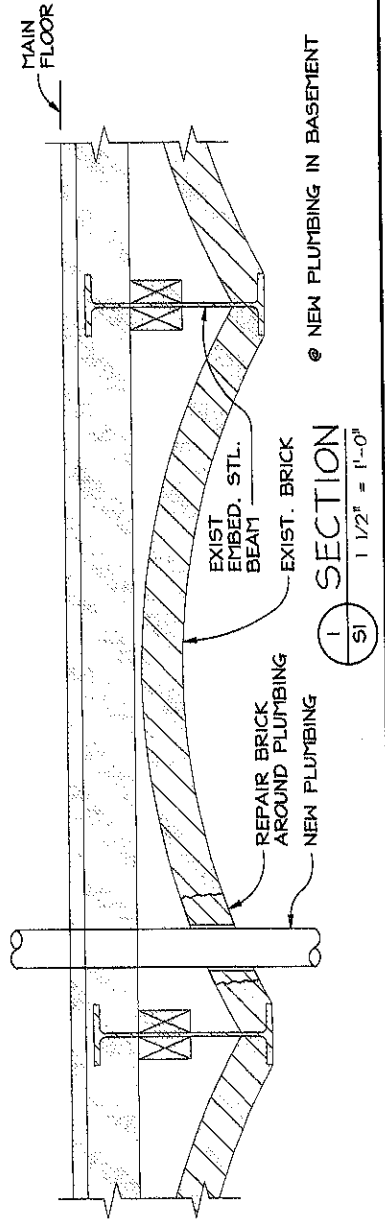

SECTION 1
 1 1/2" = 1'-0"

DARG BOLGREN, MEK & CO.
 CONSULTING STRUCTURAL ENGINEERS
 2755 GOLDEN VALLEY ROAD, SUITE 210
 GOLDEN VALLEY, MINNESOTA 55427
 (763) 544-8456 FAX (763) 544-8914
 e-mail: info@dargbolgren-inc.com www.dargbolgren-inc.com

STATE OF MINNESOTA
 DATE _____ REG. NO. _____
 I HEREBY CERTIFY THAT THIS PLAN
 OR UNDER MY DIRECT SUPERVISION AND THAT I AM
 A DULY LICENSED ENGINEER UNDER THE LAWS
 OF THE STATE OF MINNESOTA
 Progress set

ALLEY SLAB REINFC
 209 E. 45TH ST.
 SAINT PAUL, MINNESOTA
 SECTIONS & DETAILS
 CHECKED BY HDM
 DBM 15-049
 COMMISSION NUMBER
 DATE 6-1-2015
 DRAWN BY DWU

SHEET NUMBER
S2
 OF 2

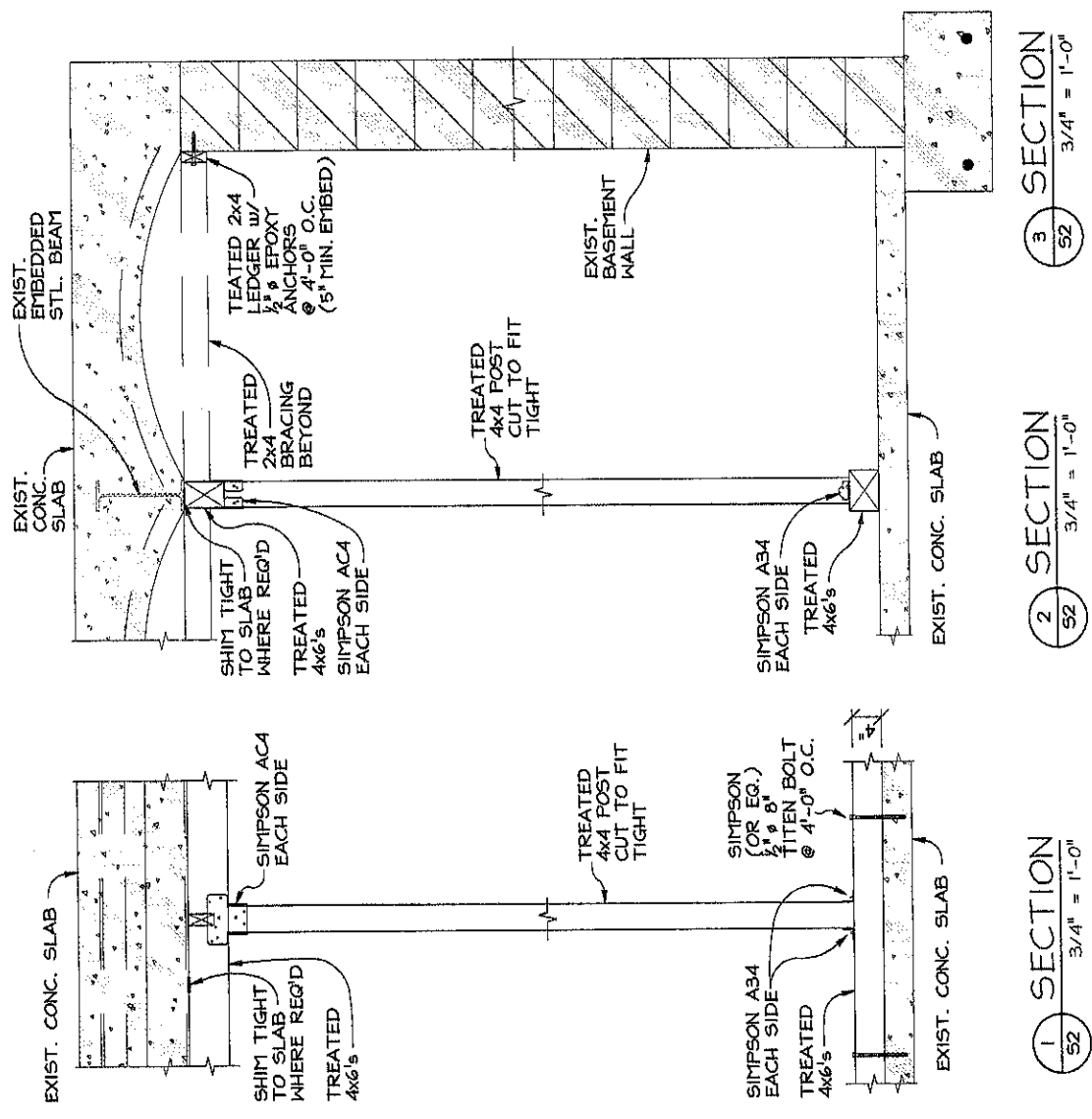

June 8, 2015

Alan Peterson
The Management Matrix
1955 University Ave. W.
St. Paul, MN 55104

Re: Alley Slab Reinforcement at 209 E. 4th St.
St. Paul, MN

Dear Mr. Peterson:

At your request, I traveled to 209 E. 4th St. in St. Paul on Thursday, 5/28/15 to observe rusted steel beams supporting the alley slab on the north side of the building.

There is basement space under the subject alley slab, which is concrete slab supported on steel beams embedded in brick arches. The basement walls are masonry.

The steel beams supporting the alley slab have considerable rust that has resulted in lost section and capacity. Two options were discussed; removal and replacement or temporary shoring. After some discussion, it was agreed to provide temporary shoring with green treated timbers as per the attached sheets S1 & S2. We understand that a permanent solution will be implemented within the next 12 months.

In the interim and until the temporary shoring is in place, we recommend that temporary barriers or a fence be located such that vehicles are not permitted on this section of alley slab.

If you have any questions, please call me at 763-230-2345.

Sincerely,
Darg, Bolgrean, Menk, Inc.

Harry D. Menk

Harry D. Menk, P.E.
Principal Structural Engineer

HDM: njn

Enclosed: S1, S2

