



APPLICATION FOR ZONING VARIANCE

Department of Safety and Inspections

375 Jackson Street

Suite 220

Saint Paul, MN 55101-1806

General: 651-266-9008

Fax: (651) 266-9099

RECEIVED IN D.S.I.

MAY 08 2013

FILE
13-201598

Zoning office use only

File Number: 13-182715

Fee: \$ 470.00

Tentative Hearing Date: 6/10/13

Section(s) 63.501 (3) (A)

City agent YD

APPLICANT

Name Sona Xiong Company _____
 Address 1108 Wilson Ave E
 City Saint Paul ST _____ Zip 55106 Phone 651-497-5816
 Email _____ Fax _____
 Property Interest of Applicant (owner, contract purchaser, etc) Owner
 Name of Owner (if different) N/A Phone Same as above

PROPERTY
INFORMATION

Address / Location 1108 Wilson Ave
 Legal Description (attach additional sheet if necessary) _____
 Lot Size 9,176 Present Zoning R4 Present Use Single family
 Proposed Use Single Family

Variance[s] requested:

Front yard Parking

Supporting Information: Supply the necessary information that is applicable to your variance request, provide details regarding the project, and explain why a variance is needed. Duplex/triplex conversions may require a pro forma to be submitted. Attach additional sheets if necessary.

Please See
 Attachment letter
 letter dated 4/9/13

Attachments as required:



Site Plan



Attachments



Pro Forma

Applicant's Signature

Date 4-9-13

4

FILE
13-201598
FILE
13-182715

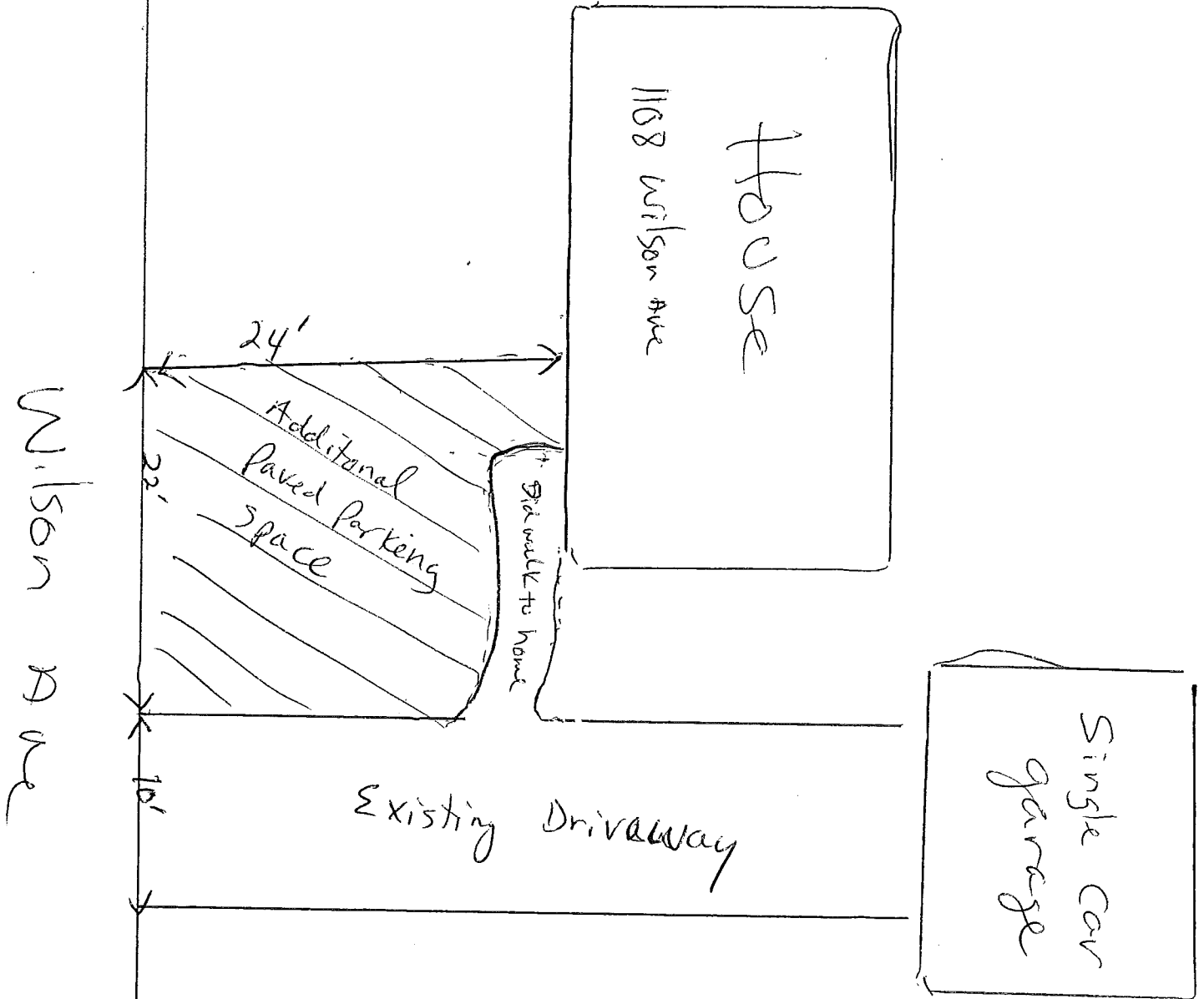

FILE
13-201598
FILE
13-182715

Soua Xiong

1108 Wilson Ave

Saint Paul, MN 55106

Home: 651-774-2148

Cell: 651-497-5116

Re.: 1108 Wilson Ave E Pave parking lot
Saint Paul, MN 55106

April 9, 2013

To Whom It May Concern:

I am the owner of 1108 Wilson Ave E, St. Paul, MN 55106. I had paid MN Roads & Parking Lot Plus to pave an additional parking space of 22'width x24' length next to the existing driveway. Because my house is the last house at the dead end of the street. My house has only one car garage and has a very narrow drive way.

I am new a comer just arrived in the US in the last five years. I had decided to put an additional space to my house for my convenience. I was not aware of pulling a permit to pave. I thought that I had paid MN Roads & Parking Lot Plus so they knew what they were doing, meaning pulling permit or they should have told me about the permit.

6

FILE
13-182715
FILE
13-201598

I had asked my ten neighbors who are adjacent to my house. I have seven neighbors who agreed and supported me of the paving additional parking space.

Therefore, I ask City of Saint Paul to grant this paving additional space of 22' width x 24' length to me.

Thank you for your grant

Sincerely yours,

A handwritten signature in black ink, appearing to be 'Soua Xiong', written over a horizontal line.

Soua Xiong
Property Owner

cells

FILE
13-201598
FILE
13-182715

- ① Ker Mawa 952-769-7637
10714 Wilson Ave. **not a P.O.**
- ② Travis Emerson ← 651-338-7606
- ③ STARR OLSON 651-895-6606
1109 Wilson
- ④ Jo HW HUBERTY
1093 W HLE FIELD
- ⑤ Peter Clasen
105 Wakefield Ave
- ⑥ Mary Kay Truff
1083 Wilson Ave
St Paul MN 55106
- ⑦ Pao Vne
1095 Wilson Ave
St. Paul MN 55106

Note: All the above neighbors who agreed and support
the parcel-additional parking space for me, Sova Xiong,

I BELIEVE THE ADDITIONAL PARKING SPACES
TO BE A BLESSING TO THE NEIGHBORHOOD.
THE PARKING IN THE WINTER IS INCREASED ON
THE STREET BECAUSE OF THE ALLEY BETWEEN
WILSON & EUCLID TO BE SO DANGEROUS IN
BAD WEATHER. SO MANY PEOPLE FALL
INTO THE DITCH AT THE CURVE THAT MANY
OF THE RESIDENTS ARE FORCED TO PARK
ON THE STREET AND NOT USE THE ALLEY.
BECAUSE OUR STREET IS A DEAD END,
WHEN WE HAVE A LOT OF SNOW THE PLOWS
OFTEN PLOW THE SNOW LEAVING IT IN THE
STREET, TAKING UP 2-4 MORE PARKING
SPACES. THE ADDITIONAL PARKING SOUT XIONG
HAS PROVIDED MADE IT EASIER TO PARK ON
THE STREET THIS LONG WINTER WHEN OUR ALLEY
WAS TOO SLIPPERY TO USE.

I AM IN FAVOR OF SOUT XIONG GETTING A VARIAN.
I LIVE DIRECTLY ACROSS THE STREET AND IT
DOES NOT IN ANYWAY HARM THE NEIGHBORHOOD.
IT IS WELL MAINTAINED AND THEY KEPT IT SHOULDER
ALL WINTER.

STARRE OLSON

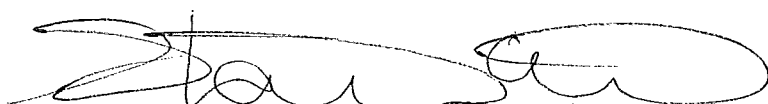
1109 WILSON AVE