

SUMMARY OF ENGINEERING RECOMMENDATION
York Avenue New Sidewalk Construction

Ward 4

PROJECT:

This project is to complete the city sidewalk on **York Avenue between Earl Street and Frank Street**. This block has an incomplete sidewalk on both sides. The new sidewalk is approximately 150' long on the north side of the street. The new sidewalk is approximately 280' long on the south side of the street. The new construction is in front of a total of four properties.

EXISTING CONDITIONS:

This is an incomplete sidewalk. The existing walk runs from York Avenue to 1101 York Avenue on the north side and 1086 York Avenue on the south side.

INITIATING ACTION:

This order was initiated by requests for repairs to the existing walk and a need to complete the walk for the entire length of the block. There is no sidewalk connection from Phalen Boulevard to the neighborhood using Frank Street. The sidewalk completion on York Avenue will help enable pedestrian travel from the local neighborhood to the Phalen Corridor trails.

ALTERNATES:

Minimum work would be to repair existing walk only and leave sidewalk incomplete.

POSITIVE BENEFITS:

At this time there are no sidewalk connections to the Phalen Corridor pathways for this neighborhood. With this sidewalk completion to Frank Street would be the first stretch completed. This would also give opportunities to start addressing other gaps in the pedestrian pathways for this area.

ADVERSE EFFECTS

Normal problems associated with construction such as noise, dust, and general disruption to the neighborhood. There are direct assessments to the abutting properties and they may contest the project.

TIME SCHEDULE:

The project to be done during the 2013 construction season.

COST ESTIMATE:

Construction	\$	11,000.00
Engineering	\$	2,900.00
Miscellaneous	\$	<u>2,000.00</u>

PROJECT TOTAL	\$	15,900.00
---------------	----	-----------

ESTIMATED FINANCING:

Property Assessment	\$	12,500.00
ROW, CIB Funds	\$	<u>3,400.00</u>

PROJECT TOTAL	\$	15,900.00
---------------	----	-----------

SOURCE OF ADDITIONAL INFORMATION

For additional information, contact Sidewalk Supervisor, Allan Czaia, at 266-6108

SUMMARY AND RECOMMENDATION:

The Department of Public Works feels that this is a necessary and worthwhile project, and the Engineering Recommendation is for approval of the project and financing.

	PIN	Length	Width	Reg walk cost	E & I 30%	Assessable
1101 York Ave.	28-29-22-42-0056	30.00	5	\$750.00	\$225.00	\$975.00
1115 York Ave.	28-29-22-42-0038	110.00	5	\$2,750.00	\$825.00	\$3,575.00
1100 York Ave.	28-29-22-42-0071	120.00	5	\$3,000.00	\$900.00	\$3,900.00
1108 York Ave.	28-29-22-42-0084	121.84	5	\$3,046.00	\$913.80	\$3,959.80

Length 381.84	Totals	\$9,546.00	\$2,863.80	\$12,409.80
---------------	--------	------------	------------	-------------

Sqft 1909.2

Real Estate 8%	
\$992.78	\$13,402.58

MEANING OF COLOR SYMBOLS

CONSTRUCT A MONO WALK
(Where no sidewalk exists)
CONSTRUCT A NEW MONO CONCRETE WALK
(Impossible or impractical to resir existing walk)
SATISFACTORY SIDEWALK
(No work anticipated)
DRIVEWAY OR ALLEY CROSSING
(As colored)

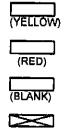

N
SCALE 1" = 40'

YORK AVE. (S.S.)

				120' x 5' NEW CONSTRUCTION	121.84' x 5' NEW CONSTRUCTION	POSSIBLE RETAINING WALL
40'	80'	78.78'	120'	120'	121.84'	39'
R-O-W	1074	1024	1086	1100	1108	R-O-W
	42-0065	42-0064	42-0063	42-0071	42-0084	
SEC. 28-29-22						

FRANK ST.

EARL ST.

FRANK ST.

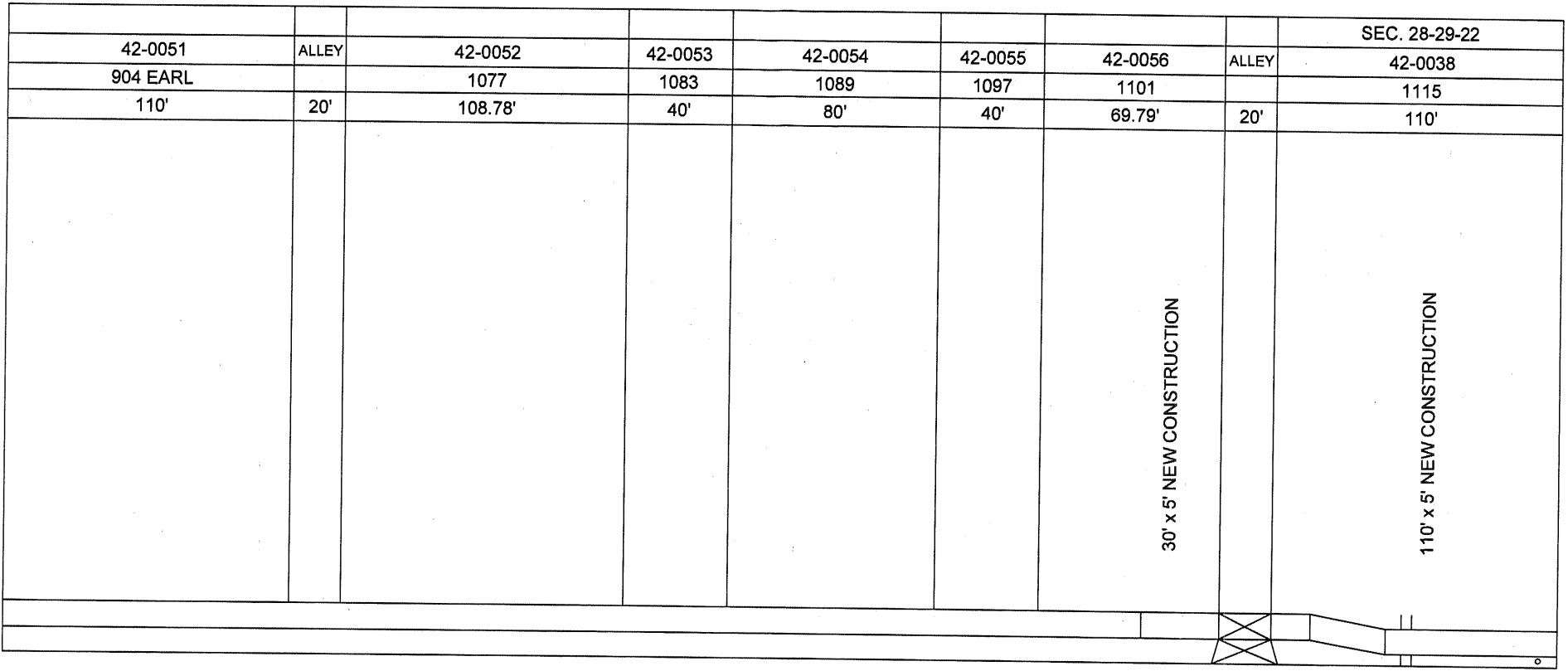

YORK AVE. (N.S.)

MEANING OF COLOR SYMBOLS

- CONSTRUCT A MONO WALK
(Where no sidewalk exists)
- CONSTRUCT A NEW MONO CONCRETE WALK
(Impossible or impractical to repair existing walk)
- SATISFACTORY SIDEWALK
(No work anticipated)
- DRIVEWAY OR ALLEY CROSSING
(As colored)

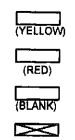

N
SCALE 1" = 40'