



CITY OF SAINT PAUL
Christopher B. Coleman, Mayor

Dan Haak, Manager
Street Engineering/Construction
900 City Hall Annex
25 W. Fourth Street
Saint Paul, MN 55102-1660
Telephone: 651-266-6080
Fax: 651-292-6315

TO: Bruce Engelbrekt
Office of Financial Services, Real Estate Division
1000 City Hall Annex

FROM: Lisa Falk-Thompson 
Public Works Street Engineering
900 City Hall Annex

RE: 2013 RSVP Projects
Madison-Benson, P-8162
Arlington-Rice, P-8158
Hatch-Agate, P-8161

DATE: December 21, 2012

Attached is the combined Summary of Engineering Recommendations for the above referenced projects. Please proceed with the combined final order for these projects, and notify me of the important dates relevant to this SOER.

If you have any questions please call me at 266-6117.

Thanks.

Attachment



SUMMARY OF ENGINEERING RECOMMENDATIONS 2013 Residential Street Vitality Projects

Report Prepared – 12-21-12
Public Hearing – 2-6-13

PROGRAM

This project is to improve the areas referred to as the **Madison-Benson (Area 86), Arlington-Rice (Area 32), and Hatch-Agate (Area 36) Residential Street Vitality Program** projects. See the attached project area maps.

Improvements to be made as part of the projects include constructing new bituminous surfaced streets with concrete curb and gutter, concrete driveway aprons and outwalks, and boulevards landscaped with sod and trees. The existing wood pole lights will be replaced with new lantern style street lighting systems as part of the projects. In addition, appropriate storm and sanitary sewer main repairs will be made, lead water services in the right of way will be replaced, and sanitary sewer service repairs will be made at the request of property owners.

Also as part of the project, special attention will be paid to bringing the existing pedestrian ramps up to current ADA standards, with 2 separate ramps in line with the sidewalks in both directions, and with a truncated dome surface.

Public art will be included in each project, following the procedures developed for the RSVP projects. Funding for public art is 1% of eligible project funds, in this case Street Improvement Bonds, as determined by the Office of Financial Services per the City's Public Art Ordinance.

EXISTING CONDITIONS

Most of the residential streets in the project areas are oiled or older paved streets. The street widths vary, generally between 26' and 32'. The street surfaces are generally in fair condition. Most of the project areas have wood pole street lighting.

East Acker Street has a section of brick pavement, for a length of about 215 feet in the middle of the block between Buffalo and L'Orient. The brick pavement is in very poor condition and has about 20% of its surface covered with asphalt patches.

PROPOSED IMPROVEMENTS

It is proposed to improve the following streets with the construction of new bituminous surfaced streets with concrete curb and gutter, concrete driveway aprons and outwalks, and boulevards landscaped with sod and trees. In addition, appropriate storm and sanitary sewer main repairs will be made, lead water services in the right of way will be replaced, and sanitary sewer service repairs will be made at the request of property owners. The street lighting systems will be updated to the standard City of Saint Paul ornamental lanterns.

Property owners on the section of East Acker with a brick surface have followed City policy and submitted a petition requesting that this section of street be reconstructed with asphalt instead of brick. The petition has the signatures of owners of more than 70% of the footage along the brick section, as required by the policy. The policy states that if a brick street is reconstructed with brick, the assessments are 25% of the actual costs, which would result in a much higher assessment to these adjacent owners than if the street were reconstructed with asphalt. This section of brick street is not within a designated local or national historic district. Because of the petition submitted, the section of East Acker with a brick surface is proposed to be reconstructed with an asphalt surface instead of a brick surface.

Madison-Benson (Area 86)

ADRIAN STREET – Thurston Street to Montreal Way
BENSON AVENUE – Homer Street to Leland Street
BENSON AVENUE – Madison Street to Rankin Street
GLEN TERRACE – Benson Avenue to Cul de sac
MUNSTER AVENUE – Sue Street to Edgcumbe Road
SELMA LANE – Ivan Way to Montreal Avenue
SNELLING PLACE – Benson Avenue to Rockwood Avenue
SPRINGFIELD STREET – 7th Street to Benson Avenue
STEWART AVENUE – Davern Street to Maynard Drive
STEWART AVENUE – Rankin Street to Homer Street
SUMNER STREET – Norfolk Avenue to Sheridan Avenue
WHEELER STREET – Cul de sac to Norfolk Avenue
WORDSWORTH AVENUE – Prior Avenue to Edgcumbe Road

Arlington-Rice (Area 32)

ABELL – Wheelock Parkway to Larpenteur Avenue
ALBEMARLE STREET – Burlington Northern tracks to Arlington Avenue
ALBEMARLE STREET – Wheelock Parkway to Larpenteur Avenue
COTTAGE AVENUE – Cul de sac to Galtier Street
CUMBERLAND STREET – Idaho Avenue to Larpenteur Avenue
FARRINGTON STREET – Burlington Northern tracks to Nebraska Avenue
GURNEY STREET – Cul de sac to Larpenteur Avenue
HAWTHORNE – Kent Street to Cul de sac
KENT STREET – Orange Avenue to Cottage Avenue
MACKUBIN STREET – Orange Avenue to Cottage Avenue
MARION STREET – Burlington Northern tracks to Arlington Avenue
MATILDA STREET – Arlington Avenue to 250' north
PARK STREET – Cottage Avenue to Arlington Avenue
SCHLETTI STREET – Orange Avenue to Cottage Avenue
WANDA - Wheelock Parkway to Larpenteur Avenue
WESTERN AVENUE – Cul de sac to Cottage Avenue
WOODBIDGE STREET – Cottage Avenue to Arlington Avenue
WOODBIDGE STREET – Wheelock Parkway to Larpenteur Avenue

Hatch-Agate (Area 36)

ACKER STREET – Sylvan Street to Jackson Street
ACKER STREET – Cortland Place to L'Orient Street
AGATE STREET – Sycamore Street to Cayuga Street
CASE AVENUE – Jackson Street to Agate Street
COOK AVENUE – Jackson Street to 300' east of Agate
JACKSON STREET – Acker Street to Sycamore Street
JENKS AVENUE – Jackson Street to 320' east of Agate
JESSAMINE AVENUE – Agate Street to 85' east of Agate
LAWSON AVENUE – Jackson Street to Agate Street
LIGHTNER PLACE – Acker Street to Sycamore Street
SIMS AVENUE – Jackson Street to Agate Street
SYCAMORE STREET – Sylvan Street to Cortland Place
SYCAMORE STREET – Elk Street to Agate Street
YORK AVENUE – Jackson Street to Agate Street

OPT-OUTS

Property owners on several streets in each project area have submitted petitions to have their blocks removed from the projects. Those streets are listed below. The petitions have been reviewed to confirm that they meet the requirement of having the support of the owners of at least 75% of the frontage on the block.

Madison-Benson

District 9 (West 7th/Fort Road Federation) and District 15 (Highland District Council) support the neighborhood request to remove the following street from the project.

SELMA LANE – Ivan Way to Montreal Avenue

Arlington-Rice

The District 6 Planning Council supports the neighborhood request to remove the following streets from the project.

ALBEMARLE STREET – Burlington Northern tracks to Cottage Avenue
ALBEMARLE STREET – Cottage Avenue to Arlington Avenue
PARK STREET – Cottage Avenue to Arlington Avenue
WANDA - Wheelock Parkway to Larpenteur Avenue

Hatch-Agate

The District 6 Planning Council is expected to consider the neighborhood petitions to remove the following streets from the project prior to the City Council Public Hearing.

ACKER STREET – Lightner Place to Jackson Street
**ACKER STREET – Elk Street to Buffalo Street
YORK AVENUE – Jackson Street to Agate Street

**This petition has not been completed as of this date. If it does not meet the 75% requirement it will be removed from this list and will remain part of the project.

Decisions regarding the street widths will be made keeping in mind the right of way widths, existing street widths, any relevant neighborhood issues, and the impact on boulevard trees. No significant changes in the width of the roads are expected in any of the above listed project areas. New curb may be hand formed to avoid damaging boulevard trees or their roots. Tree trimming may be necessary to facilitate construction.

As part of the project design processes, attempts will be made to meet the stormwater management requirements of the appropriate watershed district by building infiltration features in each area. Any of the various features allow the stormwater to infiltrate instead of being directed into the stormwater sewer system.

ALTERNATES

To do nothing would be inconsistent with the City's commitment to improve existing oiled and older paved streets.

POSITIVE BENEFITS

General improvement of the public right of way will enhance and add quality to the neighborhoods. The newly rebuilt roadways will improve the durability and drivability of the streets, reduce maintenance issues, and continue the City's efforts to improve the transportation system in Saint Paul. Lantern style lighting will enhance neighborhood safety and esthetics.

ADVERSE EFFECTS

Normal problems associated with construction such as noise, dust, reduced access to the neighborhood, and general disruption will be present while the work is being done.

EFFECTS ON TREES

Street widths will be selected to minimize the impact on trees. Ash Trees will be removed as part of the Parks and Recreation Structured Removal program. New trees will be planted as part of the boulevard restoration, following the City's master tree planting plan.

TIME SCHEDULE

The projects will begin construction in the spring and summer of 2013 and be completed by the fall of 2013. There will be further restrictions on the amount of time work is done on individual segments of streets.

Madison-Benson (Area 86) 13-P-8162
COST ESTIMATE

Construction	\$ 3,495,027
Engineering	\$ 681,530
Miscellaneous	\$ 200,000
TOTAL	\$ 4,376,557

ESTIMATED FINANCING

Street Improvement Bonds	\$ 3,843,357
Stormwater Quality Improvements	\$ 253,700
SPRWS	\$ 215,000
Major Sewer Repairs	\$ 64,500
TOTAL	\$ 4,376,557

Arlington-Rice (Area 32) 13-P-8158
COST ESTIMATE

Construction	\$ 4,989,465
Engineering	\$ 972,946
Miscellaneous	\$ 300,000
TOTAL	\$ 6,262,411

ESTIMATED FINANCING

Street Improvement Bonds	\$ 5,499,935
Stormwater Quality Improvements	\$ 362,791
SPRWS	\$ 307,450
Major Sewer Repairs	\$ 92,235
TOTAL	\$ 6,262,411

Hatch-Agate (Area 36) 13-P-8161
COST ESTIMATE

Construction	\$ 2,965,724
Engineering	\$ 578,316
Miscellaneous	\$ 200,000
TOTAL	\$ 3,744,040

ESTIMATED FINANCING

Street Improvement Bonds	\$ 3,288,154
Stormwater Quality Improvements	\$ 216,914
SPRWS	\$ 183,825
Major Sewer Repairs	\$ 55,148
TOTAL	\$ 3,744,040

ALL RSVP PROJECTS COMBINED

COST ESTIMATE

Construction	\$ 11,450,216
Engineering	\$ 2,232,792
Miscellaneous	\$ 700,000

PROJECT TOTAL **\$ 14,383,008**

ESTIMATED FINANCING

Street Improvement Bonds	\$ 12,631,446
Stormwater Quality Improvements	\$ 833,405
SPRWS	\$ 706,275
Major Sewer Repairs	\$ 211,882

PROJECT TOTAL **\$ 14,383,008**

The 2013 assessment rates for residential street paving and lighting are expected to be approximately \$60.00 total per ASSESSABLE FOOT.

SOURCE OF ADDITIONAL INFORMATION

For additional information, contact Project Engineer Lisa Falk-Thompson, 651-266-6117.

SUMMARY AND RECOMMENDATION

The Department of Public Works feels that this is a necessary and worthwhile project, and the Engineering Recommendation is for approval of the project and financing.

Respectfully submitted,

Lisa Falk-Thompson
Public Works

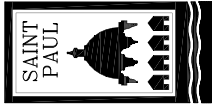

City of Saint Paul
Department of Public Works
Street Engineering and Construction Division

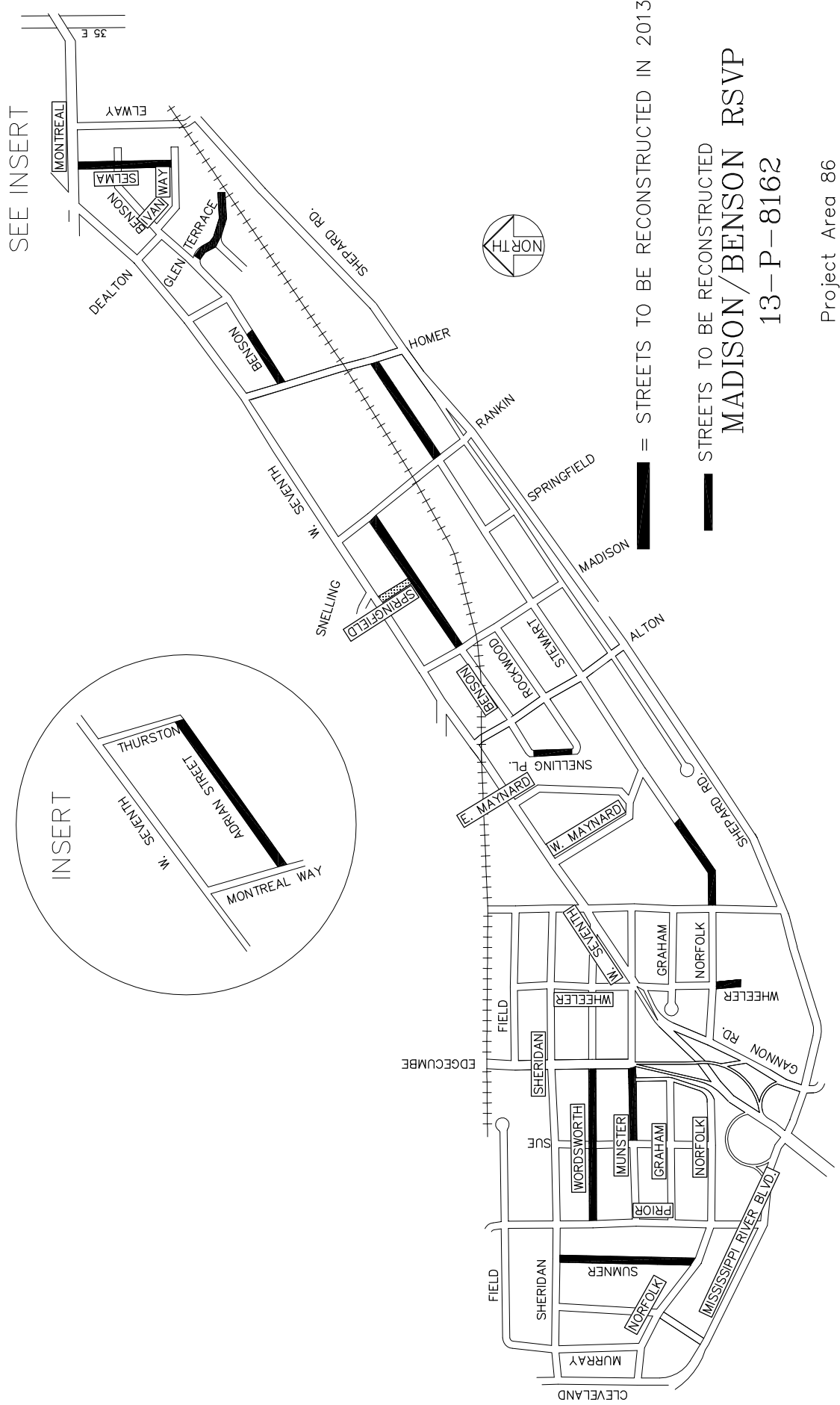

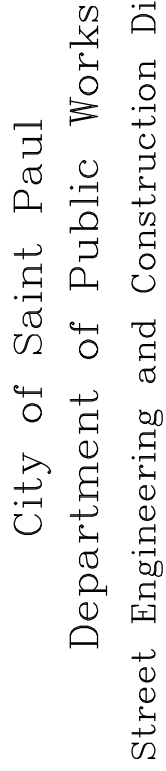

05/07/12



City of Saint Paul
Department of Public Works
Street Engineering and Construction Division

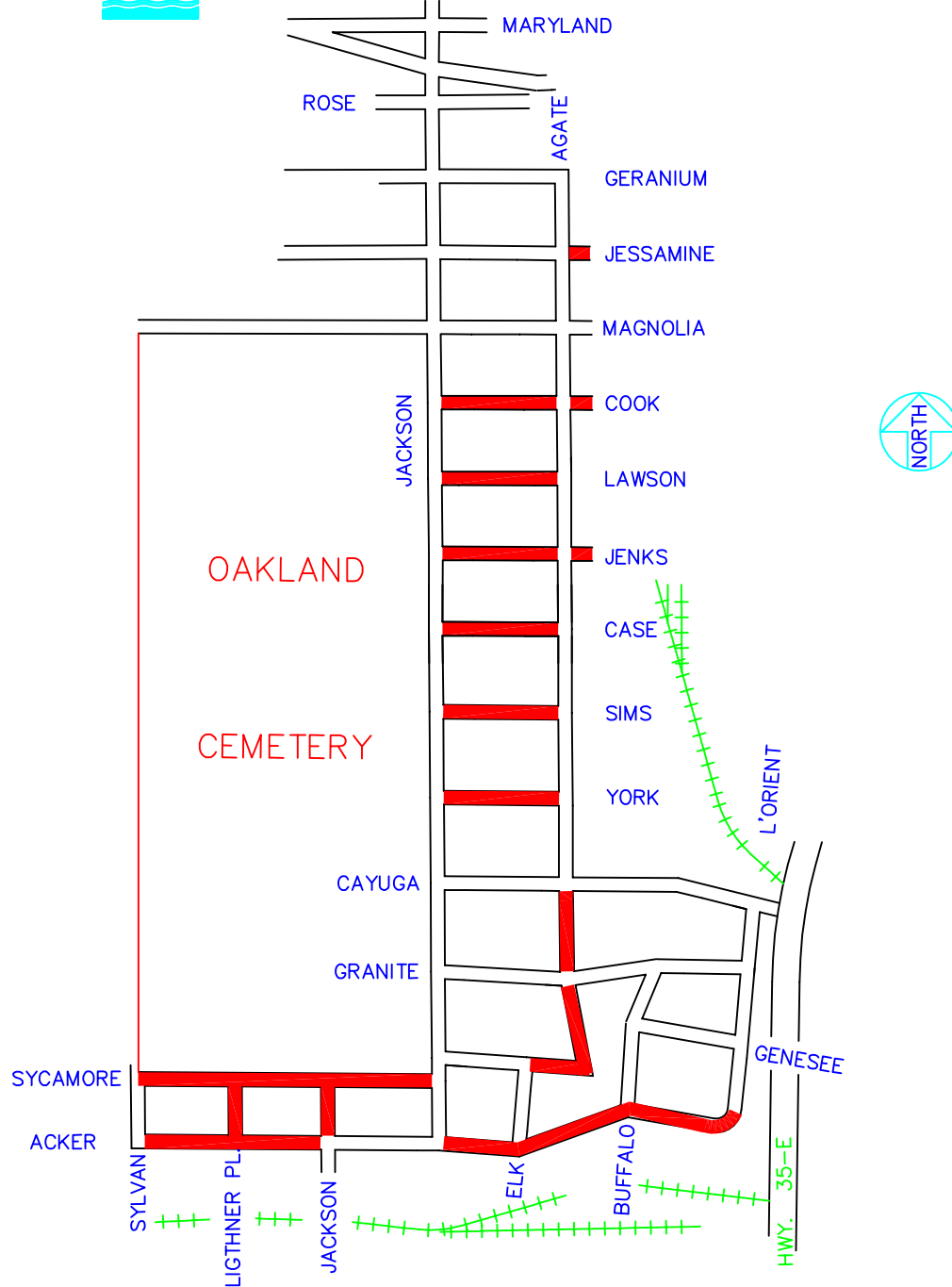

— = STREETS TO BE RECONSTRUCTED IN 2013

2013
HATCH/AGATE RSVP
13-P-8161

Project Area 36

5/11/2012