

	A	B	C	D
1	SELBY DAYTON LLC	375 JACKSON ST STE 700	SAINT PAUL MN 55101-1810	12823210044
2	COSTELLO PROPERTIES	2150 ANGELL RD	SUNFISH LAKE MN 55118-0528	12823210045
3	GREGORY W HECK ROBERT M BEYER	185 LEXINGTON PKWY S	SAINT PAUL MN 55105-2755	12823210441
4	NORMA J PEARSON	165 WESTERN AVE N CONDO 200	SAINT PAUL MN 55102-4621	12823210049
5	ABS WESTERN LLC	191 WESTERN AVE N	SAINT PAUL MN 55102-1748	12823210317
6	TARA SWEDBERG NATHAN VAN SICKLE	396 DAYTON AVE	SAINT PAUL MN 55102-1706	12823210027
7	COSTELLO PROPERTIES	2150 ANGELL RD	SUNFISH LAKE MN 55118-0528	12823210048
8	YWCA OF ST PAUL	375 SELBY AVE	ST PAUL MN 55102-1822	12823210316
9	SELBY DAYTON LLC	29 S DEEP LAKE RD	NORTH OAKS MN 55127-6312	12823210448
10	SELBY AVENUE REALTY LLC	400 SELBY AVE	SAINT PAUL MN 55102-1725	12823210400
11	ST PAUL INTERVENTION PROJECT	394 DAYTON AVE	SAINT PAUL MN 55102-1771	12823210449
12	DACBLD LLC	340 CEDAR ST UNIT 100	SAINT PAUL MN 55101-1126	12823120151
13	YWCA OF ST PAUL	375 SELBY AVE	ST PAUL MN 55102-1822	12823120287
14	DACBLD LLC	340 CEDAR ST UNIT 100	SAINT PAUL MN 55101-1126	12823120152
15	DACBLD LLC	340 CEDAR ST UNIT 100	SAINT PAUL MN 55101-1126	12823120153
16	DACBLD LLC	340 CEDAR ST UNIT 100	SAINT PAUL MN 55101-1126	12823120154
17	DACBLD LLC	340 CEDAR ST UNIT 100	SAINT PAUL MN 55101-1126	12823120155
18	DACBLD LLC	340 CEDAR ST UNIT 100	SAINT PAUL MN 55101-1126	12823120156
19	DACBLD LLC	340 CEDAR ST UNIT 100	SAINT PAUL MN 55101-1126	12823120157
20	DACBLD LLC	340 CEDAR ST UNIT 100	SAINT PAUL MN 55101-1126	12823120158
21	DACBLD LLC	340 CEDAR ST UNIT 100	SAINT PAUL MN 55101-1126	12823120159
22	DACBLD LLC	340 CEDAR ST UNIT 100	SAINT PAUL MN 55101-1126	12823120160
23	DACBLD LLC	340 CEDAR ST UNIT 100	SAINT PAUL MN 55101-1126	12823120161
24	DACBLD LLC	340 CEDAR ST UNIT 100	SAINT PAUL MN 55101-1126	12823120162
25	DACBLD LLC	340 CEDAR ST UNIT 100	SAINT PAUL MN 55101-1126	12823120163
26	JULIA V GRIGORIEV	165 WESTERN AVE N # 210	SAINT PAUL MN 55102-4633	12823210059
27	HEATHER TRACHSEL	165 WESTERN AVE N # 300	SAINT PAUL MN 55102-4621	12823210060
28	HANS FREDERICK CHRISTENSON	165 WESTERN AVE N CONDO 301	SAINT PAUL MN 55102-4621	12823210061
29	MARK R JOHNSON	165 WESTERN AVE N # 302	ST PAUL MN 55102-4611	12823210062
30	ALEXANDER EDGERTON	165 WESTERN AVE N # 409	SAINT PAUL MN 55102-4621	12823210080
31	IAN T BURTON PAMELA V BURTON	1 S PALWAY	LAKE WORTH FL 33460-4122	12823210081
32	GERILYN SAUCEDO ROMAN SAUCEDO	165 WESTERN AVE N UNIT 500	SAINT PAUL MN 55102-4621	12823210082
33	JUNE M BERKOWITZ	39 GROVE ST	MAHTOMEDI MN 55115-1629	12823210083

	A	B	C	D
34	LILLIAN OUELLETTE HOWITZ	165 WESTERN AVE N # 201	SAINT PAUL MN 55102-4621	12823210050
35	JOBETH MARSHALL	165 WESTERN AVE N # 202	ST PAUL MN 55102-4611	12823210051
36	LINDSEY FAST	165 WESTERN AVE N UNIT 207	SAINT PAUL MN 55102-4621	12823210056
37	SHAVAL WEBB CROOMS	165 WESTERN AVE N UNIT 209	SAINT PAUL MN 55102-4633	12823210058
38	PATRICIA J LAZARUS JAMES J MCKENZIE	165 WESTERN AVE N UNIT 303	SAINT PAUL MN 55102-4621	12823210063
39	HENRY PYE KAYLA M NULL GRACIA	165 WESTERN AVE N # 307	SAINT PAUL MN 55102-4621	12823210067
40	JOANNE SIMONS	165 WESTERN AVE N UNIT 405	SAINT PAUL MN 55102-4621	12823210076
41	ERIK W SMITH JANE BEHREND S	165 WESTERN AVE N CONDO 407	SAINT PAUL MN 55102-4621	12823210078
42	BARBARA BOCCI	165 WESTERN AVE N # 503	SAINT PAUL MN 55102-4621	12823210085
43	VICTOR A BLOOMFIELD	820 NW 12TH AVE APT 304	PORTLAND OR 97209-3046	12823210087
44	JENNIFER K NELSON	165 WESTERN AVE N APT 510	SAINT PAUL MN 55102-4634	12823210092
45	LANCE E GROTH	165 WESTERN AVE N UNIT 203	SAINT PAUL MN 55102-4621	12823210052
46	THE CLINE FAMILY TRUST	51 COMMONS CIR	HAWTHORN WOODS IL 60047-1246	12823210053
47	ANNE HYLAND	165 WESTERN AVE N UNIT 205	SAINT PAUL MN 55102-4621	12823210054
48	PATRICIA JO KOWALKE	165 WESTERN AVE N # 309	SAINT PAUL MN 55102-4621	12823210069
49	DENISE J ABBOTT	165 WESTERN AVE UNIT 310	SAINT PAUL MN 55102-4621	12823210070
50	BLAIR HOUSE RES CONDO ASSN	8100 OLD CEDAR AVE S STE 300	BLOOMINGTON MN 55425-1803	12823210073
51	CHERYL BROWN	165 WESTERN AVE N CONDO 403	SAINT PAUL MN 55102-4621	12823210074
52	ROBERT A STRANDQUIST PATTY D STRANDQUIST	165 WESTERN AVE N UNIT 506	SAINT PAUL MN 55102-4621	12823210088
53	E CAROLINE GALE PETER W FISH	165 WESTERN AVE N # 507	ST PAUL MN 55102-4612	12823210089
54	KARRIE DIETZ MICHAEL GALLIGAN	1691 BUCKINGHAM PATH	FARIBAULT MN 55021-7021	12823210090
55	ERIN CAMPBELL	165 WESTERN AVE N UNIT 509	SAINT PAUL MN 55102-4621	12823210091
56	EMILY DEBEVEC	2806 BUCKINGHAM RD	LOS ANGELES CA 90016-3600	12823210055
57	BLAKE D M RATNER VADDEY A RATNER	165 WESTERN AVE N 208	SAINT PAUL MN 55102-2475	12823210057
58	EARL MEDINTZ D CHERYL MEDINTZ	165 WESTERN AVE N # 304	ST PAUL MN 55102-4621	12823210064
59	ELLEN F SHAFFER KEVIN T FENTON	165 WESTERN AVE N # 308	ST PAUL MN 55102-4621	12823210068
60	GEORGE MASTROGIORGIS	165 WESTERN AVE N # 404	SAINT PAUL MN 55102-4621	12823210075
61	THOMAS ANDREW WEBER STEVEN WEBER	165 WESTERN AVE N # 406	SAINT PAUL MN 55102-4621	12823210077
62	STUART KLEIN	165 WESTERN AVE N UNIT 408	SAINT PAUL MN 55102-4621	12823210079
63	EVAN A FRIEDLEY	165 WESTERN AVE N UNIT 502	SAINT PAUL MN 55102-4621	12823210084
64	SANDRA G PETERSON ROBERT A PETERSON	165 WESTERN AVE N CONDO 504	SAINT PAUL MN 55102-4621	12823210086
65	LEONARDO LASANSKY	165 WESTERN AVE N # 400	ST PAUL MN 55102-4612	12823210320
66	VONDA S WURZBURGER TR	307 S 2ND ST	ALMA WI 54610-0000	12823210446

	A	B	C	D
67	CHARLES W OGDEN TR	1256 FALL CREEK RD	LINCOLN NE 68510-4967	12823210447
68	SELBY AVENUE REALTY LLC	400 SELBY AVE	SAINT PAUL MN 55102-1725	12823210094
69	SELBY AVENUE REALTY LLC	400 SELBY AVE	SAINT PAUL MN 55102-1725	12823210093
70	GREGORY W HECK ROBERT M BEYER	185 LEXINGTON PKWY S	SAINT PAUL MN 55105-2755	12823210442
71	GREGORY W HECK ROBERT M BEYER	185 LEXINGTON PKWY S	SAINT PAUL MN 55105-2755	12823210445
72	GREGORY W HECK ROBERT M BEYER	185 LEXINGTON PKWY S	SAINT PAUL MN 55105-2755	12823210443
73	GREGORY W HECK ROBERT M BEYER	185 LEXINGTON PKWY S	SAINT PAUL MN 55105-2755	12823210444

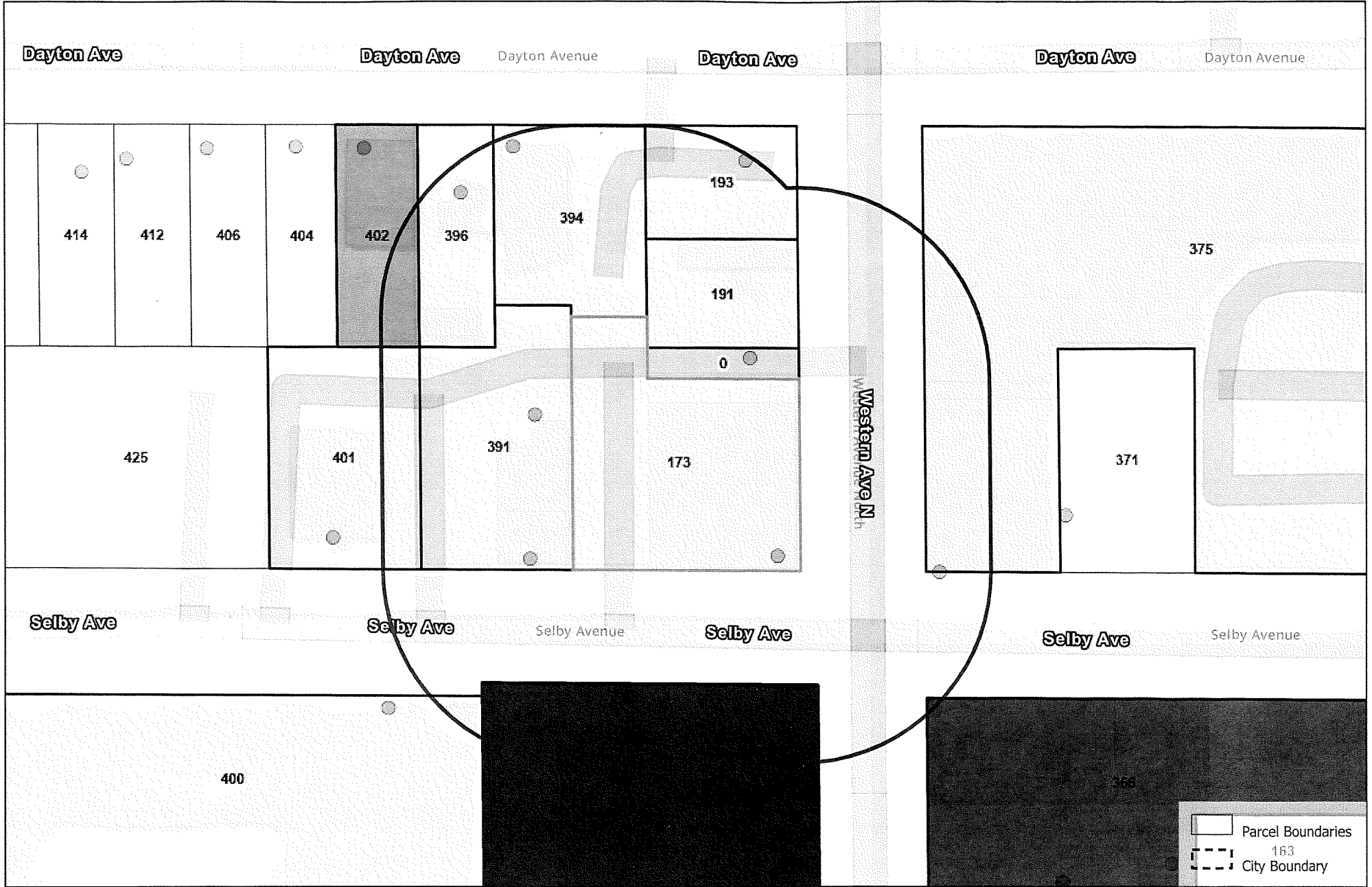

Esri Community Maps Contributors, County of Ramsey, Metropolitan Council, MetroGIS, © OpenStreetMap, Microsoft, Esri, TomTom, Garmin, SafeGraph, GeoTechnologies, Inc, NICTD/NASA, USGS, EPA, NPS, US

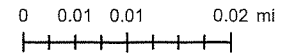

The Geographic Information System (GIS) Data to which this notice is attached are made available pursuant to the Minnesota Government Data Practices Act (Minnesota Statutes Chapter 13). The GIS Data are provided to you "AS IS" and without any warranty as to their performance, merchantability, or fitness for any particular purpose. The GIS Data were developed by the City of Saint Paul for its own internal business purposes. The City of Saint Paul does not represent or warrant that the GIS Data or the data documentation are error-free, complete, current, or accurate. You are responsible for any consequences resulting from your use of the GIS Data or your reliance on the GIS Data. You should consult the data documentation for this particular GIS Data to determine the limitations of the GIS Data and the precision with which the GIS Data may depict distance, direction, location, or other geographic features. If you transmit or provide the GIS Data (or any portion of it) to another user, the GIS Data must include a copy of this disclaimer.