

	A	B	C	D
1	CITY OF ST PAUL	25 4TH ST W # 1000	ST PAUL MN 55102-1692	272922230083
2	CITY OF ST PAUL	25 4TH ST W # 1000	ST PAUL MN 55102-1692	272922230081
3	HMONG VILLAGE LLC	1001 JOHNSON PKWY	SAINT PAUL MN 55106	272922230082
4	RAMSEY COUNTY REG RR AUTH	121 7TH PL E STE 2200	SAINT PAUL MN 55101-2146	282922140078
5	TATE PROPERTIES LLC	1147 ORCHARD CIR	MENDOTA HEIGHTS MN 55118-4146	282922140076

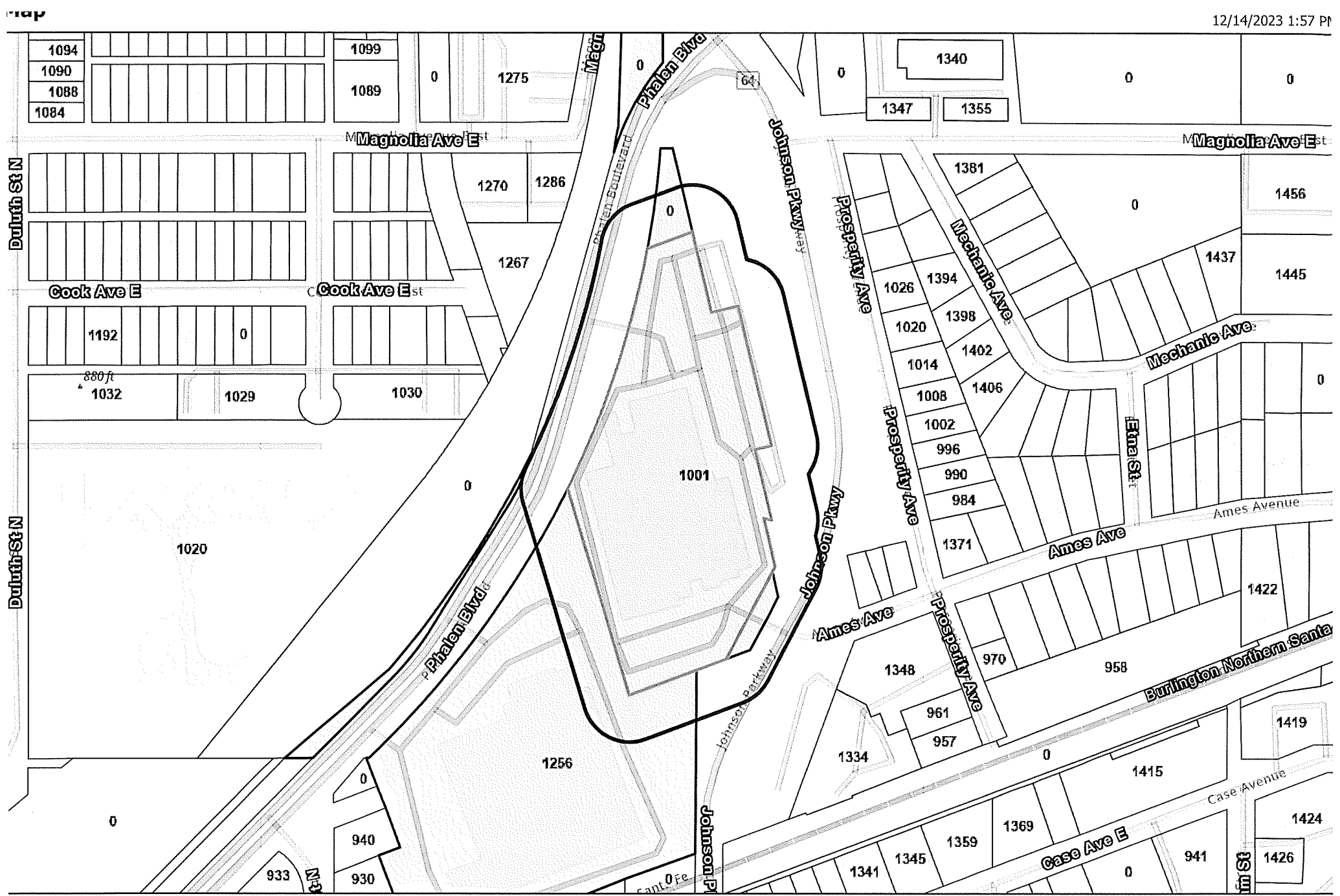

**Saint Paul Minnesota**  
*The most livable city in America*

Sources: Esri, Airbus DS, USGS, NGA, NASA, CGIAR, N Robinson, NCEAS, NLS, OS, NMA, Geodatastyrelsen, Rijkswaterstaat, GSA, Geoland, FEMA, Intermap and the GIS user community, Esri Community Maps

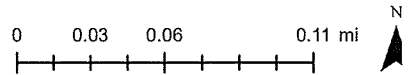

The Geographic Information System (GIS) Data to which this notice is attached are made available pursuant to the Minnesota Government Data Practices Act (Minnesota Statutes Chapter 13). The GIS Data are provided to you "AS IS" and without any warranty as to their performance, merchantability, or fitness for any particular purpose. The GIS Data were developed by the City of Saint Paul for its own internal business purposes. The City of Saint Paul does not represent or warrant that the GIS Data or the data documentation are error-free, complete, current, or accurate. You are responsible for any consequences resulting from your use of the GIS Data or your reliance on the GIS Data. You should consult the data documentation for this particular GIS Data to determine the limitations of the GIS Data and the precision with which the GIS Data may depict distance, direction, location, or other geographic features. If you transmit or provide the GIS Data (or any portion of it) to another