

	A	B	C	D
1	TONG PAO YANG XO L YANG	1086 RICE ST	SAINT PAUL MN 55117-4922	302922220125
2	METRO HOME HEALTH CARE CORPORATION	2203 CARVER AVE E	SAINT PAUL MN 55119-6002	302922220124
3	CHON YANG	1096 RICE ST	SAINT PAUL MN 55117-4922	302922220164
4	JAMES H BRADSHAW JAYNE M BRADSHAW	1078 RICE ST	SAINT PAUL MN 55117-4921	302922230038
5	JAMES H BRADSHAW JAYNE M BRADSHAW	1078 RICE ST	SAINT PAUL MN 55117-4921	302922220126
6	JASON R DEMING RACHEL L BERVEN	1084 ALBEMARLE ST	ST PAUL MN 55117-5101	252923110159
7	PATRICIA S KAUFMAN	1080 ALBEMARLE ST	ST PAUL MN 55117-5101	252923140010
8	TK INSPIRATION INC	1091 RICE ST	SAINT PAUL MN 55117-4920	252923110196
9	THATKA PROPERTY LLC	1407 BRADLEY ST	SAINT PAUL MN 55130-3403	252923110154
10	NOU VANG TOUA XIONG	4455 LAKE ELMO AVE N	LAKE ELMO MN 55042-9506	252923140001
11	PAULETTE G OKERSTROM	1090 ALBEMARLE ST	SAINT PAUL MN 55117-5101	252923110160
12	ALL GREEN LLC	217 COMO AVE # 2-100	SAINT PAUL MN 55103-1838	252923110195
13	JBHMN LLC	8500 NORMANDALE LAKE BLVD 350	MINNEAPOLIS MN 55437-3805	252923140143
14	NOU VUE	1074 ALBEMARLE ST	SAINT PAUL MN 55117-5101	252923140009
15	RICHARD HERR	1064 ALBEMARLE ST	SAINT PAUL MN 55117-5101	252923140007
16	WILLY YANG	1135 ALBEMARLE ST	SAINT PAUL MN 55117-4414	252923140008
17	TAYLOR JAMES SWARTWOOD	PO BOX 10714	WHITE BEAR LAKE MN 55110-0714	252923110161
18	XUA LEE	1098 ALBEMARLE ST	SAINT PAUL MN 55117-5101	252923110191
19	XUA LEE	1098 ALBEMARLE ST	SAINT PAUL MN 55117-5101	252923110190

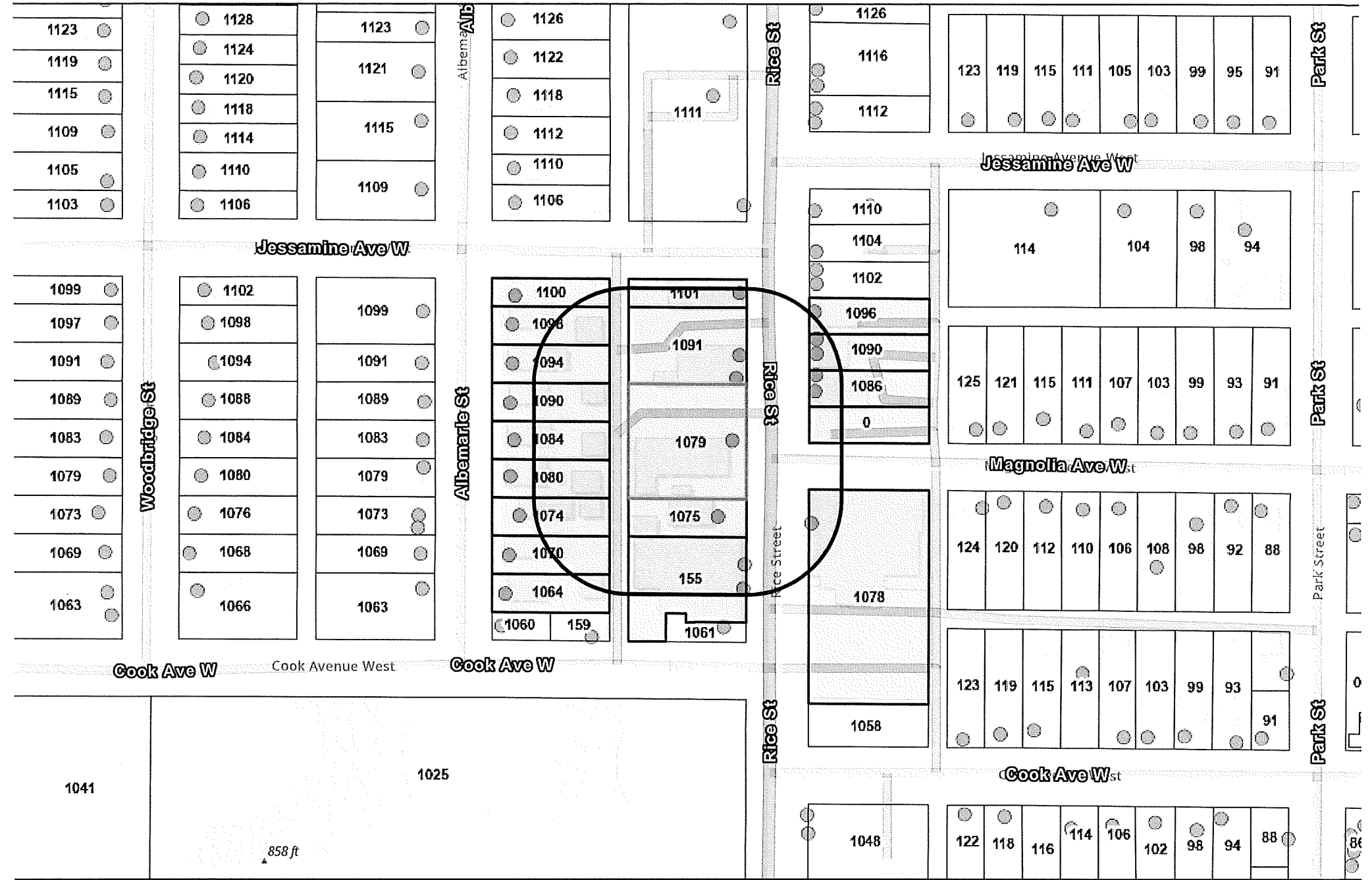

Saint Paul Minnesota
The most livable city in America

Sources: Esri, Airbus DS, USGS, NGA, NASA, CGIAR, N Robinson, NCEAS, NLS, OS, NMA, Geodatastyrelsen, Rijkswaterstaat, GSA, Geoland, FEMA, Intermap and the GIS user community, Esri Community Maps

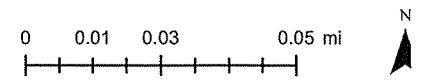

The Geographic Information System (GIS) Data to which this notice is attached are made available pursuant to the Minnesota Government Data Practices Act (Minnesota Statutes Chapter 13). The GIS Data are provided to you "AS IS" and without any warranty as to their performance, merchantability, or fitness for any particular purpose. The GIS Data were developed by the City of Saint Paul for its own internal business purposes. The City of Saint Paul does not represent or warrant that the GIS Data or the data documentation are error-free, complete, current, or accurate. You are responsible for any consequences resulting from your use of the GIS Data or your reliance on the GIS Data. You should consult the data documentation for this particular GIS Data to determine the limitations of the GIS Data and the precision with which the GIS Data may depict distance, direction, location, or other geographic features. If you transmit or provide the GIS Data (or any portion of it) to another