

	A	B	C	D
1	OWNER	MAIL-TO ADDRESS	MAIL-TO CITY/STATE	PIN
2	LEO H GADBOIS	951 GRAND AVE	ST PAUL MN 55105-3015	12823210271
3	CITY OF ST PAUL CS PR 33190	15 KELLOGG BLVD W ROOM 140	ST PAUL MN 55102-1613	12823220157
4	KATHERINE A MCGOUGH	1579 BURTON ST	FALCON HEIGHTS MN 55108-1302	12823210422
5	HANNAH M BEZEK	477 LAUREL AVE UNIT E-1	SAINT PAUL MN 55102-3445	12823210278
6	KENESAW CONDOMINIUM ASSOCIATIO	504 SELBY AVE	ST PAUL MN 55102-4567	12823220133
7	PERGOLA LLC	201 WESTERN AVE N	SAINT PAUL MN 55102-1750	12823210332
8	LEO H GADBOIS	951 GRAND AVE	ST PAUL MN 55105-3015	12823210269
9	DAVID BRIAN STEGALL	491 LAUREL AVE	SAINT PAUL MN 55102-2017	12823210276
10	LEO H GADBOIS	951 GRAND AVE	ST PAUL MN 55105-3015	12823210270
11	ERIN D CORYELL	504 SELBY AVE UNIT 1	SAINT PAUL MN 55102-4567	12823220123
12	KENESAW CONDOMINIUM ASSOC	504 SELBY AVE	ST PAUL MN 55102-4567	12823220134
13	ERIC RICH	505 SELBY AVE UNIT 1	SAINT PAUL MN 55102-4501	12823220082
14	MARY B ZAHASKY	8877 BRUNSWICK PATH	INVER GROVE HEIGHTS MN 55076-0054	12823210249
15	ROBERT C JORDON	487 LAUREL AVE	ST PAUL MN 55102-2017	12823210277
16	SHERRIL T GARAHAN	493 LAUREL AVE	ST PAUL MN 55102-2017	12823210275
17	ST PAUL CURLING CLUB INC	470 SELBY AVE	ST PAUL MN 55102-1727	12823210268
18	JAN I LASSEN	505 SELBY AVE UNIT 2	SAINT PAUL MN 55102-4501	12823220083
19	DONALD VELKY	505 SELBY AVE 3	SAINT PAUL MN 55102-4501	12823220084
20	LORRIE B DORRANCE	505 SELBY AVE APT 5	ST PAUL MN 55102-4501	12823220086
21	JOHN H FARICY JR	505 SELBY AVE	ST PAUL MN 55102-4503	12823220088
22	ALEXANDER GREVICH MCDONALD	505 SELBY AVE 12	SAINT PAUL MN 55102-4502	12823220093
23	KERRY OKEEFE	505 SELBY AVE UNIT 14	SAINT PAUL MN 55102-4501	12823220095
24	CHARLES C WIESSNER	505 SELBY AVE UNIT 8	SAINT PAUL MN 55102-2020	12823220089
25	MICHAEL L HOMOLKA	505 SELBY AVE UNIT 9	SAINT PAUL MN 55102-4501	12823220090
26	KAREN A STEVENS	505 SELBY AVE UNIT 10	SAINT PAUL MN 55102-4501	12823220091
27	RICHARD D VENTURA	1646 FINSBURY LN	LA GRANGE PARK IL 60526-1105	12823220092
28	JORDAN HALTAUFDERHEID	505 SELBY AVE UNIT 4	SAINT PAUL MN 55102-4503	12823220085
29	CHRIS KASAL	13921 315TH ST	CANNON FALLS MN 55009-4631	12823220087
30	REBECCA K STEWART	505 SELBY AVE UNIT 13	SAINT PAUL MN 55102-4501	12823220094
31	MARY G HARDY	686 FAIRMOUNT AVE	SAINT PAUL MN 55105-3520	12823210279
32	ARON J KAHN	477 LAUREL AVE UNIT E3	SAINT PAUL MN 55102-2048	12823210280
33	WILLIAM G WALLACE	477 LAUREL AVE	ST PAUL MN 55102-2048	12823210282

	A	B	C	D
34	BRIAN MILLER	479 LAUREL AVE UNIT W6	SAINT PAUL MN 55102-2080	12823210289
35	CESARIA MARY BAUER	481 LAUREL AVE UNIT 1	SAINT PAUL MN 55102-3062	12823210284
36	CHARLES W BROKAW	8985 OLD CONCORD BLVD	INVER GROVE HEIGHTS MN 55076-3737	12823210285
37	MARY G HARDY	686 FAIRMOUNT AVE	ST PAUL MN 55105-3520	12823210286
38	MARIO A ACITO	479 LAUREL AVE 4W	SAINT PAUL MN 55102	12823210287
39	NORA M MOORE	481 LAUREL AVE UNIT 5W	SAINT PAUL MN 55102-2080	12823210288
40	MARY E MORRIS	475 LAUREL AVE	ST PAUL MN 55102-2048	12823210281
41	PHILIP J ASGIAN TRUSTEE	475 LAURAL AVE #E6	ST PAUL MN 55102-2048	12823210283
42	KRISTEN TREBIL-HALBERSMA	504 SELBY AVE UNIT 2	SAINT PAUL MN 55102-1762	12823220124
43	TODD P WALKER	504 SELBY AVE UNIT 3	ST PAUL MN 55102-4567	12823220125
44	PETER D KOUDELKA	504 SELBY AVE #4	ST PAUL MN 55102-4567	12823220126
45	KATHRYN FREEMAN	504 SELBY AVE UNIT 5	SAINT PAUL MN 55102-4567	12823220127
46	KIN W JENKINS	291 RIVERWOODS LANE	BURNSVILLE MN 55337-3388	12823220132
47	ANN E BROCKMAN	504 SELBY AVE	ST PAUL MN 55102-4542	12823220128
48	JONATHAN F VAUGHAN-FIER	79 WESTERN AVE N APT 402	SAINT PAUL MN 55102-4623	12823220130
49	GIA LYONS	504 SELBY AVE UNIT 7	SAINT PAUL MN 55102-4567	12823220129
50	JOY P YOSHIKAWA	504 SELBY AVE UNIT 9	SAINT PAUL MN 55102-4542	12823220131
51	BONNIE R HILL	182 MACKUBIN ST UNIT 5	SAINT PAUL MN 55102-4548	12823210426
52	DAVID M BACHMEIER	16598 DYNAMIC DR	LAKEVILLE MN 55044-6069	12823210427
53	MARC KUKURA	7900 E ARROWHEAD PKWY APT 331	SIoux FALLS SD 57110-7021	12823210424
54	LISA M DALSIN	1399 ELEANOR AVE	SAINT PAUL MN 55116-2230	12823210423
55	KULLEN GROUP LLC	612 OAKWOOD CT	HUDSON WI 54016-1860	12823210425
56	ROOT PROPERTIES LLC	499 SELBY AVE	SAINT PAUL MN 55102-1726	12823210428
57	ROOT PROPERTIES LLC	499 SELBY AVE	SAINT PAUL MN 55102-1726	12823210429
58	ROOT PROPERTIES LLC	499 SELBY AVE	SAINT PAUL MN 55102-1726	12823210431
59	ROOT PROPERTIES LLC	499 SELBY AVE	SAINT PAUL MN 55102-1726	12823210430

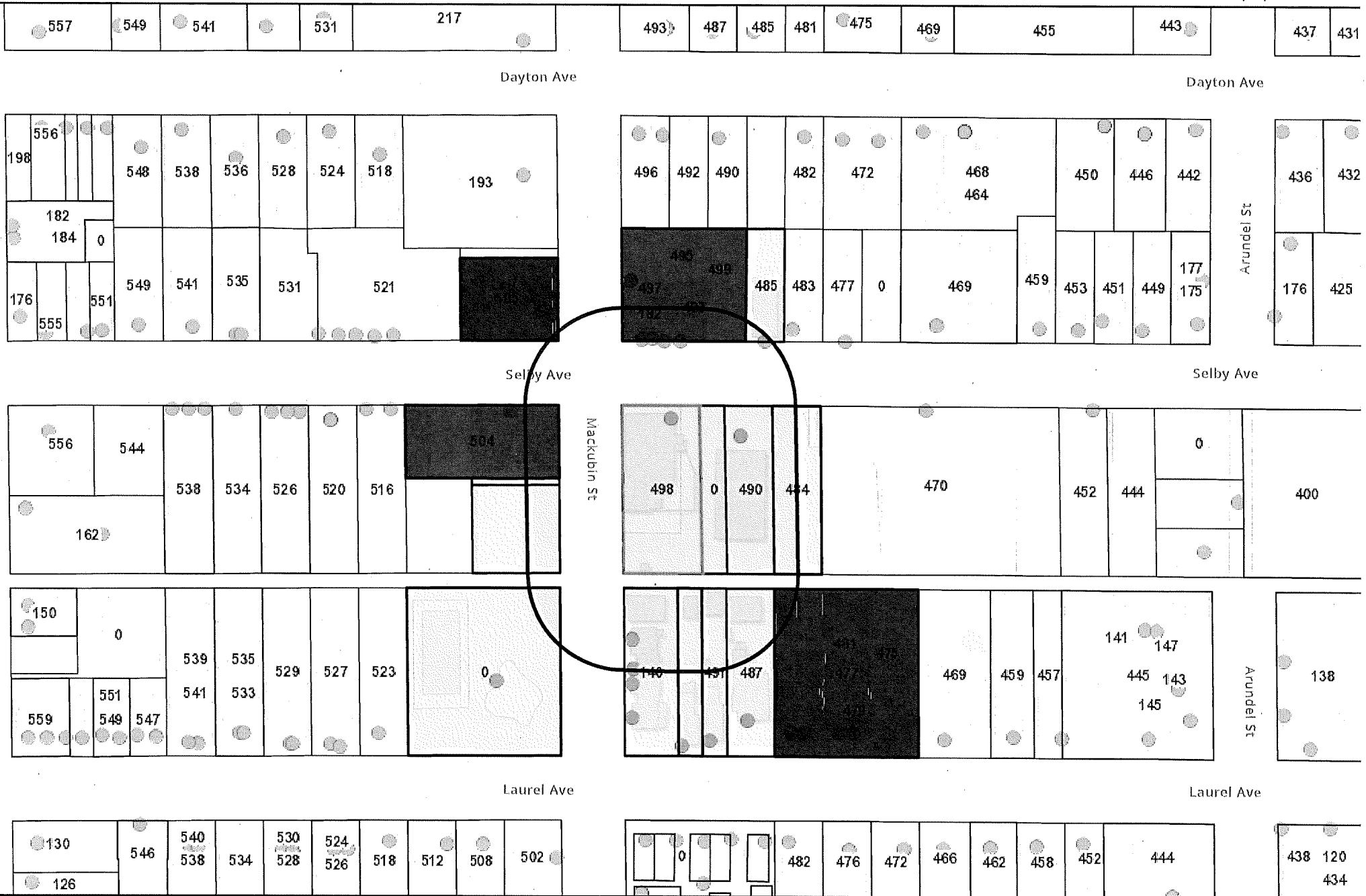

**Saint Paul Minnesota**  
*The most livable city in America*

Department of Safety and Inspections (DSI), Sources: Esri, Airbus DS, USGS, NGA, NASA, CGIAR, N Robinson, NCEAS, NLS, OS, NMA, Geodatastyrelsen, Rijkswaterstaat, GSA, Geoland, FEMA, Intermap and the

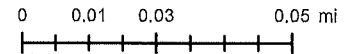

The Geographic Information System (GIS) Data to which this notice is attached are made available pursuant to the Minnesota Government Data Practices Act (Minnesota Statutes Chapter 13). The GIS Data are provided to you "AS IS" and without any warranty as to their performance, merchantability, or fitness for any particular purpose. The GIS Data were developed by the City of Saint Paul for its own internal business purposes. The City of Saint Paul does not represent or warrant that the GIS Data or the data documentation are error-free, complete, current, or accurate. You are responsible for any consequences resulting from your use of the GIS Data or your reliance on the GIS Data. You should consult the data documentation for this particular GIS Data to determine the limitations of the GIS Data and the precision with which the GIS Data may depict distance, direction, location, or other geographic features. If you transmit or provide the GIS Data (or any portion of it) to