

	A	B	C	D
1	ATRIUM LLC	1625 ENERGY PARK DR 100	ST PAUL MN 55108-2727	272923130051
2	BANDANA LLC	1625 ENERGY PARK DR #100	ST PAUL MN 55108-2727	272923130046
3	WOP BURLINGTON LLC	5150 E DUBLIN GRANVILLE RD SUITE 1	WESTERVILLE OH 43081-8701	272923140019
4	BANDANA LLC	1625 ENERGY PARK DR #100	ST PAUL MN 55108-2727	272923130048
5	TRIUMPH 3 LLC	10822 JERSEY CIR N	BROOKLYN PARK MN 55445-2316	272923130062

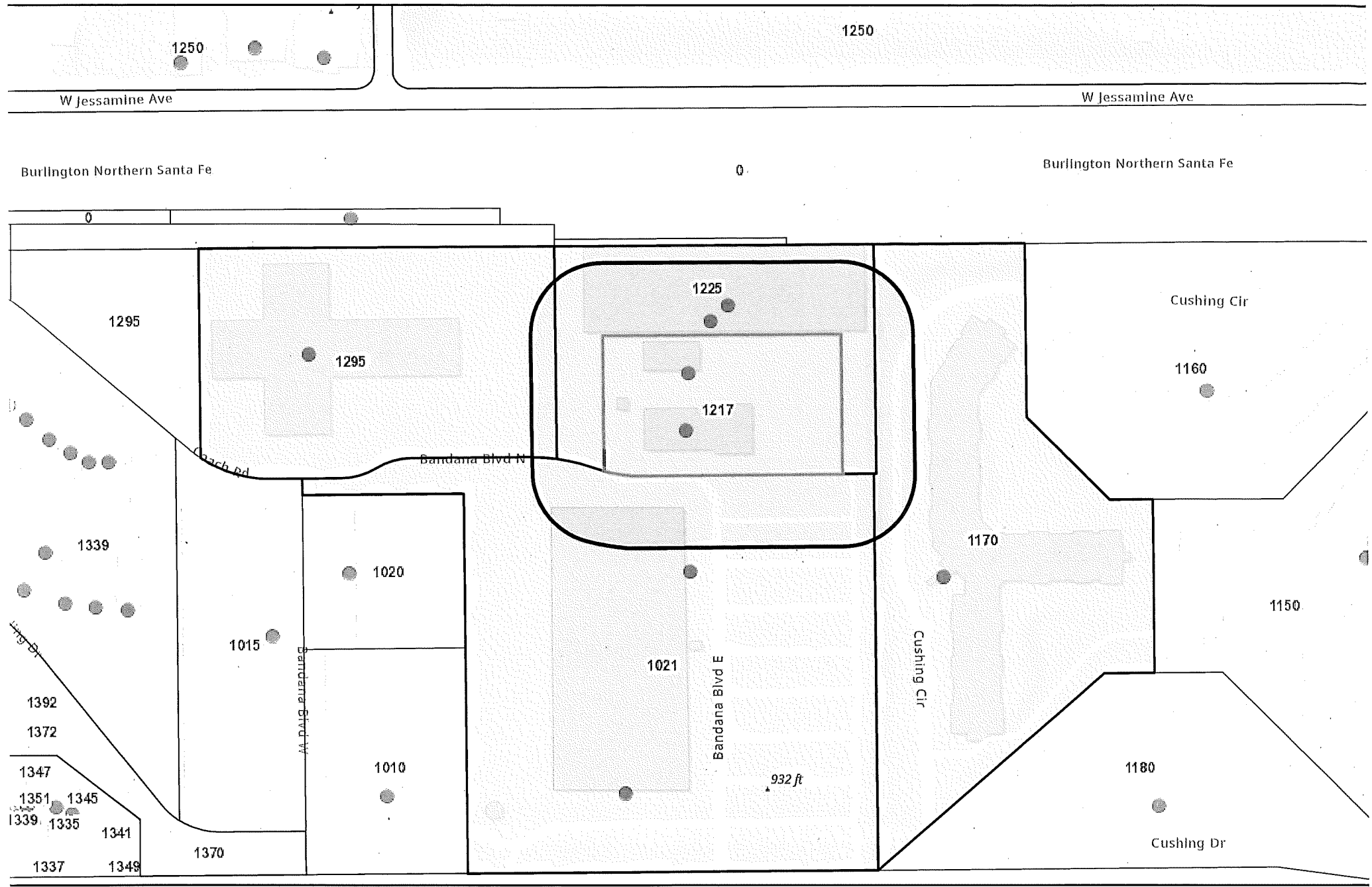

Saint Paul Minnesota
The most livable city in America

Department of Safety and Inspections (DSI), Sources: Esri, Airbus DS, USGS, NGA, NASA, CGIAR, N Robinson, NCEAS, NLS, OS, NMA, Geodastystyrelsen, Rijkswaterstaat, GSA, Geoland, FEMA, Intermap and the

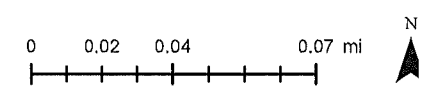

The Geographic Information System (GIS) Data to which this notice is attached are made available pursuant to the Minnesota Government Data Practices Act (Minnesota Statutes Chapter 13). The GIS Data are provided to you "AS IS" and without any warranty as to their performance, merchantability, or fitness for any particular purpose. The GIS Data were developed by the City of Saint Paul for its own internal business purposes. The City of Saint Paul does not represent or warrant that the GIS Data or the data documentation are error-free, complete, current, or accurate. You are responsible for any consequences resulting from your use of the GIS Data or your reliance on the GIS Data. You should consult the data documentation for his particular GIS Data to determine the limitations of the GIS Data and the precision with which the GIS Data may depict distance, direction, location, or other geographic features. If you transmit or provide the GIS Data (or any portion of it) to