

Saint Paul Department of Public Works
1000 City Hall Annex, 25 W. 4th St.
Saint Paul Minnesota 55102

**APPLICATION AND
ENCROACHMENT PERMIT**

STATUS: Active
No. ENC- 13-0800

PIN: 232822140012 PROPERTY ADDRESS: 1328 POINT DOUGLAS ROAD S.

ENCROACHMENT ADDRESS: 1328 POINT DOUGLAS RD. S.

PIN: _____ PROPERTY ADDRESS: _____

ENCROACHMENT ADDRESS: _____

TYPE OF ENCROACHMENT: (*areaway, cables, etc.*) PARKING LOT

DESCRIBE LOCATION OF ENCROACHMENT: INTO POINT DOUGLAS ROAD RIGHT-OF-WAY APPROXIMATELY
30 FEET; FROM INTERSECTION OF CARVER AVE TO APPROXIMATELY 150 FEET SOUTHERLY

LEGAL DESCRIPTION (*If too long attach copy*) : LOT 1, BLOCK 1, JOHN R. DUNN ADDITION

Application is hereby made for an "Encroachment Permit" as described above in accordance with the terms of Chapter 134 of the Saint Paul Legislative Code. If this application is approved, the center-signed owner(s) hereby agrees to the terms of Chapter 134 of the Saint Paul Legislative Code which shall be deemed incorporated herein by reference together with any special provisions which shall be attached hereto. All maintenance, removal operation and liability for the permitted encroachment are the responsibility of the property owner abutting the above referenced legally described property. Notice must be given to the City of Saint Paul, Department of Public Works when said encroachment is eliminated. Amended permit, if approved, replaces the permit previously issued by the City of Saint Paul under:

Ord # _____, CF # _____, Dated: _____, Chp # 134

OWNER (Fee) Print or Type: DAVID & THERESA SCHREINER

Address: 1721 ROSEWOOD AVE. N. MAPLEWOOD, MN 55109-3642

Signature (Original):  Phone #: 612-940-2833 Date: 1-2-14

Please print your Name and Title _____

OWNER (C/D or Other) Print or Type: _____

Address: _____

Signature (Original): _____ Phone #: _____ Date: _____

Please print your Name and Title _____

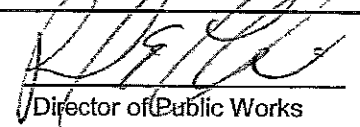
Residential 1, 2, & 3 family	APPROVED BY  Director of Public Works	Date: <u>1-8-14</u>
\$150.00 All other uses		
Amended permits		
\$150.00 Total fee (Make check payable to : City of Saint Paul)		

Comments THIS PERMIT IS ALSO SUBJECT TO THE TERMS AND CONDITIONS OF THE ^{LICENSE} AA AGREEMENT TO BE PREPARED BY THE REAL ESTATE DIVISION OF THE CITY OF SAINT PAUL.

*Pd 1-2-14
CK # 5490
Receipt # 101732*



CITY OF SEATTLE PUBLIC UTILITIES TECHNICAL SERVICES

POINT DOUGLAS RD S

THIS IS NOT A LEGAL DOCUMENT

City of Seattle
powered by

E. RLL

No parking and/or storage
"Grass"

Ea Square = 5 Feet

- A = Cars Displayed Parking Spaces For Sale
- B = Employee and Service Vehicle Parking
- C = Customer Parking

store shed
18' by 30'



No parking and/or storage

200 Feet

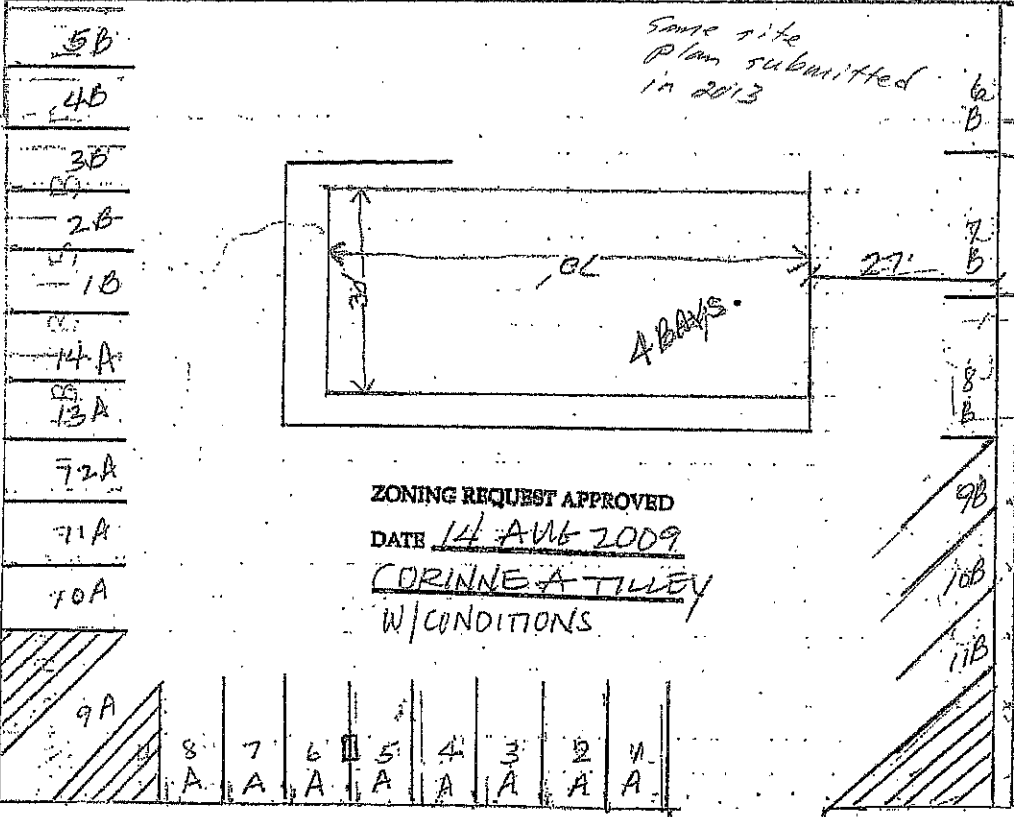

Same site
Plan submitted
in 2013

ZONING REQUEST APPROVED
 DATE 14 AUG 2009
CORINNE ATTLEY
 W/CONDITIONS

- 8 A
- 7 A
- 6 A
- 5 A
- 4 A
- 3 A
- 2 A
- 1 A

W

1328 Point Main Park Rd. S.