

P:\1319-Mark Horn-Tin Cup's Restaurant\Models\1319 - Tin Cup's Restaurant.rvt

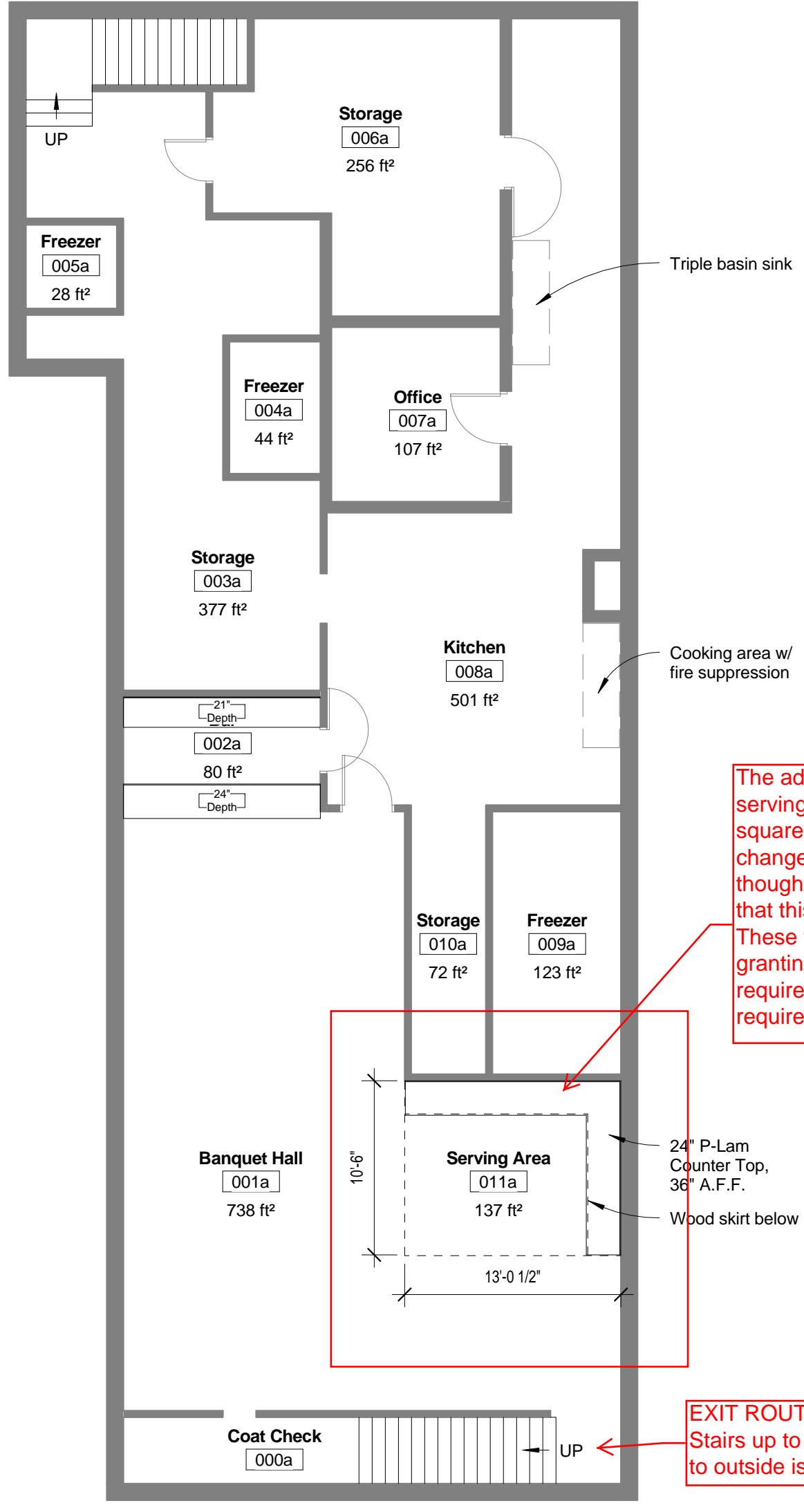

The addition of the permanent serving tables decreases the square footage of the room. It also changes the "flow of people" through the room, making it unlikely that this area would be blocked. These taken together justify granting a variance on the requirement that a second exit be required.

EXIT ROUTE.
Stairs up to the main level and door to outside is immediately to the left.

① Level -1 Option A
1/8" = 1'-0"

5/7/2013 11:06:03 AM