

SUMMIT AVENUE

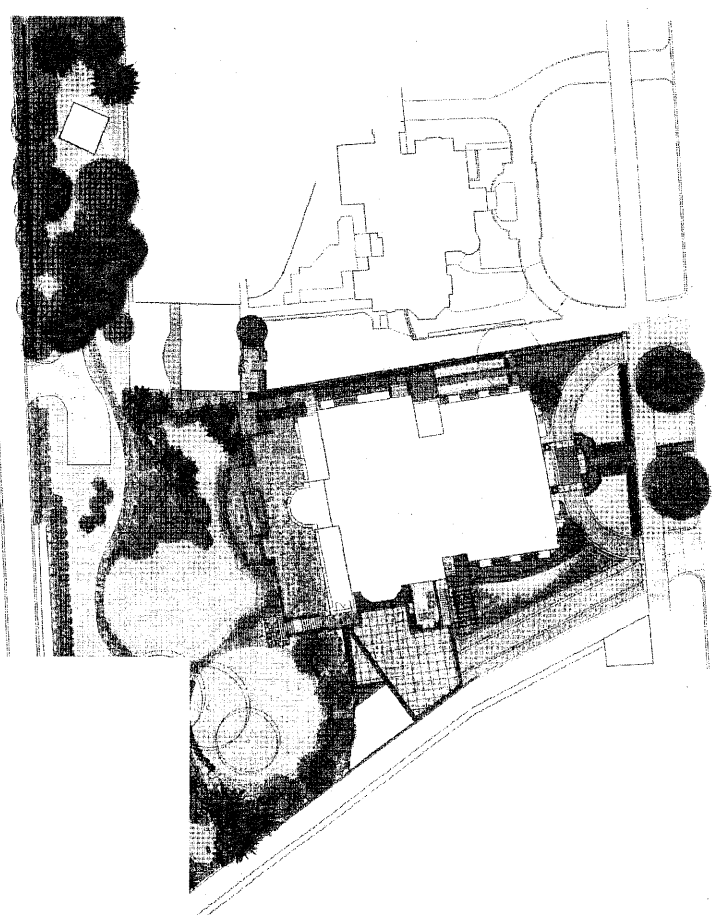
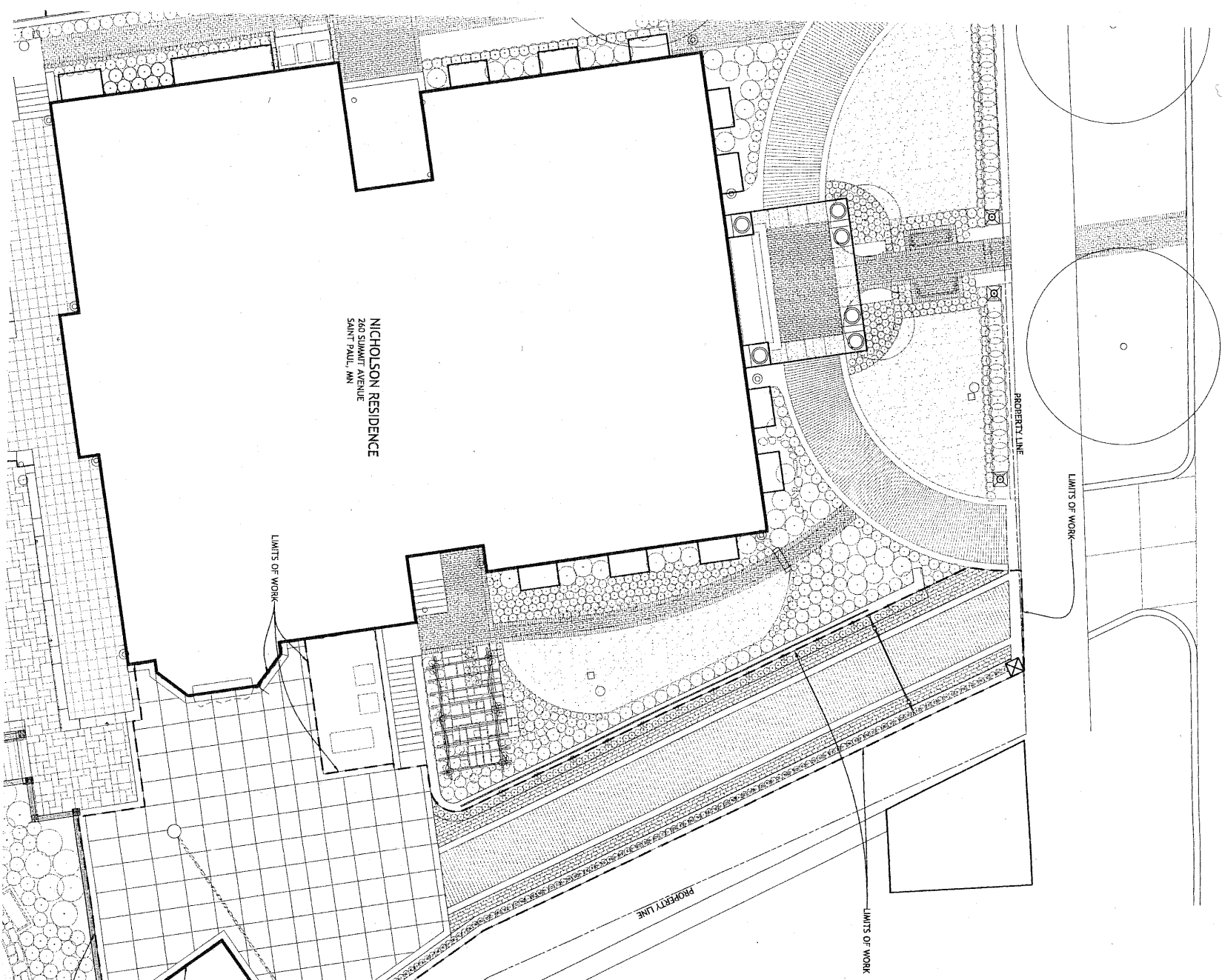

1 NICHOLSON RESIDENCE MASTER PLAN
N.T.S.

SHEET INDEX:

L0.0	COVER SHEET
L1.0	LANDSCAPE PLAN
L2.0	LANDSCAPE DETAILS
A1.0	ARCHITECTURAL SITE PLAN & ELEVATION
S1.0	STRUCTURAL WALL PLAN AND DETAILS

*not in card's Amendment
08-092498*

PLAN APPROVED

with conditions no conditions

Heritage Preservation Commission
City of St. Paul

File # 08-092498
Address 260 SUMMIT AVE.
Date 6/21/08 Signed *Christina Bar*

Any alteration from this plan must be approved by the Heritage Preservation Commission or designer for which the Commission has given authority. Leg code 73.06(e).

* SEE C.O.A. FOR CONDITIONS.

1/8" = 1'-0"

70th ANNIVERSARY
CLOSE ASSOCIATES, INC.
ARCHITECTURE THAT ENDURES
3101 East Franklin Avenue
Minneapolis, Minnesota 55405
612-339-0978 312-339-0976 Fax

CLOSE
LANDSCAPE ARCHITECTURE +
402 34 Ave North Suite 212 Minneapolis, MN 55408
P. 612.339.2782

Revisions

No.	Date	Description

Date: 23/08

008
pared
revision
1 slide

Project Title
NICHOLSON RESIDENCE PHASE 3 EXTERIOR
260 SUMMIT AVE.
ST. PAUL, MN

Sheet Title
COVER SHEET
Issue Date: 5/23/08
Project Number: 01 NIC
Sheet Number
L0.0