



PRIVATE PROPERTY TREE REMOVAL



Front Yard Back Yard Property Line Unimproved Street /Alley ROW

District # 771 Ward # 7 Citizen Request 1 / 1 Date: 6/1/04
Address: # 767 Name Pierce Butler Rte St./Ave./Blvd. N/S/E/W (W) St. Paul, MN Zip
Cross Street(s): Mnnehaha & Grove

Note left for property owner? Yes No

Inspector: Ezick Swanson DED Oak Wilt Dangerous Woodpile & Stumps

Tree Type	dbh	Location	Trees	Stems	Recheck Date	Recheck Date	Removed Date	Removed By
<u>Am. Elm</u>	<u>28"</u>	<u>Back yard alongside garage</u>	<u>1</u>	<u>1</u>				

None Pay 5+5
3-8-05

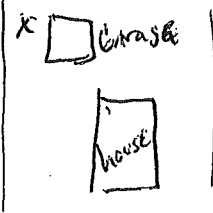
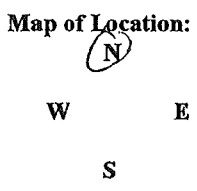

JAN 8 2005 NOT DONE
1-21-05 CB

Address

Owner Information: Bill Assess

PIN Number Taxpayer Homestead Fee Owner

Owner Name: Phone # ()

Address:

City: State: ZIP:

LETTER RE-SENT: 12/8/04

PIN Number Taxpayer Homestead Fee Owner

Other Owner Name: Resident Phone # ()

Address: 771 Pierce Butler Rt

City: St Paul State: MN ZIP: 55104

C



PRIVATE PROPERTY TREE REMOVAL

9 wires



Front Yard Back Yard Property Line Unimproved Street /Alley ROW

District # 7 Ward # _____ Citizen Request 1 / 1 / _____ Date: 6 / 1 / 104

Address: # 767 Name Pierce Butler Rte St./Ave./Blvd. _____ N/S/E/W W St. Paul, MN Zip _____
Cross Street(s): Manchahu & Grofs

Note left for property owner? Yes No

Inspector: Ezick Swanson DED Oak Wilt _____ Dangerous _____ Woodpile _____ & Stumps _____

Tree Type	dbh	Location	Trees	Stems	Recheck Date	Recheck Date	Removed Date	Removed By
Am. Elm	28"	Back yard alongside garage	1	1				

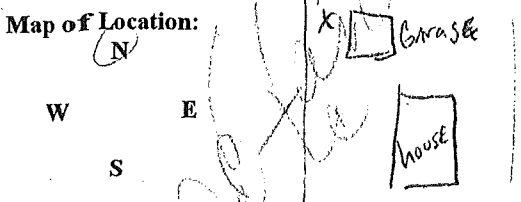

NOV 19 2004

11/30 Not started Rk

Address

Owner Information: Bill Assess

PIN Number _____ Taxpayer Homestead Fee Owner

Owner Name: _____ Phone # (____) _____

Address: _____

City: _____ State: _____ ZIP: _____

LETTER RE-SENT: ___ / ___ / ___

PIN Number _____ Taxpayer Homestead Fee Owner

Other Owner Name: _____ Phone # (____) _____

Address: _____

City: _____ State: _____ ZIP: _____



PRIVATE PROPERTY TREE REMOVAL



Front Yard ___ Back Yard Property Line ___ Unimproved Street /Alley ROW ___

District # 771 Ward # 7 Citizen Request 1/1 Date: 6/1/04

Address: # ~~767~~ Name Pierce Butler Rte St./Ave./Blvd. ___ N/S/E/W (W) St. Paul, MN Zip ___

Cross Street(s): Mnnehaha & Grofs

Note left for property owner? Yes No ___

Inspector: Erick Swanson DED Oak Wilt ___ Dangerous ___ Woodpile ___ & Stumps ___

Tree Type	dbh	Location	Trees	Stems	Recheck Date	Recheck Date	Removed Date	Removed By
<u>Am. Elm</u>	<u>28"</u>	<u>Back yard alongside garage</u>	<u>1</u>	<u>1</u>				

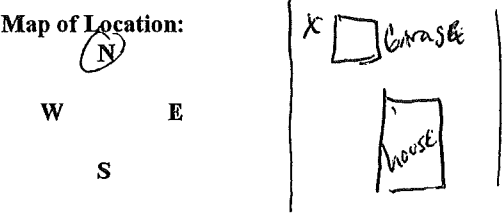

Address

Owner Information: Bill ___ Assess ___

PIN Number ___ Taxpayer ___ Homestead ___ Fee Owner ___

Owner Name: ___ Phone # () ___

Address: _____

City: _____ State: _____ ZIP: _____

LETTER RE-SENT: 12/8/04

PIN Number ___ Taxpayer ___ Homestead ___ Fee Owner ___

Other Owner Name: Resident Phone # () ___

Address: 771 Pierce Butler Rt

City: St Paul State: MN ZIP: 55104

DIVISION OF PARKS AND RECREATION
OPERATIONS



CITY OF SAINT PAUL
Randy C. Kelly, Mayor

OPERATIONS: 651-643-3473
PARK PERMITS: 651-632-5111
FORESTRY: 651-632-5129
Facsimile: 651-632-5115

1100 Hamline Avenue North
Saint Paul, Minnesota 55108

TTY: 651-266-6378
www.ci.stpaul.mn.us/dept/parks

Resident
771 Pierce Butler Route
St Paul Mn 55104-1632

Date: 12/8/2004
District: 7 **Ward:** 1
Pin#: 262923430027

Record # 04-3853

The City of Saint Paul is conducting a program for the control of tree related nuisances. It is necessary to locate and eliminate all of the dangerous trees, and all sources of Dutch Elm disease and Oak Wilt disease, including stumps or woodpiles that contain elmwood or diseased red oak with the bark attached. The city has the authority, on both public and private property, to require removal, disposal or management of diseased trees, dangerous trees and any materials that contribute to the spread of disease within the City of Saint Paul and to order the abatement of such nuisance.

Listed below is the address where the nuisance exists, the size and the location of the tree(s), stump(s), log(s), or brush which need to be taken care of by the property owner. Failure to take care of the problem will make it necessary for the city to take the necessary actions to affect the removal of the marked trees, brush and separate the bark from the marked stumps and remaining wood and bill the property owner for all costs associated with removal of the nuisance under **Chapter 175 of the Saint Paul Legislative Code**. See page two (2) for details.

Location 771 Pierce Butler Route - 28" diameter tree located in backyard alongside the garage.

- Said elm trees are dead (with tight bark), dying or infected with **Dutch Elm Disease** fungus. Trees must be removed and all stumps, wood and brush with tight bark must be recycled, chipped, burned, buried or the bark removed from all exposed wood, within one month.
- Said oak trees have been identified as having **Oak Wilt Disease**. Trees must be removed and all stumps, wood and brush with tight bark, must be chipped, burned, buried or the bark removed from all exposed wood within one month.
- Elm** logs, stumps or piles of cut elm wood or brush must be stripped of all bark or destroyed within one month, because they serve as a breeding place for the elm bark beetles which aid in the spread of dutch elm disease.
- Red** oak logs, stumps or piles of cut red oak wood or brush from oak wilt infected trees must be stripped of all bark or destroyed within one month, because they serve as a breeding place for the oak wilt fungi which contributes to the spread of oak wilt disease.
- Dangerous Trees** must be: __cut down,__ trimmed,__ bolted and cabled or __removed within one month, in order to comply with the **City Ordinance** and the protection of all people and property in Saint Paul.

DIVISION OF PARKS AND RECREATION
OPERATIONS



CITY OF SAINT PAUL
Randy C. Kelly, Mayor

OPERATIONS: 651-643-3473
PARK PERMITS: 651-632-5111
FORESTRY: 651-632-5129
Facsimile: 651-632-5115

1100 Hamline Avenue North
Saint Paul, Minnesota 55108

TTY: 651-266-6378
www.ci.stpaul.mn.us/dept/parks

Leroy A Engele
767 Pierce Butler Route
St Paul Mn 55104-1632

Date: 10/18/04
District: 7 Ward: 1
Pin#: 262923430027

Record # 04-3135

The City of Saint Paul is conducting a program for the control of tree related nuisances. It is necessary to locate and eliminate all of the dangerous trees, and all sources of Dutch Elm disease and Oak Wilt disease, including stumps or woodpiles that contain elmwood or diseased red oak with the bark attached. The city has the authority, on both public and private property, to require removal, disposal or management of diseased trees, dangerous trees and any materials that contribute to the spread of disease within the City of Saint Paul and to order the abatement of such nuisance.

Listed below is the address where the nuisance exists, the size and the location of the tree(s), stump(s), log(s), or brush which need to be taken care of by the property owner. Failure to take care of the problem will make it necessary for the city to take the necessary actions to affect the removal of the marked trees, brush and separate the bark from the marked stumps and remaining wood and bill the property owner for all costs associated with removal of the nuisance under **Chapter 175 of the Saint Paul Legislative Code**. See page two (2) for details.

Location: 767 Pierce Butler Route - 28" diameter tree located in backyard alongside the garage.

- Said elm trees are dead (with tight bark), dying or infected with **Dutch Elm Disease** fungus. Trees must be removed and all stumps, wood and brush with tight bark must be recycled, chipped, burned, buried or the bark removed from all exposed wood, within one month.
- Said oak trees have been identified as having **Oak Wilt Disease**. Trees must be removed and all stumps, wood and brush with tight bark, must be chipped, burned, buried or the bark removed from all exposed wood within one month.
- Elm** logs, stumps or piles of cut elm wood or brush must be stripped of all bark or destroyed within one month, because they serve as a breeding place for the elm bark beetles which aid in the spread of dutch elm disease.
- Red oak** logs, stumps or piles of cut red oak wood or brush from oak wilt infected trees must be stripped of all bark or destroyed within one month, because they serve as a breeding place for the oak wilt fungi which contributes to the spread of oak wilt disease.
- Dangerous Trees** must be: cut down, trimmed, bolted and cabled or removed within one month, in order to comply with the **City Ordinance** and the protection of all people and property in Saint Paul.

Run Date: 10/18/04 07:36 AM

Amanda Property - Ownership Information

House#: 767

Street Name: pierce butler

Click [Map](#) to view the map.

Click [Here](#) To access the official Ramsey County info site [New address search](#)

767 PIERCE BUTLER ROUTE - 55104-1632

Pin#: 262923430027	Census Track: 32400	Census Block: 114	Council Ward: 1	District Council: 7
Year Built: 1892	Foundation Sq Feet: 1064	Loan Company:	Land Value: 37900	Building Value: 89300

Unverified Usage: 90- SINGLE FAMILY- A- Residential **Units:** 1

Legal Desc: JOSEPH R WEIDES RE OF BLK 3 AND NORTH ONE HALF OF BLK 2 WINTER'S ADDITION TO ST. PAUL, MINNESOTA LOTS 31 AND LOT 32 BLK 3

Owner:

Leroy A Engele/Bette J Engele
767 Pierce Butler Route
St Paul MN 55104-1632

Homesteader:

Leroy A Engele/Bette J Engele
767 Pierce Butler Route
St Paul MN 55104-1632

~~740~~ 0

767 Pierce Butler One up
↓

tree is on neigh. prop. of 771

~~77~~ 488-6933

DIVISION OF PARKS AND RECREATION
OPERATIONS



CITY OF SAINT PAUL
Randy C. Kelly, Mayor

OPERATIONS: 651-643-3473
PARK PERMITS: 651-632-5111
FORESTRY: 651-632-5129
Facsimile: 651-632-5115

1100 Hamline Avenue North
Saint Paul, Minnesota 55108

TTY: 651-266-6378
www.ci.stpaul.mn.us/dept/parks

Call Leroy to meet; need to,

Leroy A Engele
767 Pierce Butler Route
St Paul Mn 55104-1632

488-6933

Sold to Jim ?

Date: 10/18/04
District: 7 Ward: 1
Pin#: 262923430027

Belongs to 771 Pierce Butler Record # 04-3135

The City of Saint Paul is conducting a program for the control of tree related nuisances. It is necessary to locate and eliminate all of the dangerous trees, and all sources of Dutch Elm disease and Oak Wilt disease, including stumps or woodpiles that contain elmwood or diseased red oak with the bark attached. The city has the authority, on both public and private property, to require removal, disposal or management of diseased trees, dangerous trees and any materials that contribute to the spread of disease within the City of Saint Paul and to order the abatement of such nuisance.

Listed below is the address where the nuisance exists, the size and the location of the tree(s), stump(s), log(s), or brush which need to be taken care of by the property owner. Failure to take care of the problem will make it necessary for the city to take the necessary actions to affect the removal of the marked trees, brush and separate the bark from the marked stumps and remaining wood and bill the property owner for all costs associated with removal of the nuisance under **Chapter 175 of the Saint Paul Legislative Code**. See page two (2) for details.

Location: 767 Pierce Butler Route - 28" diameter tree located in backyard alongside the garage.

- Said elm trees are dead (with tight bark), dying or infected with **Dutch Elm Disease** fungus. Trees must be removed and all stumps, wood and brush with tight bark must be recycled, chipped, burned, buried or the bark removed from all exposed wood, within one month.
- Said oak trees have been identified as having **Oak Wilt Disease**. Trees must be removed and all stumps, wood and brush with tight bark, must be chipped, burned, buried or the bark removed from all exposed wood within one month.
- Elm logs, stumps or piles of cut elm wood or brush must be stripped of all bark or destroyed within one month, because they serve as a breeding place for the elm bark beetles which aid in the spread of dutch elm disease.
- Red oak logs, stumps or piles of cut red oak wood or brush from oak wilt infected trees must be stripped of all bark or destroyed within one month, because they serve as a breeding place for the oak wilt fungi which contributes to the spread of oak wilt disease.
- Dangerous Trees** must be: cut down, trimmed, bolted and cabled or removed within one month, in order to comply with the **City Ordinance** and the protection of all people and property in Saint Paul.

SERVICE REQUEST REPORT

Service Request No.

0407805

0407805

Created Date: 10/25/2004 03:08 PM

WORK LOCATION

Address: 7-767 1 Pierce Butler Rt		Suite:	
Cross Street:			
City:	State:	Zip:	
Service Request Type: R-FORESTRY			
Problem Code: TREHEALTH			

Problem Description: Please re-check DED tree - Caller says it belongs to 771 Pierce Butler Rt.

Requested Date:	Crew:	Dept:	Area:
Next Approver:			
Dispatcher: AARON SCHMIDT		Call Back Ready: N	
Status: CREATED		Customer Call Back: N	
WO/Task No:		Finished Date:	

CUSTOMER INFORMATION

Customer ID:	Bill Customer: N	
Name:	Customer Call Back: N	
Work Phone:	Ext:	Home Phone:
Company:	Tax ID:	

REPORTED BY

Name: Leroy Engele	Call Back: N	
Address: 7-767 1 Pierce Butler Rt	Suite:	
City:	State:	Zip:
Work Phone:	Ext:	Home Phone:

Submitted by: SUNDMARK

SERVICE REQUEST REPORT

28 OCT 2004

07:31 AM

Service Request No.

0407805

0407805

Created Date: 10/25/2004 03:08 PM

CLOSEOUT INFORMATION

Start: _____	Finish: _____	Completed: _____
Failure: _____	Repair: _____	Further Action: _____
Comments:		
Inspected By: _____	Date: _____	
Signoff By: _____	Date: _____	
Closed By: _____	Date: _____	

CALL HISTORY

Call No: 1	Call Date: 10/28/2004 07:27:54AM
Comments:	
Response: 10/27/04 Based on unofficial survey markers, Letter should be resent to property @771 Pierce Butler. No one home at that address.	
Call Back: N	Date:
Caller Name:	
Caller Phone:	Ext:

Submitted by: SUNDMARK

Synergen Associates, Inc.
Report s_rpt138 v6.4