



CITY OF SAINT PAUL  
Christopher B. Coleman, Mayor

375 Jackson Street, Suite 220  
Saint Paul, Minnesota 55101-1806

Telephone: 651-266-8989  
Facsimile: 651-266-9124  
Web: www.stpaul.gov/dsi

## Sound Level Variance Application

City of Saint Paul Noise Ordinance (Chapter 293)

**Note:** A public hearing before the Saint Paul City Council is required. Application and fee must be received no fewer than forty five (45) days prior to the public hearing date that is before the requested Variance start date.

1. Organization/person seeking variance: Insituform
2. Mailing Address w/zip code: 1177 Birch Lake Blvd N, White Bear Lake, MN, 55110
3. Responsible person: Patrick Hillan Title: Field Engineer
4. Event Name: Ashland -Central Sewer Lining
5. Telephone: 218-820-6717 E-Mail: phillan@insituform.com
6. Date(s) during which the variance is requested: one 24 hour process between April 5th and Dec 31st 2018.
7. Noise source - Time(s) of operation: 7am-7am 24 hours  
- Time(s) of pre-event sound check: \_\_\_\_\_
8. Address or legal description of Noise source: Lining process will occur on Geranium from Edgerton to Payne.
9. Sound level requested: 70 DBA @ 50 feet after normal working hours.
10. Briefly describe the noise source and equipment involved: Running trucks with back up alarms, generators and hand held power tools.
11. Describe the steps that will be taken to minimize the noise levels: Site set up will be from 7am to 5 pm. The use of equipment with back up alarms and hand held power tools will be used during normal working hours. After hours a truck mounted boiler and critically silenced pump will be used (both under 50 DBA@ 50').
12. State reason for seeking variance (E.g. music, announcements, construction, etc.): Sewer lining process is 24 hours of continuous work.
13. Attach site diagram showing location of noise source(s), streets, stages, tents, etc. (If there will be amplified sound, indicate location and direction that all speakers will be facing.) Multiple locations may require more than one application.
14. Return completed Application, Site Diagram, and **\$172.00 fee** to: **CITY OF SAINT PAUL  
DEPARTMENT OF SAFETY AND INSPECTIONS  
375 JACKSON STREET, SUITE 220  
SAINT PAUL, MN 55101-1806**

Signature of responsible person: Patrick Hillan Date: 3-6-18

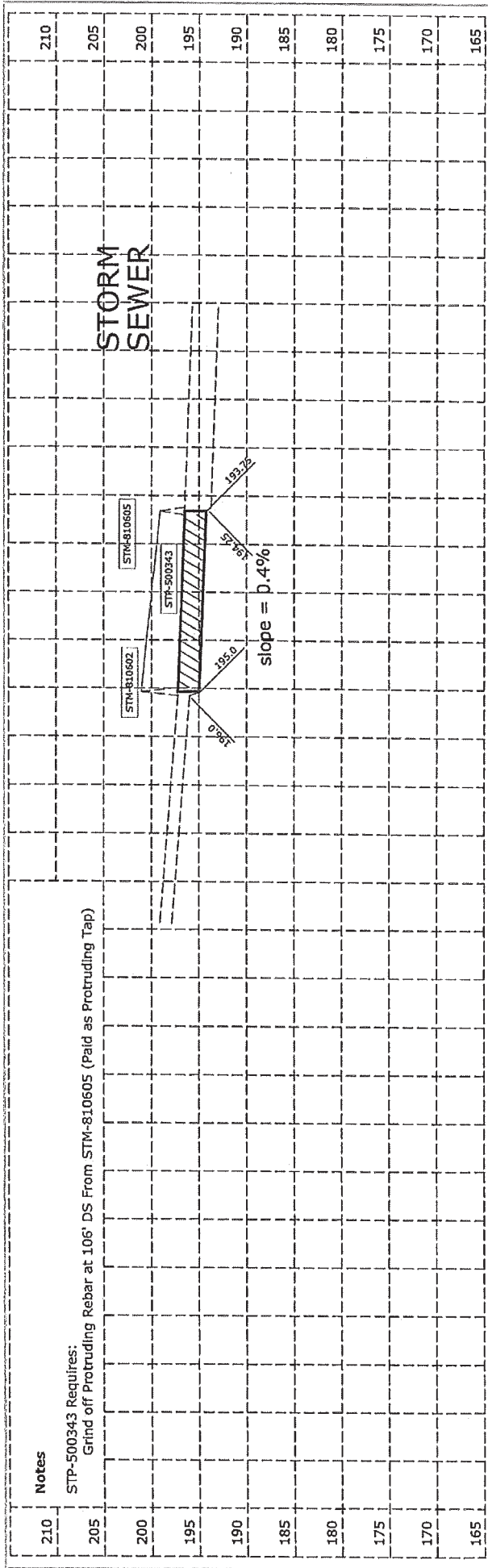

**Notes**

STP-500343 Requires:  
Grind off Protruding Rebar at 106' DS From STM-810605 (paid as Protruding Tap)



**STORM SEWER**

**Legend**

- = INSTALL PIPE LINING
- - - = SANITARY SEWER
- - - = STORM SEWER
- X = RESTORE SERVICE CONNECTION
- ▲ = IDENTIFY SEWER SERVICE BY FIELD INVESTIGATION
- = VERIFY CONNECTION TO M.H.

**INSTALL 186.7 L.F. 27" PIPE LINING**

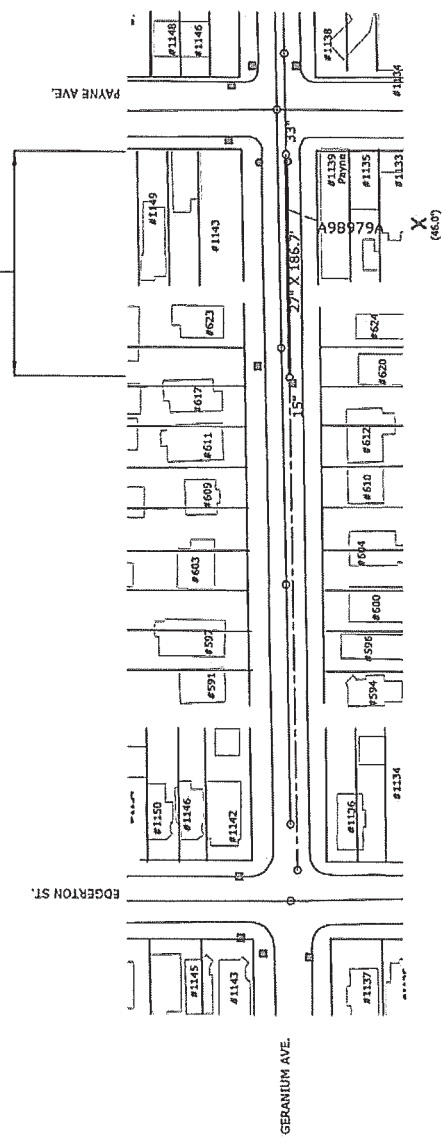

	DRAWN	P.J.L.	PROJECT: 17-S-2037	STRIP MAP NUMBER	1994
	CHECKED	L.H.	DRAWN: 10	CAD LOCATION: Z:\SEWERS\PROJECTS\2017\ASHLAND-CENTRAL	
APPROVED	S.M.O.		DWG. NO. S515	DRAWN ON: 10/20/2017	SHEET NO. 99 OF 128 SHEETS
			FOR THE CITY OF ST. PAUL, DEPARTMENT OF PUBLIC WORKS <b>ASHLAND-CENTRAL SEWER LINING</b> PREPARED BY THE SEWER DESIGN DIVISION		
			GERANIUM AVENUE Edgerton to Payne		