

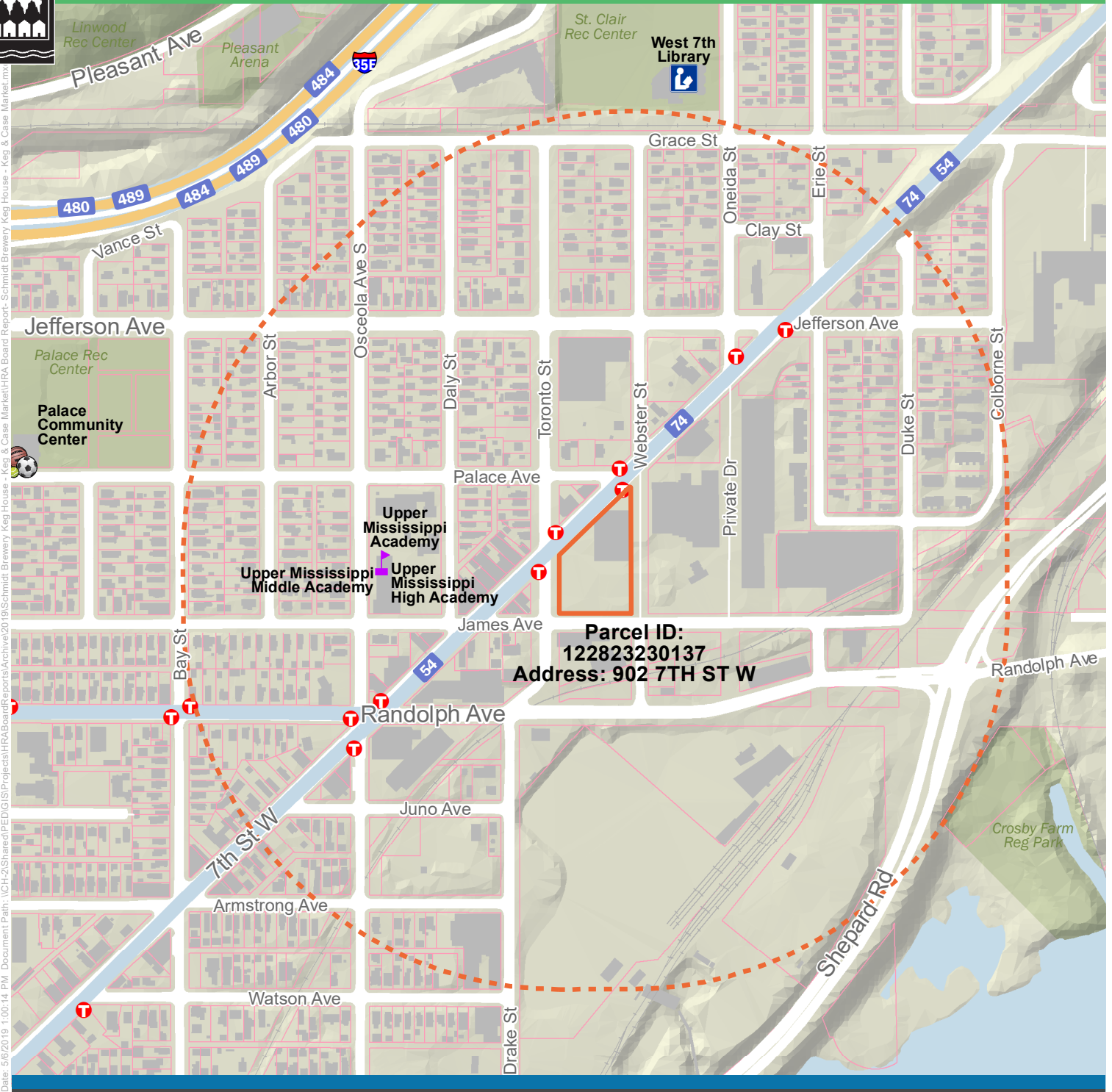

Schmidt Brewery Keg House - Keg & Case Market

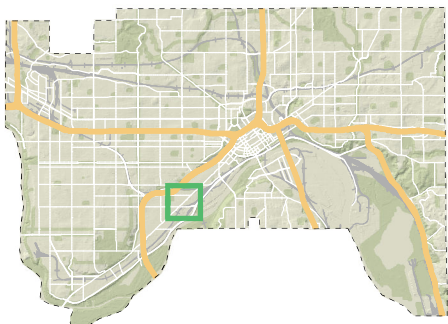

Date: 5/6/2019 1:00:14 PM Document Path: \\CH-2\Share\PED\GIS\Projects\HRA\Board\Reports\Arch\19\Schmidt Brewery Keg House - Keg & Case Market\HRA Board Report - Schmidt Brewery Keg House - Keg & Case Market.mxd



- Bus Routes
- Bus Stops
- Libraries
- Parcels
- Recreation Centers
- Schools
- Subject Parcel(s)
- Quarter Mile Distance

This document was prepared by the Saint Paul Planning and Economic Development Department and is intended to be used for reference and illustrative purposes only. This drawing is not a legally recorded plan, survey, official tax map or engineering schematic and is not intended to be used as such. Data sources: City of Saint Paul (Parks, Street Centerlines, Libraries, Rec Centers); Ramsey County (Street Outlines, Building Footprints, Parcels); Minnesota Geospatial Commons (Hydrography, Highways, Transit Lines and Stops, and Topography)

