



CITY OF SAINT PAUL

Business Licensing Telephone: 651-266-8989
375 Jackson Street, Suite 220 Facsimile: 651-266-9124
Saint Paul, Minnesota 55101-1806 Web: www.stpaul.gov/dsi

Sound Level Variance Application

Legislative Code Chapter 293. - Noise Regulations

Application and \$175 fee payment should be submitted a minimum of sixty (60) days prior to the scheduled event start date. A public notification period is required prior to scheduling the application's Public Hearing before the Saint Paul City Council. Applications received fewer than sixty (60) days prior to the event may not satisfy the ordinance's processing timelines for placement on the Council's agenda.

1. Organization/person seeking variance: Granite Inliner, LLC.
2. Event Name: City Wide Sewer Lining
3. Address and physical description of noise source location (Event, Worksite): On Marshall Ave between Snelling and Asbury (Plan Sheet 14)
4. Responsible person: Daniel Banken Title: Area Manager
5. Telephone: 651-347-4850 E-Mail: daniel.banken@gcinc.com
6. Date(s) variance requested: Sewer work will occur between 09/08/2020 and 10/09/2020

- Sewer lining requires two operations. First the sewers are cleaned and inspected and then the sewers are rehabilitated by installing a cured in place pipe inside of the existing sewer.
- Granite Inliner will spend a total of 7 nights performing cleaning and lining operations.
- Night work is specified to minimize the impacts associates with construction activity to businesses, property owners, residents, pedestrians, and vehicular traffic.
- It will take 3 nights to clean the sewer and 4 nights to install the liners.
- In general , sewer lining will occur within 4 weeks after sewers are cleaned.
- Sewer rehabilitation work will progress as follows:
 - Night work will begin at 6:00 pm and end by 7:00 am the following day
 - Sewer cleaning and inspection will occur over 3 consecutive night shifts. Sewer cleaning is done under live flow conditions, so sewer use is not impacted.
 - Sewer lining will occur over 4 consecutive night shifts. During the sewer lining process, properties can't use water or they risk a sewer back up.
- If the sound variance is approved, Granite will notify affected property owners with 300 FT of the work location a minimum of 48 hour in advance of commencing work.

7. Noise source - Time(s) of operation: Construction work associated with nighttime cleaning and lining of sewers

- Time(s) of pre-event sound check: No pre-event sound check will be done

8. Sound level requested (dBA/Decibels): 80 decibels (dba) @ fifty (50) feet during construction activities

9. Mailing address w/zip code: 16028 Forest Blvd N, #353 Hugo, MN 55038

10. Briefly describe the noise source and equipment involved: Noise will be caused by personnel and heavy trucks used in sewer lining operations. Construction equipment will include trucks, heavy equipment, pumps, boiler units, and handheld power units.

11. Describe the steps that will be taken to minimize the noise levels: Site set up will occur between 6:00 pm and 10:00 pm. Construction activities will be scheduled to minimize noise as much as possible in the late night and early morning hours.

12. State reason for seeking variance (example - music, announcements, construction, etc.): Night work is specified to minimize impacts associated with construction activity to businesses, property owners, residents, pedestrians, and vehicular traffic.

13. A site diagram & map must be attached showing location of noise source(s), streets, stages, tents, etc. (If there will be amplified sound, indicate location and direction that all speakers will be facing).

Multiple locations may require more than one application.

14. Submit completed application, site diagram/map, and \$175.00 fee to:

CITY OF SAINT PAUL
DEPARTMENT OF SAFETY AND INSPECTIONS
375 JACKSON STREET, SUITE 220
SAINT PAUL, MN 55101-1806

Signature of responsible person: _____

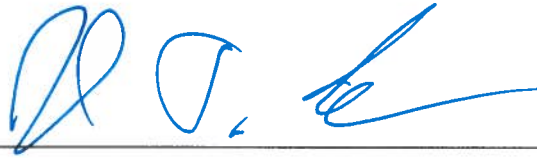

Date: _____

5/15/2020

AA-ADA-EEO Employer

February 2020

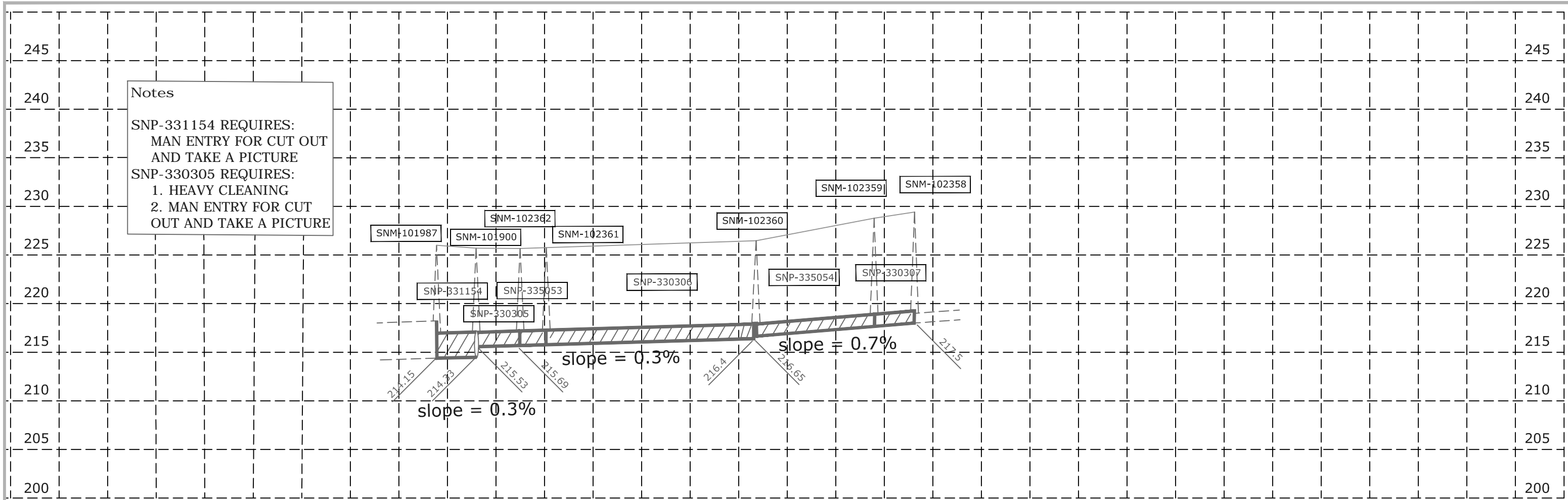

Notes

SNP-331154 REQUIRES:
MAN ENTRY FOR CUT OUT
AND TAKE A PICTURE

SNP-330305 REQUIRES:
1. HEAVY CLEANING
2. MAN ENTRY FOR CUT
OUT AND TAKE A PICTURE

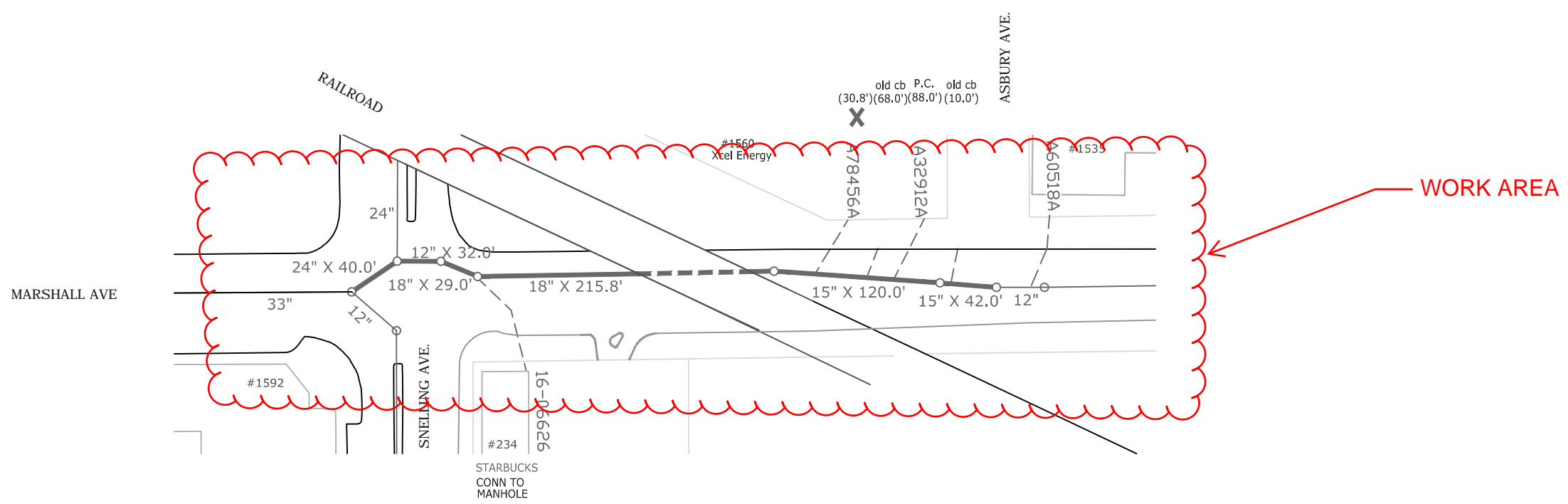
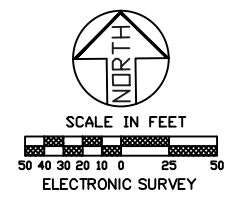

MARSHALL AVENUE
Snelling to Asbury

	DRAWN	PJL
	CHECKED	LJH
	APPROVED	SMO

I HEREBY CERTIFY THAT THIS PLAN, SPECIFICATION OR REPORT WAS PREPARED BY ME OR UNDER MY DIRECT SUPERVISION AND THAT I AM A DULY LICENSED PROFESSIONAL ENGINEER UNDER THE LAWS OF THE STATE OF MINNESOTA

Signed: *Shawn M. O'Keefe*
SHAWN M. O'KEEFE Date: 11/4/2019 Lic. No. 42402

PREPARED BY THE SEWER DESIGN DIVISION FOR THE CITY OF ST. PAUL, DEPARTMENT OF PUBLIC WORKS

2019 SEWER LINING

PROJECT: 19-S-2061	STRIP MAP NUMBER 2659 2658	WARD: 1 4	DISTRICT COUNCIL: 13 Union Park
DRAWER: 10	CAD LOCATION: Z:\SEWERS\PROJECTS\2019\2019 City Wide Sewer Lining\		
DWG. NO. 5530	DRAWN ON: 10/01/2019	SHEET NO. 14 OF 67 SHEETS	