

	A	B	C	D
1	Property Owner (PO)	PO Mail-to Address	PO Mail-to City/State/Zip	PIN
2	JAMES R KRAWETZ	44 PRIOR AVE S	ST PAUL MN 55105-1424	332923120181
3	THOMAS P HAMMERLINDL	672 FAIRVIEW AVE N	ST PAUL MN 55104-1712	332923120153
4	HEATHER M OCZKOWSKI	642 FAIRVIEW AVE N	SAINT PAUL MN 55104-1711	332923120182
5	GJMH LLC	635 FAIRVIEW AVE N	SAINT PAUL MN 55104-1709	332923210004
6	BAUER BUILT INC	PO BOX 248	DURAND WI 54736-0248	332923210003
7	MINNESOTA COMMERCIAL RAILWAY	508 CLEVELAND AVE N	ST PAUL MN 55104-1804	332923220035
8	CHARLES AVE EXCHANGE	1907 CHARLES AVE	SAINT PAUL MN 55104-1439	332923240004
9	ARVOLD PROPERTIES LLC	622 PRIOR AVE N	SAINT PAUL MN 55104-1740	332923210006
10	CH-MIDWAY LLC	1717 MCKINNEY AVE STE 1900	DALLAS TX 75202-1253	332923210001
11	MATTHEW BENYON	670 FAIRVIEW AVE N	SAINT PAUL MN 55104-1712	332923120154
12	HINPEG LLC	2424 KENNEDY ST NE	MINNEAPOLIS MN 55413-2806	332923210002
13	MENARD INC	4777 MENARD DR	EAU CLAIRE WI 54703-9604	332923220037
14	MENARD INC	5101 MENARD DR	EAU CLAIRE WI 54703-9604	332923220036
15	JIN Z ZOU	1439 WELLESLEY AVE	SAINT PAUL MN 55105-2420	332923120184
16	TRACY J LINDGREN	664 FAIRVIEW AVE N	SAINT PAUL MN 55104-1712	332923120155
17	SUNGARD RECOVER SERVICES INC	680 E SWEDESFORD RD	WAYNE PA 19087-1605	332923210005
18	NORTHERN SALT PROPERTIES LLC	20920 FOREST RD N # 1028	FOREST LAKE MN 55025-9767	332923210010
19	JEFFREY A CHERMAK	640 FAIRVIEW AVE N	ST PAUL MN 55104-1711	332923120183
20	MICHAEL NAYMAN	1818 BLAIR AVE	ST PAUL MN 55104-1704	332923120180

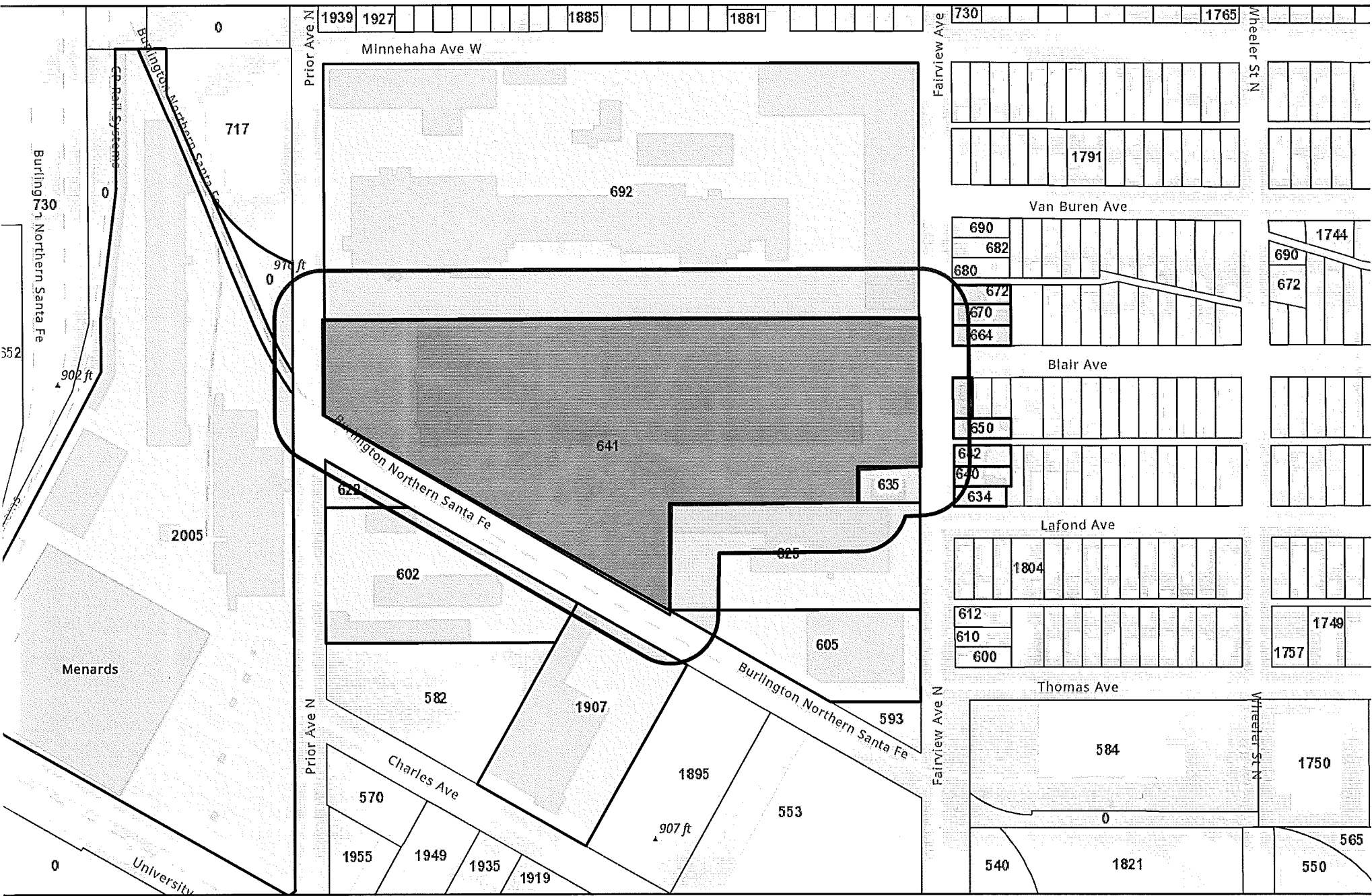

**Saint Paul Minnesota**  
*The most livable city in America*

Sources: Esri, Airbus DS, USGS, NGA, NASA, CGIAR, N Robinson, NCEAS, NLS, OS, NMA, Geodastyrelsen, Rijkswaterstaat, GSA, Geoland, FEMA, Intermap and the GIS user community, City of Saint Paul - Public Works

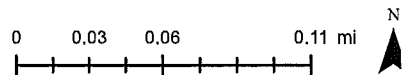

The Geographic Information System (GIS) Data to which this notice is attached are made available pursuant to the Minnesota Government Data Practices Act (Minnesota Statutes Chapter 13). The GIS Data are provided to you "AS IS" and without any warranty as to their performance, merchantability, or fitness for any particular purpose. The GIS Data were developed by the City of Saint Paul for its own internal business purposes. The City of Saint Paul does not represent or warrant that the GIS Data or the data documentation are error-free, complete, current, or accurate. You are responsible for any consequences resulting from your use of the GIS Data or your reliance on the GIS Data. You should consult the data documentation for his particular GIS Data to determine the limitations of the GIS Data and the precision with which the GIS Data may depict distance, direction, location, or other geographic features. If you transmit or provide the GIS Data (or any portion of it) to