



CITY OF SAINT PAUL  
Mayor Melvin Carter

400 City Hall Annex  
25 West 4<sup>th</sup> Street  
Saint Paul, Minnesota 55102

Telephone: 651-266-6400  
Facsimile: 651-292-7311  
www.stpaul.gov/parks

### Trail Construction on Plato Boulevard (CSAH 40) for The Robert Piram Regional Trail Ramsey County Municipally-led Project Submittal

#### Project Description

This project addresses the Plato Blvd. segment of the Robert Piram Regional Trail, a planned 3.7 mile long public transportation and recreational trail corridor link that will connect Harriet Island and Lilydale Regional Park trails in the south portion of the City and beyond to Kaposia Landing Park in the City of South St. Paul. The trail along Plato Blvd. will provide a safe, grade-separated, transportation route to reduce conflicts between pedestrians and vehicles and increase accessibility. The Robert Piram Regional Trail project is being funded through a combination of local and federal funding sources. Supporting this trail recognizes the importance of developing a multi-state national trail to bring quality of life and economic benefits to the entire metropolitan region.

#### Existing Conditions

Plato Blvd. is an urban, major collector roadway with primarily park, commercial and light industrial adjacent land use. The trail project is in an area of concentrated poverty and will serve as a transportation route for bicyclists and pedestrians coming from South St. Paul and St. Paul's West Side neighborhood to make connections to other regional parks and trails and to Saint Paul's downtown business district.

#### Infrastructure

Pedestrian sidewalks and crossings:

The existing sidewalk for the north side of Plato is 5' wide and conditions of wear vary from moderate to poor. There is no accessible route across Water Street to Harriet Island along Plato Blvd. The sidewalk terminates prior to the intersection. Accessible north-south crossings with median refuge are limited to the east side of Water, and at Wabasha, Robert, and the Lafayette frontage roads.

Roadway Infrastructure (WB & EB Plato Blvd. – Water St. to Wabasha)

Existing conditions include bituminous roadway surface, raised 10' median, and B624 curbs. Concrete and bituminous surfaces show cracks and wear.



View west towards Harriet Island of existing sidewalk terminus at Water St.



Eastbound and Westbound travel lanes for Plato Blvd. at Water Street.

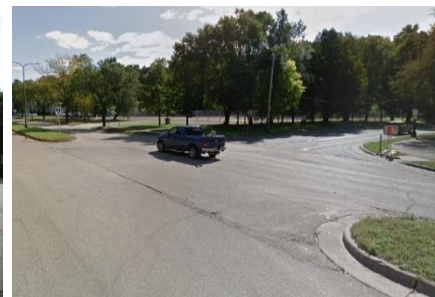

View of north-south crossing conditions at Ohio Street



CAPRA Accreditation

An Affirmative Action Equal Opportunity Employer



National Gold Medal Award



View west along Plato at Starkey St. Railroad crossing.



View west along Plato between Eva and Robert Streets.



View west of sidewalk and signal at TH 52 bridge and E. Lafayette frontage road.

### Traffic

The segment of Plato Blvd. from Water St. to Wabasha has a relatively low ADT of 4,900 (2017). Given the proposed ADT is the same for 2038, the project proposes to narrow the median and eliminate an eastbound traffic lane to place the trail between the street and boulevard trees. The current roadway configuration from Wabasha to Lafayette is the minimum width required for the ADT it serves, therefore narrowing the street was not considered. The segment of Plato Blvd. from Wabasha to Robert Street has an ADT of 7,800 and Robert Street to Lafayette Road has an ADT of 15,200.

### Proposed Improvements

The total length of improvements along Plato Blvd.(CSAH 40) in Ramsey County is 1.04 miles. See attached map for proposed locations of work. In addition to improving roadway infrastructure, the project will provide a safe, grade-separated, transportation route, helping to reduce conflicts between pedestrians and vehicles. Construction for this project will include the following:

- Sidewalk construction and new shared-use trail along the North side of Plato Blvd. from Water Street to E. Lafayette frontage road.
- Mill and overlay and roadway reconstruction for portions of WB Plato from Water St. to Wabasha.
- Mill and overlay of EB Plato from Water St. to Wabasha.
- Improved East-West pedestrian crossings and accessible ramps to meet current ADA standards
- New accessible North-south pedestrian crossings with median refuge at Water, Ohio, Livingston, State, and Eva Streets.
- Traffic signal and roadway infrastructure improvements.

Typical Section Type 1  
(Water Street to Wabasha)

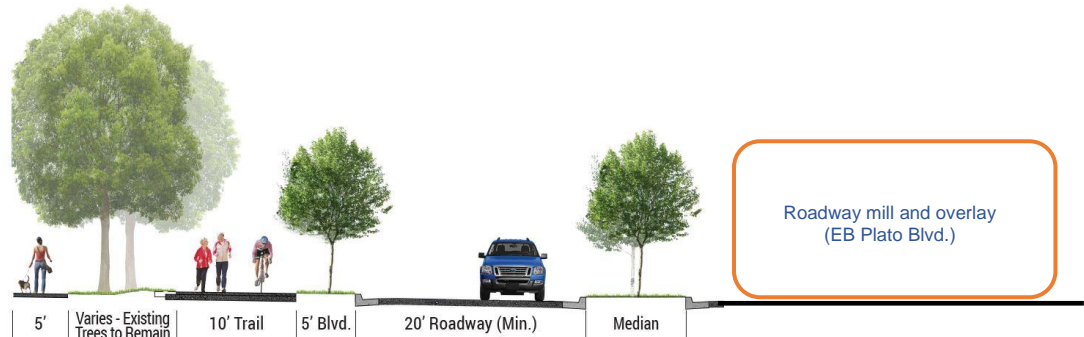

Typical Section Type 2  
(Wabasha to E. Lafayette)



### *Property*

Permanent and temporary easements are required along the Plato Blvd. segment of the trail affecting 16 parcels. The City has been working with property owners since 2017 to negotiate terms for agreement for these parcels. Of the 16 parcels, 3 require both permanent and temporary easement, the remaining 13 only require temporary easement for construction.

### *Timing and Significance*

This regional trail connection from Harriet Island to South Saint Paul has been identified as part of City-wide and Regional planning efforts including the Great River Passage Master Plan, the 2040 Regional Parks Policy Plan, and Saint Paul Parks and Recreation System Plan. The planning efforts to implement this trail have been underway since 2011 and the project is now approaching the ability to begin construction in 2019. Special timing opportunities and considerations include access to federal funding for cost participation, grant availability for required local match, and agreements with property owners subject to timing of construction. Constructing the section along Plato Blvd. is integral to the successful completion of the overall 3.7 mile trail and project goal of filling a gap in the regional trail system.

## **Proposed Costs and Funding**

### **Estimated Costs**

Construction Cost	\$ 1,615,565
Design Engineering and Inspection*	\$ 387,736
TOTAL	<u>\$ 2,003,301</u>

### **Proposed Funding**

#### *Construction*

Ramsey County Funds	\$ 412,279
Saint Paul Funds	\$ 1,203,286

#### *Design Engineering and Inspection*

Ramsey County Funds	\$ 98,947
Saint Paul Funds	\$ 288,789
TOTAL**	<u>\$ 2,003,301</u>

---

\* Assumes 24% of construction cost

\*\* Total project cost refers only to the trail segment within Ramsey County right of way. The Robert Pira Regional Trail project has received federal funding from the FHWA. Sources for the entire project are made up of a combination of local and federal funds.

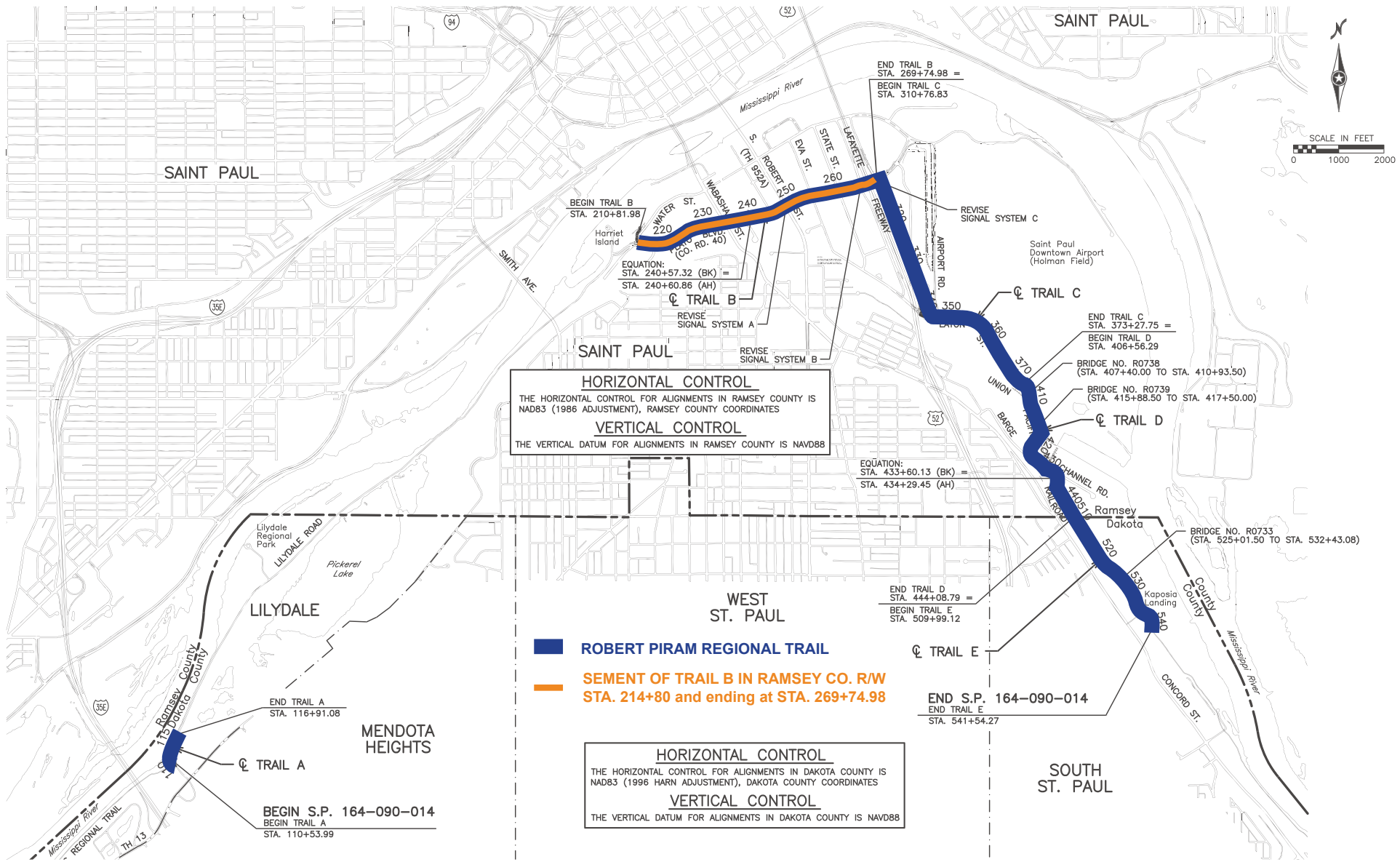

LAYOUT MAP: Robert Piram Regional Trail on Plato Blvd. (CSAH 40)

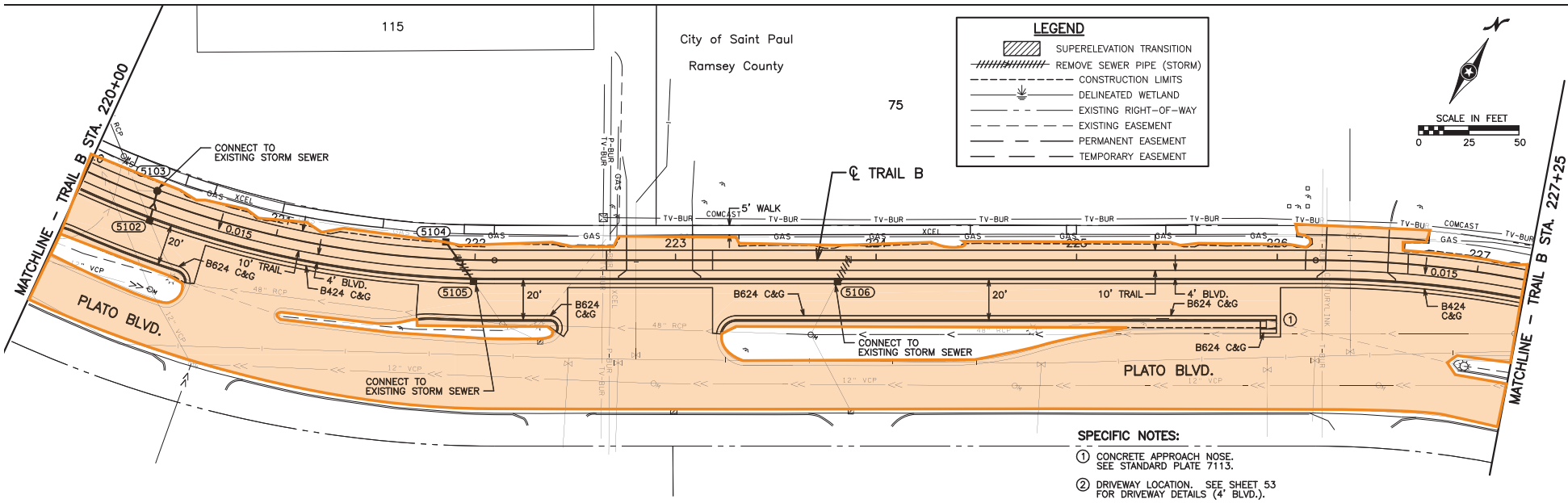
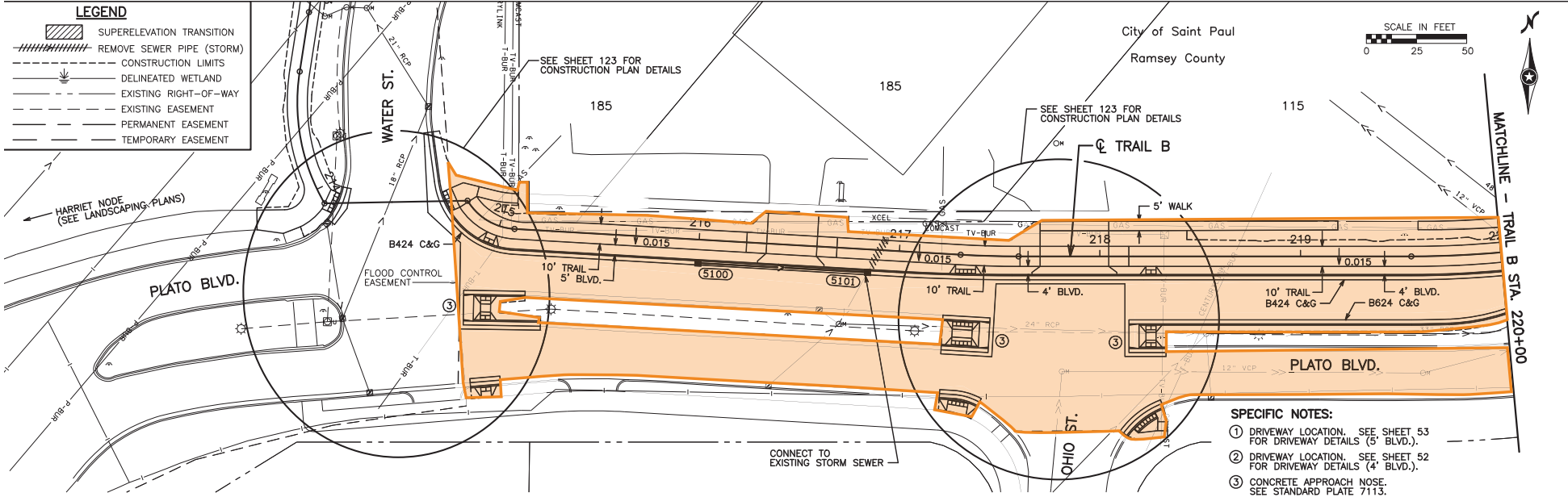

**PROJECT LIMITS: Robert Piram Regional Trail on Plato Blvd. (CSAH 40)**

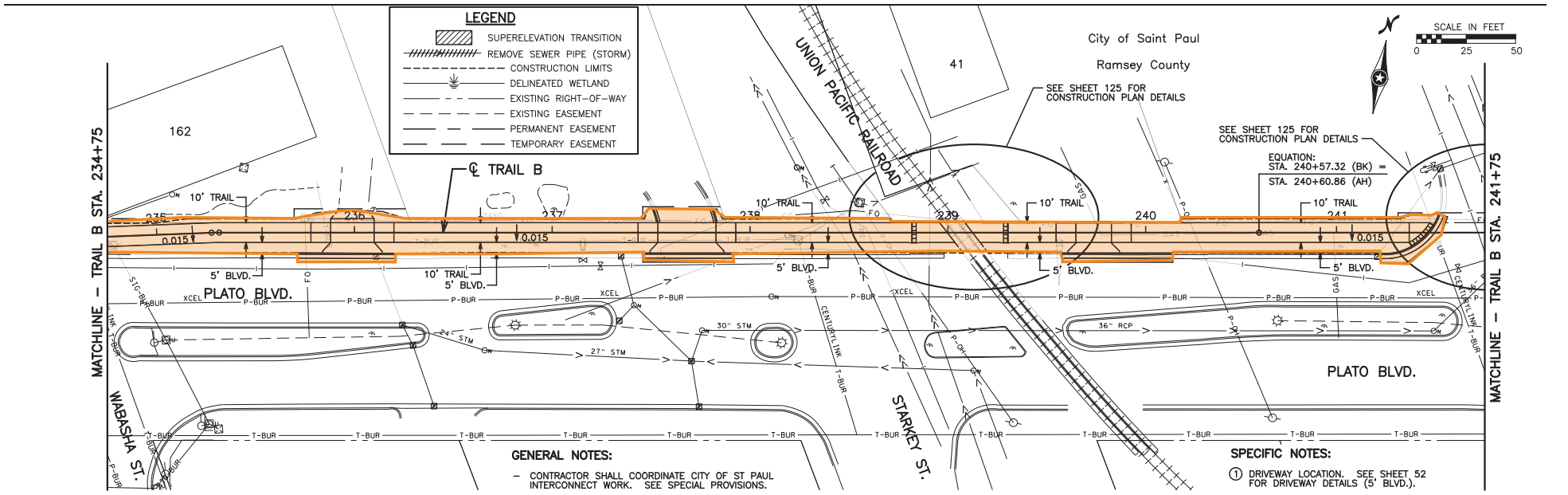
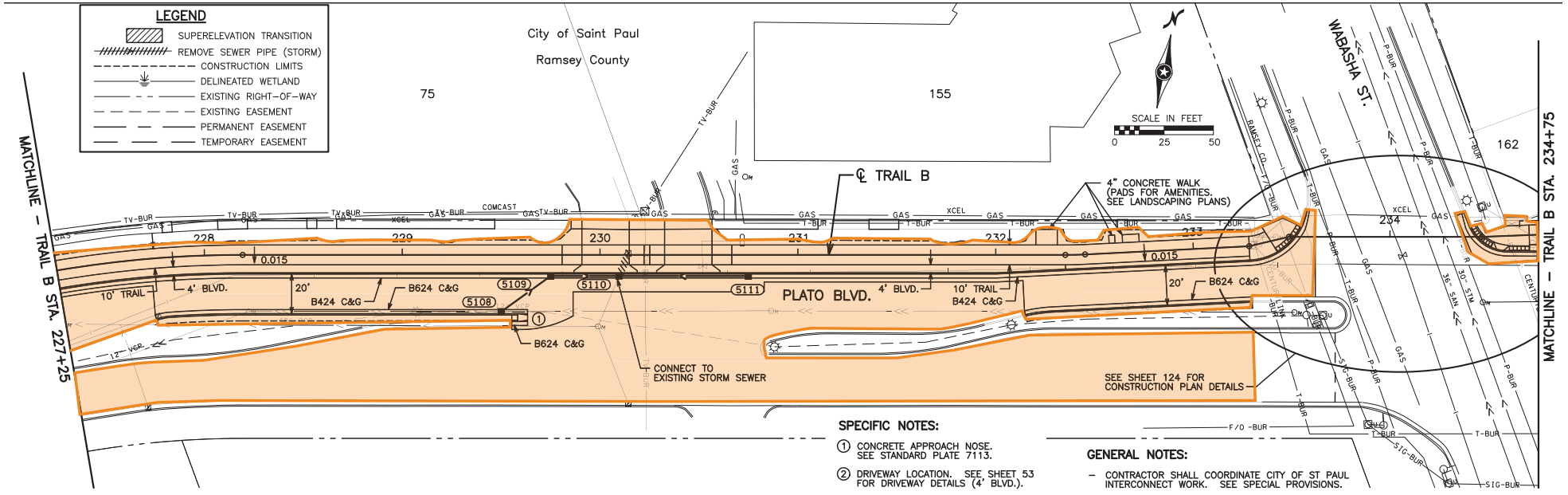

**PROJECT LIMITS: Robert Piram Regional Trail on Plato Blvd. (CSAH 40)**

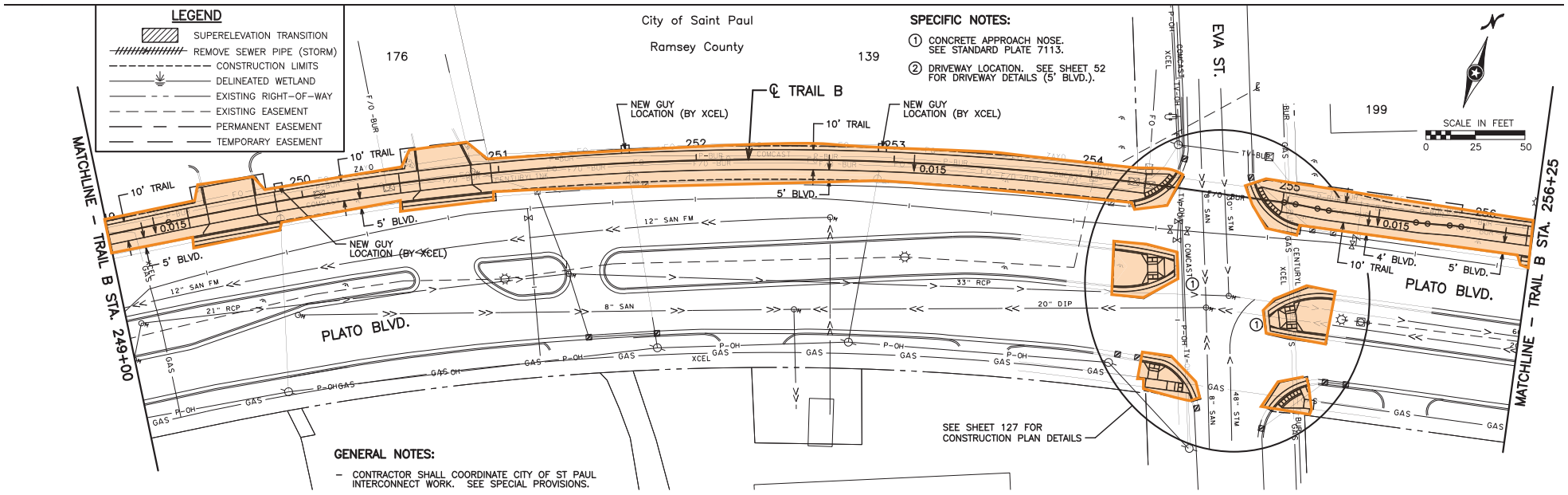
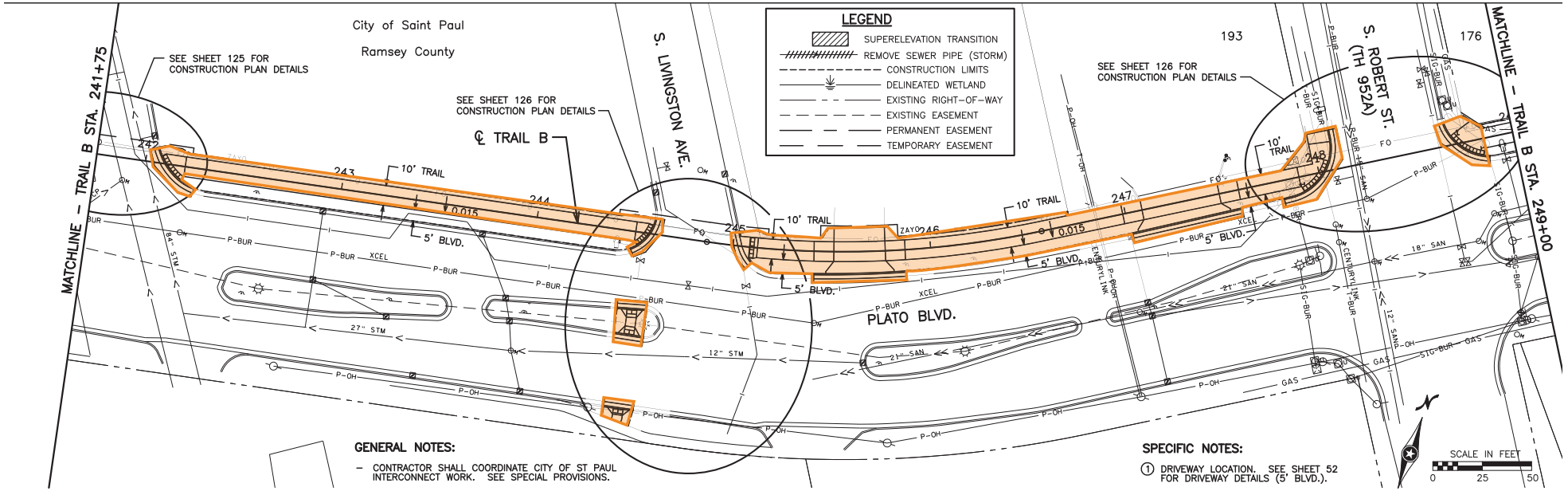

**PROJECT LIMITS: Robert Piram Regional Trail on Plato Blvd. (CSAH 40)**

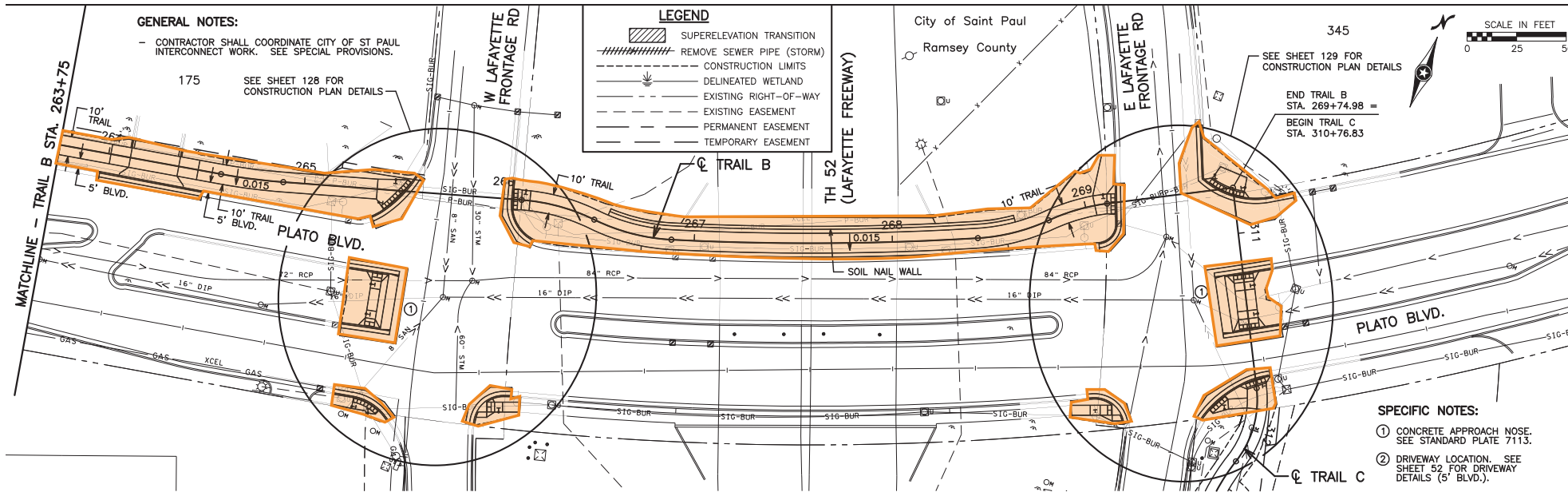
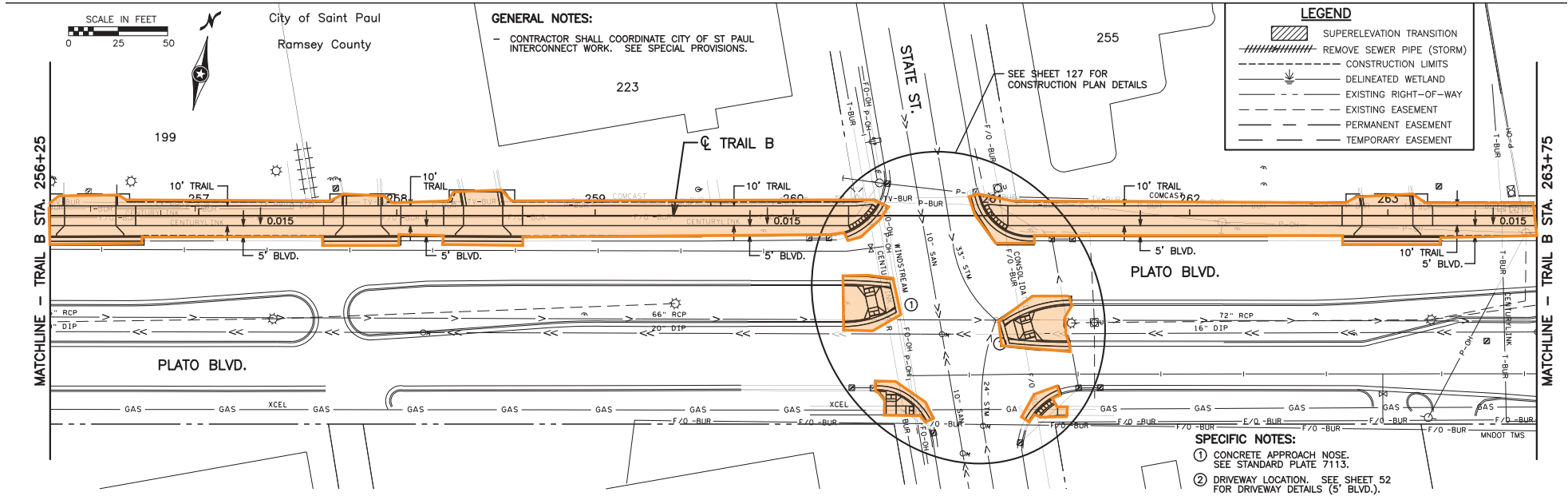

**PROJECT LIMITS: Robert Piram Regional Trail on Plato Blvd. (CSAH 40)**