

BAR IS ONE INCH ON ORIGINAL DRAWING. IF NOT ONE INCH ON THIS DRAWING ADJUST SCALES ACCORDINGLY.

PLOT DATE: Feb 12, 2021 - 5:24pm  
 FILENAME: K:\n-2\SIPaul-ParksRec\17921002\04\_Production\01\_CAD\02\_Sheets\C301 - Site Plan.dwg

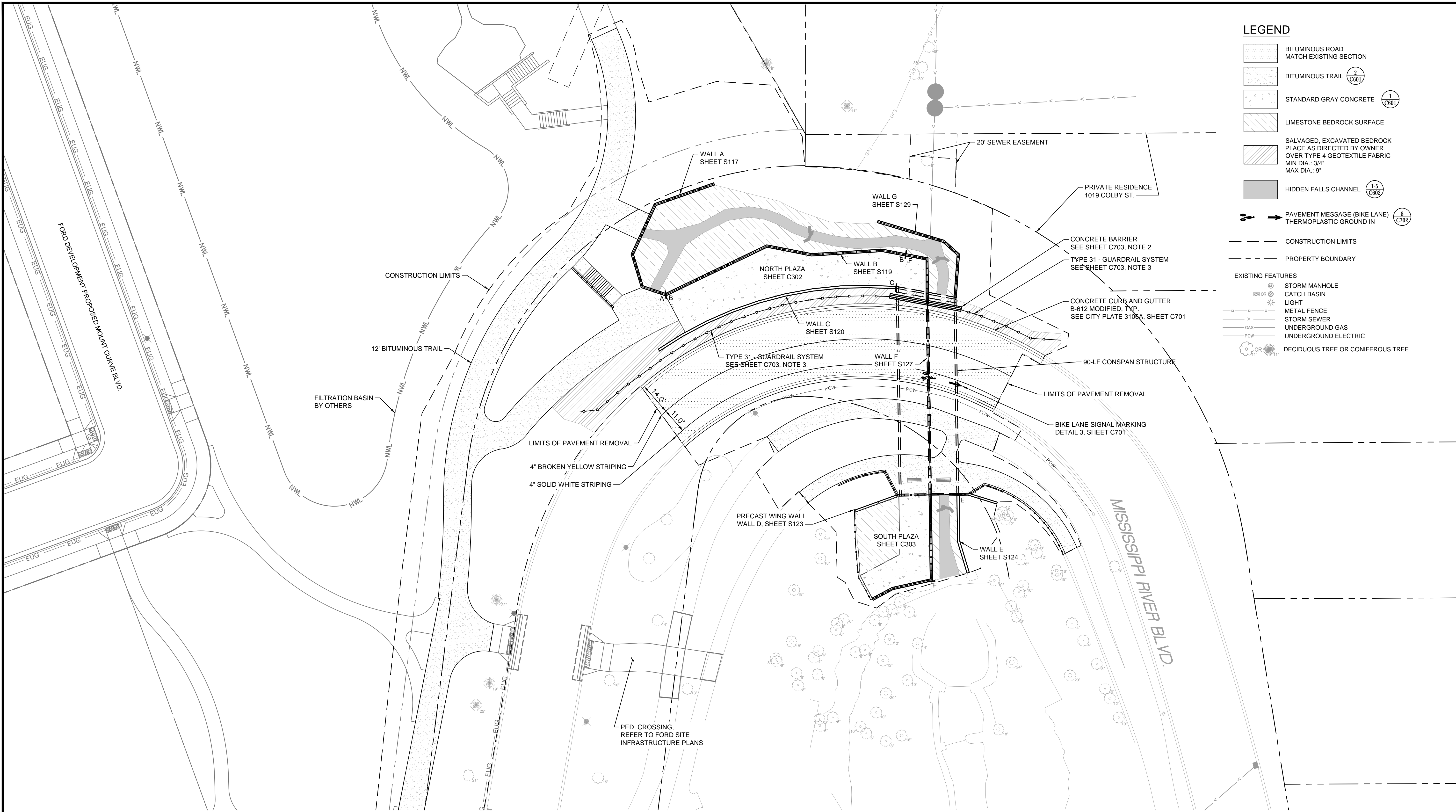

- LEGEND**
- BITUMINOUS ROAD MATCH EXISTING SECTION
  - BITUMINOUS TRAIL (2) (C601)
  - STANDARD GRAY CONCRETE (1) (C601)
  - LIMESTONE BEDROCK SURFACE
  - SALVAGED EXCAVATED BEDROCK PLACE AS DIRECTED BY OWNER OVER TYPE 4 GEOTEXTILE FABRIC MIN DIA.: 3/4" MAX DIA.: 9"
  - HIDDEN FALLS CHANNEL (1-5) (C602)
  - PAVEMENT MESSAGE (BIKE LANE) THERMOPLASTIC GROUND IN (8) (C702)
  - CONSTRUCTION LIMITS
  - PROPERTY BOUNDARY
- EXISTING FEATURES**
- STORM MANHOLE
  - CATCH BASIN
  - LIGHT
  - METAL FENCE
  - STORM SEWER
  - UNDERGROUND GAS
  - UNDERGROUND ELECTRIC
  - DECIDUOUS TREE OR CONIFEROUS TREE

**1 SITE PLAN**  
 C301 1"=20'  
 SCALE IN FEET  
 NORTH

NO.	DATE	BY	DESCRIPTION OF REVISIONS
1	2/12/2021	JNL	90% SUBMITTAL

DESIGNED	AMK
DRAWN	NJL
CHECKED	JNL

**NOT FOR CONSTRUCTION**

FINAL DESIGN  
 90% SUBMITTAL

I hereby certify that this plan, specification, or report was prepared by me or under my direct supervision and that I am a duly Licensed under the laws of the State of Minnesota.

Printed Name: JONATHAN N. LIBBY  
 Signature: \_\_\_\_\_  
 Date: \_\_\_\_\_ License #: 51278

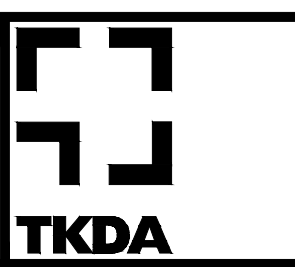

444 Cedar Street, Suite 1500  
 Saint Paul, MN 55101  
 651.292.4400  
 tkda.com



CITY OF SAINT PAUL DEPARTMENT OF PARKS AND RECREATION  
**HIGHLAND BRIDGE MRB CROSSING**  
 SAINT PAUL, MINNESOTA RAMSEY COUNTY

**SITE PLAN**

PROJ. NO. 17921.002  
 DRAWING NO. C301