

Bureau of Criminal Apprehension

Fence at BCA Headquarters Saint Paul

For Variance to 63.314 Off Street Parking Facility Standards

January 5th, 2026



About the BCA

■ **Mission**

- The Bureau of Criminal Apprehension prevents, investigates and solves crimes in collaboration with our criminal justice partners.

■ **Vision**

- Delivering exceptional law enforcement services for a safer Minnesota

■ Services fall into four general categories.

- Forensic laboratory analysis
- Criminal histories
- Investigations
- Professional services including criminal justice training and development

The BCA employs over 750 people, over 600 work at the Maryland Ave building supporting an additional 13 field offices across Minnesota, and its forensic lab at the Maryland Ave Building has an international reputation as one of the finest in the country. The BCA's Crime Scene Team of criminal investigators and laboratory specialists responds to requests from Minnesota law enforcement agencies for assistance in investigating suspicious deaths. Trains over 10,000 law enforcement personnel every year.

Study

Site Security Issues Studied Found the following:

- The fence is not continuous around the site; it only encloses the south and east sides of the property.
- The risk assessment suggested that an anti-climbable security fence be installed at least 8 ft tall. The existing fence is only 6 ft tall.
- The fence is not securely anchored to its footings or other supporting elements. In some places, the top of the fence can easily be shaken several inches back and forth.
- The fence pickets are small enough that they could be pried apart with the aid of tools.

Based on the deficiencies of the existing fence, it is recommended to remove it and replace it with a fence that forms a continuous perimeter around the facility, clearly delineates public and secure areas of the site, and is more securely constructed.

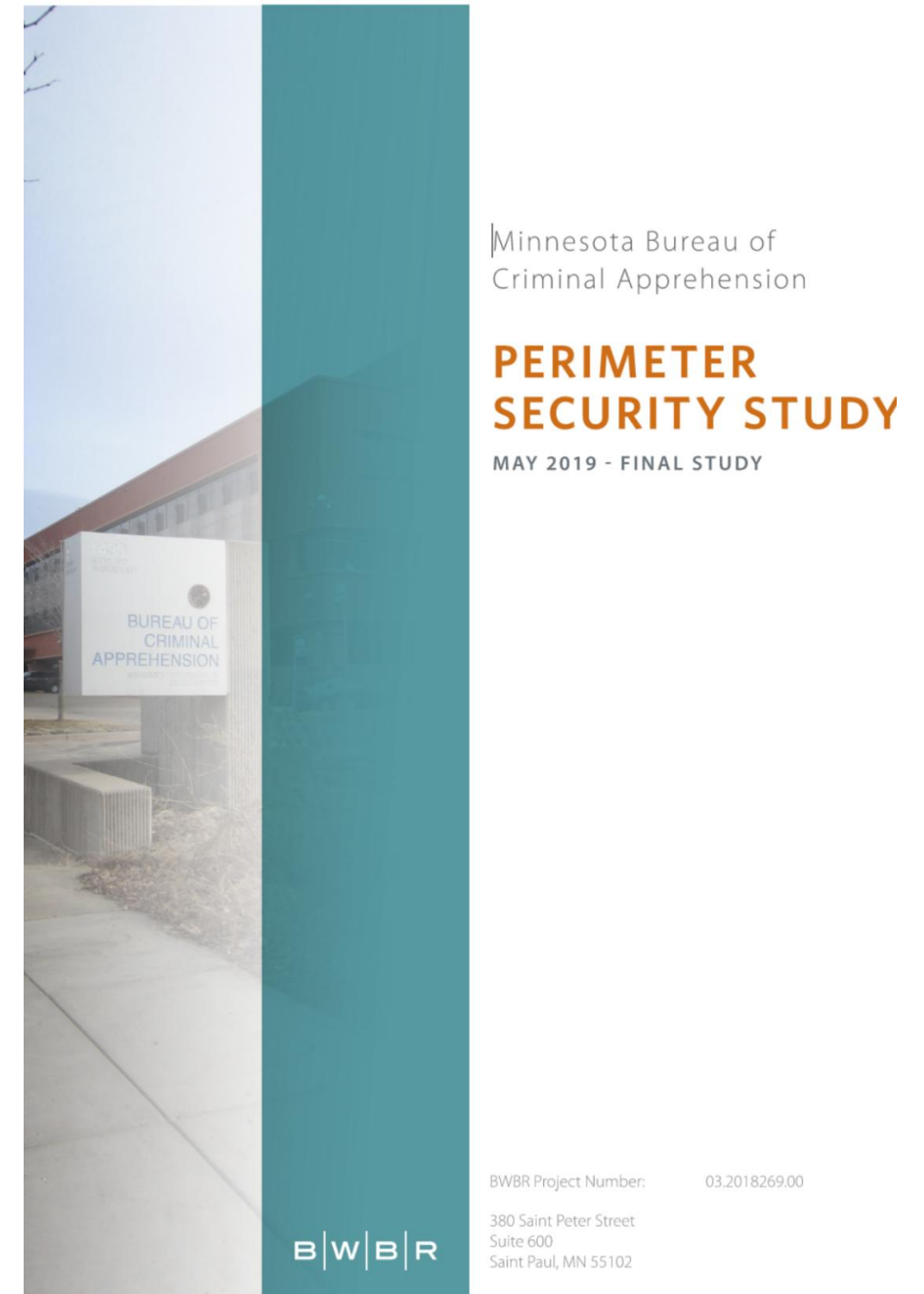

Site Security Issues Studied Found the following:

- Public and private areas of the site are not separated from each other.
- Public parking stalls located immediately adjacent to the building provide easy access for a car bomb to be parked next to building.
- High-speed vehicle chases occur on Maryland Avenue (on the north side of the site), sometimes resulting in vehicles driving off the road and into the adjacent properties. This poses the risk of vehicles being driven into the building. Intentional vehicle crashes into the building are also a possibility.
- There is a lot of pedestrian traffic going across the site that's unrelated to business at the facility. This pedestrian traffic should be using the pedestrian path that the State has dedicated an easement through the site on the south side. Being there is a lot of pedestrian traffic going across the site this poses a safety risk to with the amount of vehicle traffic.
- Space open to the public should be clear for wayfinding and keep public from non-public parking or entrances. The green space in the northeast corner of the site makes this area more inviting for vandalism or other unwanted access onto the site.

Site Security Issues Studied Found the following:

- Regulatory Considerations

Zoning

The City of St. Paul's zoning ordinance was analyzed during the study to find applicable requirements, and it was found that the requirements for fences aren't applicable to the project based on the zoning of the site and the facility being a commercial use. City staff from both the Planning and Economic Development Zoning office and the Department of Safety and Inspections Zoning office confirmed this and said that the project would not be required to be submitted for zoning review. However, the project will be required to be submitted for a building permit plan review.

State Law Required the BCA To Do

By the law, the BCA is Required to do the following:

- Minnesota Session Laws – 2023, Regular Session, Ch 72, HF 669, 4th Engrossment – 93rd Legislature, Art. 1 Sec. 15. Public Safety, Subd. 3. BCA Maryland Building
 - To design, construct, renovate, equip, and furnish unfinished space in the Bureau of Criminal Apprehension building in St. Paul to provide new offices and to design, construct, and equip a new perimeter security fence and access controls at the site.
- This construction of the security fence is a result of continual threat analysis of the risks the facility could potentially be exposed to and what measure might be taken to mitigate them. When the BCA was originally built, site security was less of a concern than it is now. The threat of terrorism has increased, the nature of the surrounding neighborhood has changed, and public demonstrations related to high-profile crime cases being investigated at the facility have been staged on the site.



Typical Correctional Chain-link and razor wire, non-decorative security fence.

What is a Security Fence

What is a Security Fence?

- Enclose an Area to prevent unauthorized entry or exit.
- Define the perimeter of protected area.
- Provide a physical and psychological deterrent to entry and prevent unauthorized personnel from entering a protected area.
- Offer Maximum Security for assets, storage areas, and open spaces.
- Ornamental steel security fence was selected as the preferred type of fence based on these objectives. A recommended example of this type of fence is Ameristar's "Aegis II" fence with the "Invincible" outward-curved pickets. This fence was recently installed at the St Paul Police Department and Ramsey County Law Enforcement Campus on Lafayette Road & University Ave.

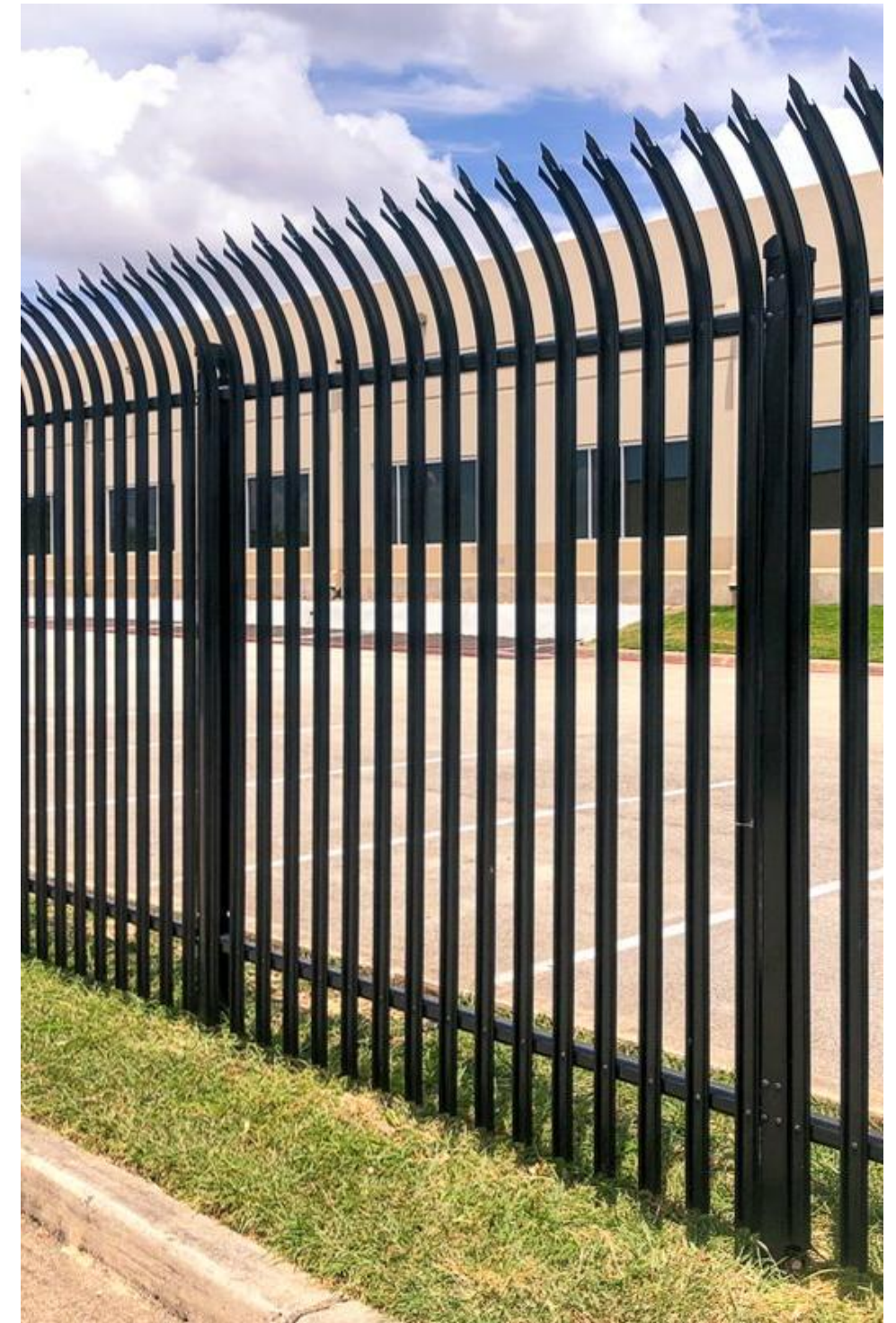

Ramsey County Sheriff's & City of St. Paul Police



Existing Fence East & South Sides of the Property

Along Barclay



Barclay Restricted Gate

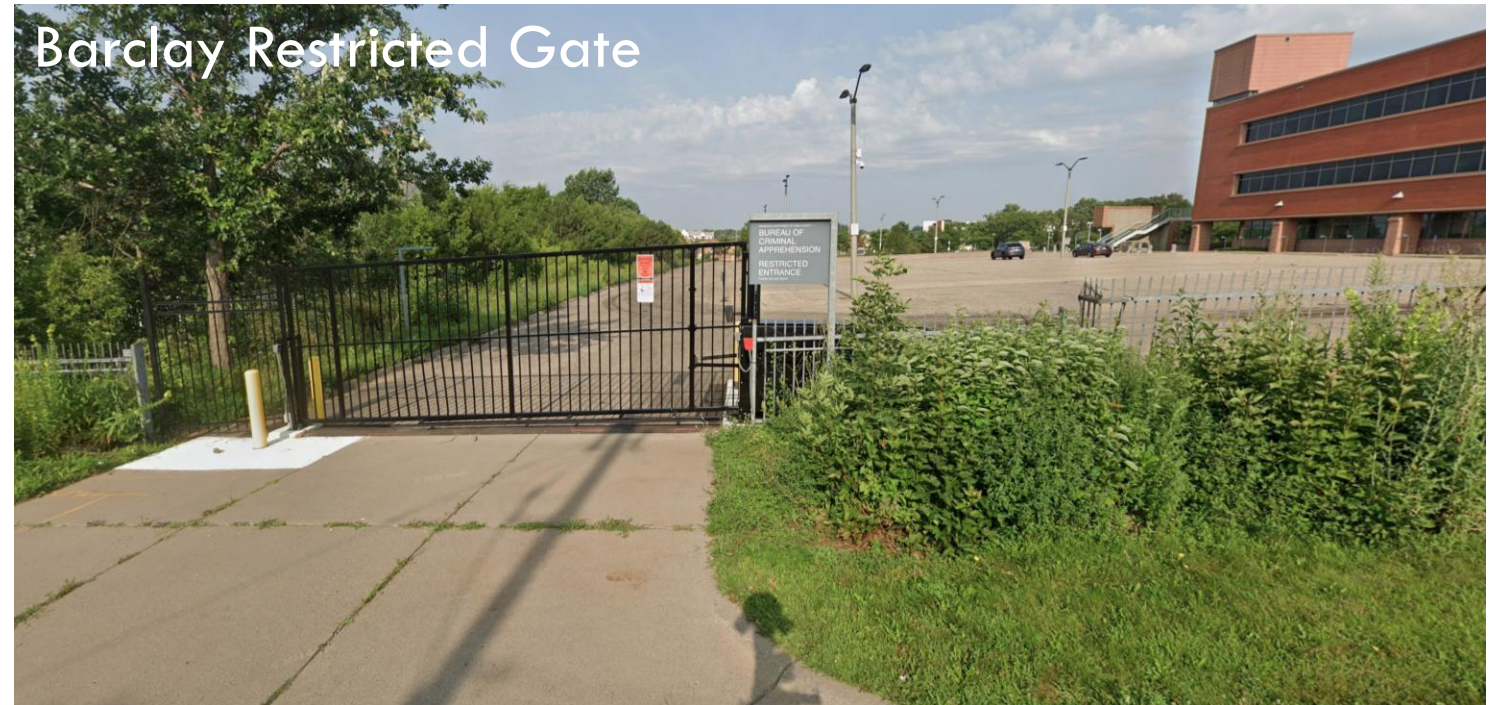

Barclay & Maryland Ave Corner

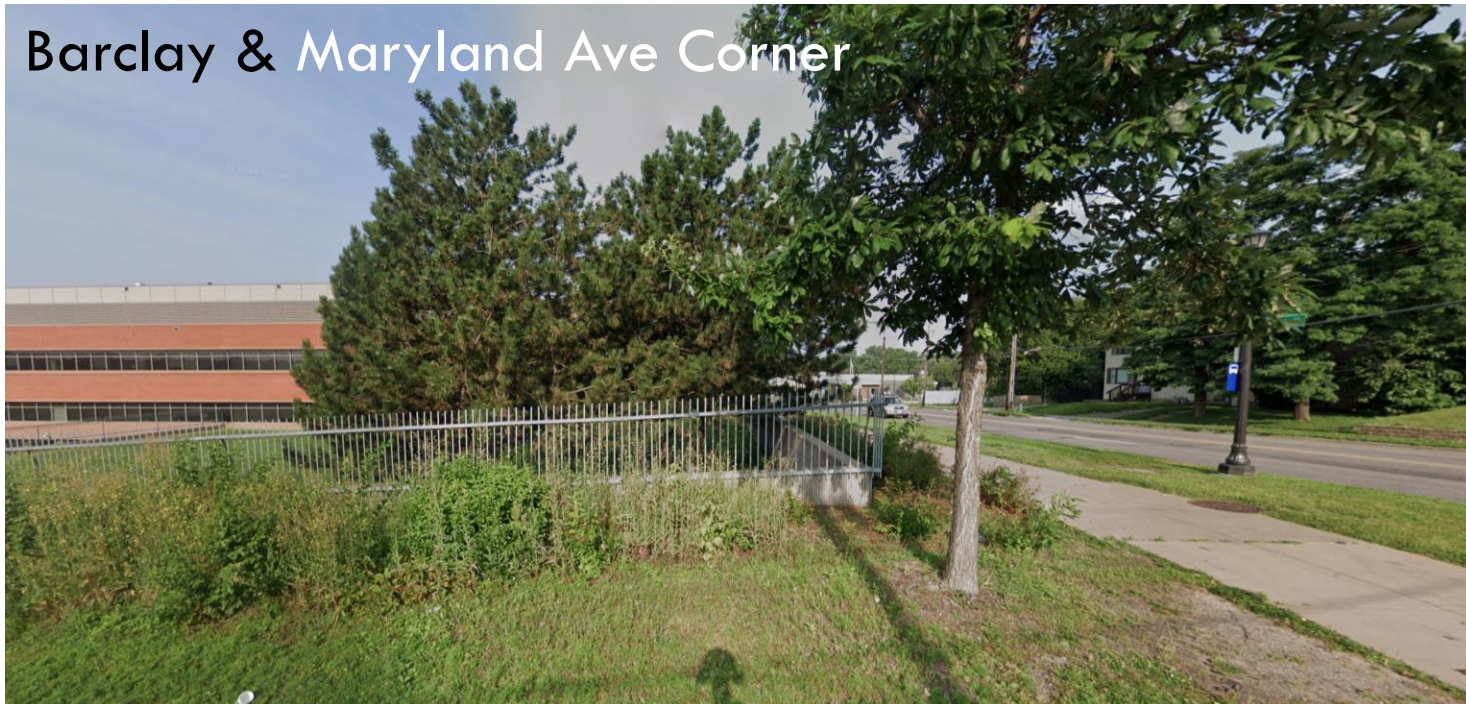

Phalen & Public Path Easement



Existing West Sides of the Property

Phalen & Staff/Student Parking lot

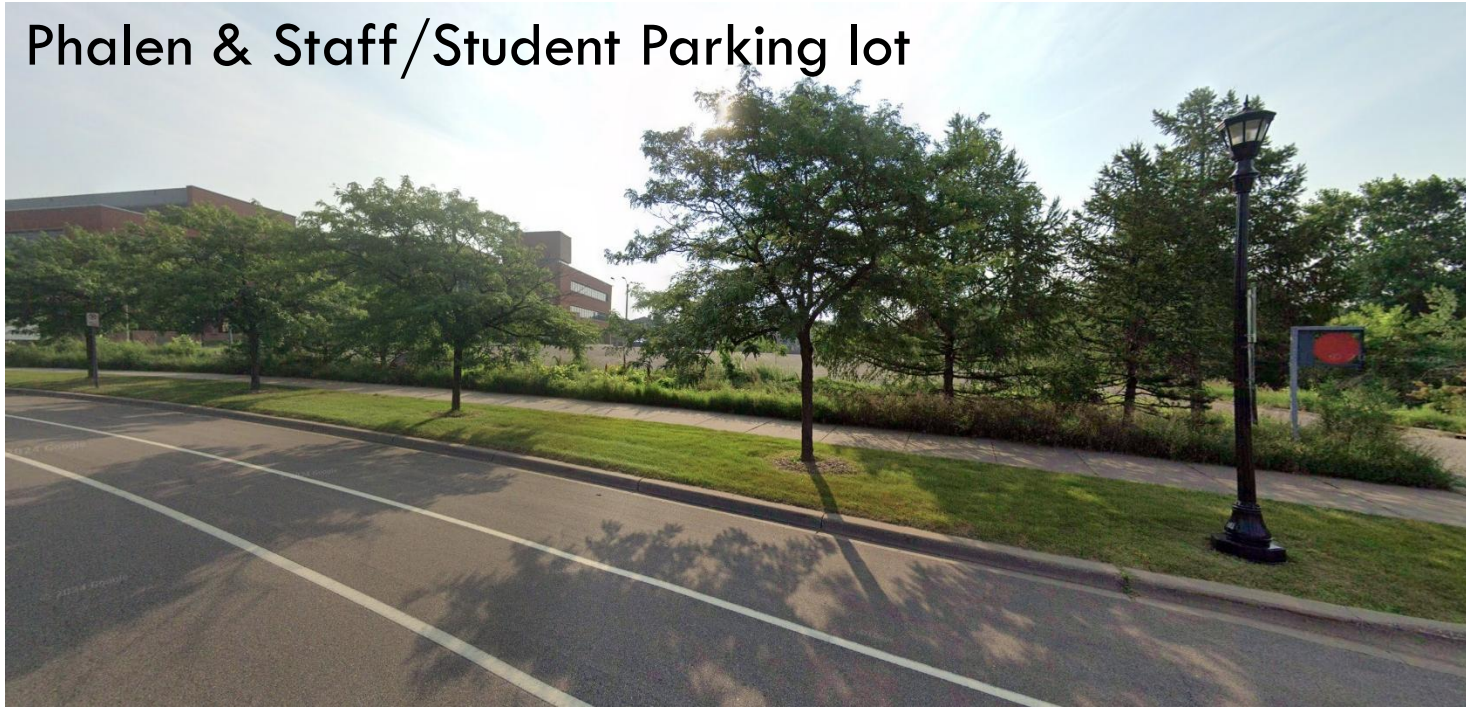

Main Gate



Phalen & Public Parking lot

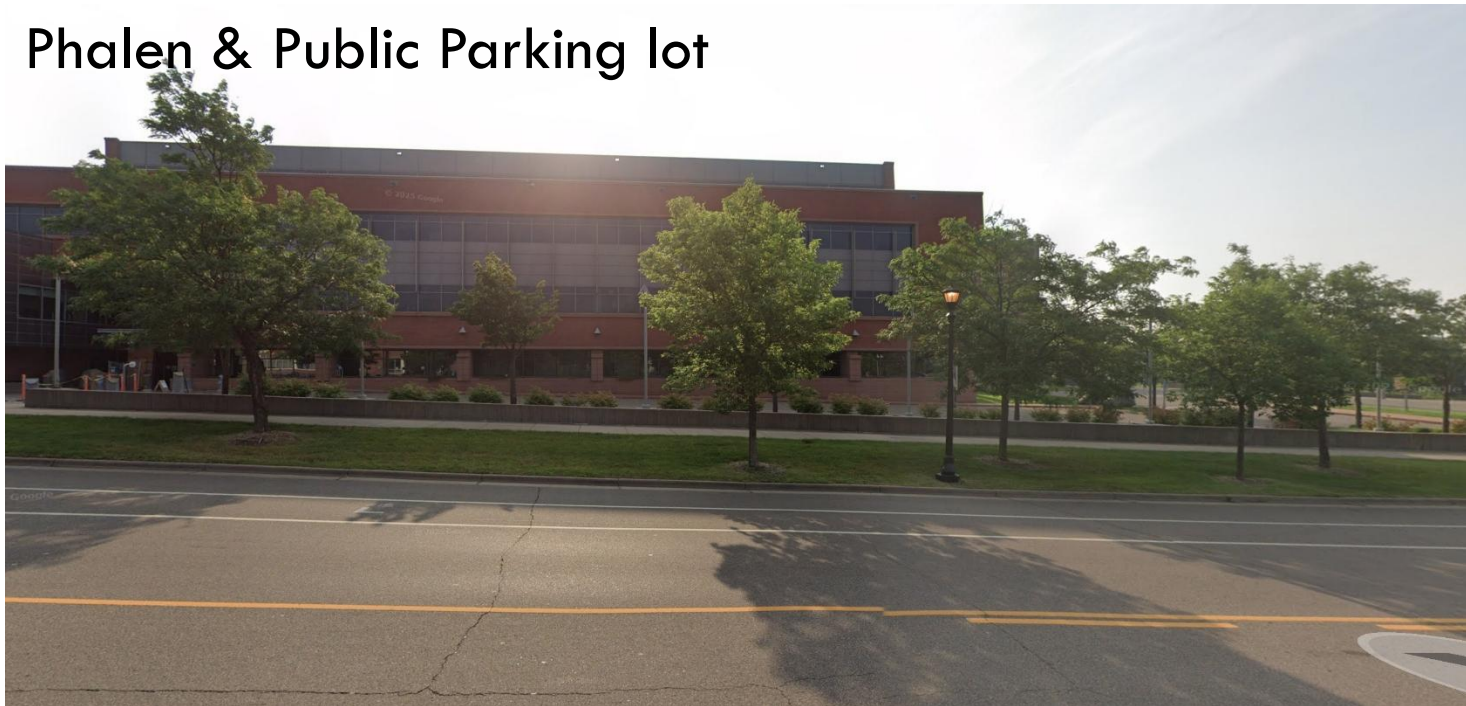

Phalen & Building Signage



Existing North Sides of the Property

Maryland & Plaza



Maryland & Building



Maryland & Stepped Back Building Section



Maryland Ave Retaining Wall & Signage



Site Plan

Site Plan

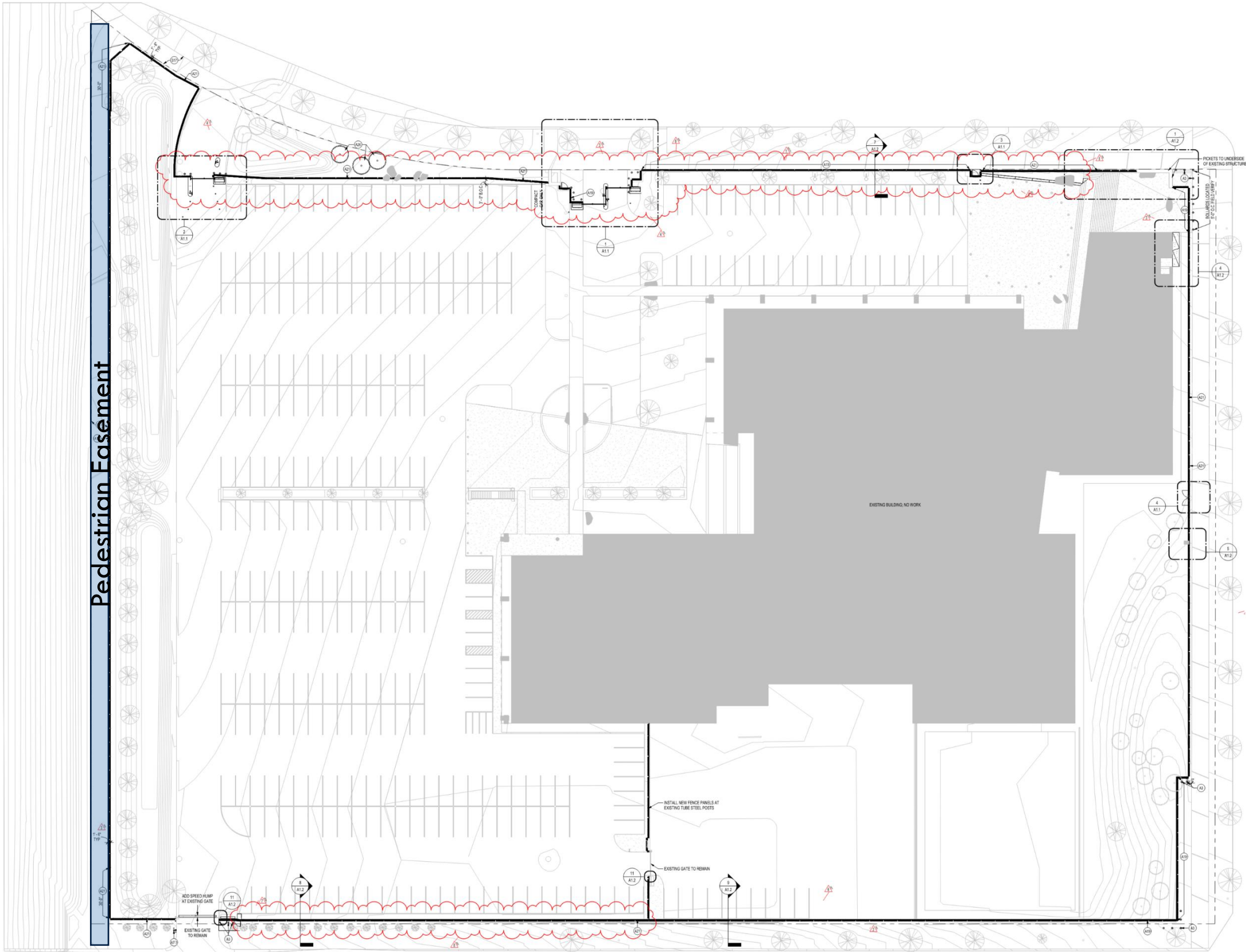

Site Renderings



Site Renderings



Site Renderings

