



**August 3, 2021**

**Emerald Lounge Parking determination**

Gross floor area of the space: 1,200 square feet

**Previous use: Yoga studio**

Parking requirement for previous use: 1 space per 400 Sq. ft

$1,200/400$  square feet = 4 parking spaces.

Parking spaces provided = 0

**Proposed use: Restaurant**

Parking requirement for proposed use: 1 space per 400 Sq. ft

$1,200/400$  square feet = 4 parking spaces

Parking provided: 0

Both the previous and the proposed use require the same amount of parking (4 spaces) and since the previous use had a nonconforming parking deficiency, the proposed use is not required to provide any parking.

Farhan Omar  
DSI Inspector I

# SITE PLAN APPROVED

OFFICE OF DSI  
CITY OF ST. PAUL

By Farahan Omar

File # 21-290692 Date 2/2/2021

Any alterations from this plan must be approved by the Zoning Administrator.

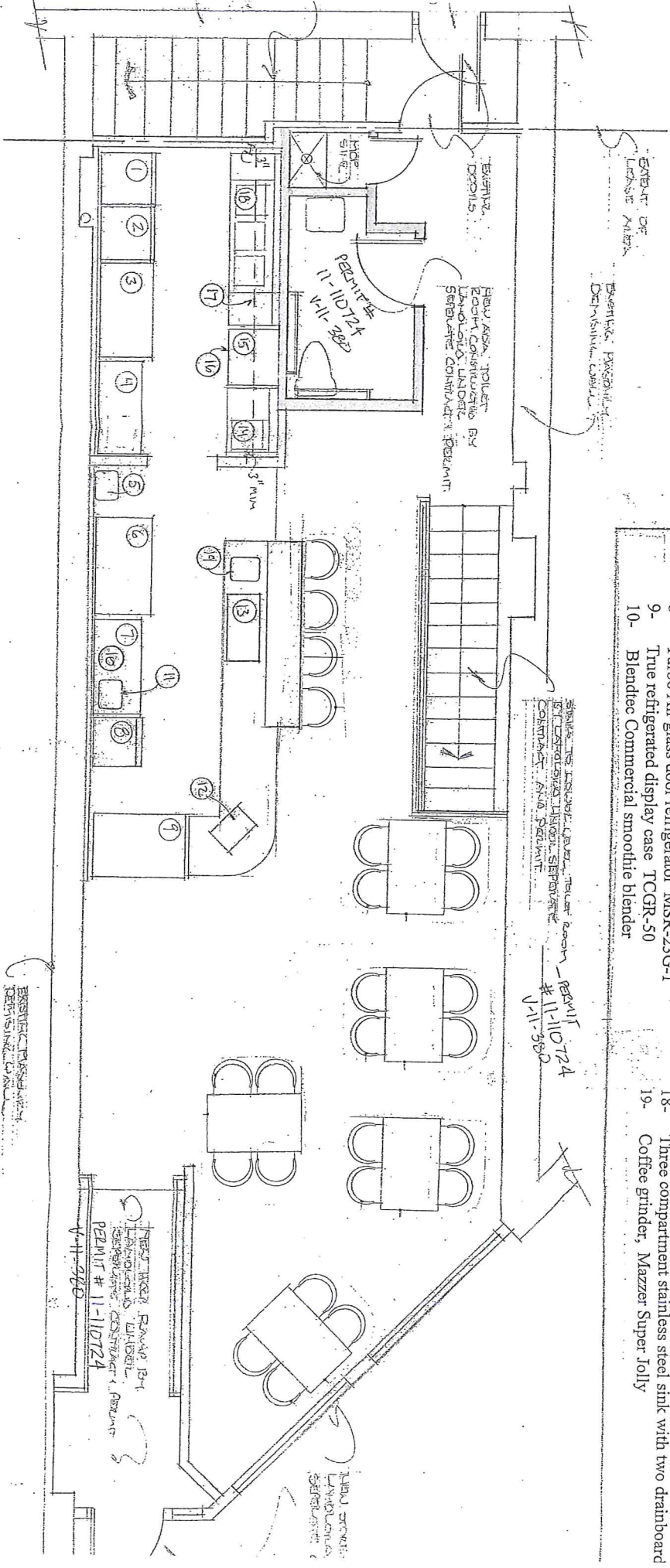

### EQUIPMENT SCHEDULE:

- |  |  |
|--|--|
| 1- True reach-in freezer T-23F                   | 11- Coffee Brewer Curtis Brewer D500                           |
| 2- True reach-in refrigerator T-23               | 12- POS  |
| 3- True sandwich station TSS4-48-8               | 13- Espresso Machine La Marzocco GB/S                          |
| 4- 48" stainless steel work table                | 14- One compartment stainless steel sink with drainboard       |
| 5- Hand sink                                     | 15- 30" stainless steel work table                             |
| 6- True 2 door under counter refrigerator TUC-48 | 16- Under counter dishwasher Moyer Diebel                      |
| 7- 48" stainless steel work table                | 17- Stainless steel wire shelving                              |
| 8- Turbo Air glass door refrigerator MSR-23G-1   | 18- Three compartment stainless steel sink with two drainboard |
| 9- True refrigerated display case TCGR-50        | 19- Coffee grinder, Mazzer Super Jolly                         |
| 10- Blendtec Commercial smoothie blender         |  |



CITY OF SAINT PAUL  
 Department of Safety and Inspections  
 375 Jackson Street, Suite 220  
 Saint Paul, Minnesota 55101  
 Phone: 651-266-8989  
 Web: [www.stpaul.gov/dsi](http://www.stpaul.gov/dsi)

License Number: 20210000674

### Zoning Addendum

An applicant must provide details related to the physical layout of the business for which a license is being requested. Please complete the following document and attach supporting documents.

\*Zoning approval will not be granted for this license request without this information.

Business Name: Emerald Lounge  
 Business Address: 455 7th St. West, St. Paul MN 55102 Business Type: Restaurant  
 Licensee Name: \_\_\_\_\_ Phone: 651-253-4721

Please answer the following questions (if business is located in St. Paul proper):

- a. What is the gross floor area for this business?
- b. What was the previous use of this space?
- c. How many off-street parking spaces are provided for this business only?
- d. Is the parking leased or owned?
- e. How many different uses are in the building?
  - i. What are these uses? What is the gross floor area for each?

serving area—846 sq ft, basement storage—348 sq ft

Yoga Studio

N/A

N/A

3

a.	<u>Claddagh Coffee</u>	<u>1500 sq ft</u>
	Use:	Area:
b.	<u>Apartments</u>	<u>3200 sq ft</u>
	Use:	Area:
c.	<u>Emerald Lounge</u>	<u>1200 sq ft</u>
	Use:	Area:

- ii. Are there any bar/restaurants in the building operating after midnight?

Yes  No

If Yes, Please list them:

- f. Do you own the property or are you leasing it?

Leasing

Answer these questions if you are applying for a restaurant license:

- a. Do you intend to have a drive-thru window?
- b. Will you have a permanent menu board?
- c. Do you intend to serve liquor?
- d. Is this a restaurant associated with a Chain or Franchised business?
- e. Will customers pay for their food before Consuming It?
- f. Is a self-service condiment bar proposed?
- g. Are trash receptacles provided for self-service bussing?
- h. Will there be hard finished, stationary seating?
- i. Are your main course food items...

Yes  No

Yes  No

Yes  No

Yes  No

Yes  No

Yes  No

Yes  No

Yes  No

Pre Packaged  To Order