

|    | A   | B                         | C                           | D           |
|----|---|---------------------------|-----------------------------|-------------|
| 1  | MANCINI FAMILY LIMITED PARTNER            | 531 7TH ST W              | ST PAUL MN 55102-3007       | 12823430106 |
| 2  | NICHOLAS BEISE CLARISSA BEISE             | 204 ANN ST                | SAINT PAUL MN 55102-3014    | 12823430061 |
| 3  | THERESA ORTIZ MEZA GERARDO MEZA GUTIERREZ | 200 ANN ST                | ST PAUL MN 55102-3044       | 12823430114 |
| 4  | ST.MARKS EVAN LUTH                        | 550 7TH ST W              | ST PAUL MN 55102-3012       | 12823430113 |
| 5  | ALLIANT REH LLP                           | 555 7TH ST W STE 101      | ST PAUL MN 55102-3068       | 12823430153 |
| 6  | BIGOS WINSLOW COMMONS LLC                 | 8325 WAYZATA BLVD STE 200 | GOLDEN VALLEY MN 55426-1460 | 12823430214 |
| 7  | PUZZLE ROOM PROPERTIES, LLC               | 3903 XERXES AVE S         | MINNEAPOLIS MN 55410-1136   | 12823430156 |
| 8  | PUZZLE ROOM PROPERTIES, LLC               | 3903 XERXES AVE S         | MINNEAPOLIS MN 55410-1136   | 12823430249 |
| 9  | FORT ROAD OFFICE PARK                     | 555 7TH ST W              | ST PAUL MN 55102-3009       | 12823430155 |
| 10 | ANITA E ORTIZ                             | 356 SUPERIOR ST           | ST PAUL MN 55102-3011       | 12823430161 |
| 11 | 586 7TH ST LLC                            | 586 7TH ST W              | SAINT PAUL MN 55102-3010    | 12823430126 |

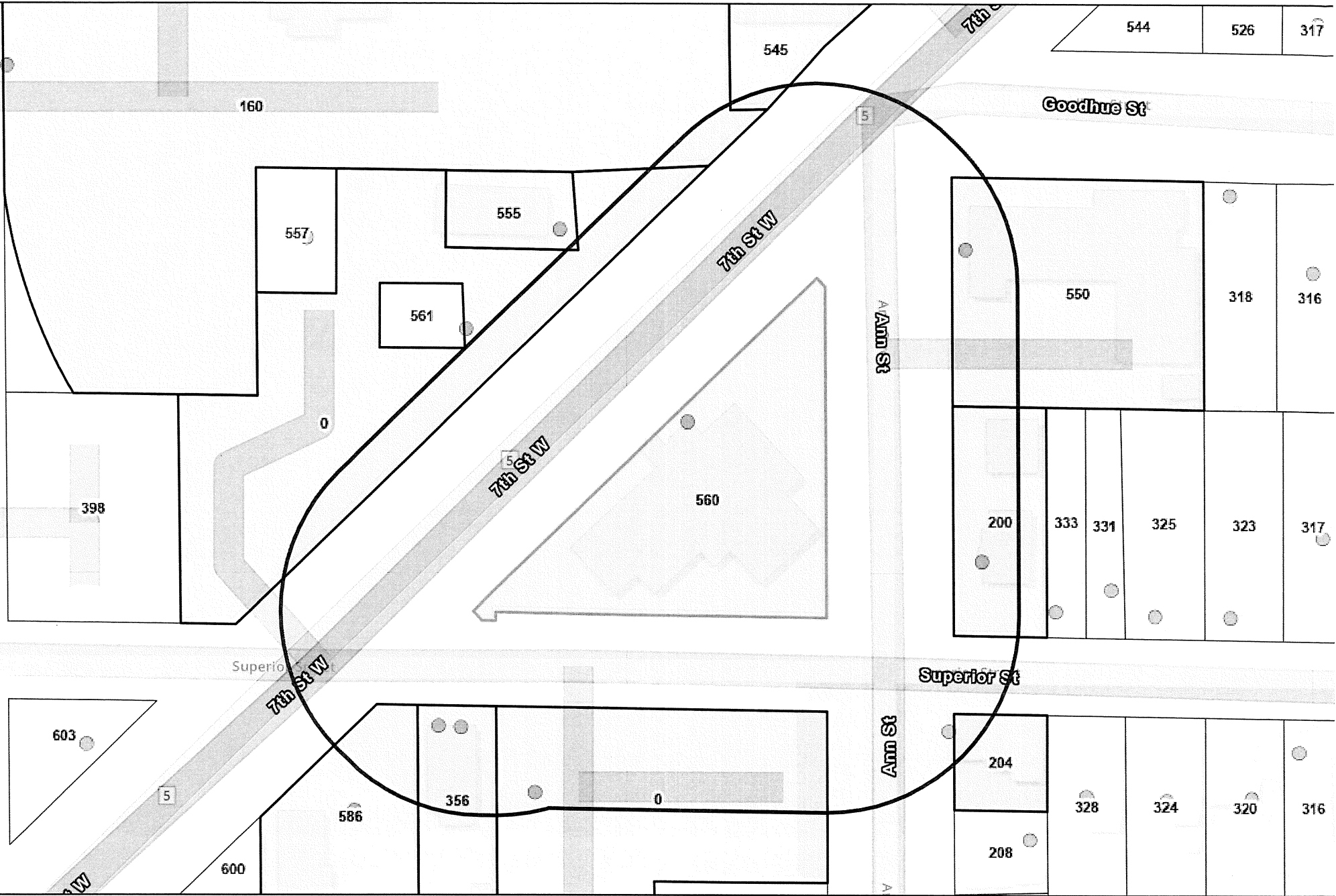

### Saint Paul Minnesota

*The most livable city in America*

Sources: Esri, Airbus DS, USGS, NGA, NASA, CGIAR, N Robinson, NCEAS, NLS, OS, NMA, Geodatastyrelsen, Rijkswaterstaat, GSA, Geoland, FEMA, Intermap and the GIS user community, Esri Community Maps

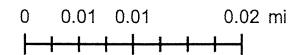

The Geographic Information System (GIS) Data to which this notice is attached are made available pursuant to the Minnesota Government Data Practices Act (Minnesota Statutes Chapter 13). The GIS Data are provided to you "AS IS" and without any warranty as to their performance, merchantability, or fitness for any particular purpose. The GIS Data were developed by the City of Saint Paul for its own internal business purposes. The City of Saint Paul does not represent or warrant that the GIS Data or the data documentation are error-free, complete, current, or accurate. You are responsible for any consequences resulting from your use of the GIS Data or your reliance on the GIS Data. You should consult the data documentation for this particular GIS Data to determine the limitations of the GIS Data and the precision with which the GIS Data may depict distance, direction, location, or other geographic features. If you transmit or provide the GIS Data (or any portion of it) to another