

SUMMARY OF ENGINEERING RECOMMENDATION
Valentine Avenue New Sidewalk Construction

Ward 4

PROJECT:

This project is to construct a new city sidewalk on north side of **Valentine Avenue** between **Eustis Street and Brompton Street**. The new sidewalk is approximately 320' long. The new construction is in front of one property.

EXISTING CONDITIONS:

There is no sidewalk there. The area is relatively flat with boulevard trees. Some trees may need to remove for this project.

INITIATING ACTION:

This order was initiated by requests for completion the sidewalk along the north side of Valentine Avenue from Como Avenue to Eustis Street with this one block being the remaining gap to be constructed.

ALTERNATES:

Leave as is, no work preformed.

POSITIVE BENEFITS:

At this time there are many gaps in the pedestrian routes for this neighborhood. This connection is the first of many blocks for that area that are lacking city sidewalks.

ADVERSE EFFECTS

Normal problems associated with construction such as noise, dust, and general disruption to the neighborhood. There is a direct assessment to the abutting property and they may contest the project.

TIME SCHEDULE:

The project to be done during the 2013 construction season.

COST ESTIMATE:

Construction	\$	8,000.00
Engineering	\$	2,400.00
Miscellaneous	\$	<u>2,000.00</u>

PROJECT TOTAL \$ **12,400.00**

ESTIMATED FINANCING:

Property Assessment	\$	10,400.00
ROW, CIB Funds	\$	<u>2,000.00</u>

PROJECT TOTAL \$ **12,400.00**

SOURCE OF ADDITIONAL INFORMATION

For additional information, contact Sidewalk Supervisor, Allan Czaia, at 266-6108

SUMMARY AND RECOMMENDATION:

The Department of Public Works feels that this is a necessary and worthwhile project, and the Engineering Recommendation is for approval of the project and financing.

	PIN	Length	Width	Reg walk cost	E & I 30%	Assessable
1499 Brompton St.	20-29-23-24-0066	320.00	5	\$8,000.00	\$2,400.00	\$10,400.00

	Length 320.00	Totals	\$8,000.00	\$2,400.00	\$10,400.00
--	---------------	--------	------------	------------	-------------

Sqft 1600

Real Estate 8%	
\$832.00	\$11,232.00

EUSTIS ST.

BROMPTON ST.

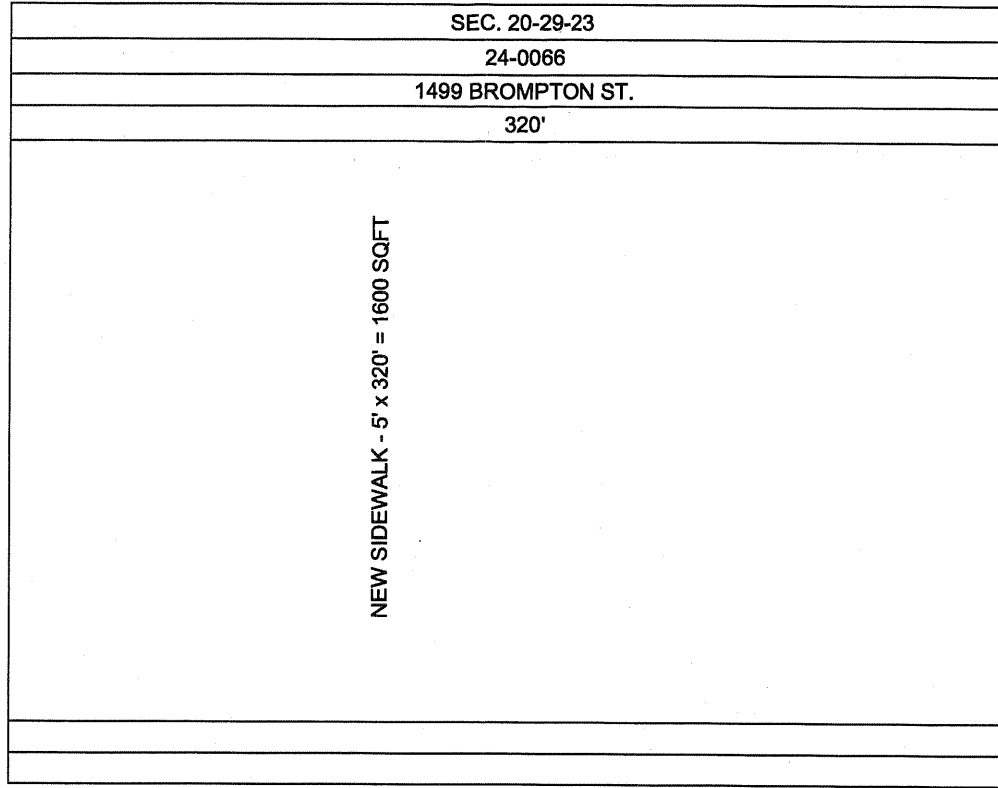

0+00

VALENTINE AVE. (N.S.)



JOB XXX - 2012

MEANING OF COLOR SYMBOLS

- CONSTRUCT A MONO WALK
(Where no sidewalk exists)
- CONSTRUCT A NEW MONO CONCRETE WALK
(Impossible or Impractical to repair existing walk)
- SATISFACTORY SIDEWALK
(No work anticipated)
- DRIVEWAY OR ALLEY CROSSING
(As colored)

