

X the appropriate line

Payable by State X

Receivable by State _____

**STATE OF MINNESOTA
WORK ORDER UNDER
MASTER PARTNERSHIP CONTRACT**

City Project No.	13-T-1318	Trunk Highway (TH):	5, 51, and 952
Project Identification:	Signal System ADA upgrades		

This Work Order Contract is issued under the authority of State of Minnesota, Department of Transportation (MnDOT) Master Partnership Contract No. 03551 between the state of Minnesota acting through its Commissioner of Transportation ("State") and the City of Saint Paul, a political subdivision of the State of Minnesota ("Local Government") and is subject to all applicable provisions and covenants of that Agreement which are incorporated herein by reference.

Work Order Contract

Article 1 Term of Work Order Contract; Incorporation of Exhibits:

- 1.1 Effective date: This Work Order Contract will be effective on the date that all required signatures are obtained by State, pursuant to Minnesota Statutes Section 16C.05, subdivision 2. The Providing Agency must not begin work under this Contract until ALL required signatures have been obtained and the Providing Agency has been notified in writing to begin such work by the Requesting Agency's Authorized Representative.
- 1.2 Expiration date: This Work Order Contract will expire on 12/31/2013, or when all obligations have been satisfactorily fulfilled, whichever occurs first.
- 1.3 Exhibits: Exhibits A through D are attached and incorporated into this Work Order Contract.

Article 2 Nature of Work; Requesting and Providing Party:

- 2.1 X the blanks below to indicate the nature of the work to be performed. See Article 3. Services Requiring a Work Order Contract, of the Master Partnership Contract for applicable definitions.
- _____ Construction Administration
- _____ Emergency Services
- _____ Professional/Technical Services
- X _____ Roadway Maintenance
- 2.2 X the blanks below to indicate which party is the "Requesting Party" and which party is the "Providing Party".
- 2.2.1 The Requesting Party is: X State _____ Local Government
- 2.2.2 The Providing Party is: _____ State X Local Government

Article 3 Scope of Work:

- 3.1 The Providing Party will perform services under this Work Order summarized generally as follows: Providing Party will perform ADA upgrades to four signalized intersections within the city limits of Saint Paul at these specific Intersection Locations:

TH 5 (East Seventh Street and Hope Street MnDOT System I.D. No. 39088
 TH 952 (Robert Street and Fillmore Street.) MnDOT System I.D. No. 39656
 TH 51 (Snelling Avenue and Hewitt Street) MnDOT System I.D. No. 20731
 TH 51 (Snelling Avenue and Thomas Street) MnDOT System I.D. No. 39102

- 3.2 The Providing Party will perform work in accordance with the "Standard Terms" contained in Exhibit A.
- 3.3 For a detailed description of work see Exhibit B (Itemized List), Exhibit C (Plans) and Article 4 'Deliverables by the Local Government'

Article 4 Deliverables by the Providing Party:

- 4.1 Deliverables are the work products created or supplied by the Providing Party pursuant to the terms of this Work Order. The detailed summary of the deliverables for this work order are as follows:

Deliverable	Description	Due Date
TH 5 (E. Seventh St and Hope St) Upgrade all pedestrian push buttons to the ADA Audible type and insure they are fully operational.	Replace 4 pedestrian push buttons with ADA Audible Type Buttons. Add 4 new pedestrian push buttons with ADA Audible Type Buttons with pushbutton stations.	12/31/2013
TH 952 (Robert St and Fillmore St.) Upgrade all pedestrian push buttons to the ADA Audible type and insure they are fully operational.	Replace 4 pedestrian push buttons with ADA Audible Type Buttons. Add 4 new pedestrian push buttons with ADA Audible Type Buttons with pushbutton stations.	12/31/2013
TH 51 (Snelling Ave. and Hewitt St.) Upgrade all pedestrian push buttons to the ADA Audible type and insure they are fully operational.	Replace 5 pedestrian push buttons with ADA Audible Type Buttons. Add 3 new pedestrian push buttons with ADA Audible Type Buttons with pushbutton stations.	12/31/2013
TH 51 (Snelling Ave. and Thomas St.) Upgrade all pedestrian push buttons to the ADA Audible type and insure they are fully operational.	Replace 4 pedestrian push buttons with ADA Audible Type Buttons. Add 4 new pedestrian push buttons with ADA Audible Type Buttons with pushbutton stations.	12/31/2013

Article 5 Items provided or completed by the Requesting Party.

- 5.1 The following will be provided or completed by the Requesting Party: NONE

Article 6 Consideration of Payment:

- 6.1 The Requesting Party will pay for all services performed by the Providing Party on a Lump Sum basis.
- 6.2 The Providing Party will submit invoice for payment in accordance with the following schedule:

The Providing Party will submit an invoice for a one-time payment upon completion of deliverables listed in Article 4 (above) and detailed in Exhibits B and C.

- 6.3 The Requesting Party's total obligation for all compensation and reimbursements to the Providing Party is not to exceed \$9,605.03.

Article 7 Terms of Payment:

- 7.1 The Requesting Party will pay the Providing Party upon satisfactory completion of the work under this Work Order Contract and acceptance by the Requesting Party's Project Manager.
- 7.2 The Providing Party will submit signed invoices, and the signature will attest that the services have actually been performed, and that the claimed amounts have not been previously claimed or paid. The Providing Party will use the format set forth in Exhibit D entitled "Invoice" when submitting Invoices.

Article 8 Local Government's Project Manager:

- 8.1 The Local Government's Project Manager for this Work Order is:

Name: Sonia Piper
Title: Traffic Engineer
Name of Local Government: City of Saint Paul
Street Address: 25 West Fourth Street
City, State Zip: Saint Paul, MN 55102
Phone: 651-266-6256
Email Address: Sonia.piper@ci.stpaul.mn.us

- 8.2 The Local Government's Project Manager for this Work Order is responsible for overseeing the Local Government's fulfillment of its obligations under this Work Order, reviewing and approving invoices, resolving disputes related to this Work Order, and for giving or receiving any notices required or permitted by this Work Order.

Article 9 State's Project Manager:

- 9.1 The State's Project Manager, for this Work Order is:

Name: Steve Misgen
Title: Traffic Engineer
Name of Local Government: MnDOT -Metro District
Street Address: Waters Edge Building
City, State Zip: Roseville, MN 55113
Phone: 651-234-7835
Email Address: Steve.misgen@state.inn.us

- 9.2 The State's Project Manager is responsible for overseeing the State's fulfillment of its obligations under this Work Order, reviewing and approving invoices, resolving disputes related to this Work Order, and for giving or receiving any notices required or permitted by this Work Order.

Article 10 Termination.

- 10.1 Termination by the State or Local Government. The Local Government, the State or the Commissioner of Administration may cancel this Work Order at any time, with or without cause,

upon 30 days' written notice to the other Party. Upon termination, the Providing party will be entitled to payment, determined on a pro rata basis, for services satisfactorily performed.

- 10.2 Termination for Insufficient Funding. If the State is the Requesting Party, The State may immediately terminate this Work Order if it does not obtain funding from the Minnesota Legislature, or other funding source; or if funding cannot be continued at a level sufficient to allow for the payment of the services covered here. Termination must be by written or fax notice to the Local Government. The State is not obligated to pay for any services that are provided after notice and effective date of termination. However, the Local Government will be entitled to payment, determined on a pro rata basis, for services satisfactorily performed to the extent that funds are available. The State will not be assessed any penalty if the Work Order is terminated because of the decision of the Minnesota Legislature, or other funding source, not to appropriate funds. The State must provide the Local Government notice of the lack of funding within a reasonable time of the State's receiving that notice.

Article 11 Additional Provisions

NONE

[THE BALANCE OF THIS PAGE IS INTENTIONALLY LEFT BLANK.]

LOCAL GOVERNMENT

The local Government certifies that the appropriate person(s) have executed the contract on behalf of the Local Government as required by applicable articles, bylaws, resolutions or ordinances.

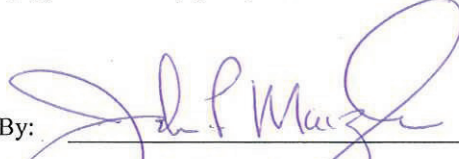
By: 
Title: City Engineer
Date: 5/13/13

COMMISSIONER OF TRANSPORTATION

By: 
Title: District Engineer
Date: 6/3/13

STATE ENCUMBRANCE VERIFICATION

The individual certifies funds have been encumbered as required by Minn. Stat. 16A.15 and 16C.05.

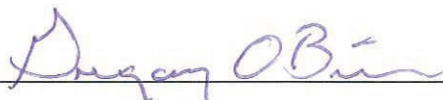
By: 
Date: 05/29/13
SWIFT Contract #: mm 63018
SWIFT PO #: 3000126004

COMMISSIONER OF ADMINISTRATION

By: 
Title: MnDOT Contracts Administrator
Date: June 12, 2013

EXHIBIT A – STANDARD TERMS

STANDARD TERMS FOR ROADWAY MAINTENANCE

1. The Providing Party will perform roadway maintenance in accordance with the specifications and guidelines in the current “MnDOT Maintenance Manual” link:
<http://ihub.dot.state.mn.us/maintenance/documents/docs.html#>.
2. Unless otherwise provided in this Work Order, the Providing Party is not required to perform extraordinary maintenance or reconstruction. The Providing Party should notify the Requesting Party immediately if it becomes aware of any maintenance, not covered by this Work Order that should be addressed immediately to prevent the risk of serious injury to the public.
3. The Providing Party will perform traffic control in accordance with Minnesota Manual on Uniform Traffic Control Devices.

[THE BALANCE OF THIS PAGE IS INTENTIONALLY LEFT BLANK.]

E. 7th Street (TH5) & Hope Street
St Paul Signal ID Number: 211

MnDOT Agreement No. 03551 Work Order 01

Exhibit "B" (Page 1 of 4)

DESCRIPTION	UNIT	QUANTITY	PRICE	TOTAL	NEW FREEDOM FUND (80%)	Mn/DOT TRUNK HIGHWAY (10%)	LOCAL MATCH (10%)
MOBILIZATION	LS	1	\$ 1,000.00	\$ 1,000.00	\$ 800.00	\$ 100.00	\$ 100.00
TEMPORARY TRAFFIC CONTROL	LS	1	\$ 500.00	\$ 500.00	\$ 400.00	\$ 50.00	\$ 50.00
TEMPORARY EROSION CONTROL - INLET PROTECTION	EACH	2	\$ 120.00	\$ 240.00	\$ 192.00	\$ 24.00	\$ 24.00
SAWCUT EXISTING SIDEWALK OR PAVEMENT	LF	76	\$ 5.00	\$ 380.00	\$ 304.00	\$ 38.00	\$ 38.00
REMOVE CONCRETE WALK	SY	11.1	\$ 10.00	\$ 111.11	\$ 88.89	\$ 11.11	\$ 11.11
REMOVE HANDHOLE	EACH	2	\$ 50.00	\$ 100.00	\$ 80.00	\$ 10.00	\$ 10.00
STREET SWEEPING	HR	1	\$ 100.00	\$ 100.00	\$ 80.00	\$ 10.00	\$ 10.00
6" CONCRETE WALK	SF	100	\$ 7.00	\$ 700.00	\$ 560.00	\$ 70.00	\$ 70.00
CONCRETE TRUCK WASHOUT CHARGE	LOAD	1	\$ 45.00	\$ 45.00	\$ 36.00	\$ 4.50	\$ 4.50
2" NMC DIRECT BORE	LF	20	\$ 12.00	\$ 240.00	\$ 192.00	\$ 24.00	\$ 24.00
2" NMC	LF	10	\$ 3.75	\$ 37.50	\$ 30.00	\$ 3.75	\$ 3.75
APS PEDESTRIAN PUSH BUTTON STATION	EACH	4	\$ 650.00	\$ 2,600.00	\$ 2,080.00	\$ 260.00	\$ 260.00
APS PUSH BUTTON	EACH	8	\$ 475.78	\$ 3,806.25	\$ 3,045.00	\$ 360.63	\$ 360.63
16"X18" PED HANDMANILED WITH COUNTDOWN TIMER	EACH	0	\$ 420.00	\$ -	\$ -	\$ -	\$ -
Z/c #14	LF	640	\$ 1.25	\$ 800.00	\$ 640.00	\$ 80.00	\$ 80.00
NAVIGATOR 2-WIRE CONTROL UNIT	EACH	1	\$ 2,295.44	\$ 2,295.44	\$ 1,837.15	\$ 228.64	\$ 228.64
SPECIAL HANDHOLE (ST. PAUL)	EACH	3	\$ 550.00	\$ 1,650.00	\$ 1,320.00	\$ 165.00	\$ 165.00
LABOR (ELECTRICIAN & TRUCK)	HR	80	\$ 125.00	\$ 10,000.00	\$ 8,000.00	\$ 1,000.00	\$ 1,000.00
				\$ 24,605.30	\$ 19,685.04	\$ 2,460.63	\$ 2,460.63
Subtotal				\$ 24,605.30	\$ 19,685.04	\$ 2,460.63	\$ 2,460.63
8% Engineering & Inspection				\$ -	\$ -	\$ -	\$ -
25% MSA Engineering & Inspections (Less 8% MnDOT E&I)				\$ -	\$ -	\$ -	\$ -
Total				\$ 24,605.30	\$ 19,685.04	\$ 2,460.63	\$ 2,460.63
-New Freedom Funds for signal materials/labor				\$ 4,921.26	\$ -	\$ -	\$ -
50% split				\$ 2,460.63	\$ -	\$ -	\$ -

Robert Street & Fillmore Ave
St. Paul Signal ID Number: 060

MnDOT Agreement No. 03551 Work Order 01

Exhibit "B" (Page 2 of 4)

DESCRIPTION	UNIT	QUANTITY	PRICE	TOTAL	NEW FREEDOM FUND (80%)	MnDOT TRUNK HIGHWAY (10%)	LOCAL MATCH (10%)
MOBILIZATION	LS	1	\$ 1,000.00	\$ 1,000.00	\$ 800.00	\$ 100.00	\$ 100.00
TEMPORARY TRAFFIC CONTROL	LS	1	\$ 500.00	\$ 500.00	\$ 400.00	\$ 50.00	\$ 50.00
TEMPORARY EROSION CONTROL - INLET PROTECTION	EACH	2	\$ 120.00	\$ 240.00	\$ 192.00	\$ 24.00	\$ 24.00
SAWCUT EXISTING SIDEWALK OR PAVEMENT	LF	96	\$ 3.00	\$ 288.00	\$ 230.40	\$ 28.80	\$ 28.80
REMOVE CONCRETE WALK	SY	16	\$ 10.00	\$ 160.00	\$ 128.00	\$ 16.00	\$ 16.00
REMOVE HANDHOLE	EACH		\$ 50.00	\$ -	\$ -	\$ -	\$ -
STREET SWEEPING	HR	1	\$ 100.00	\$ 100.00	\$ 80.00	\$ 10.00	\$ 10.00
6" CONCRETE WALK	SF	160	\$ 6.00	\$ 960.00	\$ 768.00	\$ 96.00	\$ 96.00
CONCRETE TRUCK WASHOUT CHARGE	LOAD	1	\$ 45.00	\$ 45.00	\$ 36.00	\$ 4.50	\$ 4.50
2" NMC DIRECT BORE	LF	15	\$ 12.00	\$ 180.00	\$ 144.00	\$ 18.00	\$ 18.00
2" NMC	LF	5	\$ 5.00	\$ 25.00	\$ 20.00	\$ 2.50	\$ 2.50
APS PEDESTRIAN PUSH BUTTON STATION	EACH	4	\$ 500.00	\$ 2,000.00	\$ 1,600.00	\$ 200.00	\$ 200.00
APS PUSH BUTTON	EACH	8	\$ 475.78	\$ 3,806.25	\$ 3,045.00	\$ 380.63	\$ 380.63
18" X 18" PED HAND/MAN/LED WITH COUNTDOWN TIMER	EACH		\$ 420.00	\$ -	\$ -	\$ -	\$ -
2/6 #14	LF	830	\$ 0.95	\$ 788.50	\$ 630.60	\$ 78.85	\$ 78.85
NAVIGATOR 2-WIRE CONTROL UNIT	EACH	1	\$ 2,296.44	\$ 2,296.44	\$ 1,837.15	\$ 228.64	\$ 228.64
SPECIAL HANDHOLE (ST. PAUL)	EACH	2	\$ 450.00	\$ 900.00	\$ 720.00	\$ 90.00	\$ 90.00
LABOR (ELECTRICIAN & TRUCK)	HR	80	\$ 123.00	\$ 10,000.00	\$ 8,000.00	\$ 1,000.00	\$ 1,000.00
Subtotal				\$ 23,289.19	\$ 18,631.35	\$ 2,328.92	\$ 2,328.92
8% Engineering & Inspection				\$ -	\$ -	\$ -	\$ -
25% MSA Engineering & Inspections (Less 8% MnDOT E&I)				\$ -	\$ -	\$ -	\$ -
Total				\$ 23,289.19	\$ 18,631.35	\$ 2,328.92	\$ 2,328.92
-New Freedom Funds for signal materials/labor				\$ 4,657.84	\$ -	\$ -	\$ -
50% split				\$ 2,328.92	\$ -	\$ -	\$ -

TH 51 (Snelling Ave) & Hewitt Avenue
St Paul Signal ID Number: 269

MinDOT Agreement No. 03551 Work Order 01
Exhibit "B" (Page 3 of 4)

DESCRIPTION	UNIT	QUANTITY	PRICE	TOTAL	NEW FREEDOM FUND (80%)	MINIDOT TRUNK HIGHWAY (10%)	LOCAL MATCH (10%)
MOBILIZATION	LS	1	\$ 1,000.00	\$ 1,000.00	\$ 800.00	\$ 100.00	\$ 100.00
TEMPORARY TRAFFIC CONTROL	LS	1	\$ 500.00	\$ 500.00	\$ 400.00	\$ 50.00	\$ 50.00
TEMPORARY EROSION CONTROL - INLET PROTECTION	EACH	4	\$ 120.00	\$ 480.00	\$ 384.00	\$ 48.00	\$ 48.00
SAWCUT EXISTING SIDEWALK OR PAVEMENT	LF	76	\$ 3.00	\$ 228.00	\$ 182.40	\$ 22.80	\$ 22.80
REMOVE CONCRETE WALK	SY	12.4	\$ 10.00	\$ 124.44	\$ 99.58	\$ 12.44	\$ 12.44
REMOVE HANDHOLE	EACH	2	\$ 50.00	\$ 100.00	\$ 80.00	\$ 10.00	\$ 10.00
STREET SWEEPING	HR	1	\$ 100.00	\$ 100.00	\$ 80.00	\$ 10.00	\$ 10.00
6" CONCRETE WALK	SF	112	\$ 6.00	\$ 672.00	\$ 537.60	\$ 67.20	\$ 67.20
CONCRETE TRUCK WASHOUT CHARGE	LOAD	2	\$ 45.00	\$ 90.00	\$ 72.00	\$ 9.00	\$ 9.00
2" NMC DIRECT BORE	LF	40	\$ 12.00	\$ 480.00	\$ 384.00	\$ 48.00	\$ 48.00
2" NMC	LF	20	\$ 5.00	\$ 100.00	\$ 80.00	\$ 10.00	\$ 10.00
APS PEDESTRIAN PUSH BUTTON STATION	EACH	3	\$ 500.00	\$ 1,500.00	\$ 1,200.00	\$ 150.00	\$ 150.00
APS PUSH BUTTON	EACH	8	\$ 475.78	\$ 3,806.25	\$ 3,045.00	\$ 380.63	\$ 380.63
16"x18" PED HANDMANILED WITH COUNTDOWN TIMER	EACH	1	\$ 420.00	\$ 420.00	\$ -	\$ -	\$ -
2/c #14	LF	1010	\$ 0.95	\$ 959.50	\$ 767.60	\$ 95.95	\$ 95.95
NAVIGATOR 2-WIRE CONTROL UNIT	EACH	1	\$ 2,296.44	\$ 2,296.44	\$ 1,837.15	\$ 229.64	\$ 229.64
SPECIAL HANDHOLE (ST. PAUL)	EACH	3	\$ 450.00	\$ 1,350.00	\$ 1,080.00	\$ 135.00	\$ 135.00
LABOR (ELECTRICIAN & TRUCKS)	HR	80	\$ 125.00	\$ 10,000.00	\$ 8,000.00	\$ 1,000.00	\$ 1,000.00
Subtotal				\$ 23,786.63	\$ 19,029.31	\$ 2,378.66	\$ 2,378.66
8% Engineering & Inspection				\$ -	\$ -	\$ -	\$ -
25% MSA Engineering & Inspections (Less 8% MinDOT E&I)				\$ -	\$ -	\$ -	\$ -
Total				\$ 23,786.63	\$ 19,029.31	\$ 2,378.66	\$ 2,378.66
-New Freedom Funds for signal materials/labor				\$ 4,757.33	\$ -	\$ -	\$ -
50% split				\$ 2,378.66	\$ -	\$ -	\$ -

TH 51 (Snelling Ave) & Thomas Avenue
St Paul Signal ID Number: 165

MnDOT Agreement No. 03551 Work Order 01

Exhibit "B" (Page 4 of 4)

DESCRIPTION	UNIT	QUANTITY	PRICE	TOTAL	NEW FREEDOM FUND (80%)	MnDOT TRUNK HIGHWAY (10%)	LOCAL MATCH (10%)
MOBILIZATION	LS	1	\$ 1,000.00	\$ 1,000.00	\$ 800.00	\$ 100.00	\$ 100.00
TEMPORARY TRAFFIC CONTROL	LS	1	\$ 500.00	\$ 500.00	\$ 400.00	\$ 50.00	\$ 50.00
TEMPORARY EROSION CONTROL - INLET PROTECTION	EACH	4	\$ 120.00	\$ 480.00	\$ 384.00	\$ 48.00	\$ 48.00
SAWCUT EXISTING SIDEWALK OR PAVEMENT	LF	66	\$ 3.00	\$ 198.00	\$ 158.40	\$ 19.80	\$ 19.80
REMOVE CONCRETE WALK	SY	14	\$ 10.00	\$ 140.00	\$ 112.00	\$ 14.00	\$ 14.00
STREET SWEEPING	EACH	1	\$ 50.00	\$ 50.00	\$ 40.00	\$ 5.00	\$ 5.00
6" CONCRETE WALK	HR	1	\$ 100.00	\$ 100.00	\$ 80.00	\$ 10.00	\$ 10.00
CONCRETE TRUCK WASHOUT CHARGE	SF	150	\$ 6.00	\$ 900.00	\$ 720.00	\$ 90.00	\$ 90.00
2" NMC DIRECT BORE	LOAD	2	\$ 45.00	\$ 90.00	\$ 72.00	\$ 9.00	\$ 9.00
2" NMC	LF	25	\$ 12.00	\$ 300.00	\$ 240.00	\$ 30.00	\$ 30.00
APS PEDESTRIAN PUSH BUTTON STATION	LF	70	\$ 5.00	\$ 350.00	\$ 280.00	\$ 35.00	\$ 35.00
APS PUSH BUTTON	EACH	4	\$ 500.00	\$ 2,000.00	\$ 1,600.00	\$ 200.00	\$ 200.00
16"X18" PED HAND/MANILED WITH COUNTDOWN TIMER	EACH	6	\$ 475.78	\$ 2,854.68	\$ 2,286.14	\$ 268.54	\$ 268.54
2/c #14	LF	850	\$ 0.95	\$ 807.50	\$ 646.00	\$ 80.75	\$ 80.75
NAVIGATOR 3-WIRE CONTROL UNIT	EACH	1	\$ 2,296.44	\$ 2,296.44	\$ 1,837.15	\$ 229.64	\$ 229.64
SPECIAL HANDHOLE (ST. PAUL)	EACH	3	\$ 450.00	\$ 1,350.00	\$ 1,080.00	\$ 135.00	\$ 135.00
LABOR (ELECTRICIAN & TRUCK)	HR	80	\$ 125.00	\$ 10,000.00	\$ 8,000.00	\$ 1,000.00	\$ 1,000.00
Subtotal				\$ 24,368.19	\$ 19,494.55	\$ 2,436.82	\$ 2,436.82
8% Engineering & Inspection				\$ 1,949.45			
25% MSA Engineering & Inspections (Less 8% MnDOT E&I)				\$ 4,873.64			
Total				\$ 24,368.19	\$ 19,494.55	\$ 2,436.82	\$ 2,436.82
-New Freedom Funds for signal materials/labor				\$ -			
50% split				\$ -			

NEW FREEDOM FUNDS APS INSTALLATION 7TH & HOPE NOT TO SCALE

NEW APS STATIONS: 4
APS ON EXISTING POLES: 4

MnDOT Agreement No. 05551 Work Order 01
Exhibit "C" (Page 1 of 4)

PB 6-1
PLACE PB ON EX. POLE
APS PB & SIGN
LEFT ARROW

PB 6-2
PED. PB STATION & BASE
APS PB & SIGN
RIGHT ARROW

PB 4-1
PLACE PB ON EX. POLE
APS PB & SIGN
LEFT ARROW

PB 4-2
PED. PB STATION & BASE
APS PB & SIGN
RIGHT ARROW

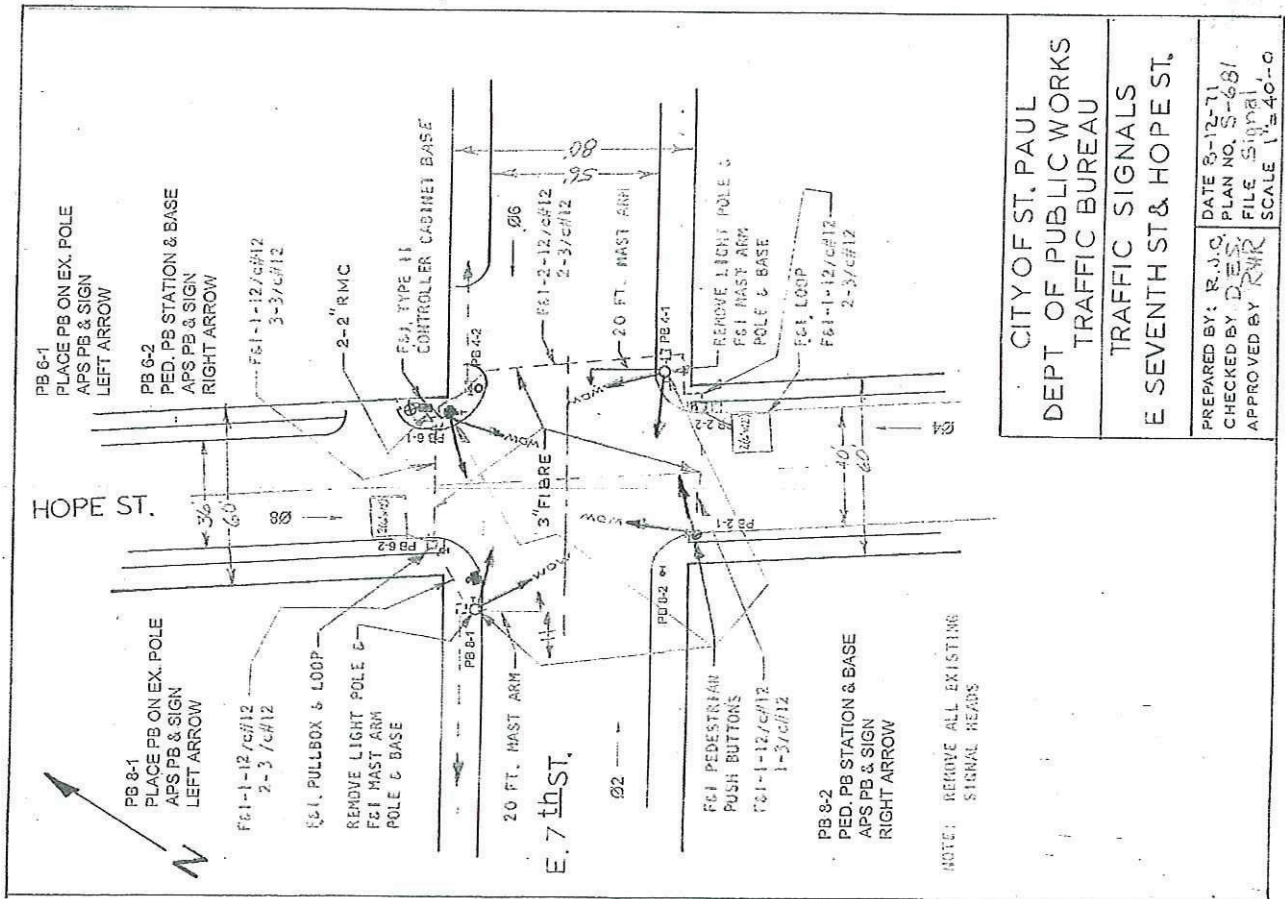

CITY OF ST. PAUL DEPT. OF PUBLIC WORKS TRAFFIC BUREAU	
TRAFFIC SIGNALS E SEVENTH ST & HOPE ST.	
PREPARED BY: R.J.C. CHECKED BY: D.E.S. APPROVED BY: R.H.R.	DATE: 8-12-71 PLAN NO. S-681 FILE: Signal SCALE: 1"=40'-0"

NOTE: REMOVE ALL EXISTING
SIGNAL HEADS

SIGNAL NO: 060

LEGEND

SIGNAL INSTALLATION NO. ①

- SIGNAL FACE NO.
- CONTROLLER CABINET ASSEMBLY & FOUNDATION
- PULLBOX - SIGNAL WIRING
- CONDUIT INSTALLATION
- CONDUIT - IN PLACE
- SIGNAL FACE - IN PLACE
- PEDESTRIAN INDICATION - IN PLACE
- PEDESTRIAN PUSH BUTTON - NEW OR IN PLACE AS NOTED
- FOUNDATION FOR LIGHTING OR SIGNAL POLE - IN PLACE
- LAST ARM ASSEMBLY & FOUNDATION - IN PLACE
- LAST ARM ASSEMBLY, FOUNDATION & LUMINAIRE - IN PLACE
- WOOD POLE - IN PLACE
- POWER SOURCE
- LOOP DETECTOR - IN PLACE
- TEMPORARY SIGNAL

NEW FREEDOM FUNDS APS INSTALLATION FILLMORE & ROBERT

NOT TO SCALE



PB 8-1
REPLACE EX. PB ON EX. POLE
APS PB & SIGN
LEFT ARROW

PB 8-2
PED. PB STATION & BASE
APS PB & SIGN
RIGHT ARROW

PB 2-2
PED. PB STATION & BASE
APS PB & SIGN
RIGHT ARROW

PB 2-1
REPLACE EX. PB ON EX. POLE
APS PB & SIGN
LEFT ARROW

H.H. NO.	H.H. SIZE
1	17"X30"X24"
2	13"X24"X24"
3	13"X24"X24"
4	13"X24"X24"
5	EXISTING
6	EXISTING
7	EXISTING
8	EXISTING
9	13"X24"X24"

DESIGNATION	PHASE	SIZE	DISTANCE TO STOP BAR
D1-1	1	2'-0"X15"	EXISTING
D1-2	2	2'-0"X15"	EXISTING
D1-3	4	2'-0"X15"	EXISTING
D1-4	8	2'-0"X15"	EXISTING
D1-5	8	2'-0"X15"	EXISTING
D1-6	8	2'-0"X15"	EXISTING
D1-7	8	2'-0"X15"	EXISTING
D1-8	8	2'-0"X15"	EXISTING

ALL NEW LOOP DETECTORS SHALL BE N.M.C. LOOPS

NEW APS STATIONS: 4
APS ON EXISTING POLES: 4

MNDOT Agreement No. 03551
Work Order 01
Exhibit "C" (Page 2 of 4)

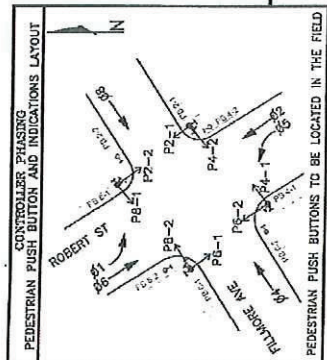
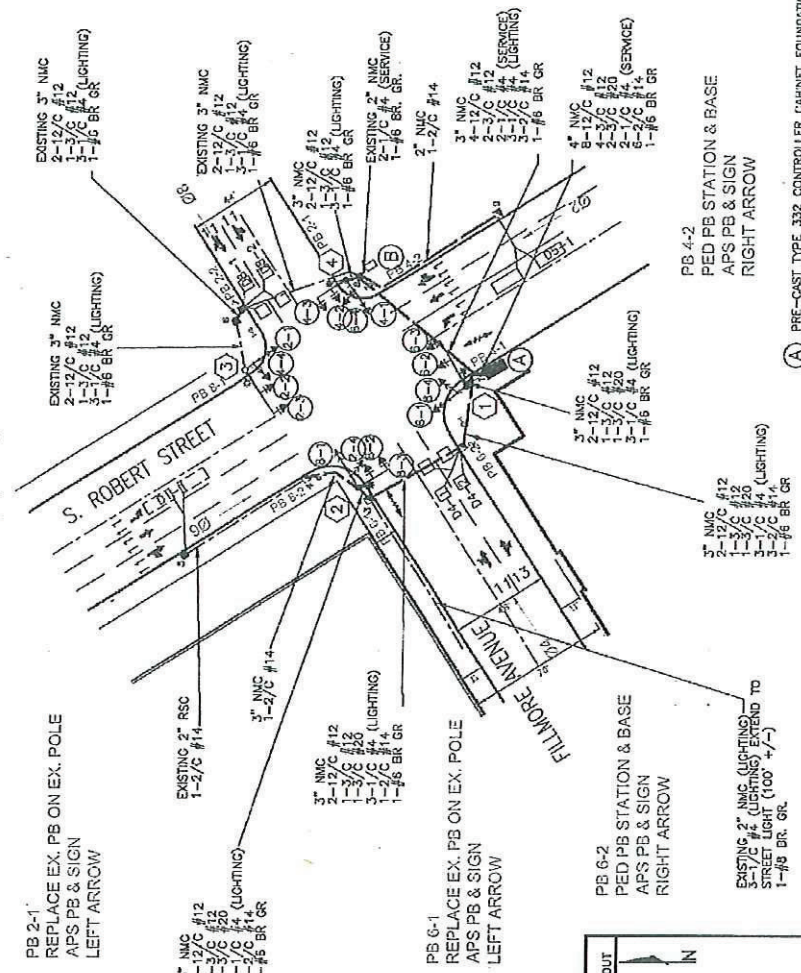

- NOTES:
- CONTROLLER CABINET ASSEMBLY (INCLUDES CONTROLLER BY THE CONTRACTOR) - FURNISHED BY THE CITY INSTALLED
 - LAST ARM ASSEMBLY (INCLUDES TRANS ARM, LAST ARM POLE, EACH OVERHEAD SIGNAL HEAD, PUSH BUTTON & LUMINAIRE EXTENSION) - FURNISHED BY THE CONTRACTOR
 - PEDESTRIAN INDICATIONS SHALL BE 12" X 6" UNLESS OTHERWISE NOTED
 - SALVAGE EXISTING SIGNAL SYSTEM, SEE SPECIAL PROVISIONS
 - INTERCONNECT REQUIREMENTS - TRAFFIC CONTROL INTERCONNECTION FOR
 - SEE SPECIAL PROVISIONS FOR LIGHTING REQUIREMENTS
 - BY THE CITY AND INSTALLATION AND LIGHTS AT POLES 1 AND 2 WILL BE FURNISHED BY THE CITY AND INSTALLATION
 - ALL SIGNAL INDICATORS AND INTERNATIONAL PEDESTRIAN SYMBOLS SHALL USE LIGHT EMITTING DIODE (LED) TECHNOLOGY

① TYPE PAB-A-25-D30-6 (0 AT 0°)
TYPE PASS POLE FOUNDATION
2-ONE WAY SIGNALS (OVERHEAD) MIDMOUNT TO BE LOCATED IN THE FIELD
TWO WAY SIGNAL (TYPE 200) POLE MOUNTED AT 270°
2-PEDESTRIAN PUSH BUTTONS
150 WATT H.P.S. LUMINAIRE
2" NMC STUB

② TYPE PA 85-A-15-D30-6 (0 AT 0°)
TYPE PASS POLE FOUNDATION
2-ONE WAY SIGNALS (OVERHEAD) MIDMOUNT TO BE LOCATED IN THE FIELD
TWO WAY SIGNAL (TYPE 200) POLE MOUNTED AT 270°
2-PEDESTRIAN PUSH BUTTONS
150 WATT H.P.S. LUMINAIRE
2" NMC STUB

③ EXISTING TYPE PAB-A-25-D30-6 (0 AT 0°)
EXISTING TYPE PASS POLE FOUNDATION
REMOVE AND SALVAGE TYPE A-20 MAST ARM
TYPE A-25 MAST ARM
2-ONE WAY SIGNALS (OVERHEAD) MIDMOUNT TO BE LOCATED IN THE FIELD
TWO WAY SIGNAL (TYPE 200) POLE MOUNTED AT 270°
2-PEDESTRIAN PUSH BUTTONS
EXISTING 150 WATT LUMINAIRE

④ TYPE PAB-A-15-D30-6 (0 AT 0°)
TYPE PASS POLE FOUNDATION
ONE WAY SIGNAL (OVERHEAD) MIDMOUNT TO BE LOCATED IN THE FIELD
TWO WAY SIGNAL (TYPE 200) POLE MOUNTED AT 270°
2-PEDESTRIAN PUSH BUTTONS
150 WATT H.P.S. LUMINAIRE
2" NMC STUB

⑤ PRE-CAST TYPE 332 CONTROLLER CABINET FOUNDATION
TYPE 170/332 CONTROLLER CABINET ASSEMBLY

⑥ SOURCE OF POWER
EXISTING NSP TRANSFORMER
EXISTING SERVICE EQUIPMENT

⑦ REPLACE EX. PB ON EX. POLE
APS PB & SIGN
LEFT ARROW

⑧ I HEREBY CERTIFY THAT THIS PLAN WAS PREPARED BY ME OR UNDER MY DIRECT SUPERVISION AND THAT I AM A DULY REGISTERED PROFESSIONAL ENGINEER UNDER THE LAWS OF THE STATE OF ILLINOIS.

