



SUBDIVISION REVIEW APPLICATION
 Department of Planning and Economic Development
 Zoning Section
 1400 City Hall Annex
 25 West Fourth Street
 Saint Paul, MN 55102-1634
 (651) 266-6589

Zoning Office Use Only

File #: 18-072460

Fee: _____

Tentative Hearing Date: _____

PD=8
 TO Be Scheduled

3629 2343 0122 -0123
 01 28 23 12 0001 -0003
 01 28 23 11 00 99

APPLICANT

Name St Paul Technical College
 Address 235 Marshall Ave
 City St. Paul St. MN Zip 55102-1807 Daytime Phone _____
 Name of Owner (if different) _____
 Contact Person (if different) Daniel Kirk Phone 651-846-4173
DANIEL.KIRK@STPAUL.EDU

PROPERTY LOCATION

Address/Location 235 Marshall Ave
 Legal Description See Attached
 Current Zoning RM2
 (attach additional sheet if necessary)

TYPE OF SUBDIVISION:

- Lot Split Lot Split with Variance Reg. Land Survey
 Preliminary Plat Final Plat Combined Plat

STAFF USE ONLY

Planning District _____ Land Use Map _____ Tax Map _____ Zoning _____

Plans Distributed _____ Return by _____ Reviewed by _____

Comments:

(attach additional sheets if necessary)

1-78051100-46115

Applicant's Signature

[Handwritten Signature]

Date 6/6/18 City Agent

[Handwritten Signature]
 6-6-18

Jump to location
 201704 4in MNRAMS [9]
 Water Utility

20180501 1/2in Collins (Wabasha Rock) Utility Tapes

Search Tools

Experimental Tools

External Maps

Help

Public Restrooms BIS Composite [aries]

Public Restrooms BIS Composite [aries]

Public Restrooms BIS Composite [aries]

Public Restrooms BIS Composite [aries]

Public Restrooms BIS Composite [aries]

Public Restrooms BIS Composite [aries]

Public Restrooms BIS Composite [aries]

Public Restrooms BIS Composite [aries]

Public Restrooms BIS Composite [aries]

Public Restrooms BIS Composite [aries]

Public Restrooms BIS Composite [aries]

Public Restrooms BIS Composite [aries]

Public Restrooms BIS Composite [aries]

Public Restrooms BIS Composite [aries]

Public Restrooms BIS Composite [aries]

Public Restrooms BIS Composite [aries]

Public Restrooms BIS Composite [aries]

Public Restrooms BIS Composite [aries]

Public Restrooms BIS Composite [aries]

Public Restrooms BIS Composite [aries]

Public Restrooms BIS Composite [aries]

Public Restrooms BIS Composite [aries]

Public Restrooms BIS Composite [aries]

Public Restrooms BIS Composite [aries]

Public Restrooms BIS Composite [aries]

Public Restrooms BIS Composite [aries]

Public Restrooms BIS Composite [aries]

Public Restrooms BIS Composite [aries]

Public Restrooms BIS Composite [aries]

Public Restrooms BIS Composite [aries]

Public Restrooms BIS Composite [aries]

Public Restrooms BIS Composite [aries]

Public Restrooms BIS Composite [aries]

GeoMOOSE 2.9.2

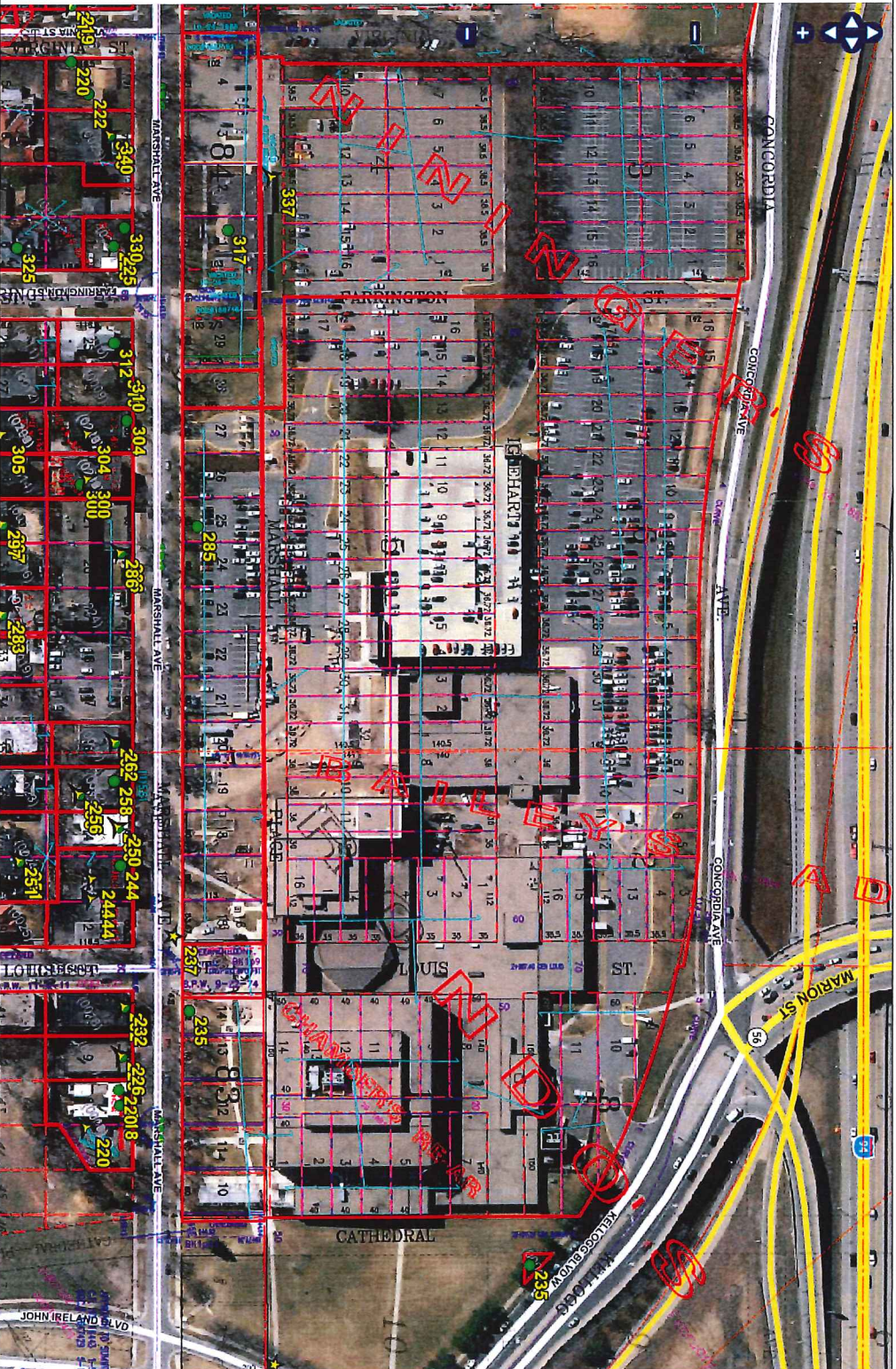

X,Y: 570304, 157933 Lat, Lon: 44.950, -93.112 USNG: 15T VK 911802 779652

CITY OF ST PAUL Owners Report

PID: 36-29-23-43-0122

Property Address: 235 MARSHALL AVE 55102-1807

St Paul Technical College
235 Marshall Ave
St Paul MN 55102-1807

Taxpayer
Resident

State Of Minnesota
235 Marshall Ave
Saint Paul MN 55102-1807

Owner
Resident

VAC STS AND ALLEY ACCRUING AND THE FOL; EX W 4.8 FT; LOT 14 AND W 4 FT OF LOT 9 AND ALL OF LOTS 10 THRU 13 BLK 83 IN DAYTON AND IRVINES ADD AND ALL OF CHAMBERS REARRANGEMENT OF BLK 11 RONDOS ADD AND PART OF SD BLK 11 RONDOS ADD BET SD DAYTON AND IRVINES ADD AND SD CHAMBERS REAR AND PART OF BLK 8 SD RONDOS ADD LYING SLY OF HWY 94 AND PART OF BAILEYS ADD LYING SLY OF SD HWY AND PART OF BLK 6 LYING SLY OF HWY AND ALL OF BLK 5 BOTH IN NININGERS ADD

CITY OF ST PAUL Owners Report

PID: 36-29-23-43-0123

Property Address: 235 MARSHALL AVE 55102-1807

St Paul Technical College
235 Marshall Ave
St Paul MN 55102-1807

Taxpayer
Resident

State Of Minnesota
235 Marshall Ave
Saint Paul MN 55102-1807

Owner
Resident

VAC STS ACCRUING AND THE FOL; EX PARTS OF VAC VIRGINIA ST AS WIDENED; ALL OF BLKS 3 AND BLK 4 AND THAT PART OF VAC MARSHALL PLACE ADJ LOTS 17 THRU 20 MOL BLK 5 AS VAC IN DOC NO.1687161

Report Name: SP-Owners Report

CITY OF ST PAUL Owners Report

Printed: 6/8/2018
Page: 1

PID: 01-28-23-12-0003

Property Address: 317 MARSHALL AVE 55102-1807

Mn State Colleges And Univ
235 Marshall Ave
St Paul MN 55102-1807

Owner
Taxpayer

DAYTON AND IRVINE'S ADDITION TO SAINT PAUL VAC STS ACCRUING AND FOL 3 FT STRIP OF NININGERS ADD N OF AND ADJ AND IN SD DAYTON AND IRVINES ADD W 10 FT OF LOT 28 AND ALL OF LOT 29 BLOCK 83 AND ALL OF BLK 84

Report Name: SP-Owners Report

CITY OF ST PAUL Owners Report

Printed: 6/8/2018
Page: 1

PID: 01-28-23-12-0002

Property Address: 295 MARSHALL AVE 55102

Mn State Colleges And Univ
235 Marshall Ave
St Paul MN 55102-1807

Owner
Taxpayer

DAYTON AND IRVINE'S ADDITION TO SAINT PAUL VAC ST ACCRUING AND FOL PART OF S 3 FT OF NININGERS ADDITION TO ST PAUL N OF AND ADJ AND IN SD DAYTON AND IRVINES ADD EX W 10 FT OF LOT 28 BLK 83

Report Name: SP-Owners Report

**CITY OF ST PAUL
Owners Report**

Printed: 6/8/2018

Page: 1

PID: 01-28-23-12-0001

Property Address: 209 MARSHALL AVE 55102

State Of Minnesota
235 Marshall Ave
Saint Paul MN 55102-1807

Owner
Taxpayer

DAYTON AND IRVINE'S ADDITION TO SAINT PAUL NO PART OF MARSHALL PLACE AS VAC IN DOC 1687161 ADJ ANI
S 3 FT OF BAILEYS ADD AND S 3 FT OF PART OF NININGERS ADD LYING NO OF AND FOL PART W OF LOUIS ST OF
LOT 16 AND ALL OF LOTS 17 THRU LOT 27 BLK 83

Report Name: SP-Owners Report

**CITY OF ST PAUL
Owners Report**

Printed: 6/8/2018

Page: 1

PID: 01-28-23-11-0099

Property Address: 285 MARSHALL AVE 55102-1807

St Paul Technical College
235 Marshall Ave
St Paul MN 55102-1807

Taxpayer
Resident

State Of Minnesota
235 Marshall Ave
Saint Paul MN 55102-1807

Owner
Resident

E 6.33 FT OF LOT 16 AND W 4.8 FT OF LOT 14 AND ALL OF LOT 15 BLK 83

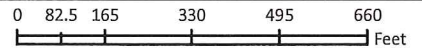
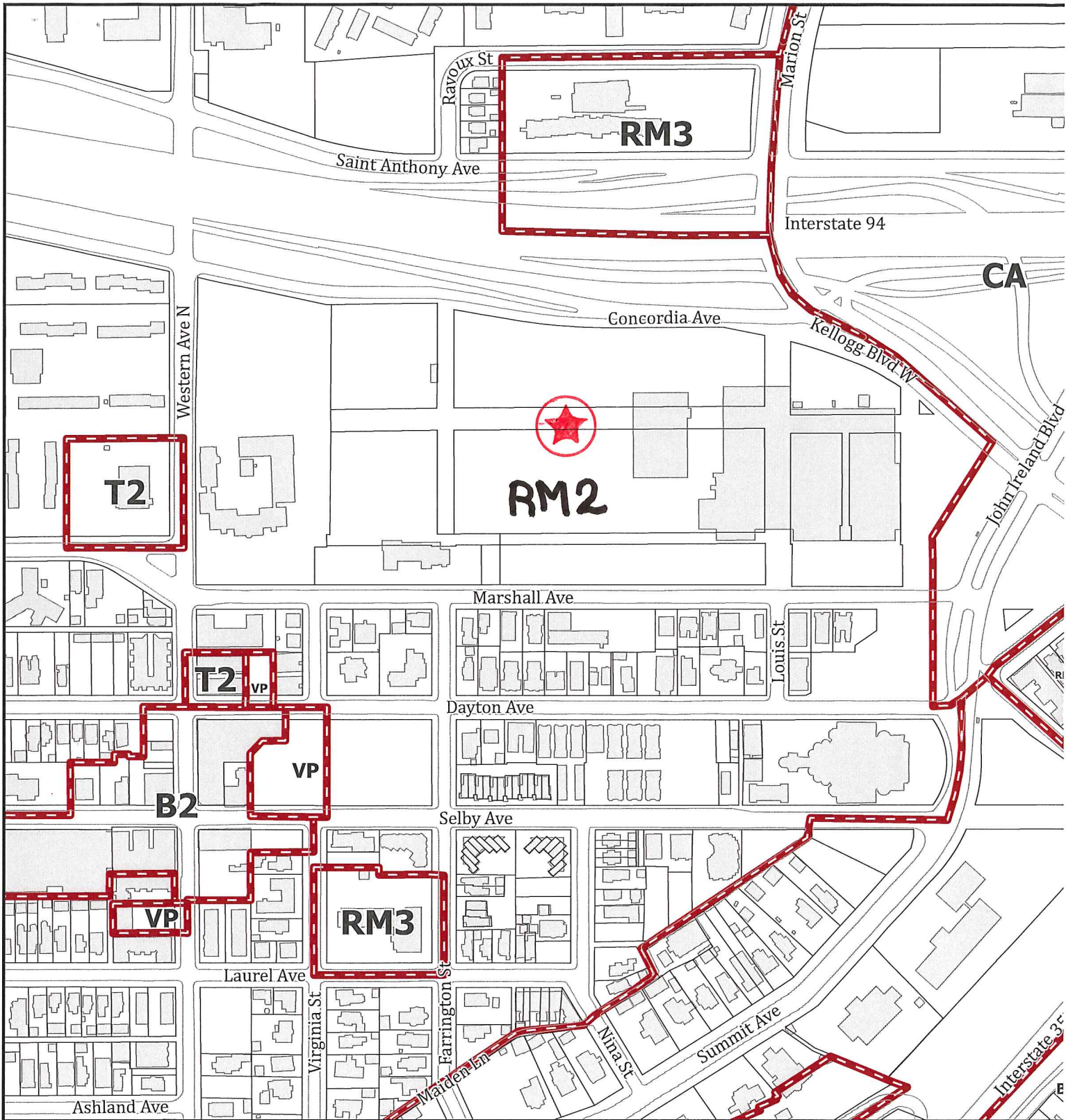

APPLICANT: St. Paul Technical College

ENS

APPLICATION TYPE: _____

FILE #: To Be Assigned DATE: 6/12/2018

PLANNING DISTRICT: _____

ZONING PANEL: _____

