

**From:** [Mark Gilbert](#)  
**To:** [\\*CI-StPaul\\_Contact-Council](#)  
**Subject:** Support the Drive-Through Amendments  
**Date:** Tuesday, November 12, 2024 8:33:49 AM

---

[You don't often get email from markgilbert@pobox.com. Learn why this is important at <https://aka.ms/LearnAboutSenderIdentification> ]

Greetings Saint Paul City Council,

I write to ask you to disallow new drive-throughs in Saint Paul. Our city is already too car-focused, and car focus means pedestrian unfriendly. I read the other day that 75% of the infrastructure we'll have in 2050 doesn't exist yet. I don't think this is true for Saint Paul in particular, but it got me thinking. We should think about the city we want to have in 2050, and start building it now. We want a more pedestrian-friendly city in 2050, so let's start building it now!

Regards,  
Mark Gilbert (Ward 3)  
1855 Lincoln Ave.  
Saint Paul, MN 55105

**From:** [vickielacroix](#)  
**To:** [\\*CI-StPaul\\_Contact-Council](#)  
**Subject:** Please keep Drive thru's  
**Date:** Tuesday, November 12, 2024 8:33:45 AM

---

[You don't often get email from vickielacroix@xmission.com. Learn why this is important at <https://aka.ms/LearnAboutSenderIdentification> ]

Greeting, I just saw you plan to eliminate drive thru's. I am disabled. I can not easily get out of my car to go into stores, restaurants, banks and other places I do business. This would be an incredible hardship for me. Please consider all citizens when making decisions not just the able bodied that can easily get out of their cars and walk up to a window.

Thank you,  
Vickie LaCroix  
Sent from my iPhone

**From:** [maddymn\\_19](#)  
**To:** [\\*CI-StPaul>Contact-Council](#)  
**Subject:** Support the Drive-Through Amendments  
**Date:** Monday, November 11, 2024 11:18:00 AM

---

You don't often get email from maddymn19@gmail.com. [Learn why this is important](#)

Council President Jalali,

My name is Madison Liebl. I'm a resident of St. Paul and I am writing to express my support for the proposed drive-through ban amendments and hope it will be passed when it comes to vote.

I love St. Paul for its historic buildings and character. To see drive-throughs become commonplace would be sad to me. It's a reason why I don't want to live in the suburbs; the chains, lack of walkability, the same building designs that you see everywhere else. Drive-throughs encourage more car dependency and make it difficult for those who can't travel by car or who wish to use other modes such as biking, walking, or taking the bus. I personally have been biking to places such as coffee shops and libraries to take a break from all the driving, and I love the bike lanes and infrastructure that's starting to be built in St. Paul.

Drive-throughs will also increase carbon emissions. As a young person in my 20's I fear what my future will look like as leaders refuse to take the action necessary to stop climate catastrophe. Any part, no matter how small, helps, and by passing this amendment, you will be helping the city continue its Climate Resiliency Plan and help protect people's lives in the coming decades.

I appreciate you taking the time to read this and hope this amendment will be passed to ban food and beverage drive-throughs.

Sincerely,  
Madison Liebl

**From:** [Jennifer Morrow](#)  
**To:** [\\*CI-StPaul\\_Contact-Council](#)  
**Subject:** Support the drive-through amendments  
**Date:** Sunday, November 10, 2024 2:36:47 PM

---

You don't often get email from jennlmorrow1@gmail.com. [Learn why this is important](#)

I strongly support the proposed amendments to the City's zoning regulations regarding drive-throughs and urge you to pass them.

Idling cars in lines create excess emissions, they block sidewalks and bike lanes and pay little attention to safety. The tiny amount of convenience they enjoy is heavily outweighed by all the damage they do.

That Starbucks on Snelling and Marshall was a prime example. It was awful and I'm glad they have closed the drive thru there.

Thank you for your time and attention.

Jenn Morrow 55102

Sent from Gmail Mobile

**From:** [Jenn P](#)  
**To:** [\\*CI-StPaul>Contact-Council](#)  
**Subject:** Comment: Drive-through zoning code amendments  
**Date:** Sunday, November 10, 2024 9:13:03 AM

---

You don't often get email from [j.l.pierson@gmail.com](mailto:j.l.pierson@gmail.com). [Learn why this is important](#)

Council President Jalali and Councilmembers,

I strongly support the proposed amendments to the city's zoning regulations regarding drive-throughs and urge you to pass them. This is a strong and common sense proposal moving Saint Paul toward its clean air and lower emissions goals. The worst impacts of climate change are being felt and we need to urgently take action towards a more sustainable future. Drive-throughs encourage driving and idling which run counter to reducing transportation-related pollution and greenhouse gas emissions a key goal of the Climate Action Resilience Plan.

Additionally, Drive-throughs make Saint Paul's streets and sidewalks less hospitable and more hazardous for all residents, especially those walking, rolling, or biking nearby. As someone who primarily cycles and walks around our city, cleaner air and less congested and safer streets is a priority.

Finally, the profits from corporate drive-throughs offer few benefits to Saint Paul's economy as they are not represented by small businesses. Rather the profits of corporate drive-throughs leave Saint Paul. They contribute little to the City's property tax base, and often inflict greater wear-and-tear on taxpayer-funded streets than do other businesses. In the end, drive-throughs impose more costs for Saint Paul than the benefits they offer.

Sincerely,  
Jenn Pierson  
Resident Highland Park and SPPS teacher

**From:** [Dave Peterson](#)  
**To:** [\\*CI-StPaul>Contact-Council](#)  
**Subject:** Ban on new food/drink drive throughs  
**Date:** Saturday, November 9, 2024 6:16:11 PM

---

You don't often get email from alphaviking1@yahoo.com. [Learn why this is important](#)

Dear St. Paul City Council,

I support the amendment to ban new food/drink drive throughs. Drive throughs eat up enormous amounts of land and are potentially dangerous for pedestrians and cyclists. Instead of having a vibrant city commercial district, we end up with a suburban style wasteland.

Please support the ban on new drive throughs.

Thank you,  
Dave Peterson  
754 Nevada Ave. W  
St. Paul  
651-334-1132

**From:** [Austin bell](#)  
**To:** [\\*CI-StPaul Contact-Council](#)  
**Subject:** Support the drive-through amendments  
**Date:** Saturday, November 9, 2024 12:41:35 PM

---

You don't often get email from acjbell@yahoo.com. [Learn why this is important](#)

Drive-thrus promote automobile infrastructure that is dangerous to climate and the fabric of the city. Idling cars pollute often in lower income neighborhoods. The amount of space needed for drive-thrus lead to low density when the space could be used to build more housing which we desperately need.

Austin Bell  
55117

**From:** [Jill Sims](#)  
**To:** [\\*CI-StPaul\\_Contact-Council](#); [CouncilHearing \(CI-StPaul\)](#)  
**Subject:** Local McDonald's Operators Public Comments on Ord 24-26  
**Date:** Tuesday, November 12, 2024 8:33:41 AM  
**Attachments:** [image001.png](#)  
[image002.png](#)  
[image003.png](#)  
[image004.png](#)  
[image005.png](#)  
[McDonalds Operators Letter to City Council 11.12.2024.pdf](#)

---

Some people who received this message don't often get email from [jill@parkstreetpublic.com](mailto:jill@parkstreetpublic.com). [Learn why this is important](#)

Good Morning,

Please see attached public comment from local McDonald's operators on Ord 24-26 regarding zoning amendments for drive-thrus ahead of the scheduled pubic hearing for tomorrow (November 13).

If you have any questions, please do not hesitate to reach out.

Thank you,

Jill

**Jill Sims**  
PRINCIPAL  
[jill@parkstreetpublic.com](mailto:jill@parkstreetpublic.com)  
612.961.2220 (m)  
525 Park Street, Suite 210  
St. Paul, MN 55103







November 12, 2024

Mitra Jalali, Council President  
Saint Paul City Council  
310-D City Hall  
15 Kellogg Blvd. W.  
St. Paul, MN 55102

Dear Council President Jalali and Members of the Council:

On behalf of local family owned McDonald's owner operators, this letter expresses opposition and concerns to the to [Ordinance 24-26](#), which proposes changes to zoning code in Chapters 65 and 66 for drive-thru and walk-up services.

As local operators, we are regularly evaluating and improving our restaurants' drive-thru services to reduce wait times, prevent blockage of sidewalks and roads, and consider the neighborhoods we live and work in throughout the city. Our customers prefer using drive-thru's to the tune of 70-80% of our business for several key reasons, including:

- Convenience and saving time
- Accessibility for those with mobility challenges or illness
- Avoiding adverse weather conditions
- Ease of travel with children or pets

This proposed ordinance has several significant impacts to our business models, which we've raised below:

**The proposed elimination of use of drive-thru for food and beverage is a significant change, which would prevent any new drive-thru's in Saint Paul.** This seems like a drastic measure in response to a poorly designed restaurant. We urge Council reconsider this provision and continue to allow food and beverage drive-thru's in the City of Saint Paul, under more careful consideration of placement.

**The proposed window walk up or lobby operation requirements to mimic drive-thru hours puts a significant risk on safety to our employees and customers.** While we prefer to have extensive lobby hours, recent safety concerns have put us in the position to reduce lobby hours in late evening hours for the safety of all. Changes to this could result in loss of staff, changes in operating hours, or potential safety risks. We urge Council to reconsider this provision and find opportunities to mitigate late night safety concerns across the City.

**The proposed T3 and T4 zoning requirements, as requiring drive-thru in T3 and T4 to be apart of four story buildings with at least 40,000 square feet would make it very difficult and effectively eliminate restaurant drive-thru's in those neighborhoods.** While we appreciate the innovation other sectors have had to make a drive-thru like this work, from a food perspective this is a difficult challenge.

**Staff recommendations included increasing the existing 60' separation from residential properties up to 120'.** We find this change unnecessary, therefore we encourage the Council to follow suit of the Planning Commission and not increase the existing separation.

**Consideration of site improvements or expansion is noticeably not addressed in this ordinance.** We are proud operators in our community and are always looking for opportunities to improve our locations through beautification, technology upgrades and more to best serve our neighborhood. We encourage Council to ensure our existing drive-thru's have the opportunity to improve or expand as necessary in the future.

Banning or restricting the ability for customers to buy food and beverage will result in less commerce in Saint Paul, greater costs to consumers and business owners, and fewer convenient options for residents and visitors. It is important to consider the impact of economic conditions to local businesses as well as to the tax revenue for the City of Saint Paul. In addition, the proposed new regulations may stifle innovation and efficiencies in renovating restaurants, reducing wait times, and improving the experience for consumers.

As this proposal stands, we ask you to oppose Ordinance 24-26 in it's original form and request you make the changes we've outlined above. We invite each of you into our restaurants to futher discuss and understand our drive-thru model. We are happy to engage in further discussion on this important matter.

Sincerely,

St. Paul/MSP Local Operators:

Patrick Duvall  
Courtney Henry  
Melissa Kennedy  
Jeff Ralph

C: Council Vice President Hwajeong Kim, Ward 5  
Council Member Anika Bowie, Ward 1  
Council Member Rebecca Noecker, Ward 2  
Council Member Saura Jost, Ward 3  
Council Member Nelsie Yang, Ward 6  
Council Member Cheniqua Johnson, Ward 7

**From:** [Macalester Urbanists Student Organization](#)  
**To:** [\\*CI-StPaul Contact-Council](#)  
**Cc:** [Everett Dalton](#); [Timotei Chas](#); [Adam Schwalbe](#); [El Davis-Greene](#); [Freeman Boda](#); [Basil DiBenedetto](#)  
**Subject:** Written Statement for Ord 24-26: Drive-through"s  
**Date:** Tuesday, November 12, 2024 7:15:57 AM  
**Attachments:** [Macalester Urbanists" Public comment on Drive-throughs.pdf](#)

---

You don't often get email from macurbanists@macalester.edu. [Learn why this is important](#)

Good morning,

Attached is the Macalester Urbanists' written statement for Ord 24-26 regarding drive-throughs.

Have a lovely day,  
Macalester Urbanists.

--

**The Macalester Urbanists Presidents:**  
**[Everett Dalton '27](#), [Timotei Chas '27](#), & [Adam Schwalbe '26](#)**  
**[Instagram](#) & [Website](#)**

*“The Macalester Urbanists is an organization whose dual purpose is (i) to connect students to urbanist advocacy and (ii) to foster a community united in a common interest in urbanism. We aim to make urbanism more accessible to all students, regardless of previous knowledge, and we encourage students to engage regardless of anticipated level of advocacy.”*

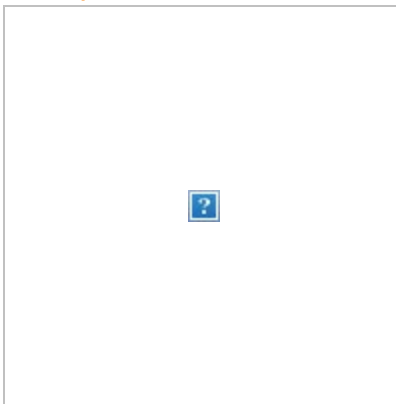



## Macalester Urbanists

1600 Grand Avenue,  
Saint Paul, MN 55105

<https://macurbanists.org/>

November 8, 2024

Subject: Drive Through Zoning Study - D9 Public Comment, Amended

Members of the St Paul City Council,

We, the Macalester Urbanists, represent a coalition of students living in St. Paul who are interested in diligent urban design and governance. As college students, many of us lack cars, and the auto-centric built environment impedes non-car owners. We have spent time deliberating as to how the recommendations made in the drive-through zoning study could affect us, and have come to the position outlined below.

We support a full ban on new drive-thrus in St Paul for the following reasons:

- 1) *Drive-throughs create a **dangerous and inhospitable environment** for pedestrians, cyclists, and public transit users. **Many of us have experienced this** firsthand at Starbucks on Snelling, the Wells Fargo on Grand, and the Caribou on Grand; through the dangerous car cut-throughs of the sidewalks, the built environment is clearly hostile to us not encased in cars. The city has committed to promoting alternative transportation and protecting the safety and comfort of pedestrians and cyclists, as part of this group, **it is clear to us that the current situation is insufficient.** Drive-through access cutting through sidewalks is dangerous for sidewalk users across all age groups. It is **incongruent with the people-centered and safety values of the St. Paul 2040 Plan** Sustainability as well as integration and coordination.*
- 2) *Drive-throughs **increase congestion in commercially and residentially oriented districts.** Issues with off-site queuing around drive-throughs have resulted in the slowing of traffic flows and harming air quality in neighboring areas.*
- 3) *Drive-throughs encourage car-centric design and transportation in the St. Paul area, diminishing the ability of college students to access services. Drive-throughs take up a lot of physical space and prohibit dense and walkable urban design. *Continuing drive-throughs in any form perpetuates auto-centric infrastructure.**

We are sensitive to concerns that reducing drive-through availability may reduce access for people with accessibility concerns and families with young children. However, we believe that

drive-throughs create accessibility barriers for St Paul's non-car users. The safety of pedestrians and cyclists shouldn't be sacrificed for the convenience of drivers. We also find the exception for banks and pharmacies unnecessary. Regarding accessibility concerns, Covid-era measures such as workers coming to cars provide precedents for inclusionary procedures.

Contact-Council@ci.stpaul.mn.us

Sincerely,

Macalester Urbanists

**From:** [Chad Kulas](#)  
**To:** [\\*CI-StPaul\\_Contact-Council](#)  
**Subject:** Midway Chamber Statement on Drive Throughs  
**Date:** Monday, November 11, 2024 8:51:13 AM  
**Attachments:** [image002.png](#)  
[image004.png](#)  
[Midway Chamber Drive Through Ban Letter.docx](#)  
[Midway Chamber Drive Through Ban Letter.pdf](#)

---

You don't often get email from [chad@midwaychamber.com](mailto:chad@midwaychamber.com). [Learn why this is important](#)

Hello,

See attached statement on ORD 24-26, pertaining to drive through windows. I've attached the same copy in pdf and word and you can use whichever you like.

Thank you,  
Chad

Chad Kulas  
Executive Director  
Midway Chamber of Commerce



C: 612.414.1934

[chad@midwaychamber.com](mailto:chad@midwaychamber.com)

[www.midwaychamber.com](http://www.midwaychamber.com)

1600 University Avenue West, Spruce Tree Centre – Suite 301, St. Paul, MN 55104



**Building a Stronger Midway since 1919**



November 6, 2024

Members of the Saint Paul City Council:

The Midway Chamber of Commerce opposes restrictions proposed on drive-throughs in Saint Paul. We find additional restrictions to be discriminatory to the elderly, disabled, ill, and parents with young children.

Many Midway Chamber members are nonprofits and small businesses who work directly with people with disabilities. According to the Minnesota State Demographic Center, over 20% of Minnesotans age 35-75 reported one or more disabilities. This number continues to climb with the aging population.

During the COVID-19 pandemic, many businesses relied on drive-throughs due to restrictions. Should we face another health crisis, there could once again be a safe way for people to attain goods (including prescriptions), do banking and get medically tested.

Of the current 80 drive-throughs in Saint Paul, 25 of them belong to a member of the Midway Chamber. While they could be protected, what happens if the business wishes to renovate their property, expand or open a new location? Renovations are often made to enhance the business as well as make it more aesthetically pleasing; the proposal could make it difficult to make these property improvements. We also believe this will hinder new businesses from choosing to locate in Saint Paul.

In terms of an environmental impact, we too aim for a more eco-friendly city. However, we believe many residents will choose to travel farther for convenience if they cannot use a drive-through in Saint Paul. This not only causes a larger carbon footprint, but would create a loss of sales for Saint Paul businesses and loss of sales tax for the city. In addition, limiting or restricting drive-throughs puts additional pressure on the need for more parking spaces and lower density housing in order to ensure people have reliable parking options to access businesses and services. Parking spaces continue to decrease in the city, while elimination of a drive-through option will require more spaces.

While we remain supportive of drive-throughs, we realize not every drive-through is suitable for the circumstance. Some properties may be too small for a drive through, or a particular proposal is not the best use of space. We believe the current system allows for decisions on a case-by-case basis without asking for an outright ban.

We call on the City Council to consider ways to make doing business in St. Paul easier for consumers and residents. In addition, we ask the City Council to reconsider the proposed drive-through ban and focus on the best and most flexible uses of commercial space which aids the consumer in the long-term.

Sincerely,

A handwritten signature in black ink, appearing to read "Chad Kulas". The signature is written in a cursive, slightly slanted style.

Chad Kulas  
Executive Director



**From:** [Cloteal LaBroi](#)  
**To:** [\\*CI-StPaul\\_Contact-Council](#); [CouncilHearing \(CI-StPaul\)](#)  
**Cc:** [Kim \(she/her\) Winston](#)  
**Subject:** Starbucks - Written Public Comment (Ord 24-26)  
**Date:** Tuesday, November 12, 2024 11:26:45 AM  
**Attachments:** [image002.png](#)  
[City of St. Paul City Council \(11.12.24\).pdf](#)

---

Some people who received this message don't often get email from clabroi@starbucks.com. [Learn why this is important](#)

Attached, please find the written public comment on behalf of Starbucks Coffee Company for Ordinance 24-26 - *Amending Chapters 65 and 66 of the Legislative code pertaining to drive-through sales and services and walk-up service windows*. This written document should be shared during the public comment on public hearings at the St. Paul city council meeting on Wednesday, November 13, 2024.

Thank you,  
Cloteal LaBroi



**Cloteal LaBroi, Esq. (she/her)**  
Regional Head | Government & External Affairs  
**Starbucks Coffee Company**  
111 North Canal St, Chicago, IL 60606  
312.519.3893 (c)



November 12, 2024

St. Paul City Council Members  
15 Kellogg Blvd. West  
310 City Hall  
St. Paul, MN 55102

**RE: Public Hearing: Amending Chapters 65 and 66 of the Legislative Code pertaining to drive-through sales and services and walk-up service windows**

Dear Members of the St. Paul City Council:

I am writing pursuant to the proposed ban on new drive-throughs in St. Paul, MN. As you know, we closed the drive-through portion of our store at Snelling and Marshall in 2022 to ensure pedestrian and customer safety.

We want to ensure you are informed about the significant design and safety protocols Starbucks has inculcated into drive-through projects since 2021 that improve safety and accessibility for customers and the community.

Our mission is to nurture the limitless possibilities of human connection. We create human connections by adapting to the needs of the communities that we serve, and our new store and drive-through models reflect our commitment to communities.

In 2022, we converted our drive-through location at Snelling and Marshall to a Café Only space. We understood the need for a format change, and we wanted to address the needs of the community. We worked closely with our store design partners to create an enhanced patio in the footprint of the prior drive-through which integrated bike-friendly elements and reflected a warm and welcoming space for our customers.

Our site plans for our drive-through lanes have evolved post-COVID.

- Our drive-through locations now have a 12-15 car stack. To increase customer safety, we wrap our drive-throughs around our parking lots when appropriate.
- We now offer a new Y-Lane which is a layout strategy that allows us to increase the number of vehicles in our drive-through queue. This concept is a traffic mitigation approach to alleviate congestion on constrained sites.



- We have also launched a “Queuing Tool” which allows us to estimate traffic count at our drive-through locations and it helps us to better understand the traffic patterns at our stores.
- Our new site plans address pedestrian traffic in our drive-through locations, and we are moving our exit and entry ways from our drive-through locations to eliminate future risks.

Given Starbucks has invested and greatly enhanced our drive-through designs, vehicle stacks, and ingress/egress pedestrian safety, we encourage the City Council to reconsider the proposed plans to eliminate drive-throughs in the B4 Central Business District, limiting drive-through locations in T2 Traditional Neighborhood Districts to banks and pharmacies as many residents including working parents and persons with disabilities need access to other services beyond those outlined in the study, and ensure stacking requirements are geographically calibrated and industry-relevant. We encourage – no “one size fits all” regulation as business needs are unique to the communities we collectively serve.

Starbucks is deeply committed to public, pedestrian, and bicycle safety. Our enhancements are consistent with the City’s desire to create sustainable and livable communities that accommodate all citizens.

Sincerely,

*Cloteal M. LaBroi, Esq.*

Cloteal LaBroi, Esq.  
Regional Head of Government Affairs (Midwest, Mid-America & Mid-South)  
Starbucks Coffee Company



**Y-Lane Drive-Through**

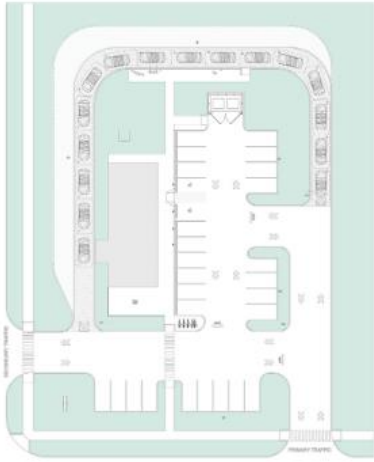

Single Lane DT



Single Order Point Y-Lane

**Recent opening in MN:**

