

SUMMARY OF ENGINEERING RECOMMENDATION
W. Larpenteur Avenue New Sidewalk Construction

Ward 5

PROJECT:

This project is to complete the city sidewalk on the South side of **W. Larpenteur** between **Galtier Street Avenue and Rice Street**. The new sidewalk is approximately 875' long and will be constructed in front of six separate property ID's.

EXISTING CONDITIONS:

This is an incomplete sidewalk. There is an existing sidewalk on the south side of W. Larpenteur Avenue starts at Galtier Street and goes approximately 90' east from Galtier Street. From that point to Marion Street there is no walk. From there going east from Marion Street there is sidewalks to the alley then again no walk to Woodbridge Street. Then no walk between Woodbridge Street to Ablemarle Street and then another 50' east of Ablemarle Street to existing walk.

INITIATING ACTION:

This order was initiated by complaints of the incomplete sidewalk infrastructure in this neighborhood.

ALTERNATES:

Do nothing and this area will stay an incomplete walk where pedestrians will need to use the street.

POSITIVE BENEFITS:

The people who live in the area will have greater walking access to the newly built school. This improvement will positively affect many.

ADVERSE EFFECTS

Normal problems associated with construction such as noise, dust, and general disruption to the neighborhood. There are direct assessments to the abutting properties and some of them may contest the project.

EFFECTS ON TREES:

There may be a need to remove some trees for the new walk but the walk may be able to meander around trees to lessen the impact.

TIME SCHEDULE:

The project is being scheduled for the 2018 construction season.

COST ESTIMATE:

Construction	\$	53,388.00
Contingency	\$	5,000.00
Engineering 30%	\$	5,072.00
City Processing Fee 8%	\$	<u>2,046.00</u>
PROJECT TOTAL	\$	65,506.00

ESTIMATED FINANCING:

Ramsey County	\$	27,873.00
General Fund	\$	10,000.00
Property Assessment	\$	<u>27,633.00</u>
PROJECT TOTAL	\$	65,506.00

SOURCE OF ADDITIONAL INFORMATION

For additional information, contact Sidewalk Supervisor, Allan Czaia, at 266-6108

SUMMARY AND RECOMMENDATION:

The Department of Public Works feels that this is a necessary and worthwhile project, and the Engineering Recommendation is for approval of the project and financing.

 WATER	 Local Roads	 County Road	 MN Highway	 US Highway	 Interstate	 Interstate	 Interstate	 Interstate	 Interstate	 Interstate	 Interstate	 Interstate	 Interstate	 Interstate	 Interstate	 Interstate	 Interstate	 Interstate	 Interstate	 Interstate	 Interstate	 Interstate	 Interstate	 Interstate	 Interstate	 Interstate	 Interstate	 Interstate	 Interstate	 Interstate	 Interstate	 Interstate	 Interstate	 Interstate	 Interstate	 Interstate	 Interstate
--	---	---	--	--	--	--	--	--	--	--	--	--	--	--	--	--	--	--	--	--	--	---	--	--	--	--	--	--	--	--	--	--	--	--	--	--	--



Should be 1" when printed.
 Scale 1:3667
 (1" ≈ 306')

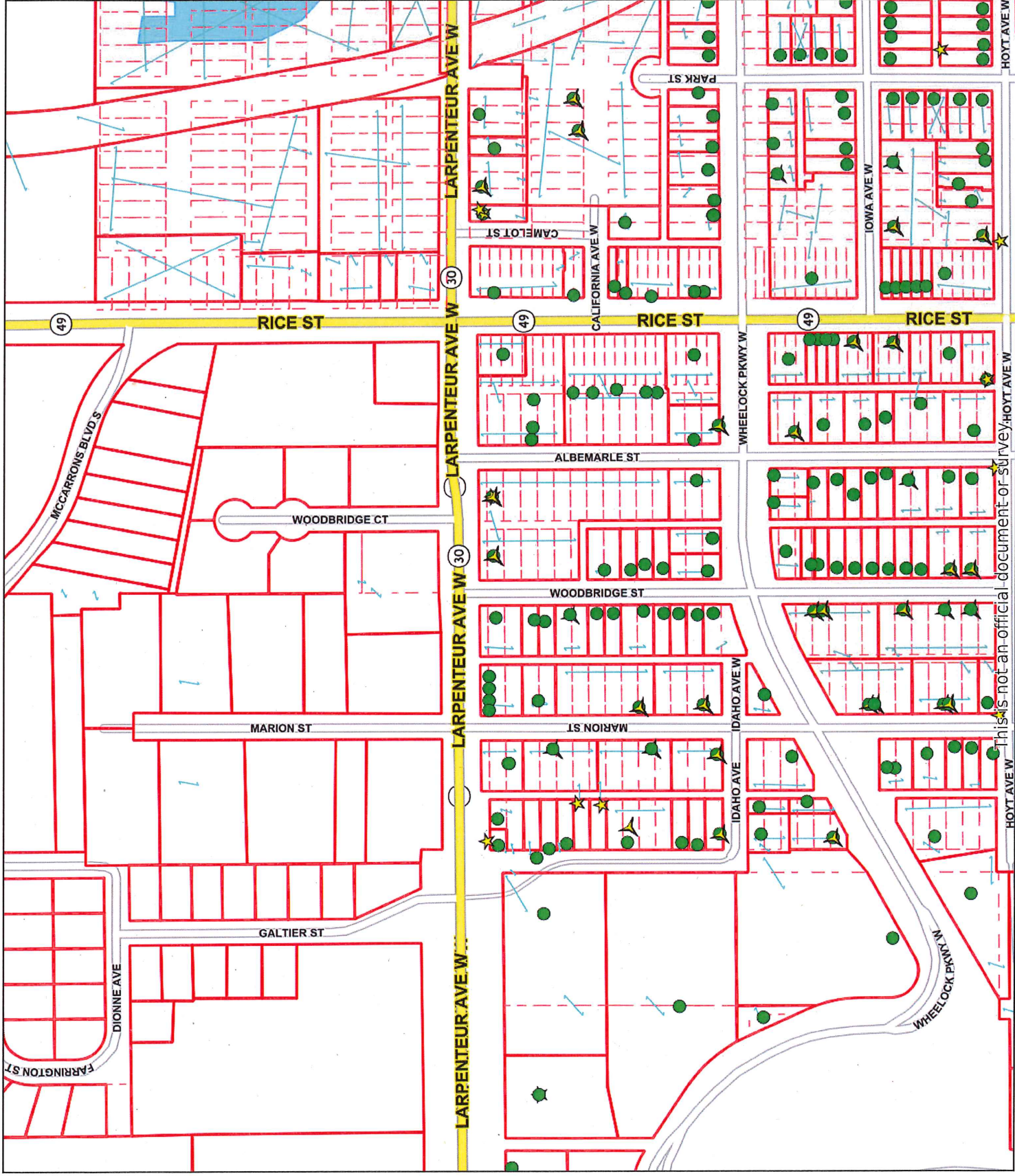

This is not an official document or survey.