

LEGEND

	TURF / LAWN
	PERMEABLE PAVERS
	4' CONCRETE SIDEWALK
	CONCRETE PAVING
	STEPPED LANDSCAPE BEDS

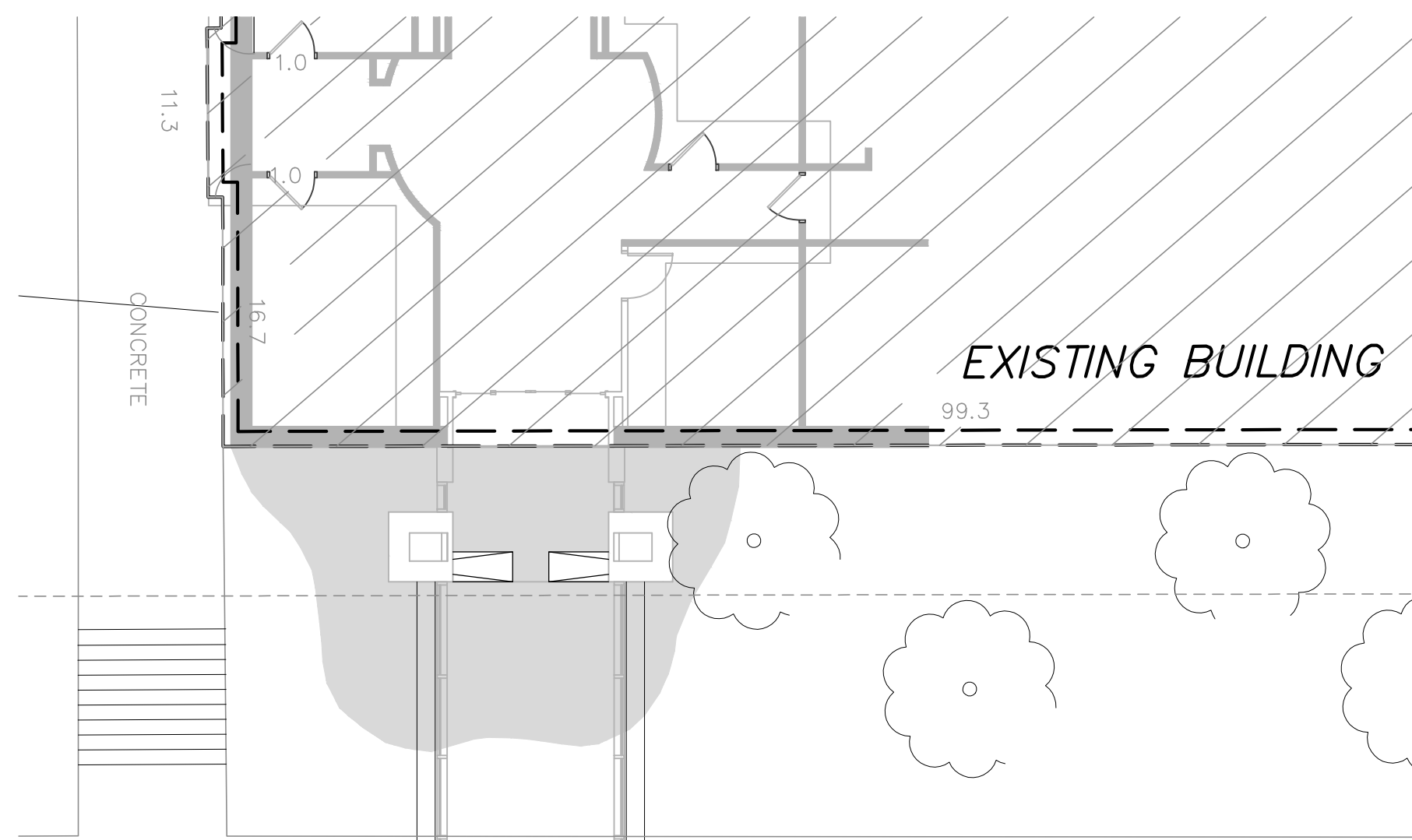

NOTES

- ALL DIMENSIONS ROUNDED TO THE NEAREST TENTH FOOT.
- ALL DIMENSIONS ARE FACE OF CURB TO FACE OF CURB UNLESS NOTED OTHERWISE. BACK OF CURB IS SHOWN GRAPHICALLY ONLY.
- DRAINAGE AND UTILITY EASEMENTS SHALL BE PROVIDED AS REQUIRED. DRAINAGE AND UTILITY EASEMENTS WILL BE PROVIDED OVER ALL PUBLIC UTILITIES.
- RESTORE BOULEVARDS WITH TURF WHERE DISTURBED DUE TO CURB CUT REMOVAL, CONSTRUCTION, UTILITY SERVICE CONNECTION.
- SIDEWALK TO BE 8" CONCRETE AT CURBCUT, 4" EVERYWHERE ELSE.
- ALL WORK ON CURBS, DRIVEWAYS, AND SIDEWALKS WITHIN THE PUBLIC RIGHT-OF-WAY MUST BE DONE TO CITY STANDARDS AND SPECIFICATIONS BY A LICENSED AND BONDED CONTRACTOR UNDER A PERMIT FROM PUBLIC WORKS SIDEWALK SECTION (651-266-6120). SIDEWALK GRADES MUST BE CARRIED ACROSS DRIVEWAYS.
- RESTORATION OF ASPHALT AND CONCRETE PAVEMENTS ARE PERFORMED BY THE PUBLIC WORKS STREET MAINTENANCE DIVISION. THE CONTRACTOR IS RESPONSIBLE FOR PAYMENT TO THE CITY FOR THE COST OF THESE RESTORATIONS. THE CONTRACTOR SHALL CONTACT PUBLIC WORKS STREET MAINTENANCE TO SET UP A WORK ORDER PRIOR TO BEGINNING ANY REMOVALS IN THE STREET AT 651-292-6600. PROCEDURES AND UNIT COSTS ARE FOUND IN STREET MAINTENANCE'S "GENERAL REQUIREMENTS - ALL RESTORATIONS" AND ARE AVAILABLE AT THE PERMIT OFFICE. CONTACT KEVIN NELSON AT 651-266-9700 FOR ESTIMATE OF COSTS FOR PAVEMENT RESTORATION.
- THE CONTRACTOR SHALL CONTACT JOHN MCNAMARA, GENERAL FOREMAN, LIGHTING - SIGNAL MAINTENANCE, (651-487-7209), IF REMOVAL OR RELOCATION OF EXISTING FACILITIES IS REQUIRED OR IN THE EVENT OF DAMAGE TO THE LIGHTING OR SIGNAL UTILITIES. THE CONTRACTOR SHALL ASSUME RESPONSIBILITY (AND RELATED COSTS) FOR ANY DAMAGE OR RELOCATIONS.
- AN OBSTRUCTION PERMIT MUST BE OBTAINED FROM PUBLIC WORKS (651-266-6151) IF TRUCKS/EQUIPMENT WILL BE DRIVING OVER CURBS OR IF CONSTRUCTION WILL BLOCK CITY STREETS OR SIDEWALKS. IT IS STRONGLY RECOMMENDED THAT CONTRACTORS CALL FOR COST ESTIMATES PRIOR TO BIDDING TO OBTAIN ACCURATE COST ESTIMATES.
- THE CONTRACTOR SHALL PROVIDE A CONTINUOUS, ACCESSIBLE AND SAFE PEDESTRIAN WALKWAY THAT MEETS ADA AND MN MUTCD STANDARDS IF WORKING IN A SIDEWALK AREA, AND TRAFFIC CONTROL PER MN MUTCD REQUIREMENTS FOR WORK IN THE PUBLIC RIGHT-OF-WAY.
- ACCESS TO SIGNAL CONTROLLER AND LIGHTING CABINETS MUST BE MAINTAINED AT ALL TIMES - IF FENCING IS REQUIRED FOR THE JOB SITE THAT WOULD ENCLOSE A CONTROLLER OR CABINET, A KEY OR OTHER MEANS OF ACCESS MUST BE PROVIDED TO THE CITY OF SAINT PAUL'S TRAFFIC MAINTENANCE DEPARTMENT. CONTACT JOHN MCNAMARA, GENERAL FOREMAN SIGNALS AND LIGHTING AT 651-266-9780.
- THE DEVELOPER SHALL CONTACT THE RIGHT OF WAY INSPECTOR, SHARON HAMILTON, AT 651-485-0418 (ONE WEEK PRIOR TO BEGINNING WORK) TO DISCUSS TRAFFIC CONTROL, PEDESTRIAN SAFETY AND COORDINATION OF ALL WORK IN THE PUBLIC RIGHT OF WAY.

E. 6TH STREET

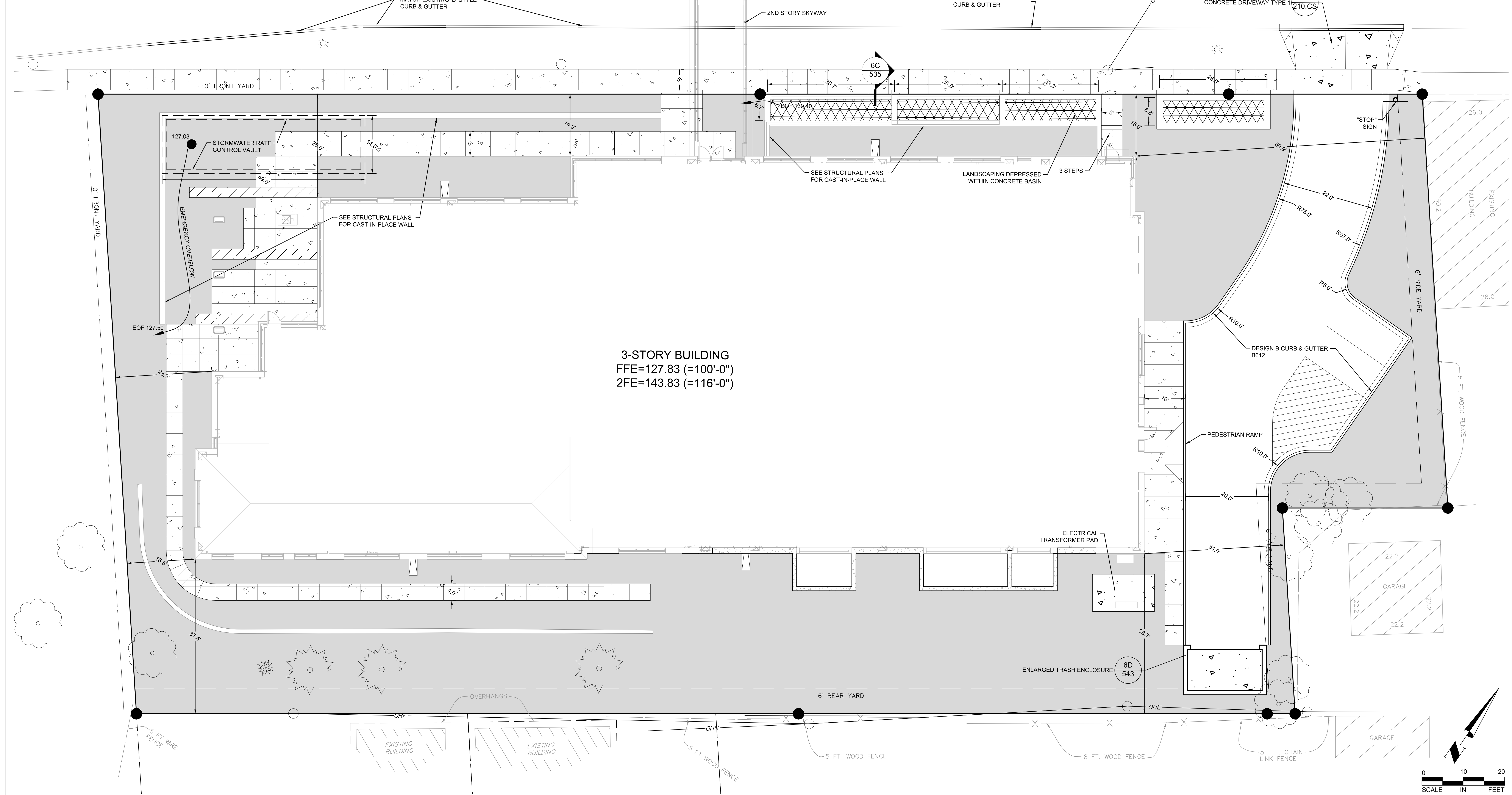

Minnesota STATE COLLEGES & UNIVERSITIES

METROPOLITAN STATE UNIVERSITY
SCIENCE EDUCATION CENTER

B | W | B | R

380 St. Peter Street, Ste. 600
Saint Paul, MN 55102
651.222.3701
bwbr.com

EVS

ENGINEERING SURVEYING ENVIRONMENTAL PLANNING

EVS, INC.
10250 Valley View Road, Suite 123
Eden Prairie, Minnesota 55344
Phone: 952-446-0236
Fax: 952-446-0290
www.evs-eng.com

This document may be an electronic file or may be printed from an electronic file provided to the user. It is the sole responsibility of the user to ensure that the content and quality is consistent with the content and quality of the paper documents on file at BWBR.

I hereby verify that this plan, specification or report was prepared by me or under my direct supervision and that I am a duly Registered Engineer under the laws of the State of Minnesota.

Name: *Brain M. Johnson*
Date: 02.15.2013 Reg. No. 46607

Issued For

Item	Date
SD Issue	1.26.2012
DD Pricing Issue	6.1.2012
DD Issue	8.24.2012
CD Pricing Issue	12.21.2012
CD MNSCU Issue	02.15.2013

This Sheet may be a Reduced Copy. The bar above is 1" long on a Full Size Sheet. Drawing Scales apply to Full Size Sheets.

Date	02/15/2013	Drawn	BJ
Comm. No.	32011249.00	Checked	DZ

Sheet Title
CIVIL SITE PLAN

Sheet No.

200.AS

