

Map of Properties to be Acquired by the City of Saint Paul

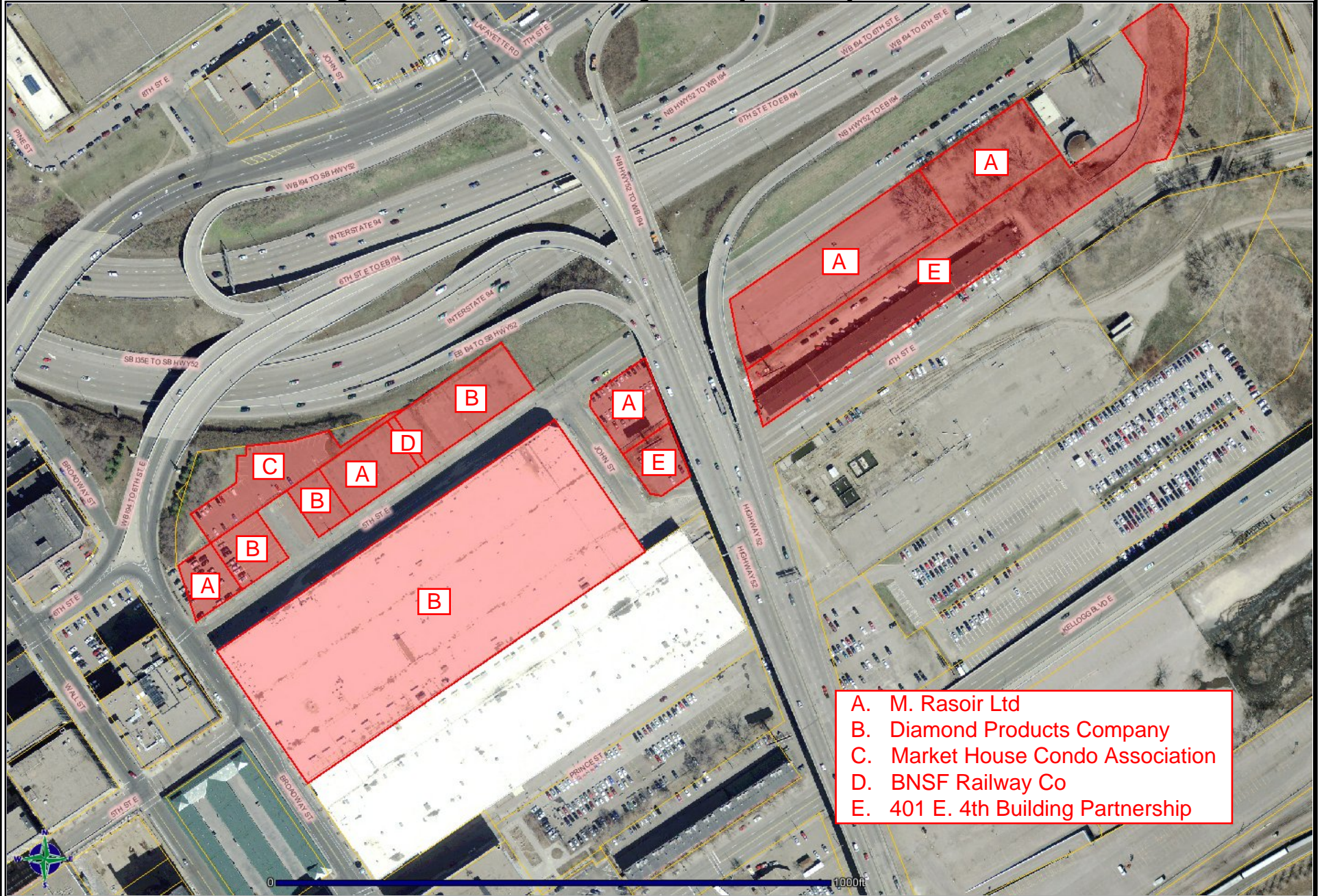

DISCLAIMER: This map is neither a legally recorded map nor a survey and is not intended to be used as one. This map is a compilation of records, information and data located in various city, county, state and federal offices and other sources regarding the area shown, and is to be used for reference purposes only.

SOURCES: Ramsey County (June 4, 2012), The Lawrence Group: June 4, 2012 for County parcel and property records data; June 2012 for commercial and residential data; April 2009 for color aerial imagery; All other