

	A	B	C	D
1	ALLINA HEALTH SYSTEM	5901 LINCOLN DR	EDINA MN 55436-1611	12823140202
2	HSRE MN RITCHIE LLC	3500 AMERICAN BLVD W SUITE 200	MINNEAPOLIS MN 55431-1096	12823140207
3	HSRE MN RITCHIE LLC	3500 AMERICAN BLVD W SUITE 200	MINNEAPOLIS MN 55431-1096	12823140199
4	HSRE MN RITCHIE LLC	3500 AMERICAN BLVD W SUITE 200	MINNEAPOLIS MN 55431-1096	12823140201
5	COMPASS45 HOSPITALITY LLC	7900 INTERNATIONAL DR STE 910	BLOOMINGTON MN 55425-2462	12823410186
6	HSRE MN RITCHIE LLC	3500 AMERICAN BLVD W SUITE 200	MINNEAPOLIS MN 55431-1096	12823140200
7	ALLINA HEALTH SYSTEM	PO BOX 43	MINNEAPOLIS MN 55440-0043	12823140197
8	ALLINA HEALTH SYSTEM	5901 LINCOLN DR	EDINA MN 55436-1611	12823140203
9	HSRE MN RITCHIE LLC	3500 AMERICAN BLVD W SUITE 200	MINNEAPOLIS MN 55431-1096	12823140206
10	COMPASS45 HOSPITALITY LLC	7900 INTERNATIONAL DR STE 910	BLOOMINGTON MN 55425-2462	12823410188
11	ALLINA HEALTH SYSTEM	PO BOX 43	MINNEAPOLIS MN 55440-0043	12823140195
12	HSRE MN RITCHIE LLC	3500 AMERICAN BLVD W SUITE 200	MINNEAPOLIS MN 55431-1096	12823140205
13	ALLINA HEALTH SYSTEM	5901 LINCOLN DR	EDINA MN 55436-1611	12823140204
14	HSRE MN RITCHIE LLC	3500 AMERICAN BLVD W SUITE 200	MINNEAPOLIS MN 55431-1096	12823140208
15	PAULINA LLC	PO BOX 24211	EDINA MN 55424-0211	12823410019
16	ALLINA HEALTH SYSTEM	5901 LINCOLN DR	EDINA MN 55436-1611	12823140198

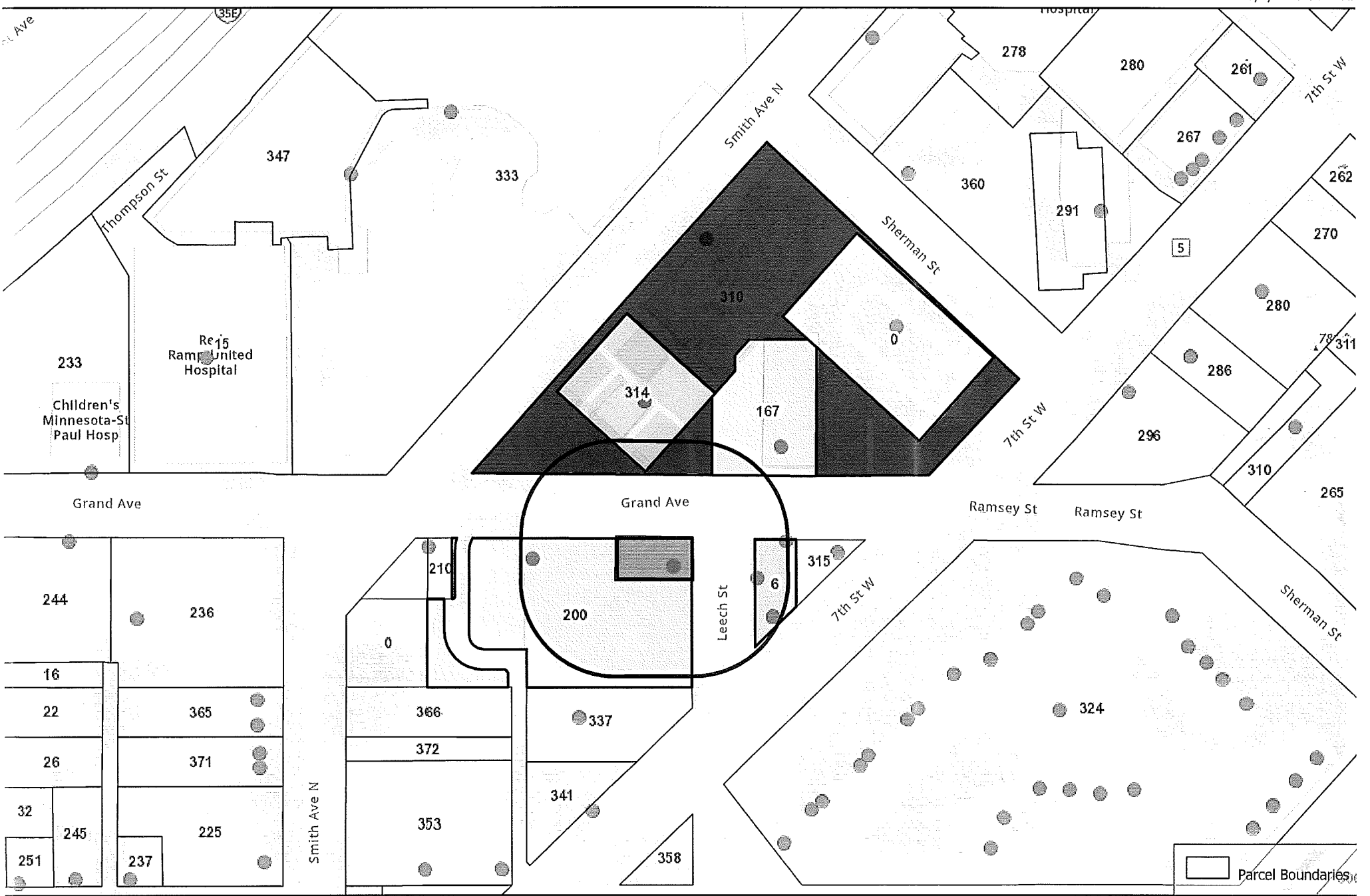

Saint Paul Minnesota
The most livable city in America

Sources: Esri, Airbus DS, USGS, NGA, NASA, CGIAR, N Robinson, NCEAS, NLS, OS, NMA, Geodatastyrelsen, Rijkswaterstaat, GSA, Geoland, FEMA, Intermap and the GIS user community, City of Saint Paul - Public Works

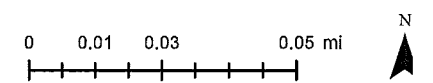

The Geographic Information System (GIS) Data to which this notice is attached are made available pursuant to the Minnesota Government Data Practices Act (Minnesota Statutes Chapter 13). The GIS Data are provided to you "AS IS" and without any warranty as to their performance, merchantability, or fitness for any particular purpose. The GIS Data were developed by the City of Saint Paul for its own internal business purposes. The City of Saint Paul does not represent or warrant that the GIS Data or the data documentation are error-free, complete, current, or accurate. You are responsible for any consequences resulting from your use of the GIS Data or your reliance on the GIS Data. You should consult the data documentation for the particular GIS Data to determine the limitations of the GIS Data and the precision with which the GIS Data may depict distance, direction, location, or other geographic features. If you transmit or provide the GIS Data (or any portion of it) to