

My Map

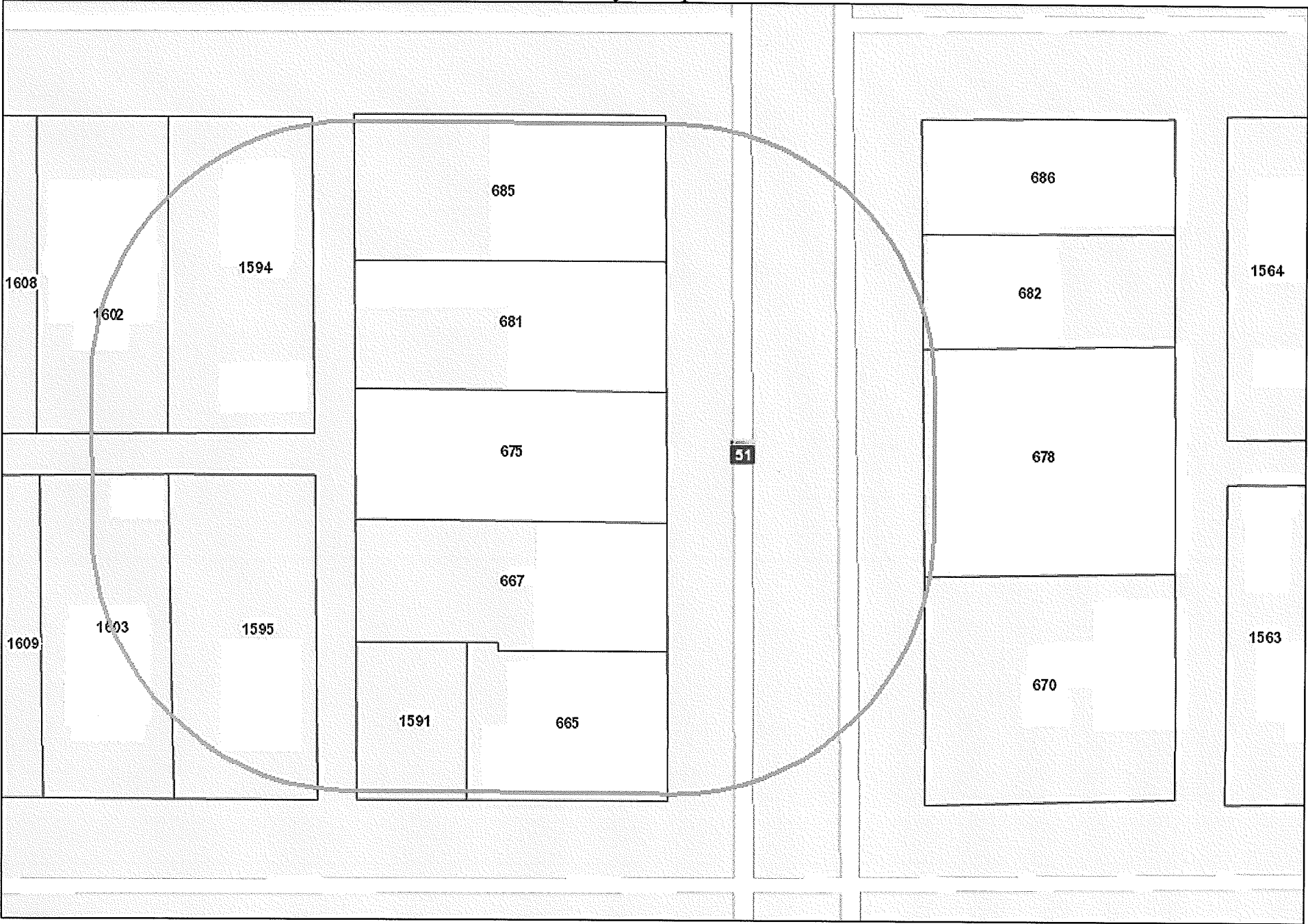

0.00226045 0.009 Miles

Date: 11/9/2018 Time: 4:26:37 PM

Service Layer Credits: OTC GIS
City of Saint Paul - Public Works



	A	B	C	D
1	ParcelID	TaxName1	TaxAddress	TaxCityStZIP
2	332923110216	KATHRYN M NELSON	3475 SIEMS CT	ARDEN HILLS MN 55112-3639
3	332923110046	DUSTY MOORE	1594 VAN BUREN AVE	SAINT PAUL MN 55104-1818
4	332923110029	MARJORIE CONRAD	1595 BLAIR AVE	ST PAUL MN 55104-1831
5	332923110045	MORROW PARTNERS INC	PO BOX 836	LAKE ELMO MN 55042-0436
6	332923110030	BENJAMIN A LAMB	1603 BLAIR AVE	ST PAUL MN 55104-1831
7	332923110217	KATHRYN M NELSON	3475 SIEMS CT	ARDEN HILLS MN 55112-3639
8	332923110215	SIRAK A HAILU	671 SNELLING AVE N	SAINT PAUL MN 55104-1839
9	342923220180	SIRAK HAILU	670 SNELLING AVE N	SAINT PAUL MN 55104-1840
10	332923110025	BRIAN P MCCONNON	675 SNELLING AVE N	ST PAUL MN 55104-1839
11	342923220179	SG NATIONAL LLC	1185 SIXTH AVE 10TH FLR	NEW YORK NY 10036-2604
12	332923110024	MMH HOLDING LLC	3844 XERXES AVE S	MINNEAPOLIS MN 55410-1133
13	342923220178	NAM M HO	559 HEINEL DR	ROSEVILLE MN 55113-2108
14	332923110023	MMH HOLDING LLC	3844 XERXES AVE S	MINNEAPOLIS MN 55410-1133