

| | A | B | C | D |
|----|---------------------------------|-----------------------------|----------------------------|-------------|
| 1 | SELBY DAYTON LLC | 375 JACKSON ST STE 700 | SAINT PAUL MN 55101-1810 | 12823210044 |
| 2 | COSTELLO PROPERTIES | 2150 ANGELL RD | SUNFISH LAKE MN 55118-0528 | 12823210045 |
| 3 | GREGORY W HECK ROBERT M BEYER | 185 LEXINGTON PKWY S | SAINT PAUL MN 55105-2755 | 12823210441 |
| 4 | NORMA J PEARSON | 165 WESTERN AVE N CONDO 200 | SAINT PAUL MN 55102-4621 | 12823210049 |
| 5 | ABS WESTERN LLC | 191 WESTERN AVE N | SAINT PAUL MN 55102-1748 | 12823210317 |
| 6 | TARA SWEDBERG NATHAN VAN SICKLE | 396 DAYTON AVE | SAINT PAUL MN 55102-1706 | 12823210027 |
| 7 | COSTELLO PROPERTIES | 2150 ANGELL RD | SUNFISH LAKE MN 55118-0528 | 12823210048 |
| 8 | YWCA OF ST PAUL | 375 SELBY AVE | ST PAUL MN 55102-1822 | 12823210316 |
| 9 | SELBY DAYTON LLC | 29 S DEEP LAKE RD | NORTH OAKS MN 55127-6312 | 12823210448 |
| 10 | SELBY AVENUE REALTY LLC | 400 SELBY AVE | SAINT PAUL MN 55102-1725 | 12823210400 |
| 11 | ST PAUL INTERVENTION PROJECT | 394 DAYTON AVE | SAINT PAUL MN 55102-1771 | 12823210449 |
| 12 | DACBLD LLC | 340 CEDAR ST UNIT 100 | SAINT PAUL MN 55101-1126 | 12823120151 |
| 13 | YWCA OF ST PAUL | 375 SELBY AVE | ST PAUL MN 55102-1822 | 12823120287 |
| 14 | DACBLD LLC | 340 CEDAR ST UNIT 100 | SAINT PAUL MN 55101-1126 | 12823120152 |
| 15 | DACBLD LLC | 340 CEDAR ST UNIT 100 | SAINT PAUL MN 55101-1126 | 12823120153 |
| 16 | DACBLD LLC | 340 CEDAR ST UNIT 100 | SAINT PAUL MN 55101-1126 | 12823120154 |
| 17 | DACBLD LLC | 340 CEDAR ST UNIT 100 | SAINT PAUL MN 55101-1126 | 12823120155 |
| 18 | DACBLD LLC | 340 CEDAR ST UNIT 100 | SAINT PAUL MN 55101-1126 | 12823120156 |
| 19 | DACBLD LLC | 340 CEDAR ST UNIT 100 | SAINT PAUL MN 55101-1126 | 12823120157 |
| 20 | DACBLD LLC | 340 CEDAR ST UNIT 100 | SAINT PAUL MN 55101-1126 | 12823120158 |
| 21 | DACBLD LLC | 340 CEDAR ST UNIT 100 | SAINT PAUL MN 55101-1126 | 12823120159 |
| 22 | DACBLD LLC | 340 CEDAR ST UNIT 100 | SAINT PAUL MN 55101-1126 | 12823120160 |
| 23 | DACBLD LLC | 340 CEDAR ST UNIT 100 | SAINT PAUL MN 55101-1126 | 12823120161 |
| 24 | DACBLD LLC | 340 CEDAR ST UNIT 100 | SAINT PAUL MN 55101-1126 | 12823120162 |
| 25 | DACBLD LLC | 340 CEDAR ST UNIT 100 | SAINT PAUL MN 55101-1126 | 12823120163 |
| 26 | JULIA V GRIGORIEV | 165 WESTERN AVE N # 210 | SAINT PAUL MN 55102-4633 | 12823210059 |
| 27 | HEATHER TRACHSEL | 165 WESTERN AVE N # 300 | SAINT PAUL MN 55102-4621 | 12823210060 |
| 28 | HANS FREDERICK CHRISTENSON | 165 WESTERN AVE N CONDO 301 | SAINT PAUL MN 55102-4621 | 12823210061 |
| 29 | MARK R JOHNSON | 165 WESTERN AVE N # 302 | ST PAUL MN 55102-4611 | 12823210062 |
| 30 | ALEXANDER EDGERTON | 165 WESTERN AVE N # 409 | SAINT PAUL MN 55102-4621 | 12823210080 |
| 31 | IAN T BURTON PAMELA V BURTON | 1 S PALWAY | LAKE WORTH FL 33460-4122 | 12823210081 |
| 32 | GERILYN SAUCEDO ROMAN SAUCEDO | 165 WESTERN AVE N UNIT 500 | SAINT PAUL MN 55102-4621 | 12823210082 |
| 33 | JUNE M BERKOWITZ | 39 GROVE ST | MAHTOMEDI MN 55115-1629 | 12823210083 |

| | A | B | C | D |
|----|--|------------------------------|------------------------------|-------------|
| 34 | LILLIAN OUELLETTE HOWITZ | 165 WESTERN AVE N # 201 | SAINT PAUL MN 55102-4621 | 12823210050 |
| 35 | JOBETH MARSHALL | 165 WESTERN AVE N # 202 | ST PAUL MN 55102-4611 | 12823210051 |
| 36 | LINDSEY FAST | 165 WESTERN AVE N UNIT 207 | SAINT PAUL MN 55102-4621 | 12823210056 |
| 37 | SHAVAL WEBB CROOMS | 165 WESTERN AVE N UNIT 209 | SAINT PAUL MN 55102-4633 | 12823210058 |
| 38 | PATRICIA J LAZARUS JAMES J MCKENZIE | 165 WESTERN AVE N UNIT 303 | SAINT PAUL MN 55102-4621 | 12823210063 |
| 39 | HENRY PYE KAYLA M NULL GRACIA | 165 WESTERN AVE N # 307 | SAINT PAUL MN 55102-4621 | 12823210067 |
| 40 | JOANNE SIMONS | 165 WESTERN AVE N UNIT 405 | SAINT PAUL MN 55102-4621 | 12823210076 |
| 41 | ERIK W SMITH JANE BEHREND S | 165 WESTERN AVE N CONDO 407 | SAINT PAUL MN 55102-4621 | 12823210078 |
| 42 | BARBARA BOCCI | 165 WESTERN AVE N # 503 | SAINT PAUL MN 55102-4621 | 12823210085 |
| 43 | VICTOR A BLOOMFIELD | 820 NW 12TH AVE APT 304 | PORTLAND OR 97209-3046 | 12823210087 |
| 44 | JENNIFER K NELSON | 165 WESTERN AVE N APT 510 | SAINT PAUL MN 55102-4634 | 12823210092 |
| 45 | LANCE E GROTH | 165 WESTERN AVE N UNIT 203 | SAINT PAUL MN 55102-4621 | 12823210052 |
| 46 | THE CLINE FAMILY TRUST | 51 COMMONS CIR | HAWTHORN WOODS IL 60047-1246 | 12823210053 |
| 47 | ANNE HYLAND | 165 WESTERN AVE N UNIT 205 | SAINT PAUL MN 55102-4621 | 12823210054 |
| 48 | PATRICIA JO KOWALKE | 165 WESTERN AVE N # 309 | SAINT PAUL MN 55102-4621 | 12823210069 |
| 49 | DENISE J ABBOTT | 165 WESTERN AVE UNIT 310 | SAINT PAUL MN 55102-4621 | 12823210070 |
| 50 | BLAIR HOUSE RES CONDO ASSN | 8100 OLD CEDAR AVE S STE 300 | BLOOMINGTON MN 55425-1803 | 12823210073 |
| 51 | CHERYL BROWN | 165 WESTERN AVE N CONDO 403 | SAINT PAUL MN 55102-4621 | 12823210074 |
| 52 | ROBERT A STRANDQUIST PATTY D STRANDQUIST | 165 WESTERN AVE N UNIT 506 | SAINT PAUL MN 55102-4621 | 12823210088 |
| 53 | E CAROLINE GALE PETER W FISH | 165 WESTERN AVE N # 507 | ST PAUL MN 55102-4612 | 12823210089 |
| 54 | KARRIE DIETZ MICHAEL GALLIGAN | 1691 BUCKINGHAM PATH | FARIBAULT MN 55021-7021 | 12823210090 |
| 55 | ERIN CAMPBELL | 165 WESTERN AVE N UNIT 509 | SAINT PAUL MN 55102-4621 | 12823210091 |
| 56 | EMILY DEBEVEC | 2806 BUCKINGHAM RD | LOS ANGELES CA 90016-3600 | 12823210055 |
| 57 | BLAKE D M RATNER VADDEY A RATNER | 165 WESTERN AVE N 208 | SAINT PAUL MN 55102-2475 | 12823210057 |
| 58 | EARL MEDINTZ D CHERYL MEDINTZ | 165 WESTERN AVE N # 304 | ST PAUL MN 55102-4621 | 12823210064 |
| 59 | ELLEN F SHAFFER KEVIN T FENTON | 165 WESTERN AVE N # 308 | ST PAUL MN 55102-4621 | 12823210068 |
| 60 | GEORGE MASTROGIORGIS | 165 WESTERN AVE N # 404 | SAINT PAUL MN 55102-4621 | 12823210075 |
| 61 | THOMAS ANDREW WEBER STEVEN WEBER | 165 WESTERN AVE N # 406 | SAINT PAUL MN 55102-4621 | 12823210077 |
| 62 | STUART KLEIN | 165 WESTERN AVE N UNIT 408 | SAINT PAUL MN 55102-4621 | 12823210079 |
| 63 | EVAN A FRIEDLEY | 165 WESTERN AVE N UNIT 502 | SAINT PAUL MN 55102-4621 | 12823210084 |
| 64 | SANDRA G PETERSON ROBERT A PETERSON | 165 WESTERN AVE N CONDO 504 | SAINT PAUL MN 55102-4621 | 12823210086 |
| 65 | LEONARDO LASANSKY | 165 WESTERN AVE N # 400 | ST PAUL MN 55102-4612 | 12823210320 |
| 66 | VONDA S WURZBURGER TR | 307 S 2ND ST | ALMA WI 54610-0000 | 12823210446 |

| | A | B | C | D |
|----|-------------------------------|----------------------|--------------------------|-------------|
| 67 | CHARLES W OGDEN TR | 1256 FALL CREEK RD | LINCOLN NE 68510-4967 | 12823210447 |
| 68 | SELBY AVENUE REALTY LLC | 400 SELBY AVE | SAINT PAUL MN 55102-1725 | 12823210094 |
| 69 | SELBY AVENUE REALTY LLC | 400 SELBY AVE | SAINT PAUL MN 55102-1725 | 12823210093 |
| 70 | GREGORY W HECK ROBERT M BEYER | 185 LEXINGTON PKWY S | SAINT PAUL MN 55105-2755 | 12823210442 |
| 71 | GREGORY W HECK ROBERT M BEYER | 185 LEXINGTON PKWY S | SAINT PAUL MN 55105-2755 | 12823210445 |
| 72 | GREGORY W HECK ROBERT M BEYER | 185 LEXINGTON PKWY S | SAINT PAUL MN 55105-2755 | 12823210443 |
| 73 | GREGORY W HECK ROBERT M BEYER | 185 LEXINGTON PKWY S | SAINT PAUL MN 55105-2755 | 12823210444 |

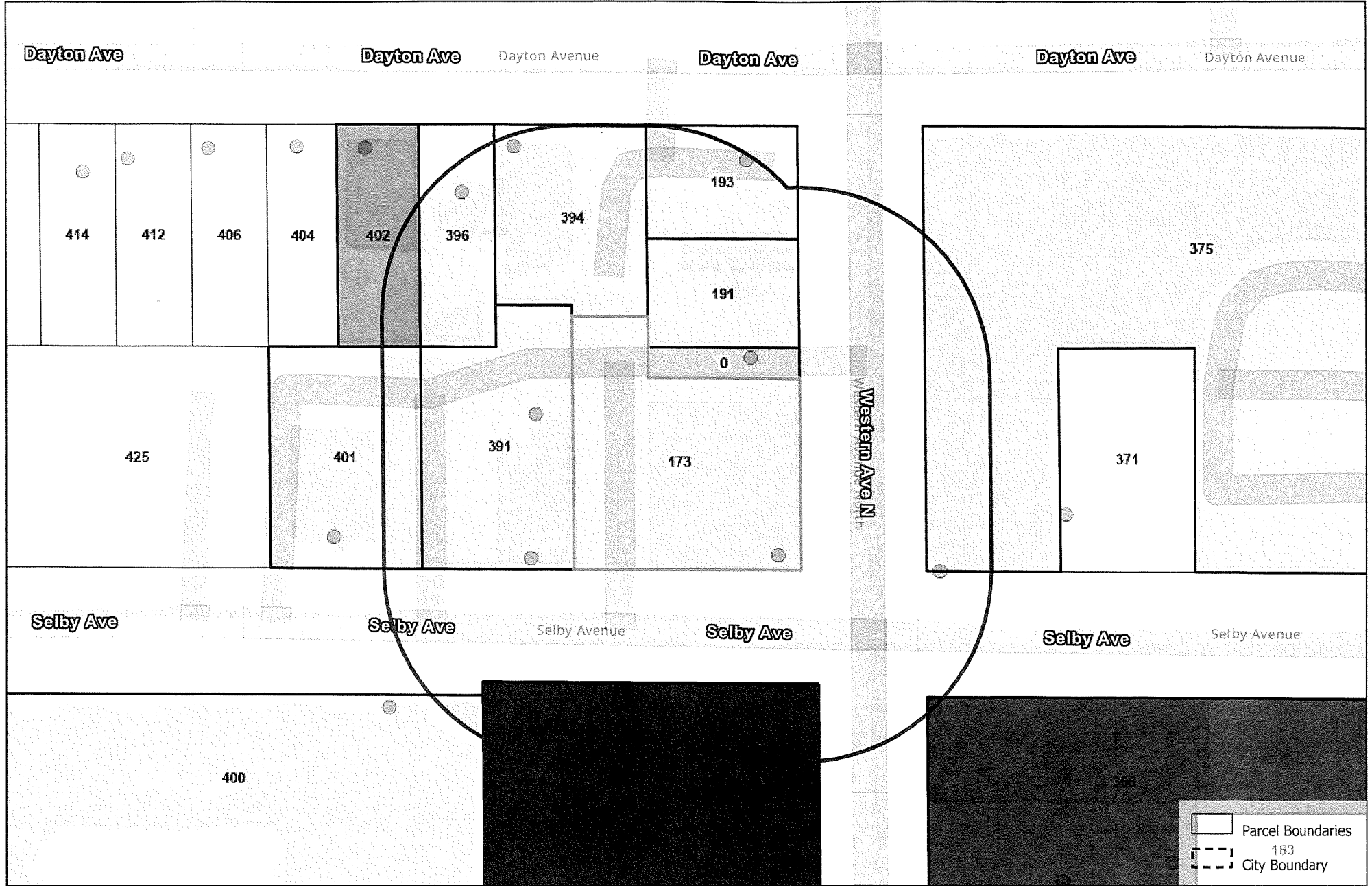

Esri Community Maps Contributors, County of Ramsey, Metropolitan Council, MetroGIS, © OpenStreetMap, Microsoft, Esri, TomTom, Garmin, SafeGraph, GeoTechnologies, Inc, METI/NASA, USGS, EPA, NPS, US

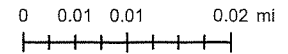

The Geographic Information System (GIS) Data to which this notice is attached are made available pursuant to the Minnesota Government Data Practices Act (Minnesota Statutes Chapter 13). The GIS Data are provided to you "AS IS" and without any warranty as to their performance, merchantability, or fitness for any particular purpose. The GIS Data were developed by the City of Saint Paul for its own internal business purposes. The City of Saint Paul does not represent or warrant that the GIS Data or the data documentation are error-free, complete, current, or accurate. You are responsible for any consequences resulting from your use of the GIS Data or your reliance on the GIS Data. You should consult the data documentation for this particular GIS Data to determine the limitations of the GIS Data and the precision with which the GIS Data may depict distance, direction, location, or other geographic features. If you transmit or provide the GIS Data (or any portion of it) to another user, the GIS Data must include a copy of this disclaimer.