

COMMUNITY OF PEACE ACADEMY

ST. PAUL, MINNESOTA

SITE DEMOLITION, SITE DIMENSION, GRADING, DRAINAGE, EROSION CONTROL & UTILITY PLAN

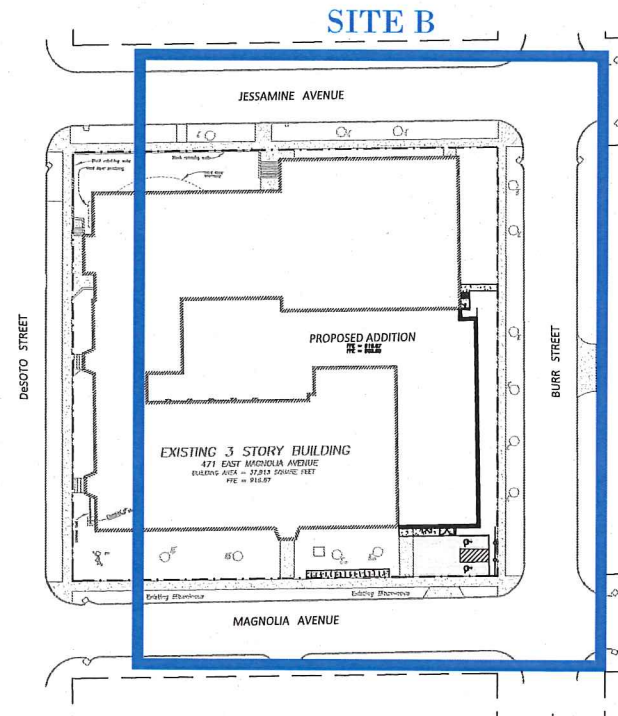
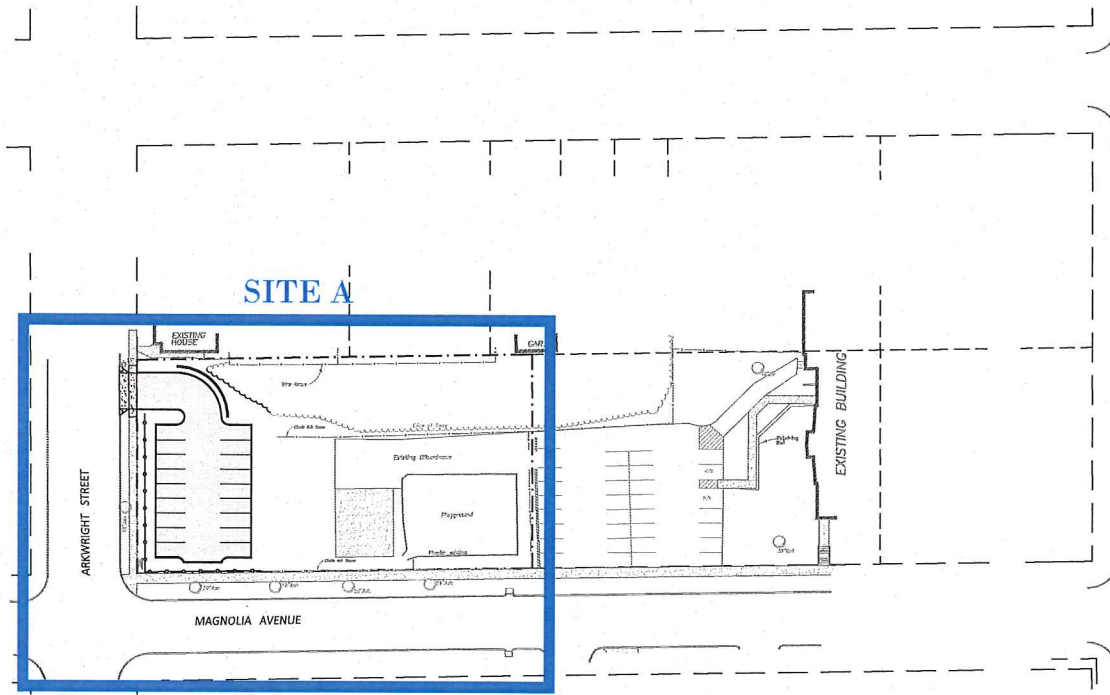

INDEX

TITLE SHEET	C0
SITE DEMOLITION PLAN	C1
SITE DIMENSION PLAN	C2
GRADING, DRAINAGE & EROSION CONTROL PLAN	C3
UTILITY PLAN	C4
DETAILS	C5

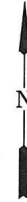

Rehder & Associates, Inc.
Civil Engineers, Planners and Land Surveyors
3940 Federal Drive, Suite 110 • Eden Prairie, Minnesota 55324
612-432-0651 • Fax: 612-432-8797 • email: info@rehder.com
PROJECT NO.: 191-1989-021 DRAWING FILE: 1989021.DWG

I hereby certify that the plan was prepared by me or under my direct supervision and that I am a duly Licensed Professional Engineer under the laws of the State of Minnesota.
[Signature]
Name: Barton G. Espel Reg. No. 24352

ISSUED
DATE: 08/19/2019
BY: [Signature]
FOR: [Signature]
PROJECT: 191-1989-021

TITLE SHEET
COMMUNITY OF PEACE ACADEMY
CITY OF ST. PAUL

SHEET NUMBER

C0