

1 | 2 | 3 | 4 | 5 | 6 | 7 | 8 | 9

A  
B  
C  
D  
E  
F  
G  
H

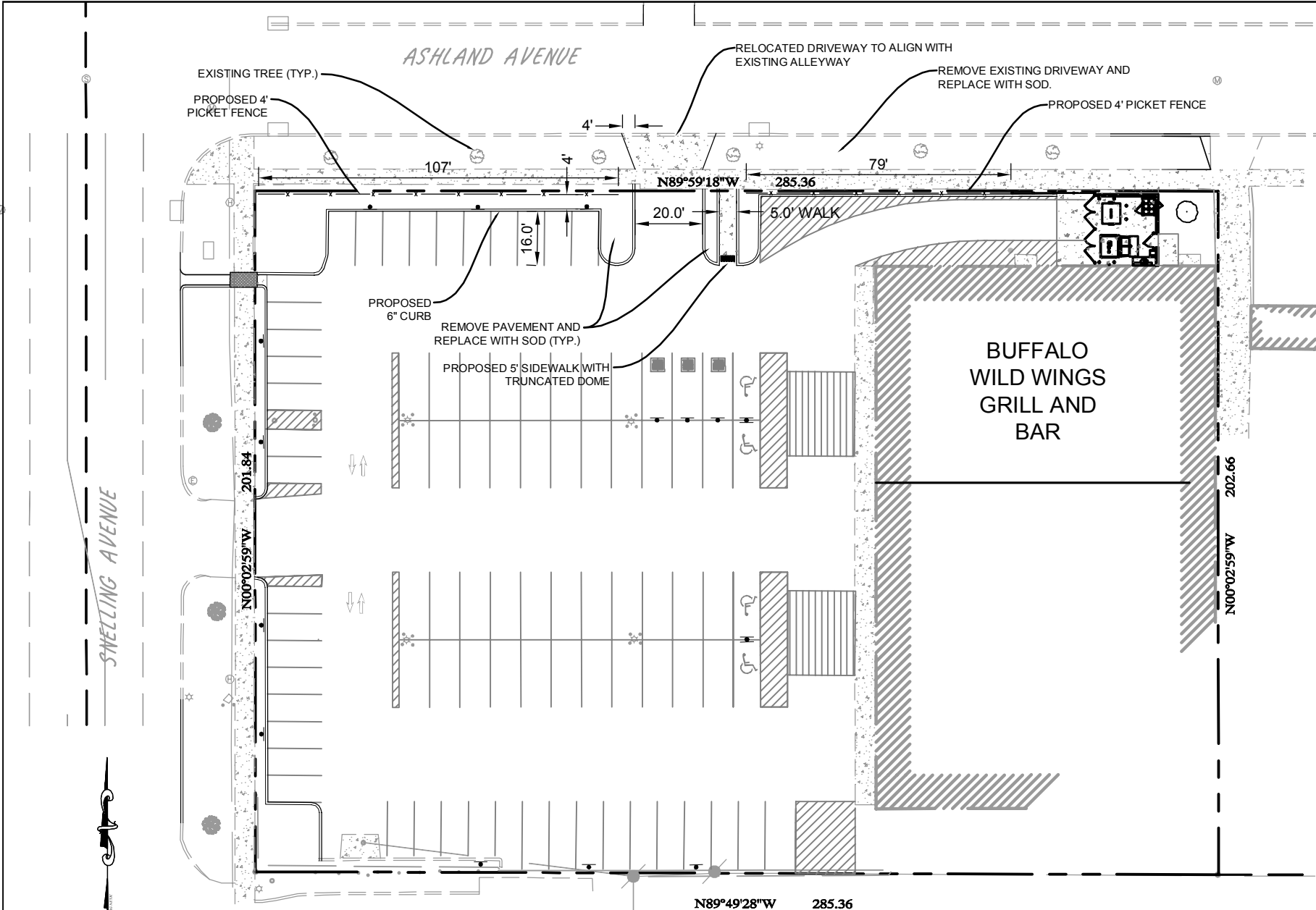

EXISTING TREE (TYP.)  
PROPOSED 4' PICKET FENCE

PROPOSED 6" CURB  
REMOVE PAVEMENT AND REPLACE WITH SOD (TYP.)

PROPOSED 5' SIDEWALK WITH TRUNCATED DOME

RELOCATED DRIVEWAY TO ALIGN WITH EXISTING ALLEYWAY

REMOVE EXISTING DRIVEWAY AND REPLACE WITH SOD.

PROPOSED 4' PICKET FENCE

**BUFFALO WILD WINGS GRILL AND BAR**

SNELLING AVENUE

ASHLAND AVENUE



| APPROVED PARKING DATA |                 |                |               |
|-----------------------|-----------------|----------------|---------------|
| STANDARD PARKING      | COMPACT PARKING | ACCES. PARKING | TOTAL PARKING |
| 45                    | 45              | 4              | 94            |

| PROPOSED PARKING DATA |                 |                |               |
|-----------------------|-----------------|----------------|---------------|
| STANDARD PARKING      | COMPACT PARKING | ACCES. PARKING | TOTAL PARKING |
| 45                    | 39              | 4              | 88            |

SHEET NUMBER  
**CON1**

DESIGN ENGINEER:  
MN P.E. LICENSE NUMBER:

**BUFFALO WILD WINGS**  
**ST. PAUL, MINNESOTA**  
**SNELLING AND ASHLAND**

DATE  
05/28/2013  
PROJECT NO.  
1161993000

**Kimley-Horn and Associates, Inc.**  
© 2013 KIMLEY-HORN AND ASSOCIATES, INC.  
2303 UNIVERSITY AVE W, STE 2308 ST. PAUL, MN 55114  
PHONE (651) 645-4197 FAX (651) 645-5116  
WWW.KIMLEY-HORN.COM

SCALE AS NOTED  
DESIGNED BY BMW  
DRAWN BY BMW  
CHECKED BY BRS

Plotting name: K:\TWC\_LDEV\RSP Architects\Buffalo Wild Wings\160693000 - St. Paul (Snelling and Ashland)\3 Design\CAD\Exhibits\Site Adjustment Exh2013-0528 Concept 1.dwg Layout1 May 28, 2013 1:02pm by: brian.wurdeman