

Roadway curb maintained by County, planter wall maintained by City

Plantings maintained by City = 

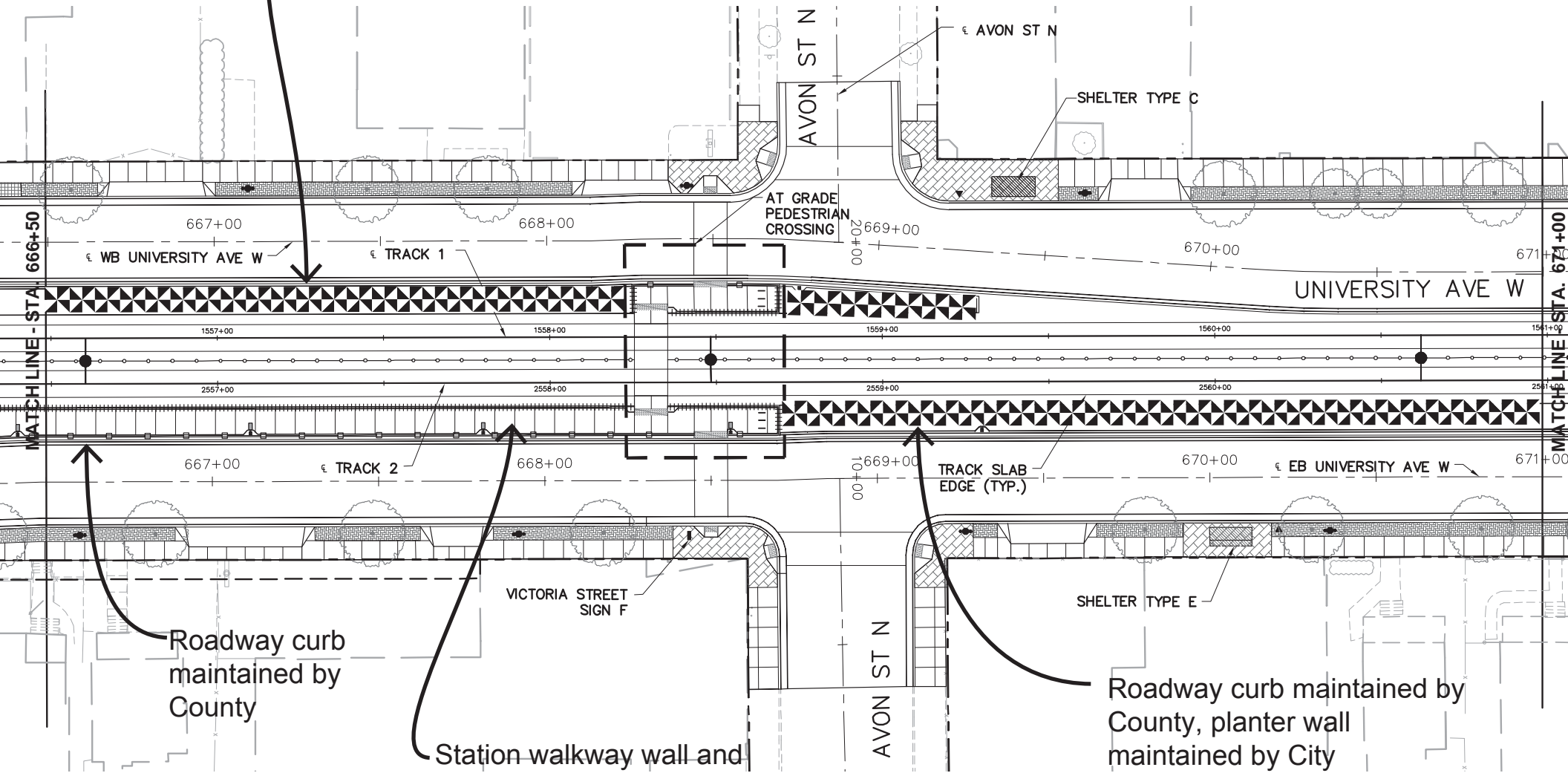

Roadway curb maintained by County

Station walkway wall and railing maintained by Council

Roadway curb maintained by County, planter wall maintained by City

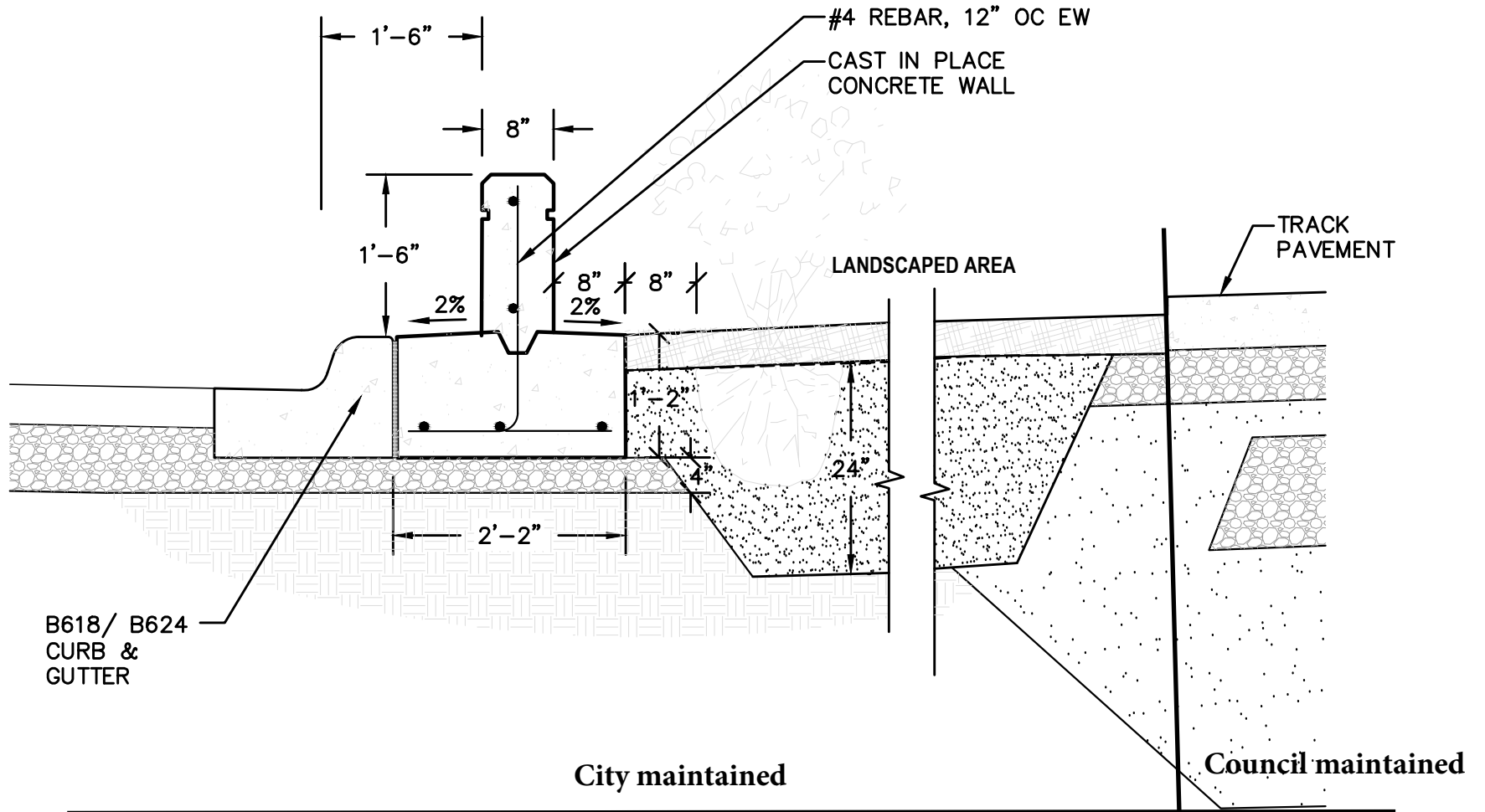

## MEDIAN PLANTER WALL

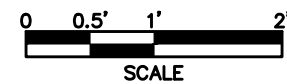

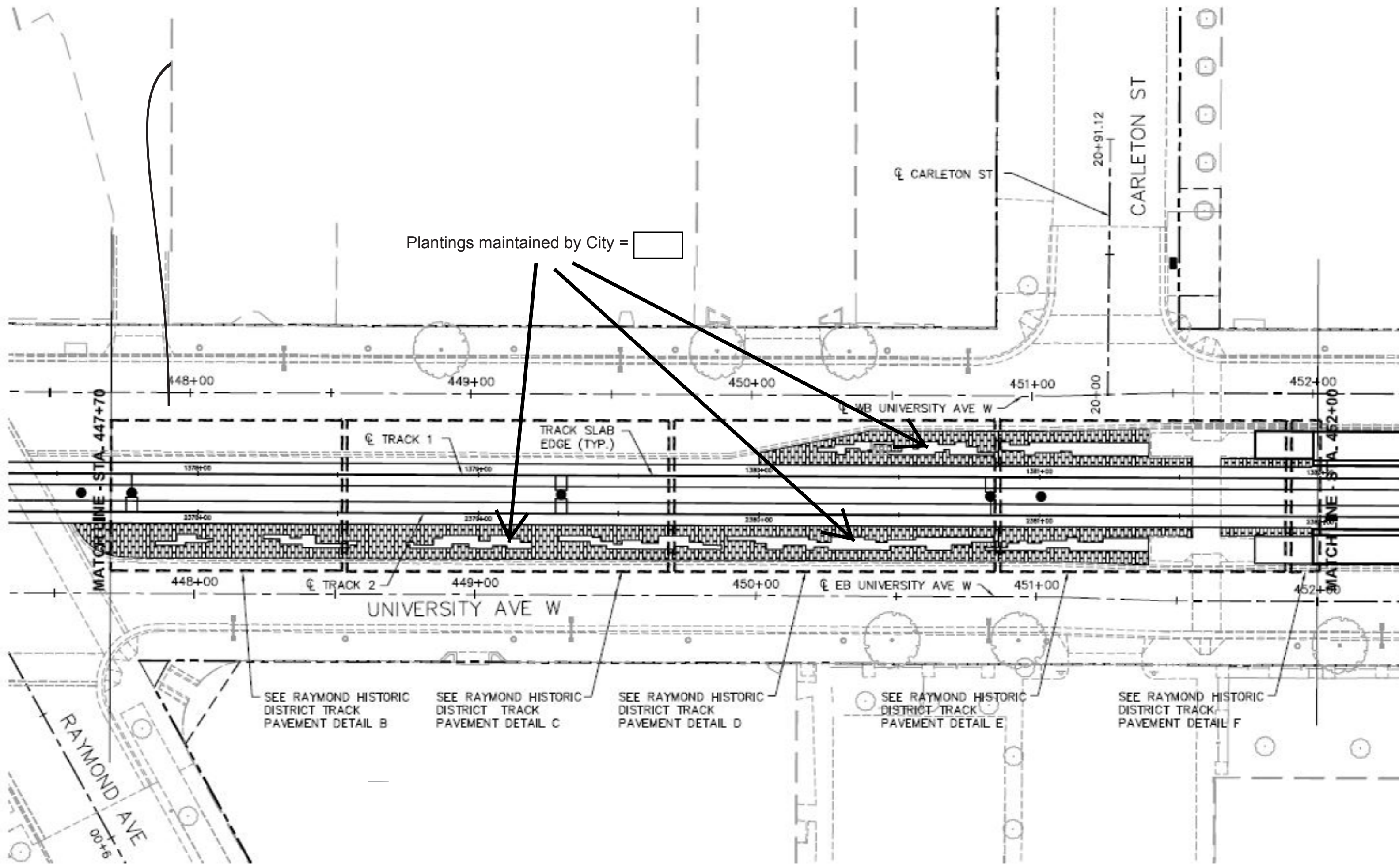

Plantings maintained by City = [ ]

SEE RAYMOND HISTORIC DISTRICT TRACK PAVEMENT DETAIL B

SEE RAYMOND HISTORIC DISTRICT TRACK PAVEMENT DETAIL C

SEE RAYMOND HISTORIC DISTRICT TRACK PAVEMENT DETAIL D

SEE RAYMOND HISTORIC DISTRICT TRACK PAVEMENT DETAIL E

SEE RAYMOND HISTORIC DISTRICT TRACK PAVEMENT DETAIL F

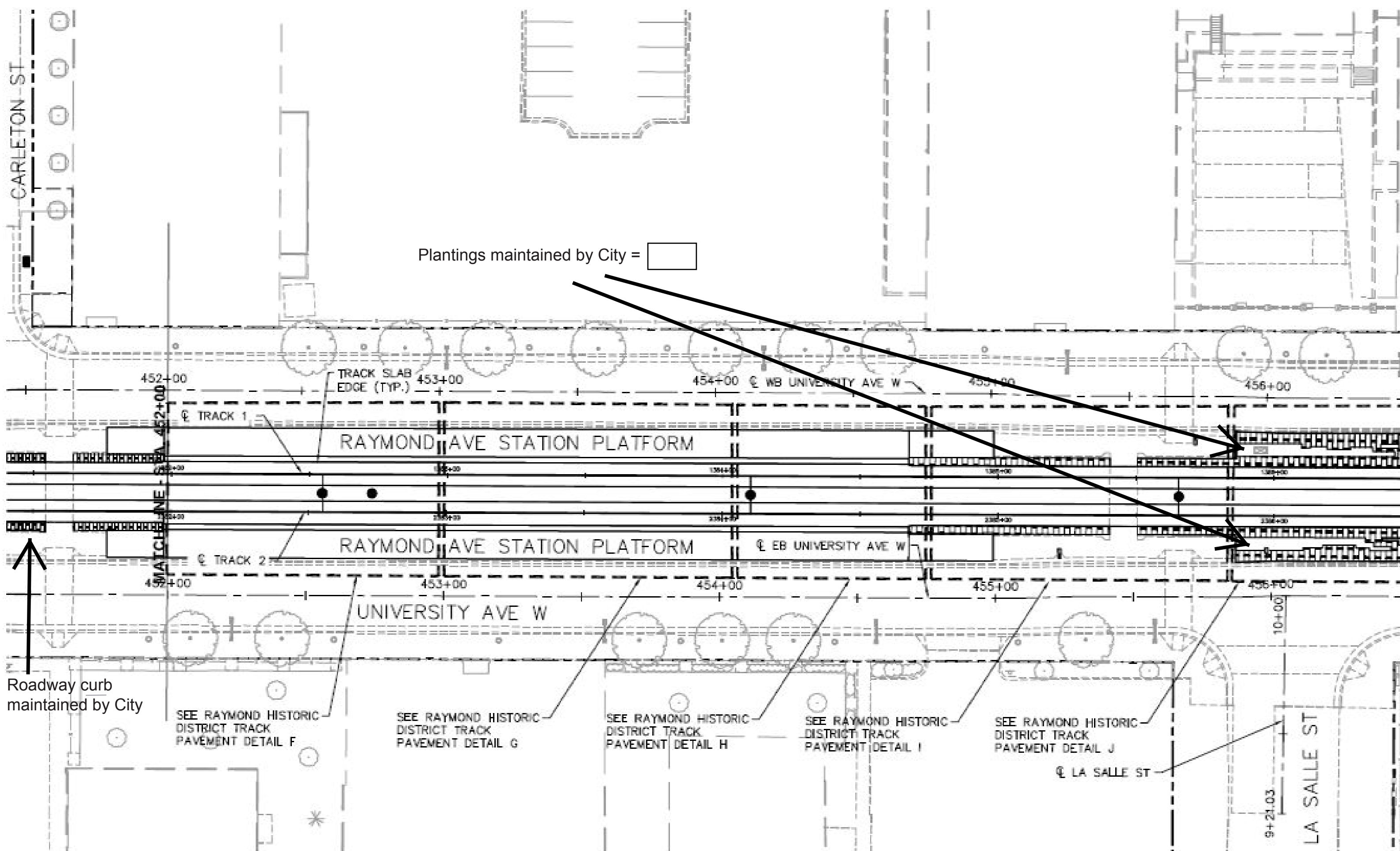

Plantings maintained by City =

Roadway curb maintained by City

SEE RAYMOND HISTORIC DISTRICT TRACK PAVEMENT DETAIL F

SEE RAYMOND HISTORIC DISTRICT TRACK PAVEMENT DETAIL G

SEE RAYMOND HISTORIC DISTRICT TRACK PAVEMENT DETAIL H

SEE RAYMOND HISTORIC DISTRICT TRACK PAVEMENT DETAIL I

SEE RAYMOND HISTORIC DISTRICT TRACK PAVEMENT DETAIL J

LA SALLE ST

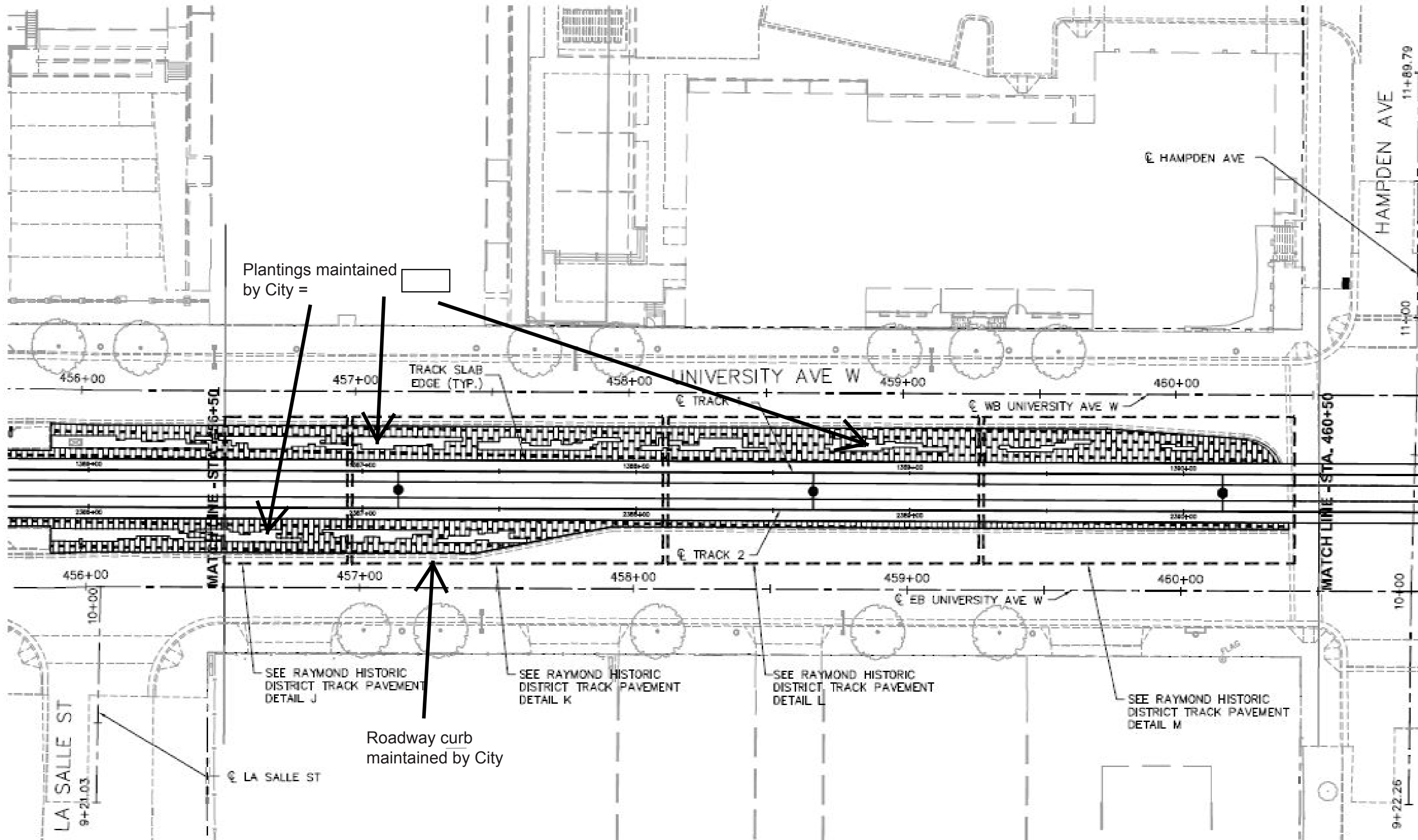

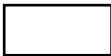
Plantings maintained by City = 

Roadway curb maintained by City

SEE RAYMOND HISTORIC DISTRICT TRACK PAVEMENT DETAIL J

SEE RAYMOND HISTORIC DISTRICT TRACK PAVEMENT DETAIL K

SEE RAYMOND HISTORIC DISTRICT TRACK PAVEMENT DETAIL L

SEE RAYMOND HISTORIC DISTRICT TRACK PAVEMENT DETAIL M

TRACK SLAB EDGE (TYP.)

UNIVERSITY AVE W

EB HAMPDEN AVE

HAMPDEN AVE

LA SALLE ST  
9+21.03

MATCH LINE - STA. 466+50

MATCH LINE - STA. 460+50

TRACK 1

TRACK 2

456+00

457+00

458+00

459+00

460+00

456+00

457+00

458+00

459+00

460+00

10+00

10+00

LA SALLE ST

9+22.26

11+89.79

11+00