

PROPERTY WITHIN 100 FEET OF PARCEL: 380 JACKSON ST

05/29/12

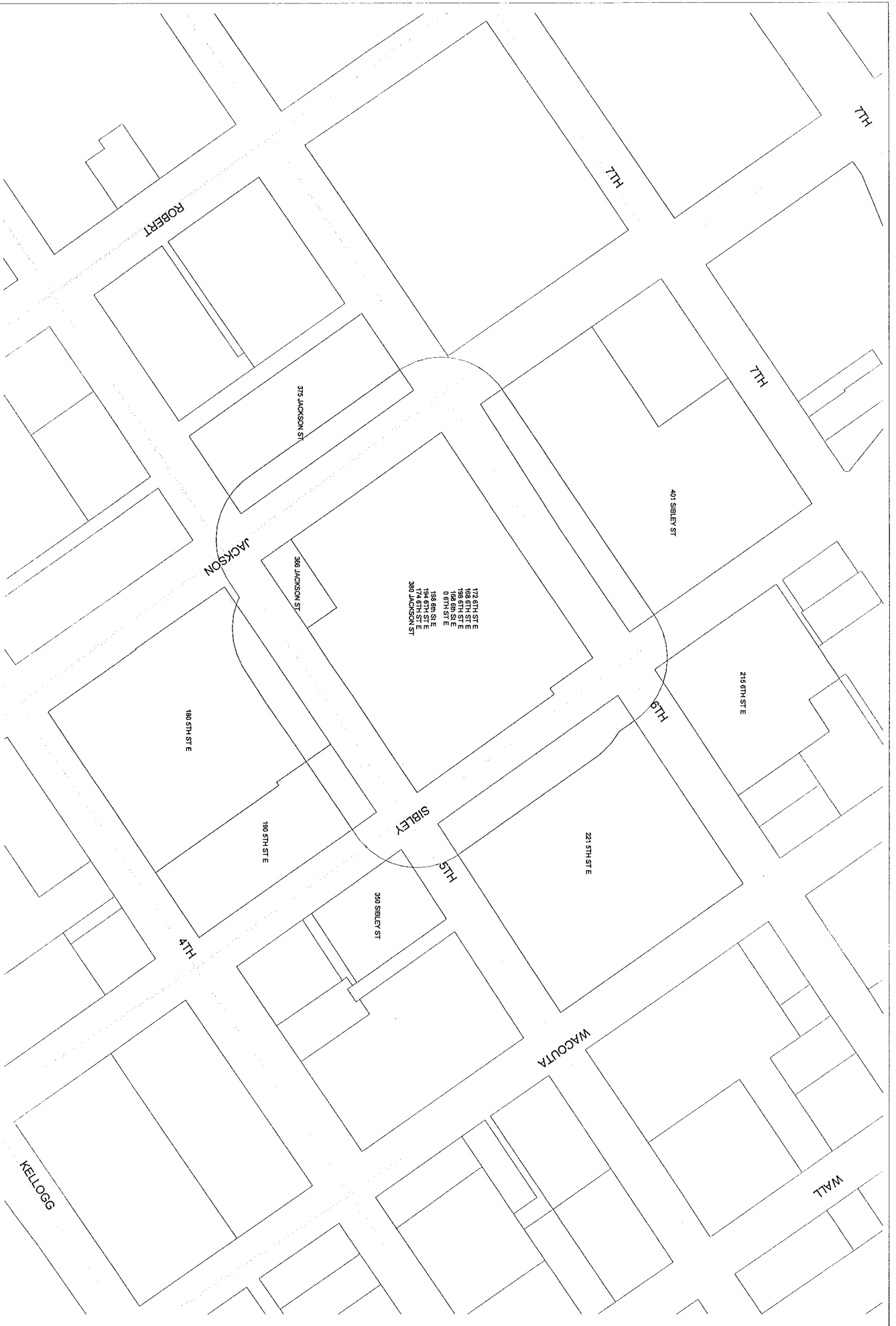

NA 3014 20 Llc/Corp / 4330 Llc / Corp / Fairfield Apartments Llc / Corp / Lakes Area Properties Llc / Corp Po Box 50176 Minneapolis MN 55405-0176	62822110050	NA 375 Jackson Courtly Llc 29 Deep Lake Rd S North Oaks MN 55127-6312	62822110005
NA 375 Jackson Willow Llc 29 Deep Lake Rd S St Paul MN 55127-6312	62822110005	NA Airye Condominium Assn/Co Gittleman Management Corp 1801 American Blvd E Ste 21 Bloomington MN 55425-1230	3.12922E+11
NA Alan G Rodgers 168 6th St E Unit 2802 St Paul MN 55101-1947	3.12922E+11	NA Alice M Yamane/Wende M O'brien Tr 168 6th St E #4401 St Paul MN 55101-1991	3.12922E+11
NA Allan J Brennan/Karen A Brennan 168 6th St E #3503 St Paul MN 55101-1991	3.12922E+11	NA Ammerman Family Trust 554 N 8th St River Falls WI 54022-1526	3.12922E+11
NA Andrew N Kloster/Lisa H Kloster 198 6th St E Unit 404 Saint Paul MN 55101-1948	3.12922E+11	NA Annabella Romer Tr 168 6th St E #2803 St Paul MN 55101-1991	3.12922E+11
NA Army Corps Centre Operating A/Bgk Properties Inc 330 Garfield St Sante Fe NM 87501-2640	62822110008	NA Barry P Peters 10685b Hazelhurst Dr Unit 5268 Houston TX 77043-3238	3.12922E+11
NA Beth Dinndorf 168 6th St E Unit 3803 St Paul MN 55101-1991	3.12922E+11	NA Bigos Sibley Tower Llc 8325 Wayzata Blvd Ste 200 Golden Valley MN 55426-1460	3.12922E+11
NA Bonita R Woods 168 6th St E Unit 3302 St Paul MN 55101-1970	3.12922E+11	NA Brenda Masak/Richard Masak 198 6th St #504 St Paul MN 55101-1948	3.12922E+11
NA Brian L Nowacki/Tammey A Nowacki 168 6th St E Unit 3005 St Paul MN 55101-1970	3.12922E+11	NA Charles L Droubie/Leah M Droubie 168 6th St E #3305 St Paul MN 55101-1991	3.12922E+11
NA Chris D Olson 168 6th St E #2706 St Paul MN 55101-1947	3.12922E+11	NA City Of St Paul Mears Park 24 4th St W Ste 1000 St Paul MN 55102-1692	3.12922E+11

NA Constance J Nardini 198 6th St E Unit 601 St Paul MN 55101-1948	3.12922E+11	NA Crystal K Meriwether Po Box 5000 Ogdensburg NY 13669-5000	3.12922E+11
NA Dale A Mcjunker/Donna M Mcjunker 168 6th St E Unit 3804 St Paul MN 55101-2909	3.12922E+11	NA Daniel E Hathaway 168 6th St E #4202 St Paul MN 55101-1991	3.12922E+11
NA Daniel E Mahai Trustee/Chris E Mahai Trustee 168 6th St Unit 4004 Saint Paul MN 55101-1991	3.12922E+11	NA David P Aro 168 6th St E Unit 3606 St Paul MN 55101-1971	3.12922E+11
NA Denise A Steiner 168 6th St E #2701 St Paul MN 55101-1991	3.12922E+11	NA Donald O Hedman 168 6th St E Unit 3204 St Paul MN 55101-1970	3.12922E+11
NA Donald S Peterson 168 6th St E Unit 2805 Saint Paul MN 55101-1991	3.12922E+11	NA Donna J Dunn/Nancy S Beckes 168 6th St E Unit 3403 St Paul MN 55101-1991	3.12922E+11
NA Dorris N Rehfeld 168 6th St E Unit 4204 St Paul MN 55101-1972	3.12922E+11	NA Duane J Bangle/Mary H Bangle 168 6th St E Unit 3301 St Paul MN 55101-1970	3.12922E+11
NA Edward P Starr/Ruth Ann Starr 168 6th St E #3903 St Paul MN 55101-1991	3.12922E+11	NA Elaine M Rogers 168 6th St E Unit 2905 St Paul MN 55101-1991	3.12922E+11
NA Elizabeth A Dinndorf 168 6th St Unit 3803 St Paul MN 55101-1991	3.12922E+11	NA Eugene L Hugoson/Patricia L Hugoson 168 6th St E Unit 3402 St Paul MN 55101-1971	3.12922E+11
NA Figen Haugen 168 6th St E #3601 St Paul MN 55101-1991	3.12922E+11	NA Firstar Bank Of Minnesota Na Po Box 64142 Saint Paul MN 55164-9366	3.12922E+11
NA Gary M Strauch/Jean L Strauch 168 6th St Unit 3603 St Paul MN 55101-1991	3.12922E+11	NA George F Kremer/Patricia A Kremer 168 6th St E Unit 3701 St Paul MN 55101-1971	3.12922E+11

NA George M Heriot 168 6th St E Unit 3104 St Paul MN 55101-1991	3.12922E+11	NA Gerald Hendrickson/Diane Hendrickson 168 6th St E Unit 3405 St Paul MN 55101-1971	3.12922E+11
NA J W Burnett 4840 Maryland Ave N Crystal MN 55428-4638	3.12922E+11	NA Jackson I Llc 510 1st Ave N #200 Minneapolis MN 55403-1641	62822110050
NA James D Meisenheimer/Carol E Gage 168 6th St #3904 St Paul MN 55101-1991	3.12922E+11	NA James E Kursu 168 6th St E Unit 3505 St Paul MN 55101-1971	3.12922E+11
NA James M Campbell 168 6th St E Unit 3004 St Paul MN 55101-1970	3.12922E+11	NA James R Daines Trustee/Jeanette R Daines Trustee E4581 330th Ave Menomonie WI 54751-6406	3.12922E+11
NA James R Pagliarini/C Elizabeth Raymond 168 6th St E Unit 3103 Saint Paul MN 55101-1991	3.12922E+11	NA James W Chamberlain 198 6th St 702 St Paul MN 55101-1948	3.12922E+11
NA James W Rustad 168 6th St #4303 St Paul MN 55101-1991	3.12922E+11	NA Janice Nelson 168 6th St E Unit 320 Saint Paul MN 55101-1991	3.12922E+11
NA Jeffrey T Fuqua 198 6th St E Unit 501 Saint Paul MN 55101-1948	3.12922E+11	NA Jerome W Johnson/Cheryl A Johnson 198 6th St E #701 St Paul MN 55101-1948	3.12922E+11
NA Joan E Lavine/Charles J Lavine 198 6th St E #704 St Paul MN 55101-1948	3.12922E+11	NA John C Shelerud 168 6th St Unit 3406 Saint Paul MN 55101-1991	3.12922E+11
NA John Patton/Michele Patton 168 6th St E #3703 St Paul MN 55101-1991	3.12922E+11	NA John Scheibel 168 6th St E #4005 St Paul MN 55101-1991	3.12922E+11
NA June Revocable Tr 11/15/05 Kim/June Kim Revocable T 11/15/05 168 6th St E Unit 3506 St Paul MN 55101-1971	3.12922E+11	NA Karen J Mccauley 198 6th St E #401 St Paul MN 55101-1948	3.12922E+11

NA Kathleen Bischel Beddow/Earl F Beddow 168 6th St E #3202 St Paul MN 55101-1991	3.12922E+11	NA Kathleen L Peterson 168 6th St E Unit 4103 Saint Paul MN 55101-1991	3.12922E+11
NA Kathryn E Bury/James S Bury Trustee 168 6th St E Unit 3901 St Paul MN 55101-1991	3.12922E+11	NA Kenneth M Hill/Mark S Swenby 168 6th St E Unit 2601 St Paul MN 55101-1991	3.12922E+11
NA Kim R Lareau/Robert W Lareau 168 6th St E Unit #3102 St Paul MN 55101-1970	3.12922E+11	NA Lang C Boomer 168 6th St 2604 St Paul MN 55101-1991	3.12922E+11
NA Larry J Braun/Marjorie A Reed Braun 647 Pond View Dr Mendota Heights MN 55120-1928	3.12922E+11	NA Laurel J Lapore 198 6th St E Unit 602 St Paul MN 55101-1948	3.12922E+11
NA Laurie A Platt 168 6th St E Unit 3105 St Paul MN 55101-1970	3.12922E+11	NA Lawrence T Nelsen Trustee 168 6th St E Unit 2703 Saint Paul MN 55101-1991	3.12922E+11
NA Lowertown Acquisitions Compan/David Brooks 2627 South Shore Blvd White Bear Lake MN 55110-3951	62822110051	NA Margaret G Hinke 168 6th St E Unit 3201 St Paul MN 55101-1970	3.12922E+11
NA Margaret M Snyder 168 6th St E Unit 3702 St Paul MN 55101-1971	3.12922E+11	NA Margaret Mary Anfang 168 6th St E Unit 4003 St Paul MN 55101-1991	3.12922E+11
NA Marilyn S Amundson/Peter A Amundson 168 6th St E #3704 St Paul MN 55101-1971	3.12922E+11	NA Mark G Bayuk 198 6th St E Unit 502 Saint Paul MN 55101-1948	3.12922E+11
NA Mark J Kleinschmidt 168 6th St E Unit 4402 St Paul MN 55101-1991	3.12922E+11	NA Marvin A Hanson/Gloria G Hanson 168 6th St E Unit 3801 St Paul MN 55101-1991	3.12922E+11
NA Mary L Barrett 198 6th St E Unit 703 St Paul MN 55101-1948	3.12922E+11	NA Mary R Anderson Trustee 2676 N Carriage Ln Chandler AZ 85224-1726	3.12922E+11

NA Michael D Mariana 168 6th St E Unit 3001 St Paul MN 55101-1991	3.12922E+11	NA Michael J Skwira/Karen A Skwira 168 6th St E St Paul MN 55101-1972	3.12922E+11
NA Michael L Denesen/Claudette E Denesen 168 6th St E St Paul MN 55101-1947	3.12922E+11	NA Mitchell J Matthiesen 168 6th St E Unit 2602 St Paul MN 55101-1947	3.12922E+11
NA Nancy J Marren 168 6th St E Unit 3905 St Paul MN 55101-1972	3.12922E+11	NA Nancy Jean Pajunen Trustee 168 E 6th St 4002 St Paul MN 55101-1991	3.12922E+11
NA Nardini, Constance J	3.12922E+11	NA Nea Galtier Llc 380 Jackson St Ste 418 Saint Paul MN 55101-3800	3.12922E+11
NA Nea Galtier Parking Llc 380 Jackson St Ste 418 Saint Paul MN 55101-3899	3.12922E+11	NA Nilsson, Karl H	3.12922E+11
NA Park Square Court Building/James Crockarell 325 Cedar St #800 St Paul MN 55101-1012	3.12922E+11	NA Patricia A Erlandson 168 6th St E Unit 4001 Saint Paul MN 55101-1991	3.12922E+11
NA Patricia A Stefanson 168 6th St E Unit 4403 St Paul MN 55101-1991	3.12922E+11	NA Patricia Louise Evens 198 6th St E Unit 402 Saint Paul MN 55101-2990	3.12922E+11
NA Patrick J Curran/Patricia J Curran 168 6th St E Unit 3504 St Paul MN 55101-1991	3.12922E+11	NA Paul E Mattke 168 6th St E #2603 St Paul MN 55101-1991	3.12922E+11
NA Paul Woutat/Mary Woutat 168 6th St E St Paul MN 55101-1991	3.12922E+11	NA Randal W Eckart/Elizabeth A Keenan 168 6th St E Unit 4105 St Paul MN 55101-1972	3.12922E+11
NA Raymond E Andrews/Dorothy J Andrews 168 6th St E Unit 4502 St Paul MN 55101-1972	3.12922E+11	NA Richard Bents/Lludmila Bents 168 6th St E Unit 4302 St Paul MN 55101-1991	3.12922E+11

NA Richard H Bents 168 6th St E Unit 4302 St Paul MN 55101-1991	3.12922E+11	NA Richard M Kelly/Jean L Kelly 168 6th St E Unit 3404 St Paul MN 55101-1991	3.12922E+11
NA Robert E Goff 168 6th St E Unit 4301 St Paul MN 55101-1991	3.12922E+11	NA Robert G Keller/Lynn Keller 168 6th St E #3604 St Paul MN 55101-1991	3.12922E+11
NA Robert Riesett/Karen L Riesett 168 6th St E Ste 3902 St Paul MN 55101-1991	3.12922E+11	NA Rodney Skoe/Sarah Hoagberg 54000 189th Ave Clearbrook MN 56634-4270	3.12922E+11
NA Rosalie M Wosepka 2712 Le Homme Dieu Hts Ne Alexandria MN 56308-7983	3.12922E+11	NA Rudolph Stadelman/Eva Stadelman 168 6th St E St Paul MN 55101-1971	3.12922E+11
NA Sam 1 Llc 3475 Willow Lake Blvd Suite 10 White Bear Lake MN 55110-5160	3.12922E+11	NA Sandra L Hupp 555 Sterling St S Maplewood MN 55119-5579	3.12922E+11
NA Segundo M Velasquez/Joan E Velasquez 774 Sibley Memorial Hwy Mendota Heights MN 55118-1707	3.12922E+11	NA Shailen A Gupta/Rina Nath 3899 Nobel Dr Apt 1225 San Diego CA 92122-5764	3.12922E+11
NA Shawn Torkelson 168 6th St E #3205 St Paul MN 55101-1991	3.12922E+11	NA Sherman L Bartz/Anne L Bartz 168 6th St E St Paul MN 55101-1972	3.12922E+11
NA Sherri A Buss/Jefferson Clowes 168 6th St E Unit 3401 St Paul MN 55101-1971	3.12922E+11	NA St Paul Housing Group Llc/Co Bigos Management Inc 8325 Wayzata Blvd Ste 200 Golden Valley MN 55426-1460	3.12922E+11
NA Steven P Adamski/Melissa D Adamski 168 6th St E Unit 2606 St Paul MN 55101-1947	3.12922E+11	NA Steven T Tredinnick/Elizabeth H Tredinnick 168 6th St E St Paul MN 55101-1991	3.12922E+11
NA Strauss Apartments Lp 1525 S 4th St Ste 201 Minneapolis MN 55454-1134	3.12922E+11	NA Sue E Babcock/Dale W Raduez 168 6th St E #3006 St Paul MN 55101-1991	3.12922E+11

NA Thomas J Doyle/Sharon L Elmore 833 Lincoln Ave St Paul MN 55105-3350	3.12922E+11	NA Thomas R Broman/Mary E Broman 168 6th St E Unit 2902 Saint Paul MN 55101-1991	3.12922E+11
NA Timothy E Mardell 168 6th St E Unit 4203 St Paul MN 55101-1972	3.12922E+11	NA Valeria S Silva/Paul H Stine 168 6th St E Unit 3101 Saint Paul MN 55101-1991	3.12922E+11
NA Vladimir Savcenko 168 6th St E #4501 St Paul MN 55101-2908	3.12922E+11	NA Wayne C Stumme/Carolann D Stumme 198 6th St E Apt 604 St Paul MN 55101-1948	3.12922E+11
NA William A Conklin 168 6th St E #3003 St Paul MN 55101-1991	3.12922E+11	NA William C Whalen Sr/Argene A Whalen 168 6th St E Unit 2806 Saint Paul MN 55101-1991	3.12922E+11
NA Ymca Of Greater Saint Paul 2125 E Hennepin Ave Minneapolis MN 55413-1768	3.12922E+11	NA Yvonne M Klappa 198 6th St E Unit 403 St Paul MN 55101-1948	3.12922E+11
NA Zeinab A Ammar 312 Spring St #411 St Paul MN 55102-4436	3.12922E+11	NA Zhenqing Zhu/Qi Lin Zhu 168 6th St Unit 2804 St Paul MN 55101-1991	3.12922E+11
NA Zoe W Sealy 168 6th St E Unit 2901 Saint Paul MN 55101-1991	3.12922E+11		