

Vang, Mai (CI-StPaul)

From: Shaff, Leanna (CI-StPaul)
Sent: Wednesday, April 16, 2014 9:34 AM
To: Moermond, Marcia (CI-StPaul); Vang, Mai (CI-StPaul)
Cc: Neis, Adrian (CI-StPaul)
Subject: FW: 1088 conway
Attachments: 20140303083014832.pdf

This is the attachment in AMANDA. Looks like the ceiling height is 7'9", but only 2 feet wide for the length of the room. Anyway, maybe this will be more informative.



Leanna Shaff

Fire Inspection Supervisor

Department of Safety and Inspections
375 Jackson Street, Suite 220
Saint Paul, MN 55101-1806
P: 651.266.8980
leanna.shaff@ci.stpaul.mn.us

The Most Livable
City in America



Making Saint Paul the Most Livable City in America

From: Niemeyer, George (CI-StPaul)
Sent: Wednesday, April 16, 2014 9:29 AM
To: Shaff, Leanna (CI-StPaul)
Subject: 1088 conway

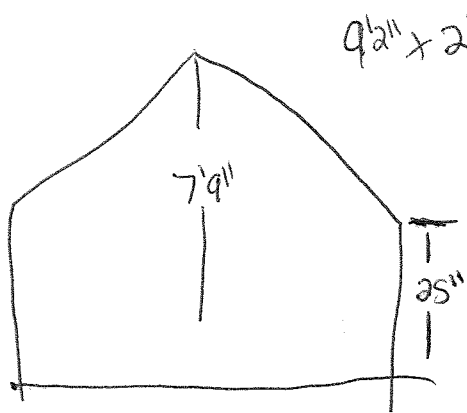

9'2" x 2' over 7' West room

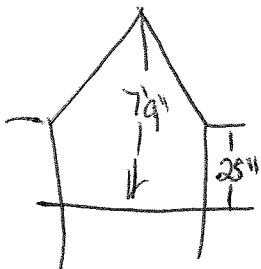
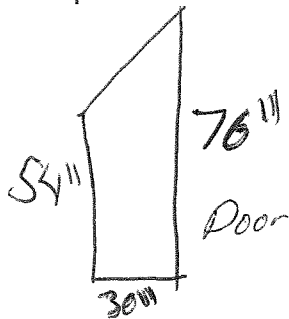
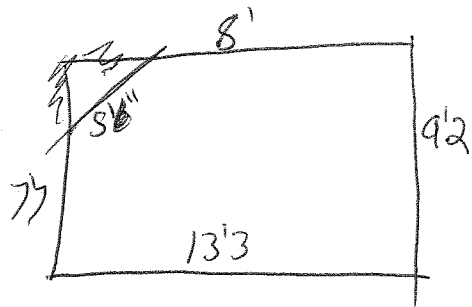

2' x 10'3" over 7'

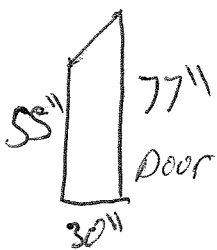
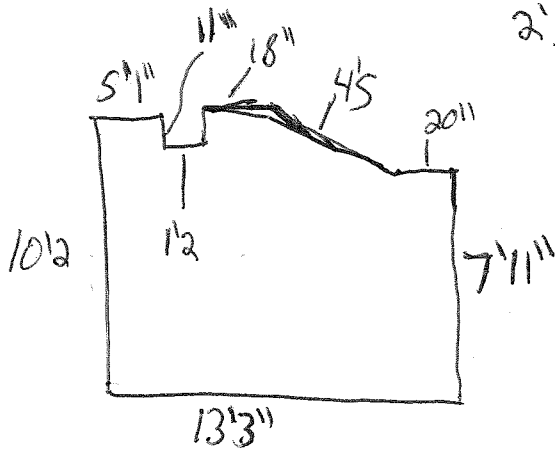

East room