

**Appendix C— Listing Activity and Plans for 210 Victoria
Street S. Since 2014**

62

210 Victoria Street S. Listing and Price History (Most Recent Owner)

October 30, 2014: Sold to Chris Carlson for \$245,000

February, 2015: Listed for sale for \$899,000 as a teardown

June, 2015: Relisted for sale for \$679,000 as a teardown

January, 2016: Delisted, with no further listing activity

63

210 Victoria Street S. Internet Listings

Sold on October 30, 2014:

[CORPORATE REAL ESTATE SERVICES](#) [BURNET](#) [Search for Homes](#) [Agents & Offices](#) [Local Information](#) [Buying & Selling Your Home](#) [About Us](#) [Contact Us](#) [Sign In](#)

[Home](#) / [Minnesota Real Estate Sales](#) / [Saint Paul Home Sales](#) / [Summer Home Sales](#) / [Recently Viewed Properties](#)

210 Victoria Street S, Saint Paul, MN 55105

\$245,000

[Save](#) [Hide](#) [Print](#) [Share](#)

Sold Closed Single Family 3 Beds 2 Full Baths

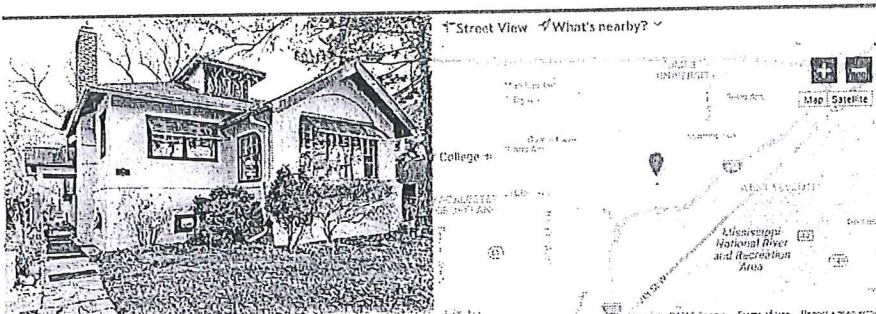

What's Your Home Worth?

For a complimentary comparative market analysis, please contact us so we can discuss your home's value.

Your Property Information

ADDRESS optional
 CITY STATE
 Select via

Last listing prior to being de-listed in January, 2016:

[Movoto](#) [Find Neighborhoods by ZIP or Address](#) [Buy](#) [Sell](#) [Find an Agent](#) [Local Info](#) [Learn](#) [Login](#)

[Market](#) [Photo](#)

De-listed \$679,000

Movoto Saint Paul Agent
[Email](#)
 Name
 Phone number

I am interested in 210 Victoria Street S Saint Paul, MN 55105

210 Victoria St S
 Saint Paul, MN 55105
 3 Bd 3 Ba 3,374 Sqft

To be built. New construction in high demand neighborhood, one and a half story home that features 3 Bedrooms, 2 and a half bath, 2731 sq ft 2 car garage. Customized finishes for buyer

[Register or Login to see all pictures & details. Why is this required?](#)

[Tour Nearby Homes](#)

Not a Five Valued

Moving Your Estate • Address: 210 Victoria St S, Saint Paul, MN 55105 • 210 Victoria St S

64

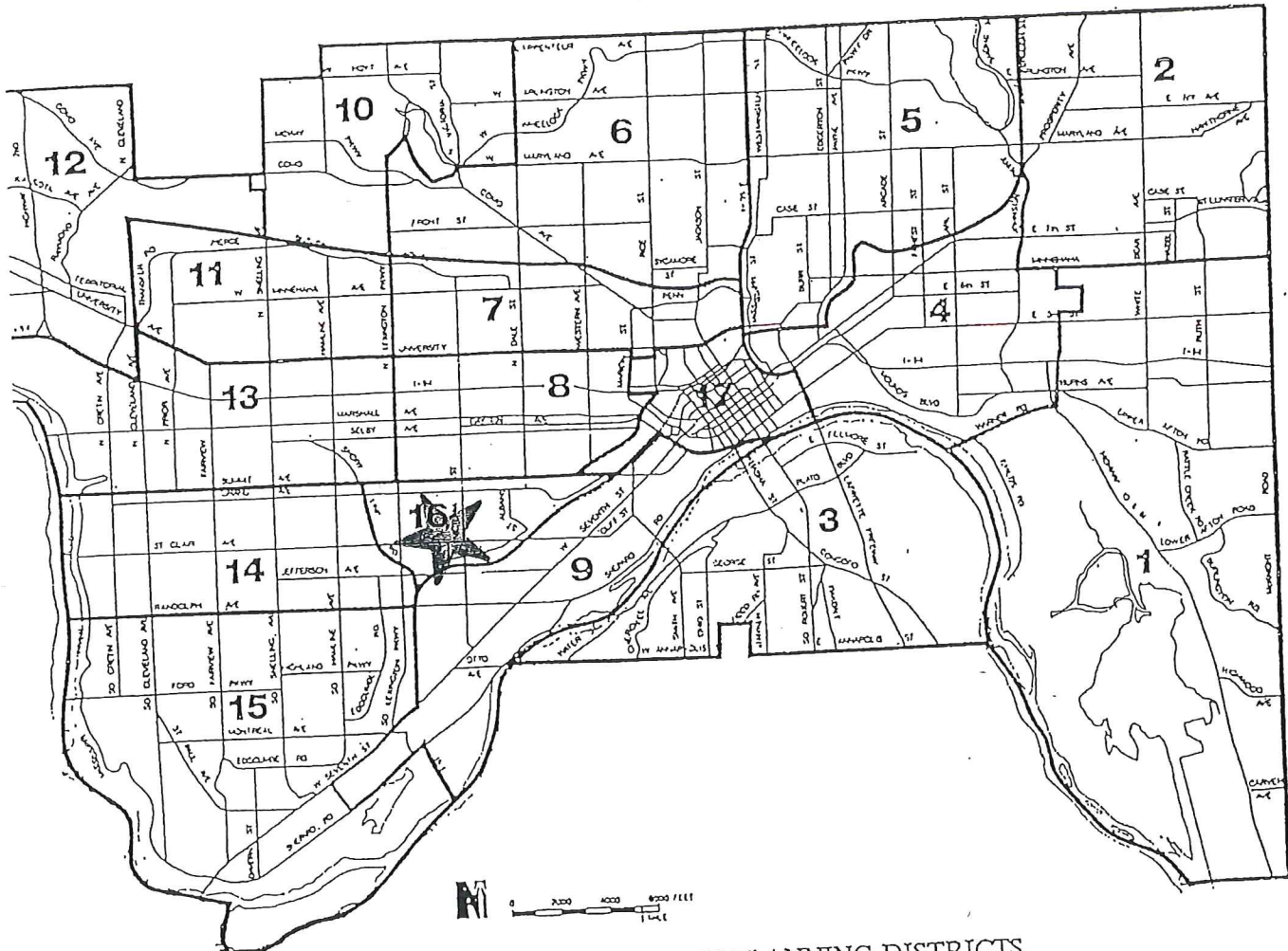

CITIZEN PARTICIPATION PLANNING DISTRICTS

- 1. SUNRAY-BATTLECREEK-HIGHWOOD
- 2. HAZEL PARK HADEN-PROSPERITY HILLCREST
- 3. WEST SIDE
- 4. DAYTON'S BLUFF
- 5. PAYNE-PHALEN
- 6. NORTH END
- 7. THOMAS-DALE
- 8. SUMMIT-UNIVERSITY
- 9. WEST SEVENTH
- 10. COMO
- 11. HAMLINE-MIDWAY
- 12. ST. ANTHONY PARK
- 13. MERRIAM PARK-LEXINGTON HAMLINE-SNELLING HAMLINE
- 14. MACALESTER GROVELAND
- 15. HIGHLAND
- 16. SUMMIT HILL
- 17. DOWNTOWN

ZONING FILE 16-058084

63

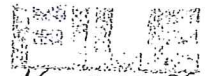

16-058082

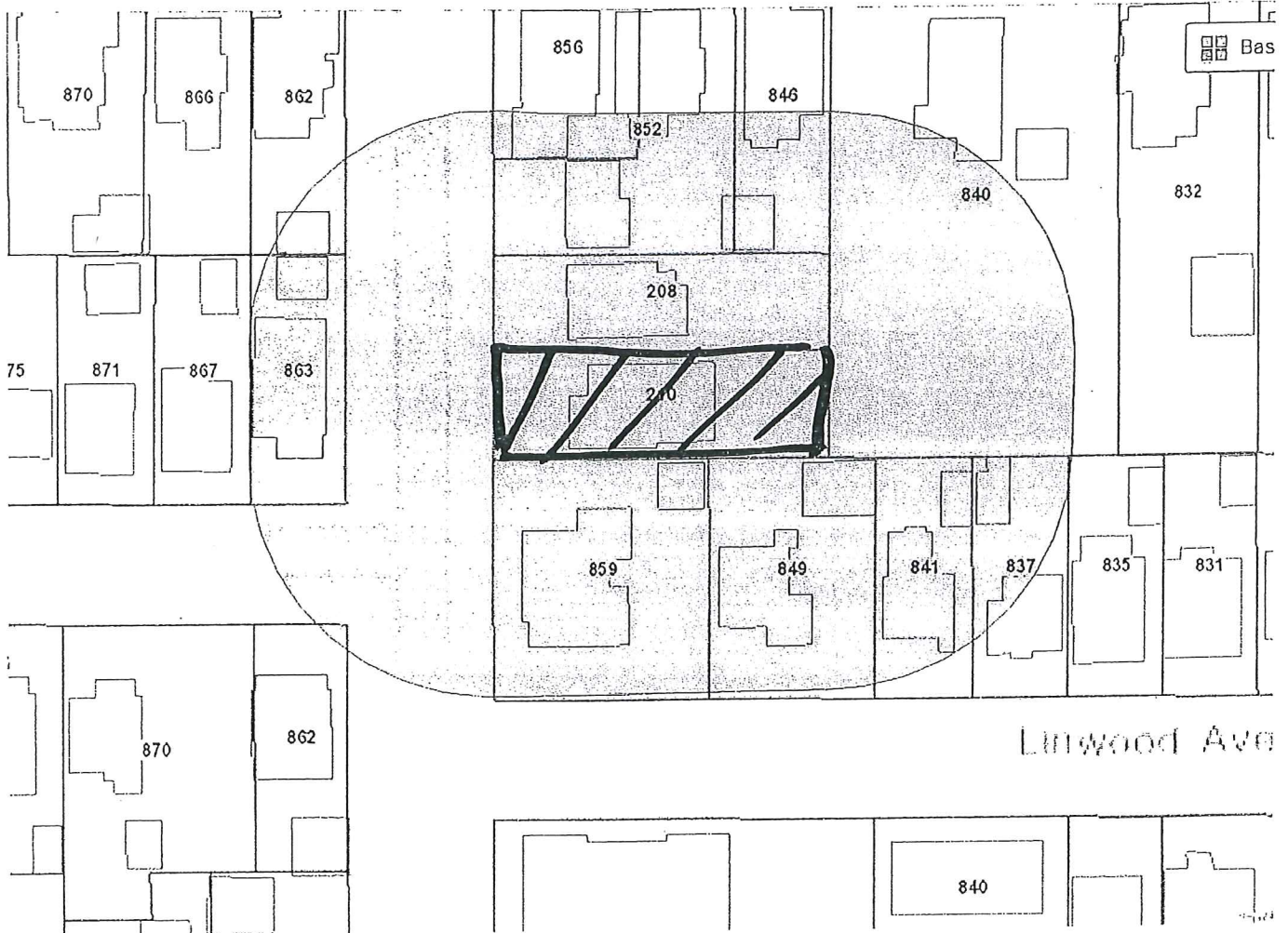

66