

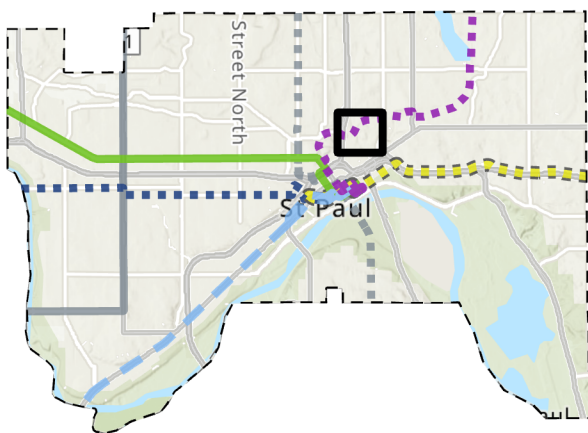

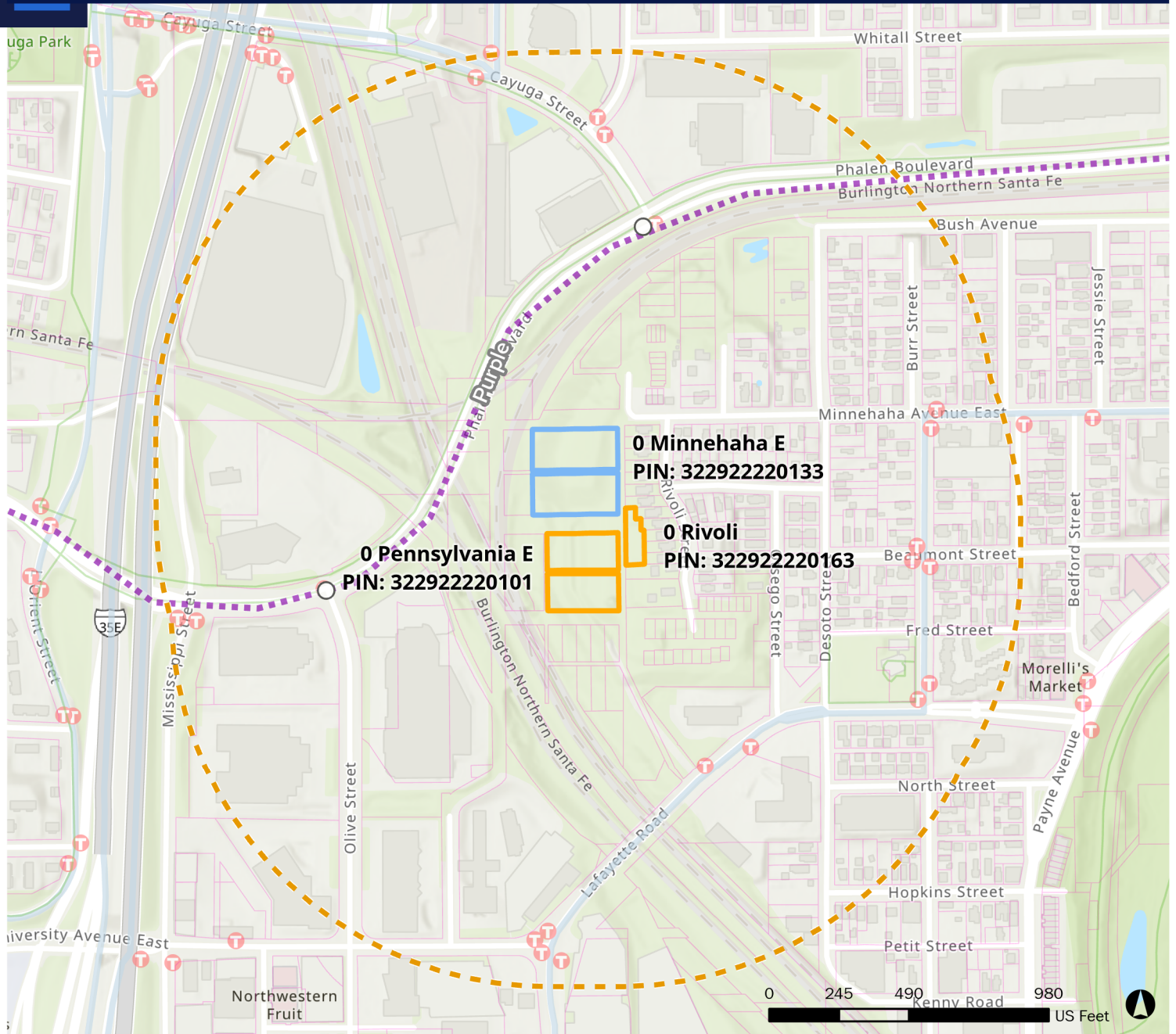







Temporary Use - HRA Parcels on Rivoli Bluff

Saint Paul Housing & Redevelopment Authority

March 10, 2023



-  Subject Properties
-  Quarter-Mile Distance
-  Bus stops
-  Bus routes
-  Purple Line
-  Transitway
-  Stations
-  Trails

Date: 3/10/2023 12:24 PM Document Path: C:\Users\wadem\City of Saint Paul\FED-Research & Mapping\Documents\Projects\HRA Board Reports\Online\2023\2023.03.10 - Temp Use - Rivoli Bluff\GIS\HRA Board Report Map - Temp Use - Rivoli Bluff.aprx