

	A	B	C	D
1	BRENDON HORTON KATHERINE PFALZ	1824 DAYTON AVE	SAINT PAUL MN 55104-6012	42823210072
2	MALLARY WEST STEVEN WEST	175 FAIRVIEW AVE N	SAINT PAUL MN 55104-6003	42823210083
3	DOUGLAS WEBER	1821 SELBY AVE	SAINT PAUL MN 55104-6025	42823210082
4	JOHN P SZAYNOWSKI	1800 DAYTON AVE	ST PAUL MN 55104-6001	42823120140
5	JOSEPH G BEATTY COLLEEN R BEATTY	1802 DAYTON AVE	SAINT PAUL MN 55104-6001	42823120141
6	ERIK B BUOEN KARIN G EGGE	1808 DAYTON AVE	SAINT PAUL MN 55104-6001	42823120142
7	MICHAEL L DOUGLAS	1812 DAYTON AVE	SAINT PAUL MN 55104-6001	42823120143
8	KEITH P COLLINS AMY C COLLINS	7420 COVENTRY WAY	EDINA MN 55439-2608	42823120144
9	POYNTON INVESTMENT CO LLC	101 1ST ST N	CANNON FALLS MN 55009-2003	42823120210
10	POYNTON INVESTMENT CO LLC	101 1ST ST N	CANNON FALLS MN 55009-2003	42823120145
11	JEFF ARMSTRONG	1803 SELBY AVE	ST PAUL MN 55104-6031	42823120146
12	THEODORE L ZINNER CATHERINE A ZINNER	1570 DELAWARE AVE	WEST ST PAUL MN 55118-3850	42823120147
13	F W THORNE	3 GRIGGS ST N	ST PAUL MN 55104-6913	42823120167
14	GRAND AVE APTS L.P	PO BOX 4751	ST PAUL MN 55104-0751	42823120166
15	JENNIFER TROOIJEN PATRICK WILZ	1802 SELBY AVE	SAINT PAUL MN 55104-6030	42823120165

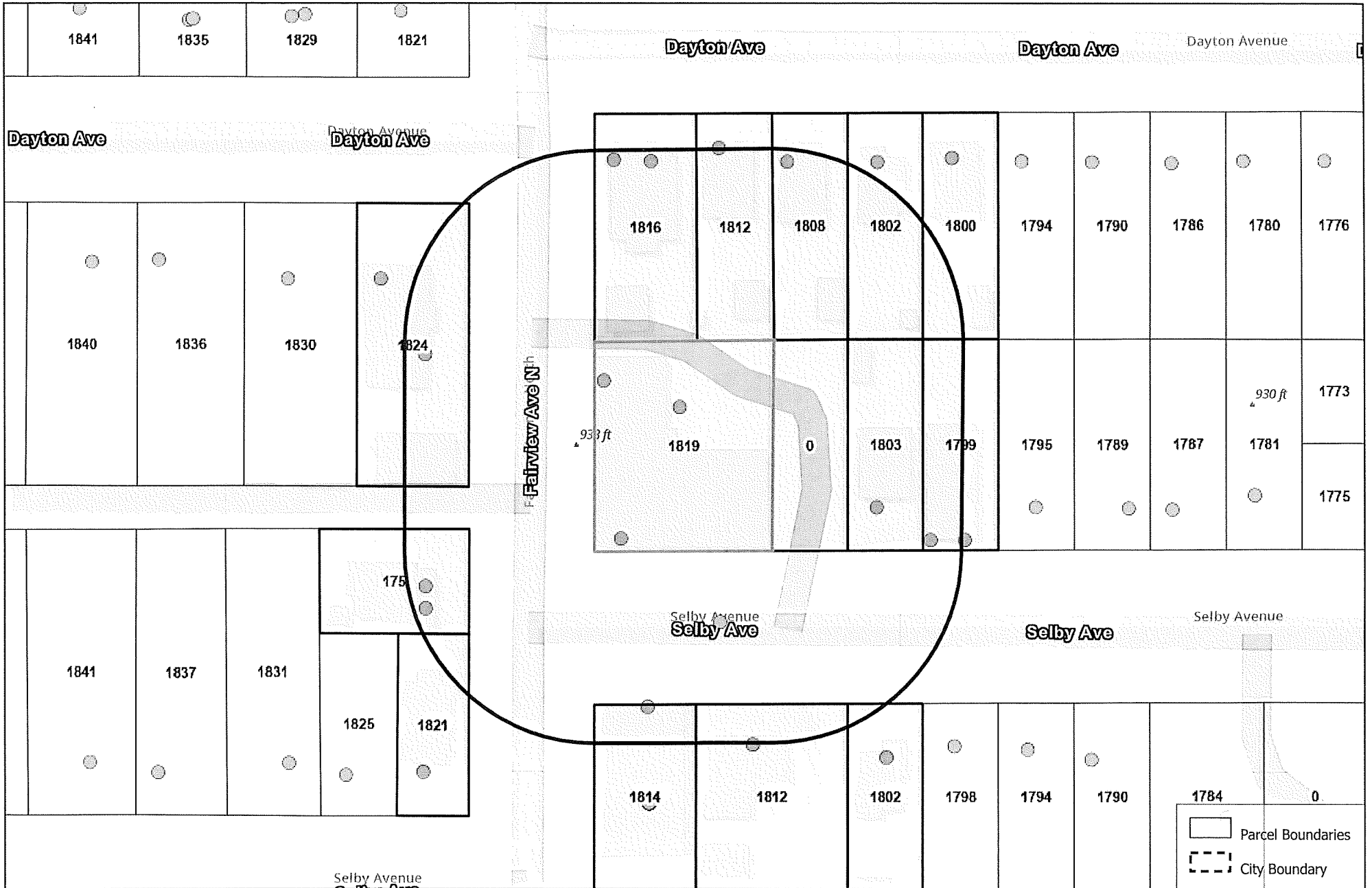

Esri Community Maps Contributors, County of Ramsey, Metropolitan Council, MetroGIS, © OpenStreetMap, Microsoft, Esri, TomTom, Garmin, SafeGraph, GeoTechnologies, Inc, METI/NASA, USGS, EPA, NPS, US

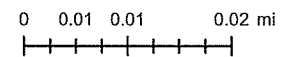

The Geographic Information System (GIS) Data to which this notice is attached are made available pursuant to the Minnesota Government Data Practices Act (Minnesota Statutes Chapter 13). The GIS Data are provided to you "AS IS" and without any warranty as to their performance, merchantability, or fitness for any particular purpose. The GIS Data were developed by the City of Saint Paul for its own internal business purposes. The City of Saint Paul does not represent or warrant that the GIS Data or the data documentation are error-free, complete, current, or accurate. You are responsible for any consequences resulting from your use of the GIS Data or your reliance on the GIS Data. You should consult the data documentation for this particular GIS Data to determine the limitations of the GIS Data and the precision with which the GIS Data may depict distance, direction, location, or other geographic features. If you transmit or provide the GIS Data (or any portion of it) to another user, the GIS Data must include a copy of this disclaimer.