

	A	B	C	D
1	BOBETTE K GODDING	859 HAGUE AVE	ST PAUL MN 55104-6612	22823120156
2	TOBASI PROPERTIES LLC	809 SELBY AVE	SAINT PAUL MN 55104-6621	22823120074
3	169 VICTORIA LLC	1564 SELBY AVE UNIT 9	SAINT PAUL MN 55104-6624	22823210051
4	BRUZER PROPERTIES 2 LLC	1268 AMBLE RD	ARDEN HILLS MN 55112-5703	22823210073
5	LAUREL H LEIN ERIC M LEIN	361 SUMMIT AVE	ST PAUL MN 55102-2168	22823210072
6	MONROE WALKER JR ANN C WALKER	863 HAGUE AVE	ST PAUL MN 55104-6515	22823210074
7	JAMES A LOGAN LORA ETTA LOGAN	1331 DAYTON AVE	ST PAUL MN 55104-6441	22823210052
8	169 VICTORIA LLC	1564 SELBY AVE UNIT 9	SAINT PAUL MN 55104-6624	22823210048
9	D I V I N E INSTITUTE INC	838 STELLAR PL	SAINT PAUL MN 55117-5446	22823210050
10	SELBY 874 LLC	PO BOX 681	CIRCLE PINES MN 55014-0681	22823210053
11	CHRISTOPHER R HERTEL RACHEL A HERTEL	885 HAGUE AVE	ST PAUL MN 55104-6515	22823210071
12	169 VICTORIA LLC	1564 SELBY AVE UNIT 9	SAINT PAUL MN 55104-6624	22823210049
13	RONDO DEVELOPMENT ON SELBY LLC	626 SELBY AVE	SAINT PAUL MN 55104-7523	22823120291
14	CHDC RONDO LIMITED PARTNERSHIP	614 N FIRST ST STE 100	MINNEAPOLIS MN 55401-3101	22823120292

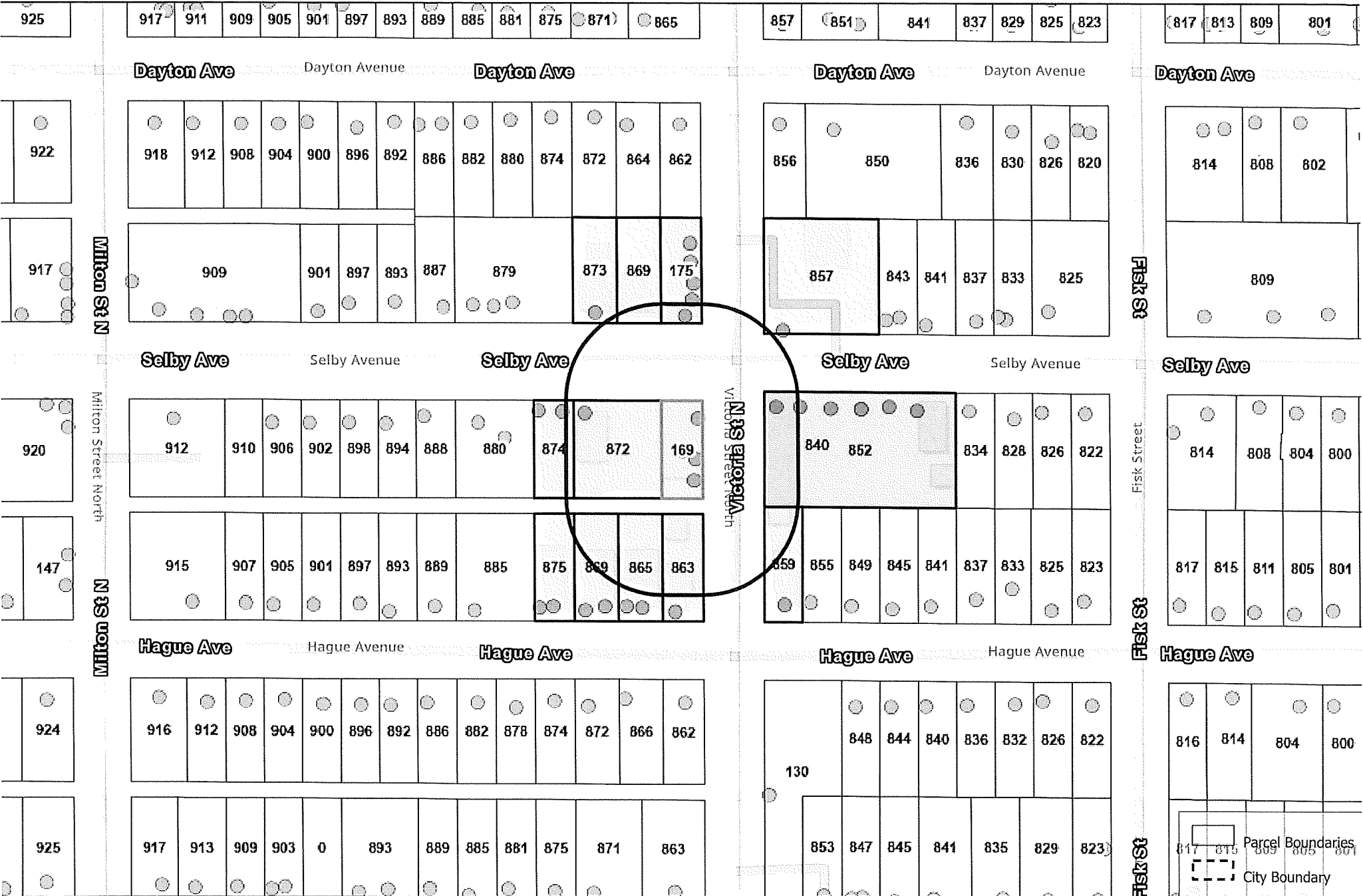

**Saint Paul Minnesota**  
*The most livable city in America*

Sources: Esri, Airbus DS, USGS, NGA, NASA, CGIAR, N Robinson, NCEAS, NLS, OS, NMA, Geodatastyrelsen, Rijkswaterstaat, GSA, Geoland, FEMA, Intermap and the GIS user community, Esri Community Maps

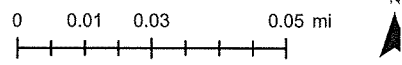

The Geographic Information System (GIS) Data to which this notice is attached are made available pursuant to the Minnesota Government Data Practices Act (Minnesota Statutes Chapter 13). The GIS Data are provided to you "AS IS" and without any warranty as to their performance, merchantability, or fitness for any particular purpose. The GIS Data were developed by the City of Saint Paul for its own internal business purposes. The City of Saint Paul does not represent or warrant that the GIS Data or the data documentation are error-free, complete, current, or accurate. You are responsible for any consequences resulting from your use of the GIS Data or your reliance on the GIS Data. You should consult the data documentation for this particular GIS Data to determine the limitations of the GIS Data and the precision with which the GIS Data may depict distance, direction, location, or other geographic features. If you transmit or provide the GIS Data (or any portion of it) to another