

1001 JOHNSON PARKWAY

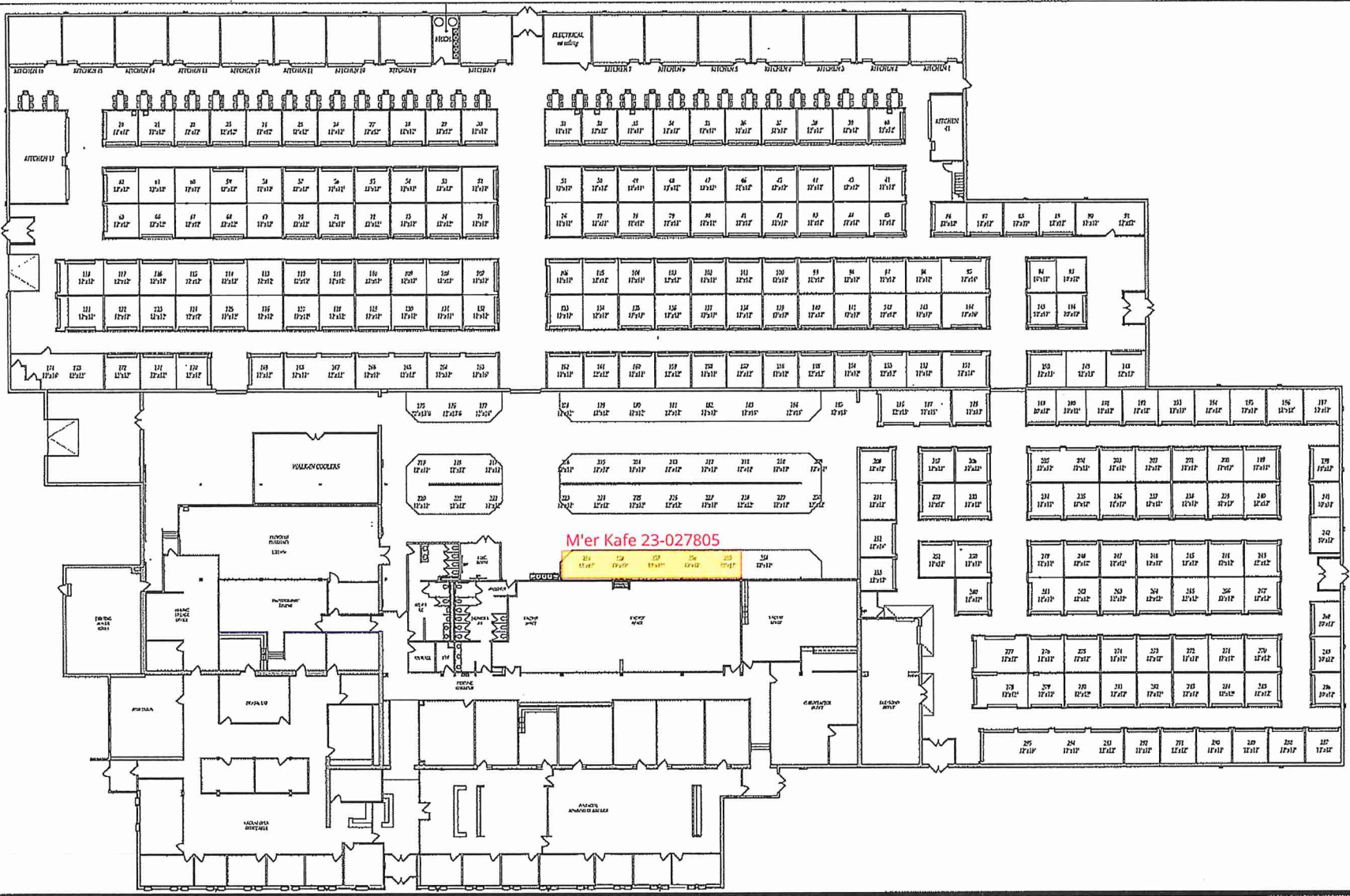

M'er Kafe 23-027805

THE DIMENSIONS AND CONFIGURATIONS CONTAINED HEREIN ARE THE EXCLUSIVE PROPERTY OF GENESIS AND ARCHITECTURE AND SHALL NOT BE UTILIZED OR COPIED BY OTHER PARTIES WITHOUT WRITTEN CONSENT.

REVISION NUMBER	DATE	REVISION NUMBER	DATE
MADE FOR AS-BUILT	05-23-2		

GENESIS
 4319 Baker Road, Suite 400, Plymouth, MN 55441
 Phone: 952.892.7274 Fax: 952.892.7760

PROJECT: **HIMONG VILLAGE**
 1001 JOHNSON PARKWAY
 ST. PAUL, MN

SHEET TITLE: **AS-BUILT PLAN / MARKETING**

JOB: **1001 JOHNSON PARKWAY**
 DRAWN BY: **AN**
 CHECKED BY: **DS**
 SHEET NO.:

M-1

53 x
12 = 636

53'

Room 1
Kitchen
Area

12x12 = 144 SF

Room 2
Sitting Area 41x12 = 492 SF

12'

53'

TER KAFE

