

	A	B	C	D
1	LAWRENCE H KASELLA JR	12166 GANTRY LN	APPLE VALLEY MN 55124-6203	12823420056
2	GULL LAKE RENTALS LLC	1477 SELBY AVE	SAINT PAUL MN 55104-6331	12823420057
3	DAVID BARNETT REAL ESTATE HOLDINGS INC	101 GORE ST UNIT 2	CAMBRIDGE MA 02141	12823420058
4	MATTAINI AND BULACH PROPERTIES LLC	1870 50TH ST E	INVER GROVE HEIGHTS MN 55077-1283	12823420052
5	EKBOM PROPERTIES I LLC	901 CASCADE ST N	OSCEOLA WI 54020-8106	12823420053
6	EKBOM PROPERTIES I LLC	901 CASCADE ST N	OSCEOLA WI 54020-8106	12823420078
7	JEFFREY A AUSTIN TRUSTEE	151 WESTERN AVE N	SAINT PAUL MN 55102-2067	12823420054
8	LAUREL ANN STEPHENSON	571 MEARS AVE	MENDOTA HEIGHTS MN 55118-1926	12823420077
9	SOCIETY OF ST VINCENT DE PAUL	2939 12TH AVE S	MINNEAPOLIS MN 55407-1316	12823420055

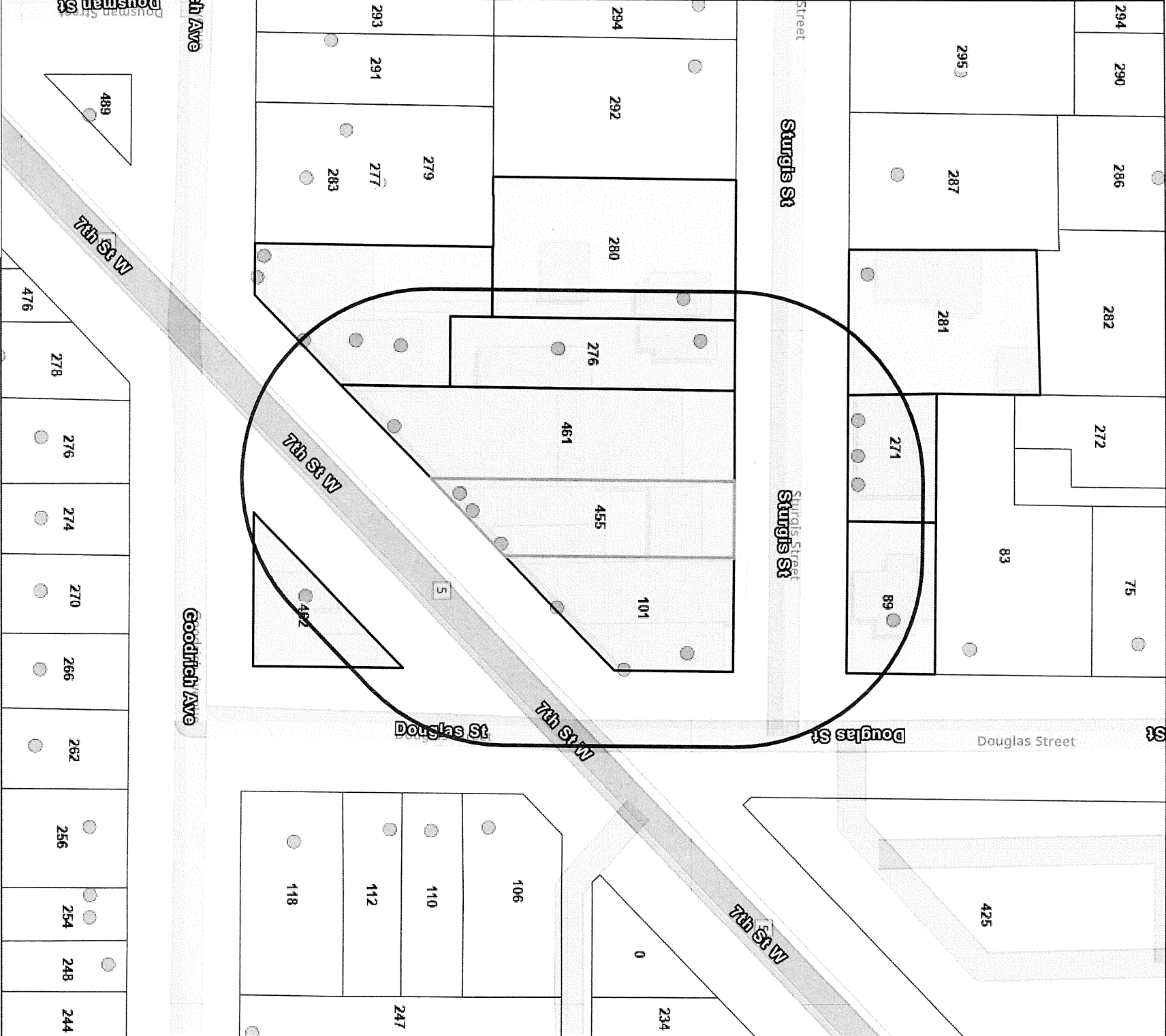

**Saint Paul Minnesota**

*The most livable city in America*

The Geographic Information System (GIS) Data to which this notice is attached are made available pursuant to the Minnesota Government Data Practices Act (Minnesota Statutes Chapter 13). The GIS Data are provided to you "AS IS" and without any warranty as to their performance, merchantability, or fitness for any particular purpose. The GIS Data were developed by the City of Saint Paul for its own internal business purposes. The City of Saint Paul does not represent or warrant that the GIS Data or the data documentation are error-free, complete, current, or accurate. You are responsible for any consequences resulting from your use of the GIS Data or your reliance on the GIS Data. You should consult the data documentation for this particular GIS Data to determine the limitations of the GIS Data and the precision with which the GIS Data may depict distance, direction, location, or other geographic features. If you transmit or provide the GIS Data (or any portion of it) to another user, the GIS Data must include a copy of this disclaimer.