

	A	B	C	D
1	PROPERTY OWNER (PO)	PO MAIL-TO ADDRESS	PO MAIL-TO CITY/STATE/ZIP	PIN
2	MIO INVESTMENTS LLC	5201 EDEN AVE STE 100	EDINA MN 55436-2349	352923220076
3	YI FEI WANG	1004 LAFOND AVE	SAINT PAUL MN 55104-2112	352923220069
4	ST PAUL PUBLIC HOUSING AGENCY	555 WABASHA ST N STE 400	ST PAUL MN 55102-1602	352923230007
5	CHRISTINE M HAGER	1028 THOMAS AVE	ST PAUL MN 55104-2638	352923230012
6	SASS INC	PO BOX 2068	STILLWATER MN 55082-3068	352923230008
7	KARI MYKEREZI	1343 THOMAS AVE	SAINT PAUL MN 55104-2448	352923230011
8	DAVID R DIERENFIELD	719 WINSLOW AVE	SAINT PAUL MN 55107-3328	352923220075
9	BAJA REALTY LLC	526 HAWTHORNE WOODS DR	SAINT PAUL MN 55123-3059	352923220070
10	MOHAMED A ELRASHEEDY	1045 THOMAS AVE	ST PAUL MN 55104-2640	352923220182
11	CHRISTOPHER FENCL	1042 THOMAS AVE	SAINT PAUL MN 55104-2639	352923230096
12	FELIX BUCKLEY JONES	1032 THOMAS AVE	SAINT PAUL MN 55104-2638	352923230013
13	BE VANG	368 ROSE AVE E	SAINT PAUL MN 55130-3628	352923230010
14	CHI 1016 THOMAS AVE LLC	1665 DANE RD	OWATONNA MN 55060-2027	352923230009
15	LUIS MANUAL URRUTIA	1044 LAFOND AVE	ST PAUL MN 55104-2123	352923220156
16	KIM SORN THENG	2534 MONTANA AVE E	MAPLEWOOD MN 55119-3151	352923220183
17	BEFAME PROPERTY LLC	1033 THOMAS AVE	SAINT PAUL MN 55104-2637	352923220188
18	VISITATION PLACE LP	1200 SECOND AVE S	MINNEAPOLIS MN 55403-2523	352923220187

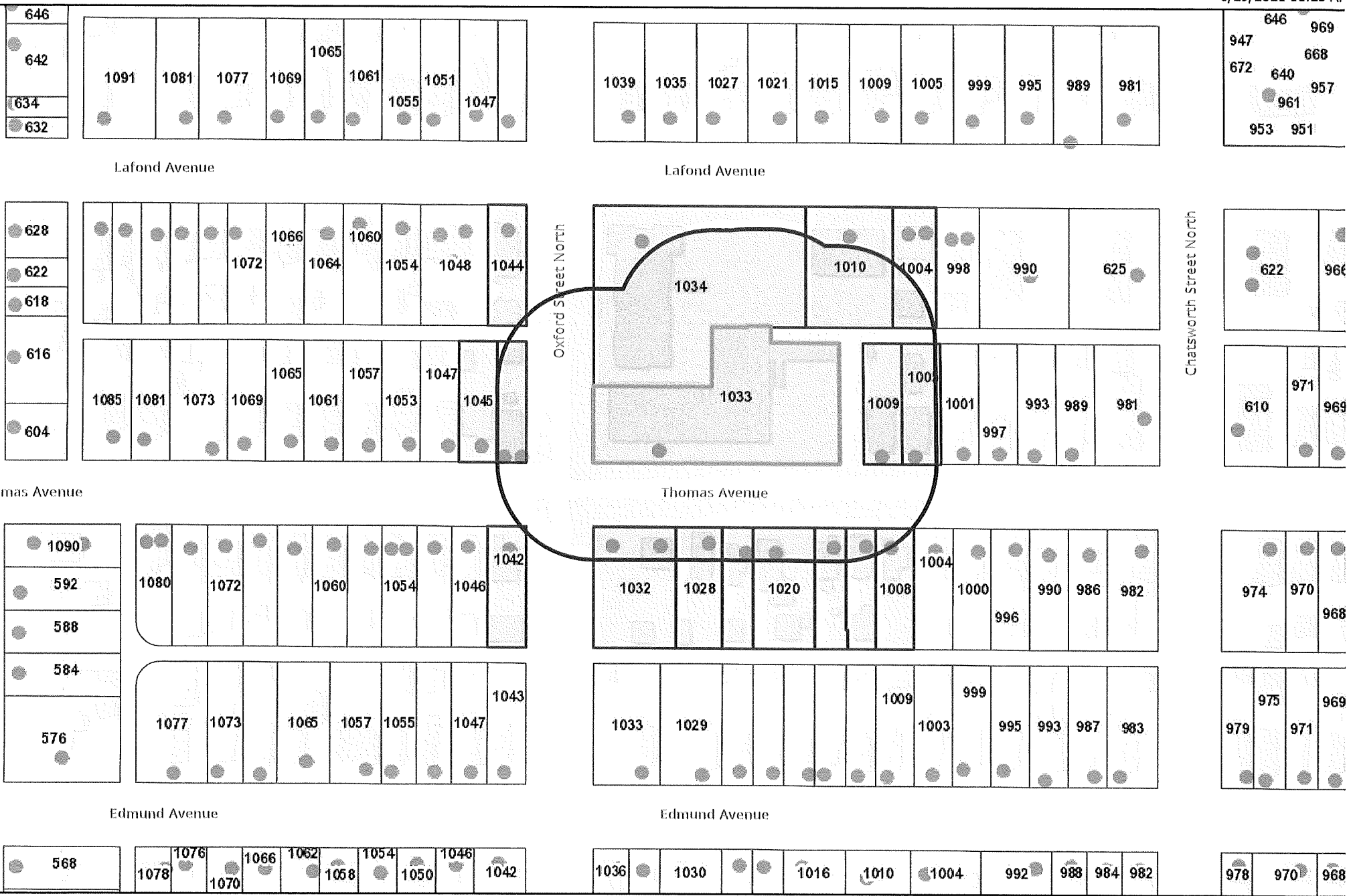

Saint Paul Minnesota
The most livable city in America

Department of Safety and Inspections (DSI), Sources: Esri, Airbus DS, USGS, NGA, NASA, CGIAR, N Robinson, NCEAS, NLS, OS, NMA, Geodastylreiser, Rijkswaterstaat, GSA, Geoland, FEMA, Intermap and the

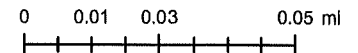

The Geographic Information System (GIS) Data to which this notice is attached are made available pursuant to the Minnesota Government Data Practices Act (Minnesota Statutes Chapter 13). The GIS Data are provided to you "AS IS" and without any warranty as to their performance, merchantability, or fitness for any particular purpose. The GIS Data were developed by the City of Saint Paul for its own internal business purposes. The City of Saint Paul does not represent or warrant that the GIS Data or the data documentation are error-free, complete, current, or accurate. You are responsible for any consequences resulting from your use of the GIS Data or your reliance on the GIS Data. You should consult the data documentation for this particular GIS Data to determine the limitations of the GIS Data and the precision with which the GIS Data may depict distance, direction, location, or other geographic features. If you transmit or provide the GIS Data (or any portion of it) to