





Source: Esri, Maxar, Earthstar Geographics, and the GIS User Community



File #22-086-535 Aerial Map Application of Pulte Homes of Mn

Application Type: Combined Plat
Application Date: August 15, 2022
Planning District: 15

Subject Parcel(s) Outlined in Blue

-  Subject Parcel(s)
-  ParcelPoly

0 20 40 80 120 160 Feet

This document was prepared by the Saint Paul Planning and Economic Development Department and is intended to be used for reference and illustrative purposes only. This drawing is not a legally recorded plan, survey, official tax map or engineering schematic and is not intended to be used as such. Data sources: City of Saint Paul, Ramsey County, Metropolitan Council, State of Minnesota.

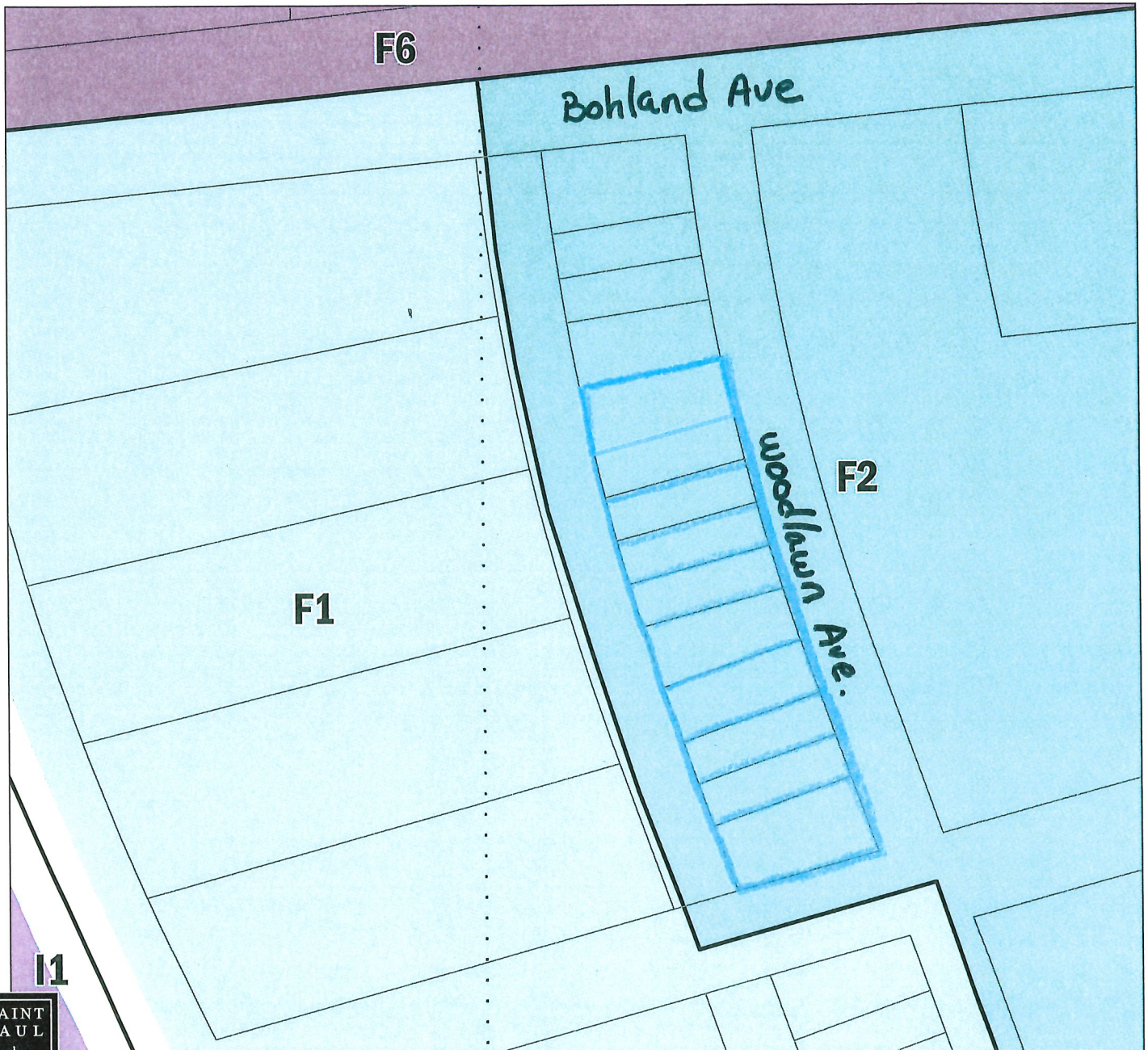

File #22-086-535 Zoning Map Application of Pulte Homes of Mn

Application Type: Combined Plat
Application Date: August 15, 2022
Planning District: 15

0 15 30 60 90 120 Feet

This document was prepared by the Saint Paul Planning and Economic Development Department and is intended to be used for reference and illustrative purposes only. This drawing is not a legally recorded plan, survey, official tax map or engineering schematic and is not intended to be used as such. Data sources: City of Saint Paul, Ramsey County, Metropolitan Council, State of Minnesota.

Subject Parcel(s) Outlined in Blue

Subject Parcel(s)	RM2 Multiple-Family	BC Community Business (converted)	F1 River Residential
ParcelPoly	RM3 Multiple-Family	B2 Community Business	F2 Residential Low
RL One-Family Large Lot	T1 Traditional Neighborhood	B3 General Business	F3 Residential Mid
R1 One-Family	T2 Traditional Neighborhood	B4 Central Business	F4 Residential High
R2 One-Family	T3 Traditional Neighborhood	B5 Central Business Service	F5 Business
R3 One-Family	T3M T3 with Master Plan	IT Transitional Industrial	F6 Gateway
R4 One-Family	T4 Traditional Neighborhood	ITM IT with Master Plan	VP Vehicular Parking
RT1 Two-Family	T4M T4 with Master Plan	I1 Light Industrial	PD Planned Development
RT2 Townhouse	OS Office-Service	I2 General Industrial	CA Capitol Area Jurisdiction
RM1 Multiple-Family	B1 Local Business	I3 Restricted Industrial	

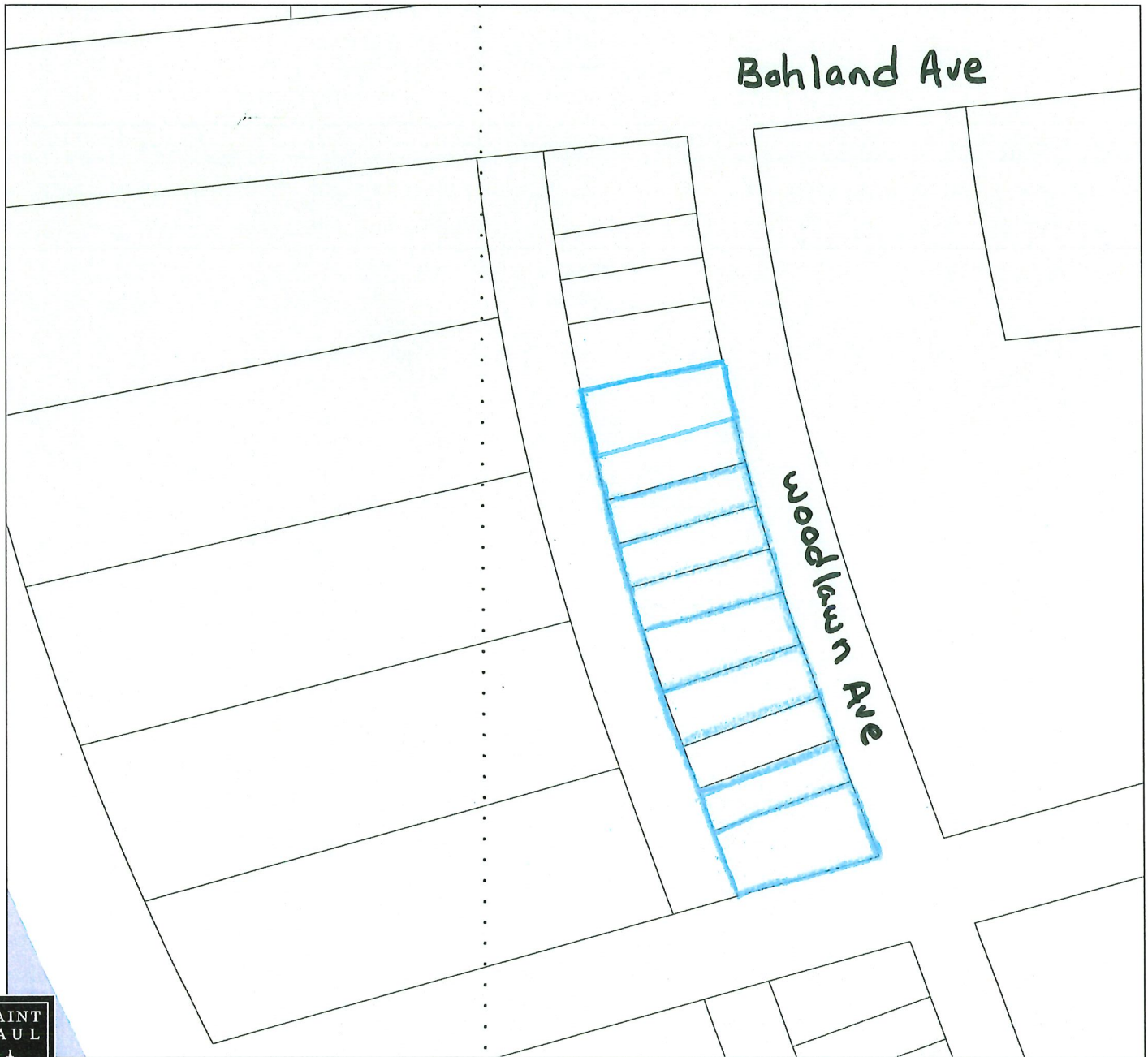

File #22-086-535 Existing Land Use Application of Pulte Homes of Mn

Application Type: Combined Plat
 Application Date: August 15, 2022
 Planning District: 15



This document was prepared by the Saint Paul Planning and Economic Development Department and is intended to be used for reference and illustrative purposes only. This drawing is not a legally recorded plan, survey, official tax map or engineering schematic and is not intended to be used as such. Data sources: City of Saint Paul, Ramsey County, Metropolitan Council, State of Minnesota.

Subject Parcel(s) Outlined in Blue

Subject Parcel(s)	Single Family Attached	Mixed Use Commercial and Other	Major Highway
ParcelPoly	Multifamily	Industrial and Utility	Railway
Farmstead	Office	Extractive	Airport
Seasonal/Vacation	Retail and Other Commercial	Institutional	Agricultural
Single Family Detached	Mixed Use Residential	Park, Recreational or Preserve	Undeveloped
Manufactured Housing Park	Mixed Use Industrial	Golf Course	Water