

**GENERAL NOTES**

- SEE OVERALL PLANS FOR GRIDLINE DIMENSIONS
- REFER TO BUILDING SYSTEMS SHEET FOR PARTITION TYPES
- ALL DIMENSIONS ARE FROM STUD TO STUD UNO
- DIMENSIONS TO EXISTING WALLS ARE TO THE FACE OF FINISH OF THE WALL
- ALL FIXTURE/FURNITURE DIMENSIONS ARE TO FINISH FACE OF WALL AND ITEM
- WHERE NOTED, FOF MEANS FACE OF FINISH
- WHERE NOTED, FCM MEANS FACE OF MASONRY
- ALL FINISH MATERIALS TO COMPLY WITH FLAME SPREAD RATINGS PER APPLICABLE CODES
- SEE TENANT SUPPLIED ITEMS SCHEDULE FOR ALL TSM ITEMS

**FLOOR FINISH LEGEND**

- (F 1) CONCRETE
- (F 2) STABILIZED DECOMPOSED GRANITE
- (F 3) GRAVEL
- (F 4) RAIN GARDEN W/ NATIVE PLANTINGS

**FLOOR PLAN KEYNOTES**

- 100 GC TO PROVIDE NEW EMERGENCY LIGHT EXIT SIGNS AT NEW DOORS

**PLAN LEGEND**

- (F #) FLOOR TYPE
- (B #) BASE TYPE
- EXISTING PARTITION
- RATED EXISTING PARTITION
- NEW PARTITION
- 1HR RATED PARTITION
- AREA NOT IN CONTRACT

**MATERIAL NOTES**

ALL WOOD ASSUMED TO BE WESTERN RED CEDAR.  
 BID ALTERNATIVE:  
 CEDAR TONE PRESSURE TREATED PINE.

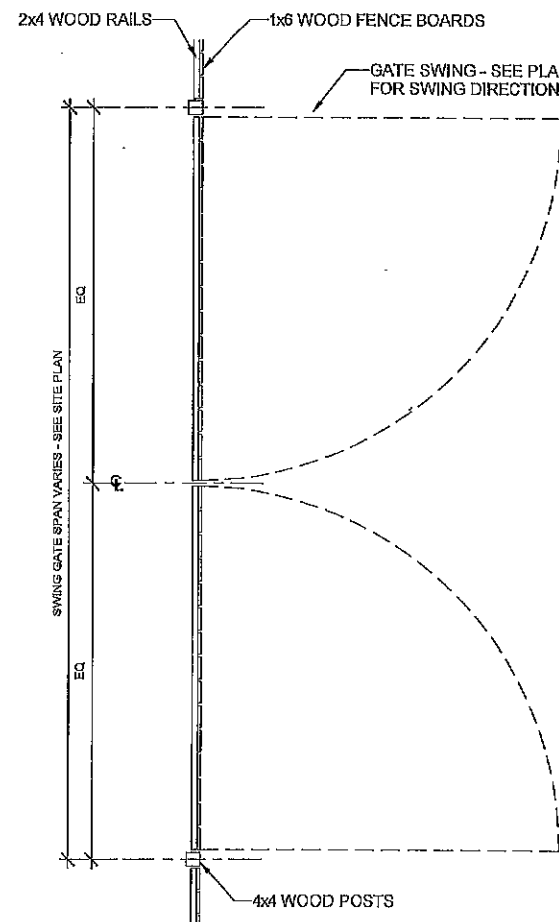

2 Enlarged Plan - Swing Gate

A100 SCALE: 1/2" = 1'-0"

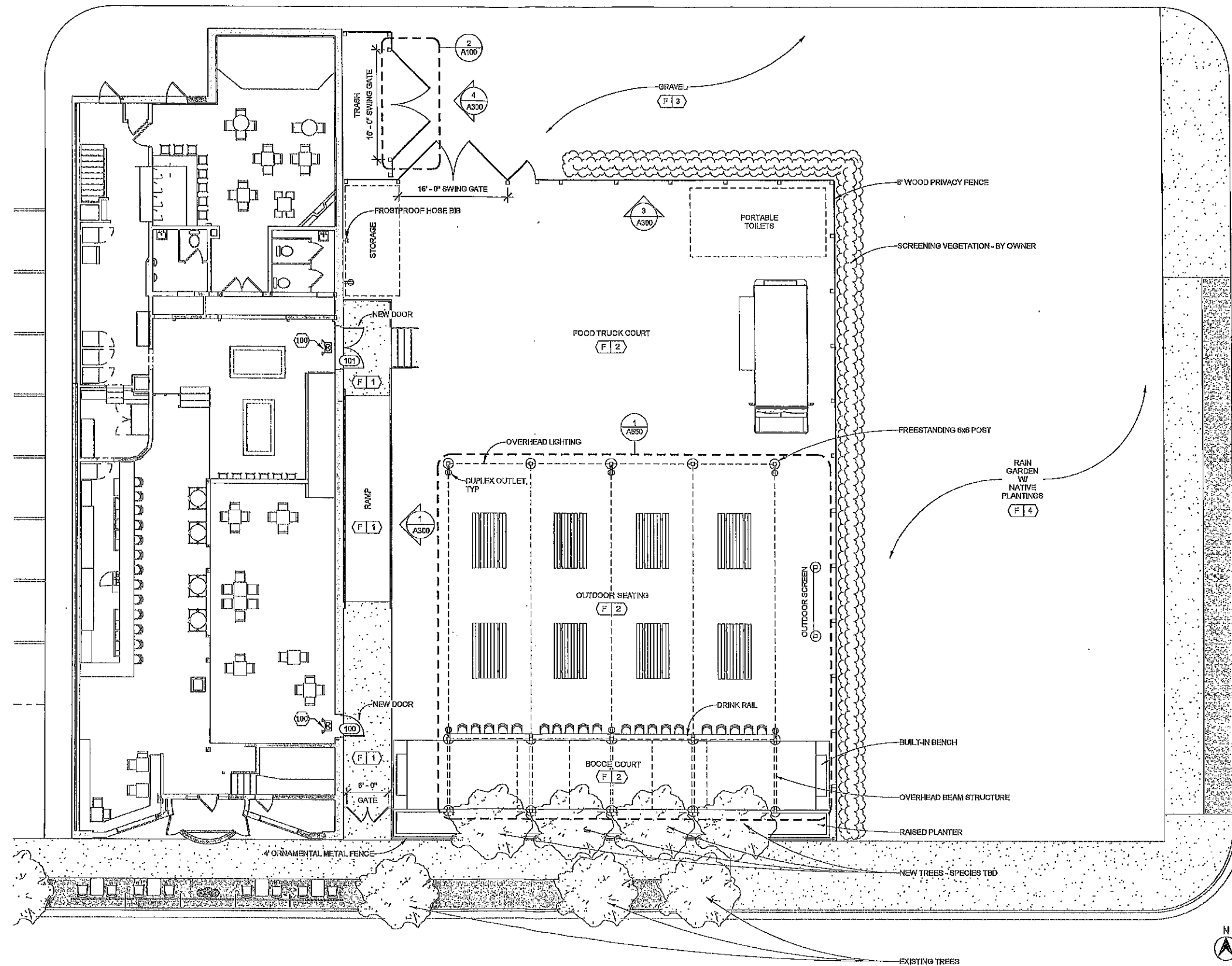

1 Site Plan

A100 SCALE: 1/8" = 1'-0"

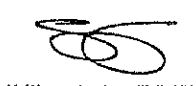

I, Sean M. Wagner, hereby certify that this plan, specification or report was prepared by me or under my direct supervision and that I am a duly Licensed Architect under the Laws of the State of Minnesota. Date: 10.03.2022 License No. 48989

**NewStudio** architecture

2803 Wydliff Street, Saint Paul, MN 55114  
 P: 651.207.5827 F: 651.207.8247

Wes Burdino  
 1415 University Ave W  
 St Paul, MN 55104

TBD

Dan Eienbaas  
 Kinley-Horn  
 797 Stella St, Suite 100  
 St. Paul, MN 55114  
 PH: 651.645.4197  
 EMAIL: Dan.Eienbaas@kinley-horn.com

DRAWN BY: Author CHECKED BY: Checker

NSA PROJECT NUMBER: 2022-455

PROJECT PHASE: DESIGN DEVELOPMENT

REV# / ISSUE / DATE :

SHEET TITLE :  
**SITE PLAN**

SHEET NO.:

**A100**

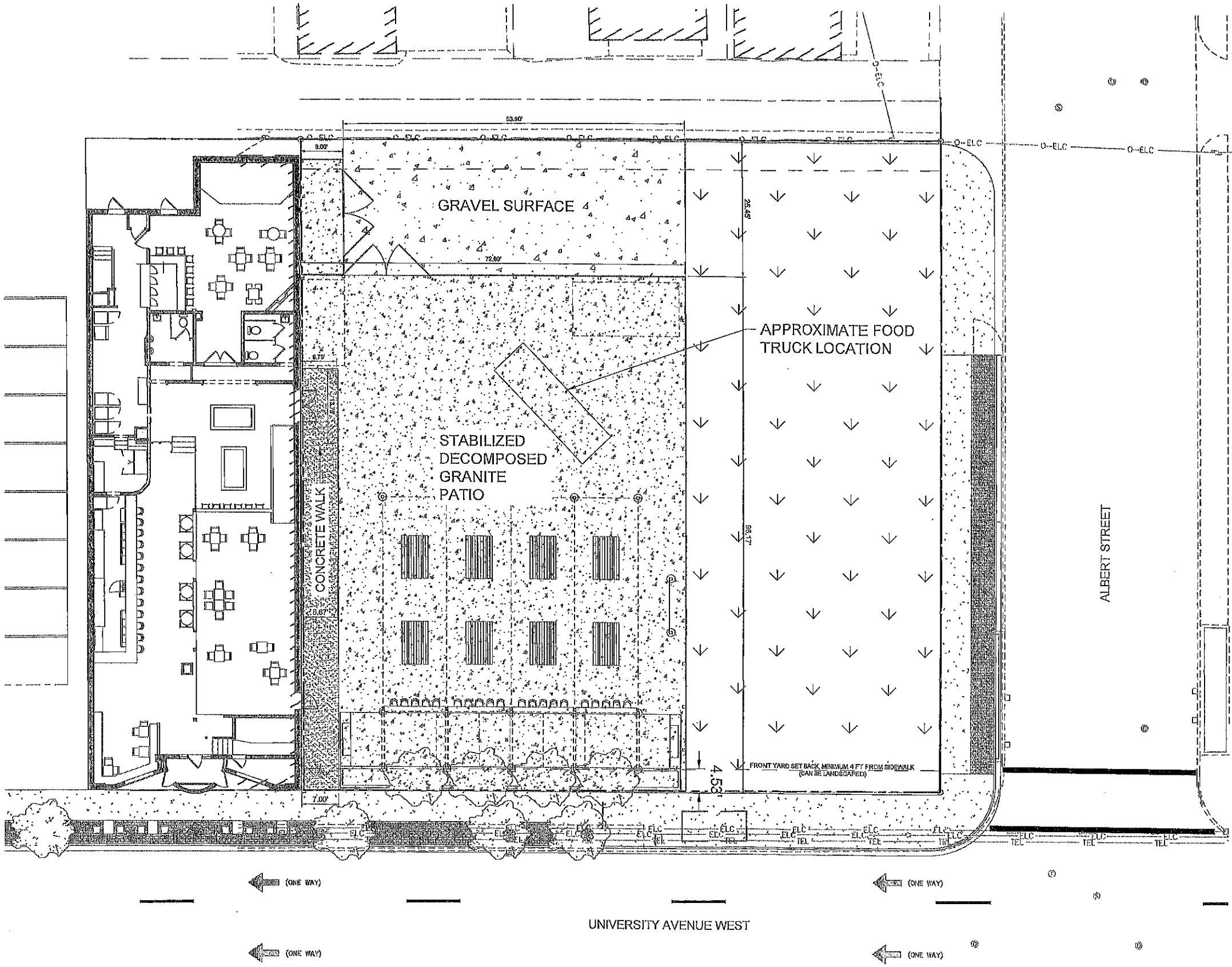

**LEGEND**

	PROPERTY LINE
	SETBACK LINE
	EXISTING VEGETATION
	PROPOSED GRAVEL SURFACE
	PROPOSED STABILIZED DECOMPOSED GRANITE
	PROPOSED CONCRETE SIDEWALK

**PROPERTY SUMMARY**

BLACK HART PATIO	
TOTAL PROPERTY AREA	14,585 SF (0.33 AC)
PROPOSED IMPERVIOUS AREA	8,720 SF (0.20 AC)
PROPOSED PERVIOUS AREA	1,023 SF (0.02 AC)
TOTAL DISTURBED AREA	9,740 SF (0.22 AC)

**ZONING SUMMARY**

EXISTING ZONING	T2 - TRADITIONAL NEIGHBORHOOD
PROPOSED ZONING	T2 - TRADITIONAL NEIGHBORHOOD
BUILDING SETBACKS	FRONT = 4' REAR = 13' (FROM CENTERLINE OF ALLEY)

- SITE PLAN NOTES**
- ALL WORK AND MATERIALS SHALL COMPLY WITH ALL CITY/COUNTY REGULATIONS AND CODES AND O.S.H.A. STANDARDS.
  - CONTRACTOR SHALL REFER TO THE ARCHITECTURAL PLANS FOR EXACT LOCATIONS AND DIMENSIONS OF VESTIBULES, SLOPE PAVING, SIDEWALKS, EXIT PORCHES, TRUCK DOCKS, PRECISE BUILDING DIMENSIONS AND EXACT BUILDING UTILITY ENTRANCE LOCATIONS.
  - ALL DIMENSIONS AND RADII ARE TO THE FACE OF CURB UNLESS OTHERWISE NOTED.
  - EXISTING STRUCTURES WITHIN CONSTRUCTION LIMITS ARE TO BE ABANDONED, REMOVED OR RELOCATED AS NECESSARY. ALL COST SHALL BE INCLUDED IN BASE BID.
  - CONTRACTOR SHALL BE RESPONSIBLE FOR ALL RELOCATIONS, UNLESS OTHERWISE NOTED OR PLANS INCLUDING BUT NOT LIMITED TO, ALL UTILITIES, STORM DRAINAGE, SIGNS, TRAFFIC SIGNALS & POLES, ETC. AS REQUIRED. ALL WORK SHALL BE IN ACCORDANCE WITH GOVERNING AUTHORITIES REQUIREMENTS AND PROJECT SITE WORK SPECIFICATIONS AND SHALL BE APPROVED BY SUCH. ALL COST SHALL BE INCLUDED IN BASE BID.
  - SITE BOUNDARY, TOPOGRAPHY, UTILITY AND ROAD INFORMATION TAKEN FROM A SURVEY BY LAKE AND LAND SURVEYING, DATED 07/14/2022. KIMLEY-HORN ASSUMES NO LIABILITY FOR ANY ERRORS, INACCURACIES, OR OMISSIONS CONTAINED THEREIN.
  - PYLON / MONUMENT SIGNS SHALL BE CONSTRUCTED BY OTHERS. SIGNS ARE SHOWN FOR GRAPHICAL & INFORMATIONAL PURPOSES ONLY. CONTRACTOR TO VERIFY SIZE, LOCATION AND ANY REQUIRED PERMITS NECESSARY FOR THE CONSTRUCTION OF THE PYLON / MONUMENT SIGN.
  - CONTRACTOR SHALL REFERENCE ARCH / MEP PLANS FOR SITE LIGHTING AND ELECTRICAL PLAN.
  - NO PROPOSED LANDSCAPING SUCH AS TREES OR SHRUBS, ABOVE AND UNDERGROUND STRUCTURES, OR OTHER OBSTRUCTIONS SHALL BE LOCATED WITHIN EXISTING OR PROPOSED UTILITY EASEMENTS AND RIGHTS OF WAY UNLESS SPECIFICALLY NOTED ON PLANS OTHERWISE.
  - REFERENCE ARCHITECTURAL PLANS FOR DUMPSTER ENCLOSURE DETAILS.
  - REFER TO FINAL PLAT OR ALTA SURVEY FOR EXACT LOT AND PROPERTY BOUNDARY DIMENSIONS.
  - ALL AREAS ARE ROUNDED TO THE NEAREST SQUARE FOOT.
  - ALL DIMENSIONS ARE ROUNDED TO THE NEAREST TENTH FOOT.

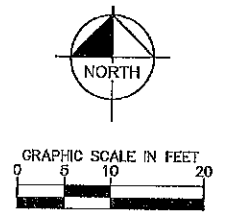

PRELIMINARY - NOT FOR CONSTRUCTION

BLACK HART PATIO  
 PREPARED FOR  
 BLACK HART OF  
 SAINT PAUL,  
 MN

**KIMLEY-HORN PROJECT INFORMATION**

KIMLEY-HORN PROJECT NO.	XXXXXX
DATE	10/17/2022
SCALE	AS SHOWN
DESIGNED BY	DLE
DRAWN BY	DLE
CHECKED BY	DLE
PROJECT LEAD	MR. XXXXXX
DATE	XXXXXX
LIC. NO.	XXXXXX

**Kimley-Horn**  
 © 2022 KIMLEY-HORN AND ASSOCIATES, INC.  
 787 EUSTIS STREET, SUITE 100, ST. PAUL, MN 55114  
 PHONE 651-945-4187  
 WWW.KIMLEY-HORN.COM

NO.	REVISIONS	DATE	BY

SHEET NUMBER  
**C400**